

cozzia®

cozzia®



Scan the QR code for installation video

INSTALLATION MANUAL | CZ-330

The CZ-330 massage arrives in one box.



- 1 Open the box and remove all contents.** Remove the packing materials. Take the base and footrest out of the box. Collect all the accessories and put them aside.



- 2 Adjust chair position.** Use the power cord to connect the chair to a power supply and turn on the power switch. The chair will go back to the home position. Then turn off the power switch.





3 Remove footrest fixing plates from chair base. Locate the fixing plates on the chair base. Slacken and remove the screws, then take off the footrest fixing plate. Put the screws and footrest fixing plate aside the chair base.

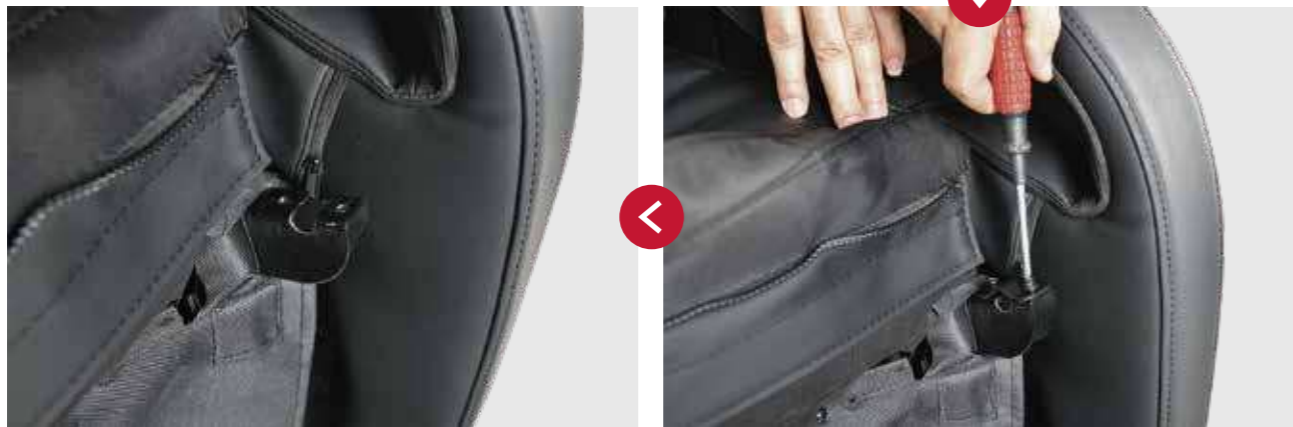

4 Connect wire and air hose in footrest. Plug footrest wire connectors tightly, then connect the air hose. Caution: Same color air hoses connect together.

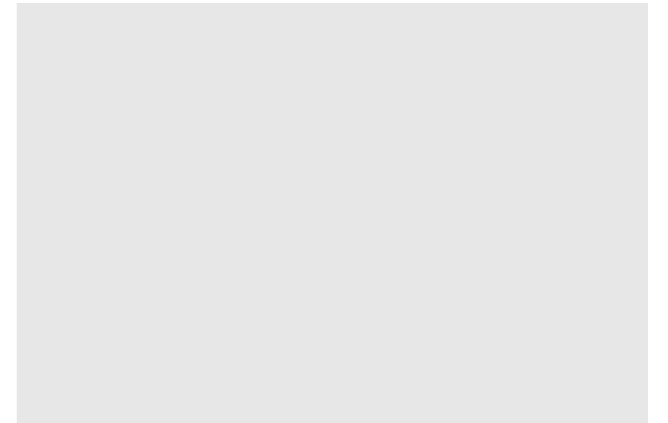

5 Attach footrest to chair base. Attach the footrest onto the brackets of the chair base. Then fix the footrest fixing plates to secure the footrest.



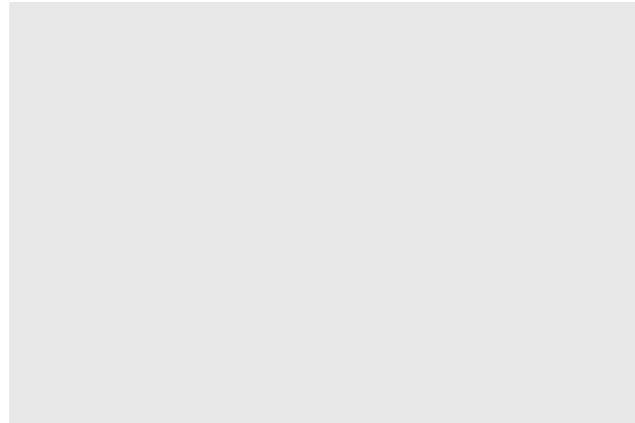

6 Zip the zipper between the seat pad and footrest cushion.

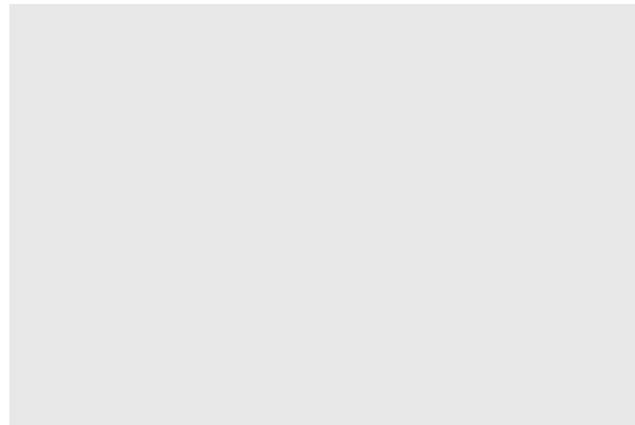

7 **Turn on the chair.** Turn on the power switch. The chair will now be ready to start.

