



smart process
control & instrumentation

Crompton Instruments SC Series Split Core Current Transformers

A range of split core current transformers that offers a cost effective and efficient method by which the current can be measured without the need to break the conductor, thereby reducing installation and commissioning time.

Specifications

System voltage	720V (0.72kV) maximum
Test voltage	3kV for 1 minute
System frequency	50/60Hz
Insulation class	E
Overload withstand	1.2 times rated current continuously
Short circuit thermal	100 x rated primary for 1 second
Operating temperature	-20 °C to +70 °C
Relative humidity	0-90% (non condensing)
Compliant with	IEC/EN 60044-1, BS7626
Accuracy	Class 3, 1 & 0.5
Mounting hardware	Plug-in metal feet for wall or base mounting or moulded busbar mounting
Rated dynamic current	= 2.55 x I _{ht}
Enclosure	Flame retardant grade classified UL 94V-O

Features

- High quality comprehensive measurements
- Available in a wide range of transformer ratings
- Accuracy up to Class 0.5
- Foot or Busbar mounted

Benefits

- Faster installation
- Cost effective
- Long product life

Applications

- Switchgear
- Distribution systems
- Generator Sets
- Control panels

Crompton Instruments SC Series Split Core Current Transformers



smartprocess
control & instrumentation

Product Codes

	Part Number	Ratio	Burden VA against class index			Aperture (mm)
			0.5	1	3	
Case 1	SC1-100/5A	100/5A	-	-	1.5	20 x 30
	SC1-150/5A	150/5A	-	-	2	20 x 30
	SC1-200/5A	200/5A	-	1.5	2.5	20 x 30
	SC1-250/5A	250/5A	-	2	4	20 x 30
	SC1-300/5A	300/5A	1.5	4	6	20 x 30
	SC1-400/5A	400/5A	2.5	6	10	20 x 30
Case 2	SC2-250/5A	250/5A	1	2	4	50 x 80
	SC2-300/5A	300/5A	1.5	3	6	50 x 80
	SC2-400/5A	400/5A	1.5	3	10	50 x 80
	SC2-500/5A	500/5A	2.5	5	15	50 x 80
	SC2-600/5A	600/5A	2.5	5	15	50 x 80
	SC2-750/5A	750/5A	3	6	20	50 x 80
	SC2-800/5A	800/5A	3	7.5	20	50 x 80
	SC2-1000/5A	1000/5A	5	10	20	50 x 80
Case 3	SC3-250/5A	250/5A	1	2	4	80 x 80
	SC3-300/5A	300/5A	1.5	3	6	80 x 80
	SC3-400/5A	400/5A	1.5	3	10	80 x 80
	SC3-500/5A	500/5A	2.5	5	15	80 x 80
	SC3-600/5A	600/5A	2.5	5	15	80 x 80
	SC3-750/5A	750/5A	3	6	20	80 x 80
	SC3-800/5A	800/5A	3	7.5	20	80 x 80
	SC3-1000/5A	1000/5A	5	10	20	80 x 80
Case 4	SC4-500/5A	500/5A	-	4	12.5	80 x 120
	SC4-600/5A	600/5A	-	5	15	80 x 120
	SC4-750/5A	750/5A	2.5	6	17.5	80 x 120
	SC4-800/5A	800/5A	3	7.5	20	80 x 120
	SC4-1000/5A	1000/5A	5	10	20	80 x 120
	SC4-1200/5A	1200/5A	6	12.5	25	80 x 120
	SC4-1250/5A	1250/5A	7.5	15	30	80 x 120
	SC4-1500/5A	1500/5A	8	17	30	80 x 120
Case 5	SC4-1600/5A	1600/5A	8	17	30	80 x 120
	SC5-1000/5A	1000/5A	10	15	20	80 x 160
	SC5-1250/5A	1250/5A	10	15	20	80 x 160
	SC5-1500/5A	1500/5A	15	20	25	80 x 160
	SC5-2000/5A	2000/5A	15	20	25	80 x 160
	SC5-2500/5A	2500/5A	15	20	25	80 x 160
	SC5-3000/5A	3000/5A	20	25	30	80 x 160
	SC5-4000/5A	4000/5A	20	25	30	80 x 160
SC5-5000/5A	5000/5A	20	25	30	80 x 160	
SC5-6000/5A	6000/5A	20	25	30	80 x 160	

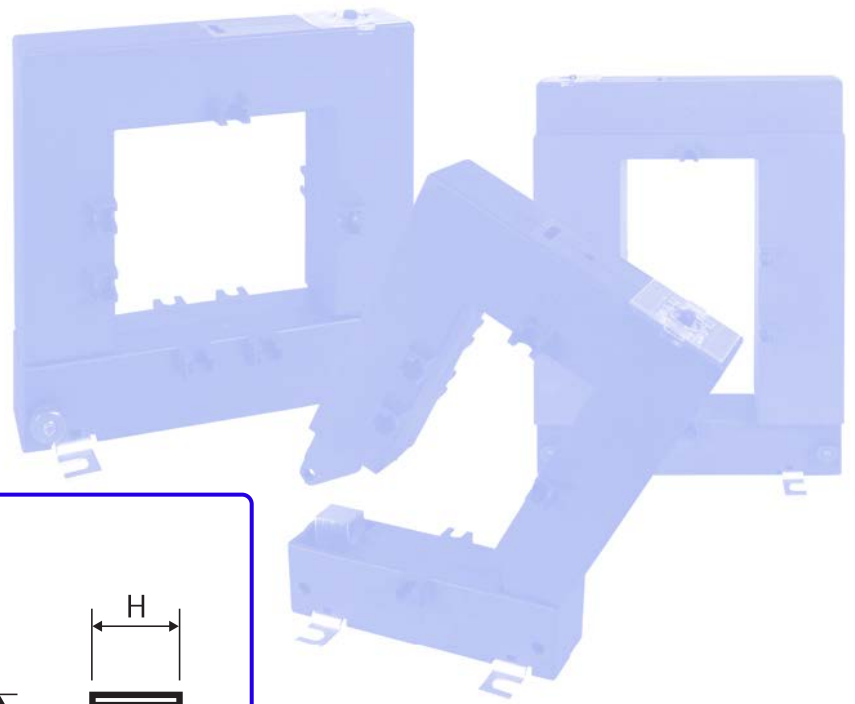

Dimensions (mm)

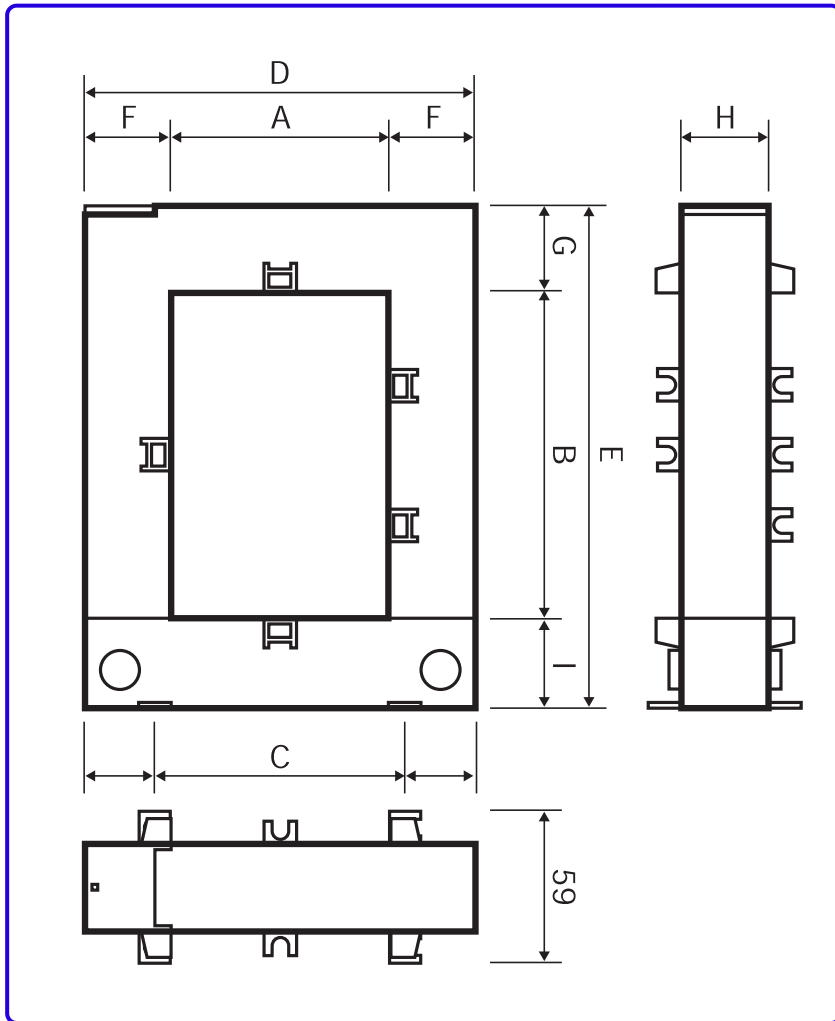

Model	Case 1	Case 2	Case 3	Case 4	Case 5
A	20	50	80	80	80
B	30	80	80	120	160
C	51	78	108	108	120
D	89	114	144	144	184
E	111	145	145	185	245
F	34	32	32	32	52
G	47	32	32	32	52
H	40	32	32	32	52
I	32	33	33	33	38
Weight (kg)	0.75	0.90	1.05	1.25	4.30



Smart Process & Control LTD
Unit 11, Totman Close,
Brook Road Industrial Estate,
Rayleigh, Essex, SS6 7UZ
Telephone: 01268 773422
www.smartprocess.co.uk