



PRO TIPS

-RIVIAN SHOULD BE IN OFFROAD MODE (HIGHEST SUSPENSION SETTING) TO GIVE YOU THE MOST ROOM TO WORK UNDERNEATH

-4" ACCESS HOLE TEMPLATES ARE TO BE USED WHILE THE ROCKER PANELS ARE INSTALLED ON BOTTOMSIDE OF RIVIAN

-ORIENTATION OF TEMPLATES ARE SUCH THAT IF YOU ARE LYING DOWN WITH YOUR BACK ON THE GROUND LOOKING UP TO THE SKY/BOTTOM SIDE OF THE TRUCK, EACH TEMPLATE CAN BE PLACED DIRECTLY ONTO THE PLASTIC PANELS TO MARK YOUR ACCESS HOLES

-WHEN USING 4" HOLE SAW, SHORTEN PILOT DRILL SO THAT IT EXTENDS .25" PAST CUTTING EDGE OF SAW

-WHEN CUTTING ACCESS HOLE IN REAR PANEL (2/2) REMOVE THE JACK ACCESS COVER AND LET IT HANG FROM THE PANEL SO THAT IT'S LEASH ISN'T CUT BY THE HOLE SAW



INNER REFERENCE:
ALIGN THIS PAPER EDGE TO
INNER EDGE OF CENTER
PLASTIC PANEL

DRIVER SIDE FRONT PANEL

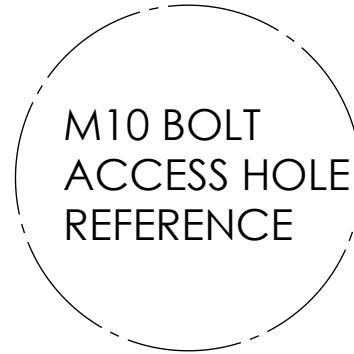

BACK
REFERENCE:
ALIGN THIS
PAPER EDGE
TO BACK EDGE
OF FRONT
PLASTIC PANEL

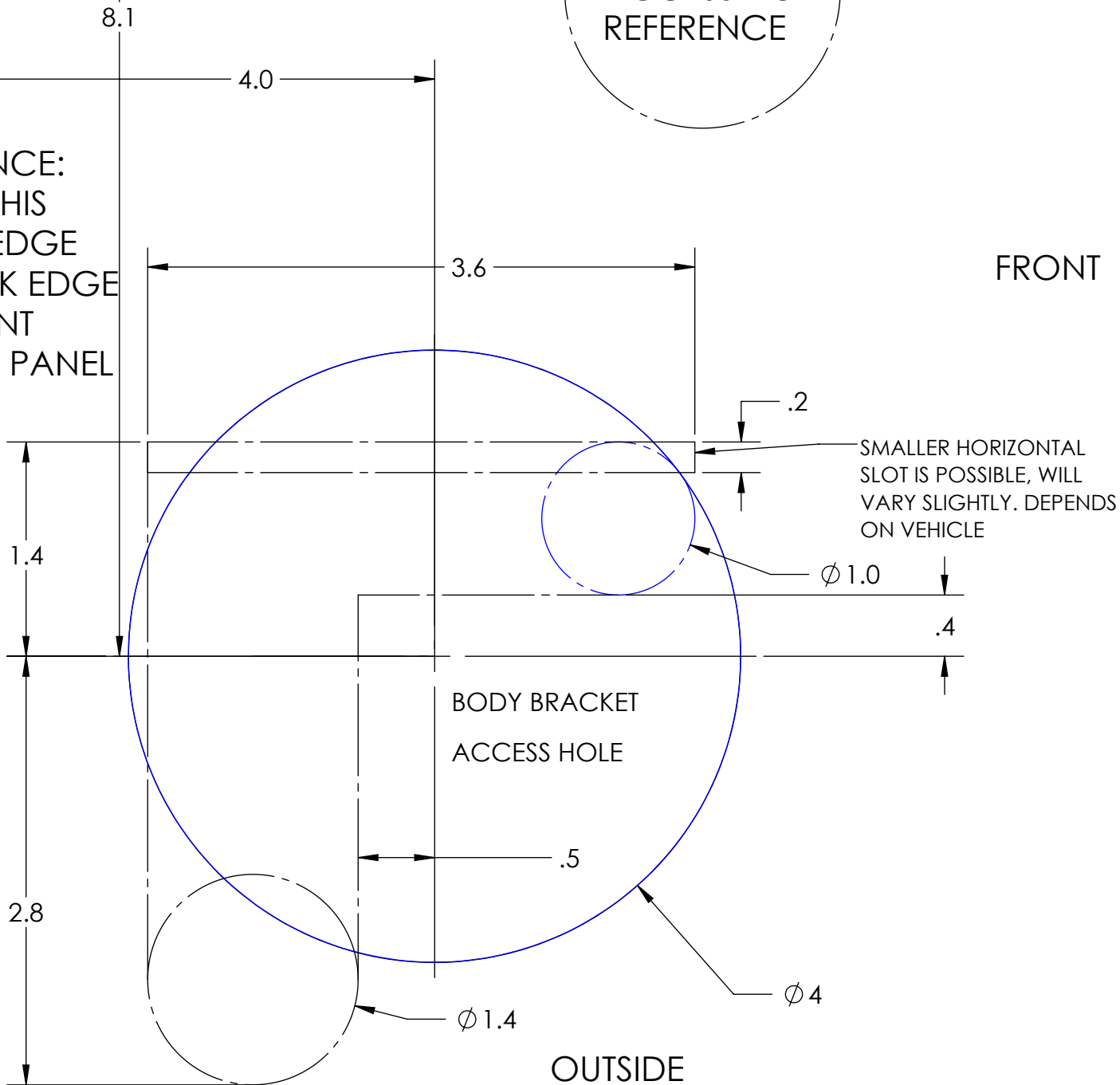



INNER REFERENCE:
ALIGN THIS PAPER EDGE TO
INNER EDGE OF CENTER
PLASTIC PANEL

BACK REFERENCE:
ALIGN THIS
PAPER EDGE
TO BACK
EDGE OF
FRONT
PLASTIC
PANEL

PASSENGER SIDE FRONT PANEL

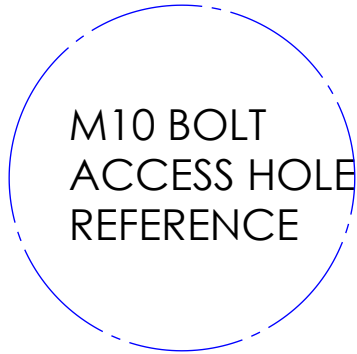

8.1

FRONT

SMALLER HORIZONTAL
SLOT IS POSSIBLE, WILL
VARY SLIGHTLY. DEPENDS
ON VEHICLE

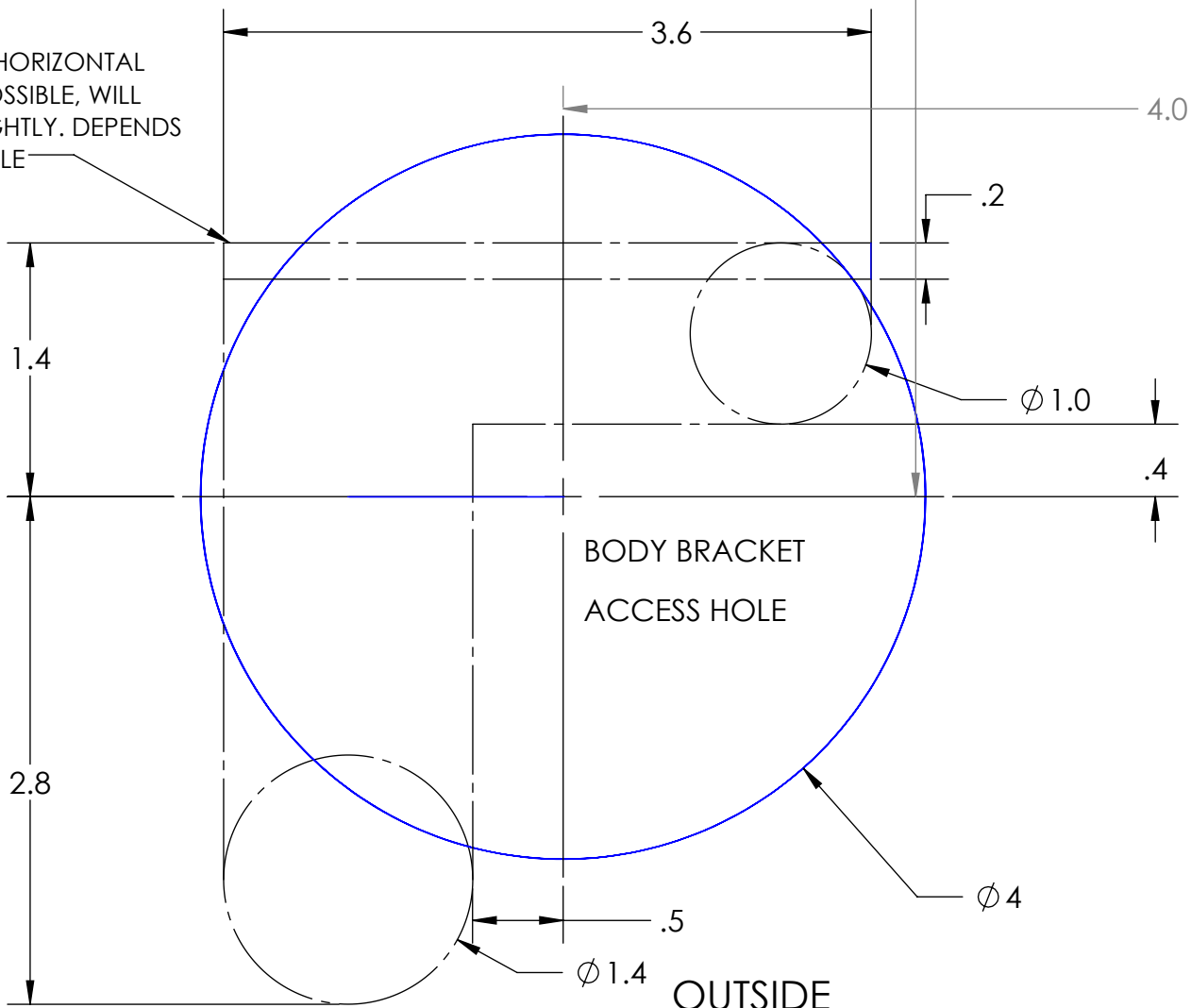



INNER REFERENCE:
ALIGN THIS PAPER EDGE TO
INNER EDGE OF CENTER
PLASTIC PANEL

PASSENGER SIDE CENTER PANEL

FRONT REFERENCE:
20 INCHES FROM
THIS PAPER EDGE
TO FRONT EDGE
OF CENTER PLASTIC
PANEL

8.1

4.0

BACK

SMALLER HORIZONTAL
SLOT IS POSSIBLE, WILL
VARY SLIGHTLY. DEPENDS
ON VEHICLE

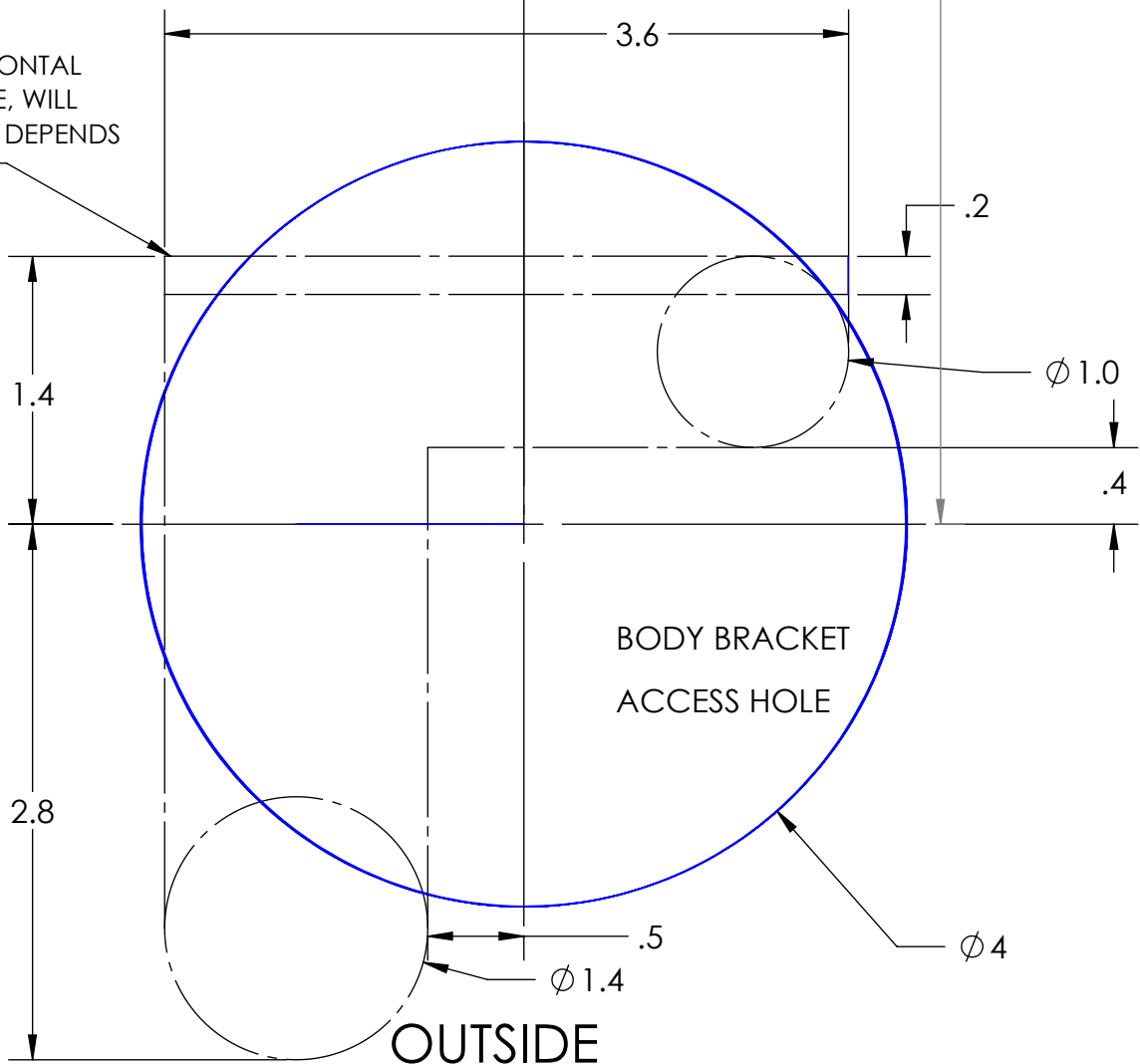



INNER REFERENCE:
ALIGN THIS PAPER EDGE TO
INNER EDGE OF REAR
PLASTIC PANEL

FRONT
REFERENCE:
ALIGN THIS
PAPER EDGE
TO FRONT EDGE
OF REAR
PLASTIC PANEL

DRIVER SIDE REAR PANEL (1/2)

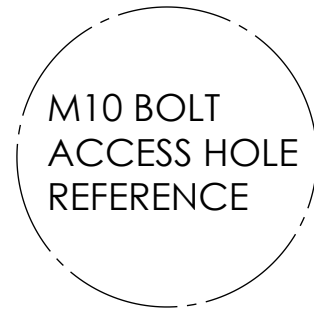

8.1
BACK

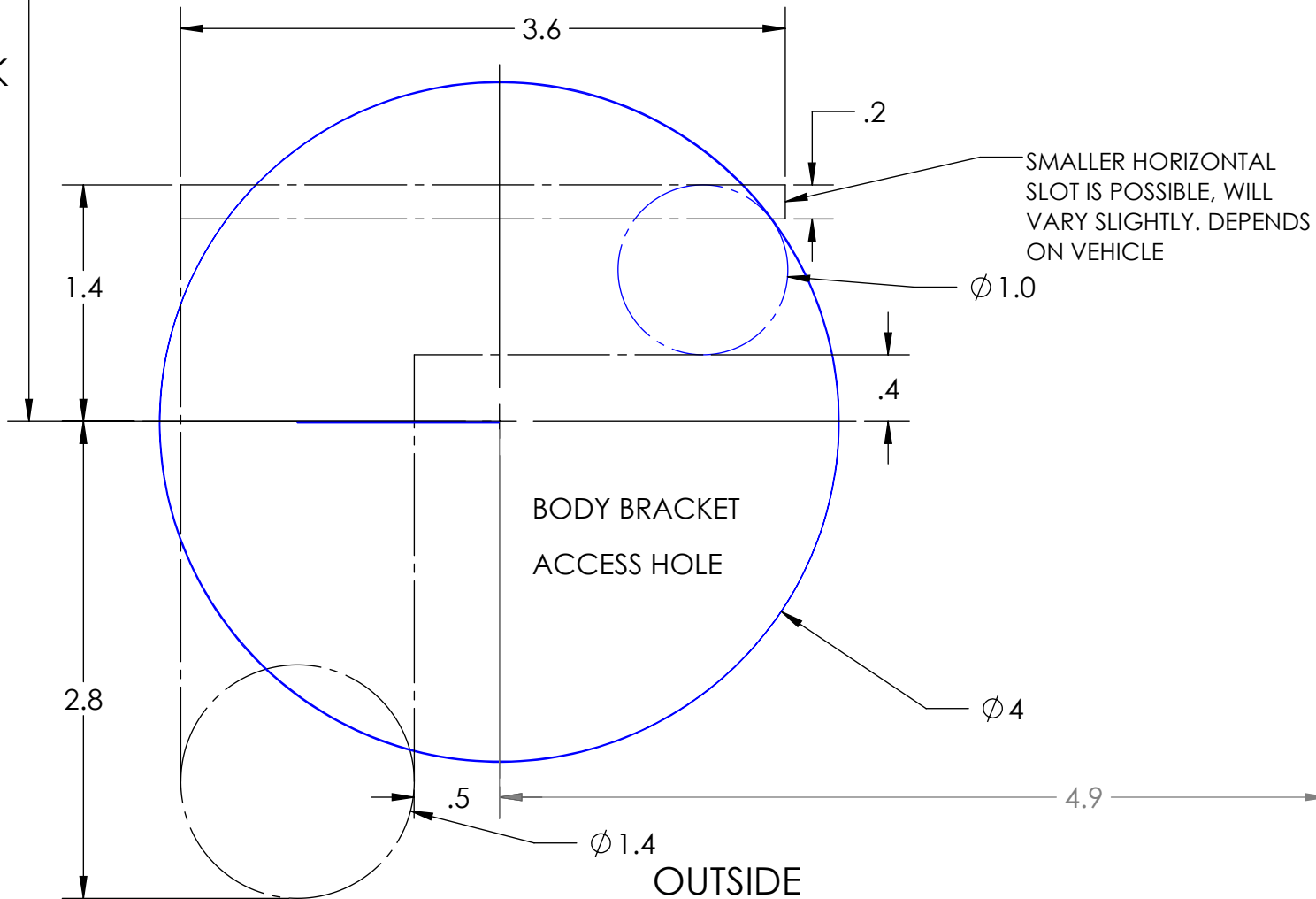



INNER REFERENCE:
ALIGN THIS PAPER EDGE TO
INNER EDGE OF REAR
PLASTIC PANEL

FRONT
REFERENCE:
ALIGN THIS
PAPER EDGE
TO FRONT EDGE
OF REAR
PLASTIC PANEL

PASSENGER SIDE REAR PANEL (1/2)

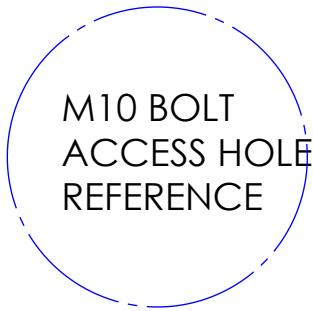

8.1

BACK

SMALLER HORIZONTAL
SLOT IS POSSIBLE, WILL
VARY SLIGHTLY. DEPENDS
ON VEHICLE

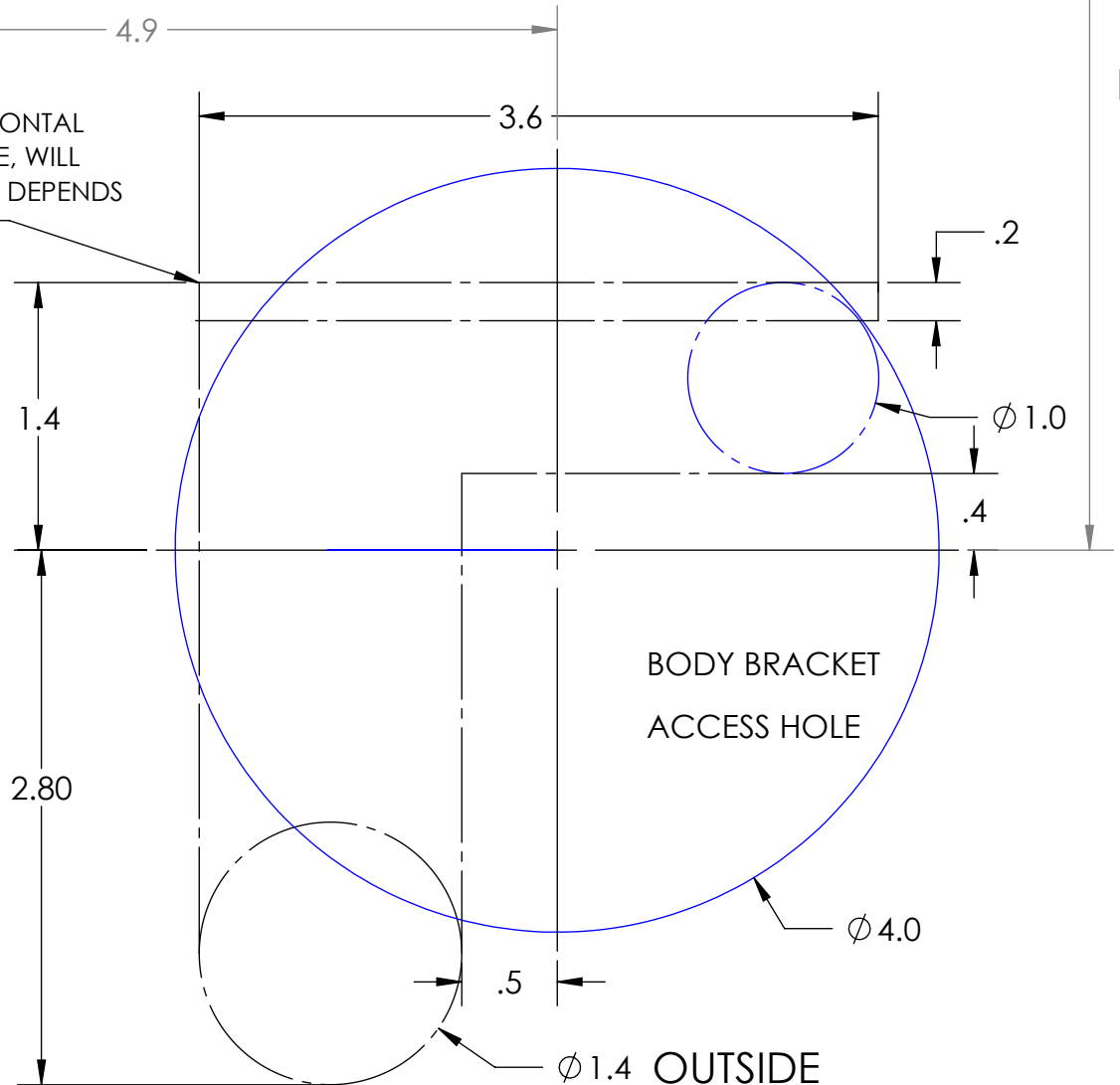



INNER REFERENCE:
ALIGN THIS PAPER EDGE TO
INNER EDGE OF REAR
PLASTIC PANEL

PASSENGER SIDE REAR PANEL (2/2)

