

Quick Operation Guide

WOLONG - CR4355
Behind-the-ear external speaker hearing aid

Please read the rehabilitation plan first

Technical Parameter

| Max.OSPL90 | HF Avg.OSPL90 | Max gain | HFA Gain |
|-------------|-----------------|-----------------|---------------|
| ≤118dB | 105±4dB | ≤50dB | 34±4dB |
| Noise Level | Frequency Range | Battery Current | Total Distort |
| ≤32dB | 500-3500Hz | ≤2mA | ≤3% |

Power On/Off

- Power ON: Take the device out of the charging box.
 - Power OFF: Put the device into the charging box.
- There is a startup announcement of hearing aids.



Please distinguish the right ear from the left ear according to the R/L logo on the external receiver. (L) is on the left and (R) is on the right.



Before using, please remove the insulating film label from the new hearing aid.

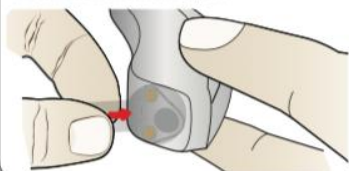

Hearing aid diagram



Accessories diagram



How to replace the earplugs

The hearing aids attach with M size earplugs at the first. If the earplugs cannot fit your ear canal, there will be beep. So please choose the suitable earplugs that fit your ear canal.

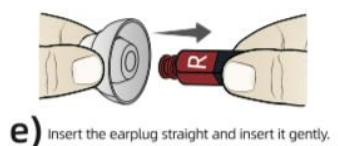
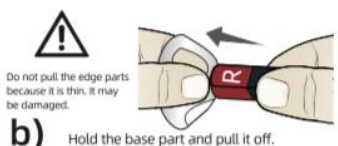
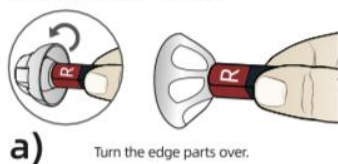

How to wear the hearing aids

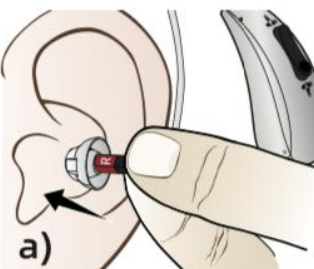

1. Gently insert the earplug into the ear canal.



2. Place the hearing aid behind the ear. The curve of the sound tube should fit comfortably on top of your ear.



If the earplug isn't suitable, there will be gaps, which will cause whistling. Please again choose the suitable earplugs that fit your ear canal.

How to use

Volume adjustment and environmental mode switching.



● Volume adjustment:

Click the up button to increase the volume. Click the down button to decrease the volume. You will hear three beeps, indicating the highest or lowest volume.

● Mode switching:

Long press the up button for 3 seconds, the program is in ascending order. One beep means mode 1 (normal mode). Two beeps mean mode 2 (noise reduction mode). Three beeps mean mode 3 (outdoor mode). Long press the down button, the program will switch in descending order.

There is a memory function of the volume and modes. Restart the hearing aid, the hearing aid will automatically restore the last set volume level and program mode gear.

If you feel there is a whistling sound, please check if the earplug is tight. If it is untight, please replace one.

How to charge

The charging box has a power storage function, and the hearing aid can be charged after being inserted. When the charging box is out of power, a charger needs to be connected to charge the charging box and the hearing aid.

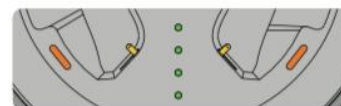
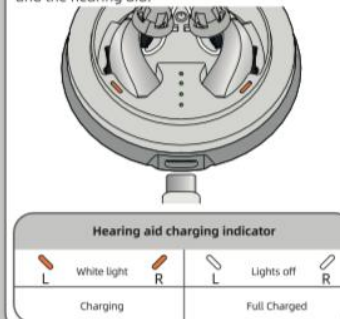

Charging box battery indicator

| 100% | 75% | 50% | 25% |
|---|------|------|------|
| ●●●● | ●●●● | ●●●● | ●●●● |
| When the power of the charging box is less than 25%, the indicator light flashes. | | | |

| | Hearing Aid | Charging Box |
|------------------------|-----------------------|---|
| Battery Specifications | 20mAh Lithium Battery | 280mAh Lithium Battery |
| Charging Time | ≤3h | ≤3h |
| Rated Working Time | ≥18h | 10 Times for Single Unit 5 Times for Two Units |

Maintenance

Keep the hearing aids clean at all time. After use, remove the earplug and clean the sound hole with the brush. Wipe off oil and moisture with tissue paper, etc., and keep the product dry.

1. Clean the sound hole with the brush.



2. Clean the microphone with a cleaning brush.

Troubleshooting

| Problem | Possible Solution |
|------------------------------------|---|
| Sound is distorted | ① Decrease volume. ② Charge the product. ③ Clean the dome. |
| The product emits whistling sounds | ① Reinsert the Earplugs until it fits tightly. ② Decrease volume. ③ Clean the Earplugs. |
| The product does not work | ① Change to different size of Earplugs. ② Check whether the microphone is damaged or not. ③ Charge the product. |
| Can't charge | ① Clean the charging contacts. ② Make sure that the charging contacts are in good contact. |

Consult your Hearing Care Professional or directly contact to us if the problem cannot be solved.

Low battery reminder

There are low battery warning signal beep sounds every one minute until the battery runs out. So please charge the hearing aids when you hear the beep.



How to replace the earwax guard

Please replace the ear guard once every three months. Do not reuse your wax guard once used. The used wax guard filters cannot be attached tightly.

Remove earplugs refer to "How to replace the earplugs".

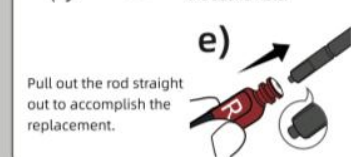
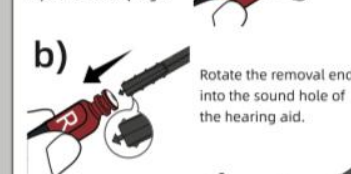

Notes and Tips

1. This product is not waterproof.
2. If the hearing aid is not used for a long time, please charge it every 1-2 months to avoid damage to the battery.
3. The adapter provided in the package is only for hearing aids, please do not use it to charge other devices.
4. Store in a well-ventilated and dry place.
5. Do not use in or near an X ray or MRI machine.

All pictures are for reference only