



Introducing the all NEW CLIM8ZONE™

AN EXPERIENCE YOU WON'T
FIND ANYWHERE ELSE



SPECS

- Ability to heat and cool the water in the spa
- Uses less energy to keep the water hot, providing smart savings
- Directly integrated with the SpaTouch3™ panel
- Unlike other spa heat pumps, Clim8zone™ has the ability to function at low ambient air temperatures down to -20°C/-4°F

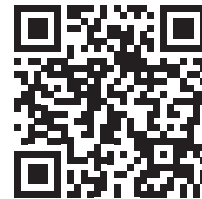

FOR MORE INFORMATION

Visit us online:

www.balboawater.com/Clim8zone

CLIM8ZONE™

THE CLIM8ZONE™ OFFERS USERS THREE TEMPERATURE OPTIONS FOR **HEATING** AND **COOLING** THE SPA WATER

1



Heating & Cooling Mode

Heats and cools the spa water as per the spa user's designed setting in the spa panel.

2



Heating only mode

Heats the spa water.

3



Cooling only mode

Cools the spa water.

AUTO SMART MODE



Default Mode

For heat and cooling



Clim8zone™ Computer

Automatically adjusts the compressor frequency using an artificial intelligence algorithm that is based on ambient air temperature, water temperature and other factors.

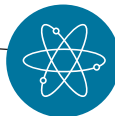

Artificial Intelligence

Built in algorithm automatically adjusts the heat pump for optimal heating/cooling performance and efficiency.



Variable Output

Auto adjust of heating and cooling capacity.

CLIM8ZONE™

OPERATES EFFORTLESSLY FROM THE SPATOUCH3™ PANEL

User adjusts the Set Temperature. The spa System does the rest.

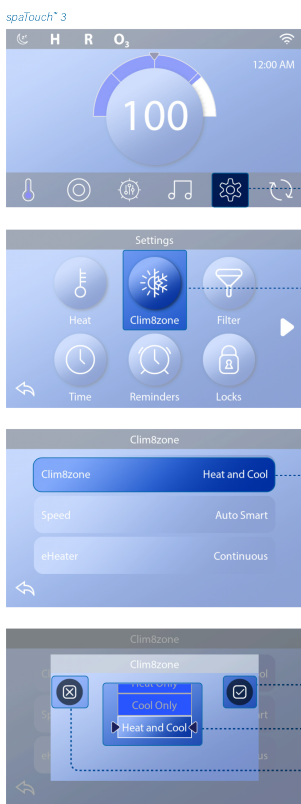

SET THE TEMPERATURE MODE

Follow these steps to set the Temperature mode.

- 1 - Press the Settings button (A) to enter the Settings screen.
- 2 - Press the CLIM8ZONE™ button (B) to enter the CLIM8ZONE™ screen.
- 3 - Press the CLIM8ZONE™ button (C) to enter the CLIM8ZONE™ screen.
- 4 - Select one of the following Temperature modes (E):

- Heat Only**
- Cool Only**
- Heat and Cool (Default Mode)**
- Disabled**

5 - Press the Save button (D) to save your setting. Press the Cancel button (F) to cancel your setting.

Your setting is complete.

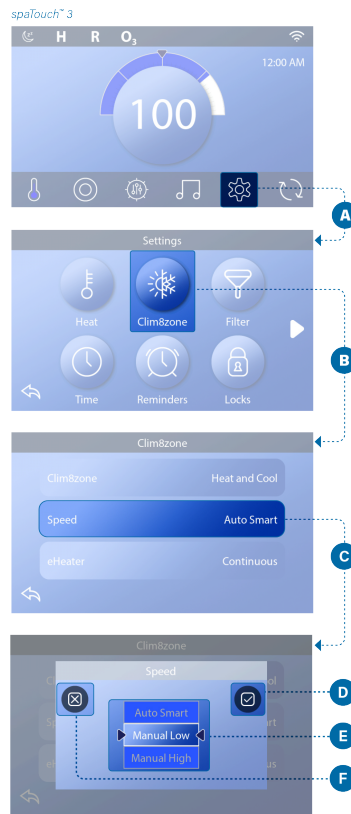

SET THE SPEED MODE

Follow these steps to set the Temperature mode.

- 1 - Press the Settings button (A) to enter the Settings screen.
- 2 - Press the CLIM8ZONE™ button (B) to enter the CLIM8ZONE™ screen.
- 3 - Press the Speed button (C) to enter the Speed screen.
- 4 - Select one of the following Speed modes (E):

- Manual High**
- Auto Smart (Default Mode)**
- Manual Low**

5 - Press the Save button (D) to save your setting. Press the Cancel button (F) to cancel your setting.

Your setting is complete.

