

YOKEKON[®]

YK-MH-2118

User Manual

Thanks for your purchase.
We provide a one-year warranty.
If any quality issues, replacement or refund is available.
Please feel free to contact us via E-mail:

service@yokekon.com



Precautions

Thank you for purchasing our humidifier **YK-MH-2118**.

Please read this manual carefully before using
and keep it for future reference.

All pictures shown are for illustration purposes only.
Actual products may vary due to product enhancement.

Contents

Safety Guide	1-2
Components	3
Placement	4
Installation	5
Water Filling & Accessories Assembly	6
Control Panel & Remote Control	7
Maintenance	8
FAQ	9-10
Product Specifications	11
Warranty Card	12

Safety Guide

- ❶ Please do not disassemble or transform the machine.
- ❷ Please do not let the machine be strongly impacted.
- ❸ Please stop the machine before moving it.
- ❹ Please don't connect the socket that exceeds the rated voltage and don't use the extension cable to avoid fire or electric shock.
- ❺ When the plug or wire is abnormally hot, please stop using it.
- ❻ Please do not unplug the power plug with wet hands, otherwise, it may cause electric shock or injury.
- ❼ Please do not block the outlet or add water to the mist outlet which may cause water leakage, deformation or failure.
- ❽ Please do not use acidic detergent in the main body. If the detergent remains, it may produce toxic gas.
- ❾ Children should use it under the supervision of adults.
- ❿ Please do not deliberately inhale the spray mist, especially for people with sensitive respiratory tract.

Safety Guide

- ❶ Please do not put essential oil into the main body/water tank, which may cause water leakage deformation or failure.
- ❶ Please do not insert your fingers or other things into the water inlet or air outlet or the gap which may cause damage to the machine or electric shock.
- ❶ When not in use for a long time (more than 24 hours), please pour out the water in the water tank and sink to prevent mold or impurities from harming your health.
- ❶ Please leave it at room temperature for 30 minutes before the first use to avoid damage to the water tank due to sudden temperature changes.
- ❶ Please use it at normal room temperature (5°C~40°C).
- ❶ When the room temperature is lower than 0°C, please pour out the water in the water tank and sink to avoid freezing and damaging the machine.

Components

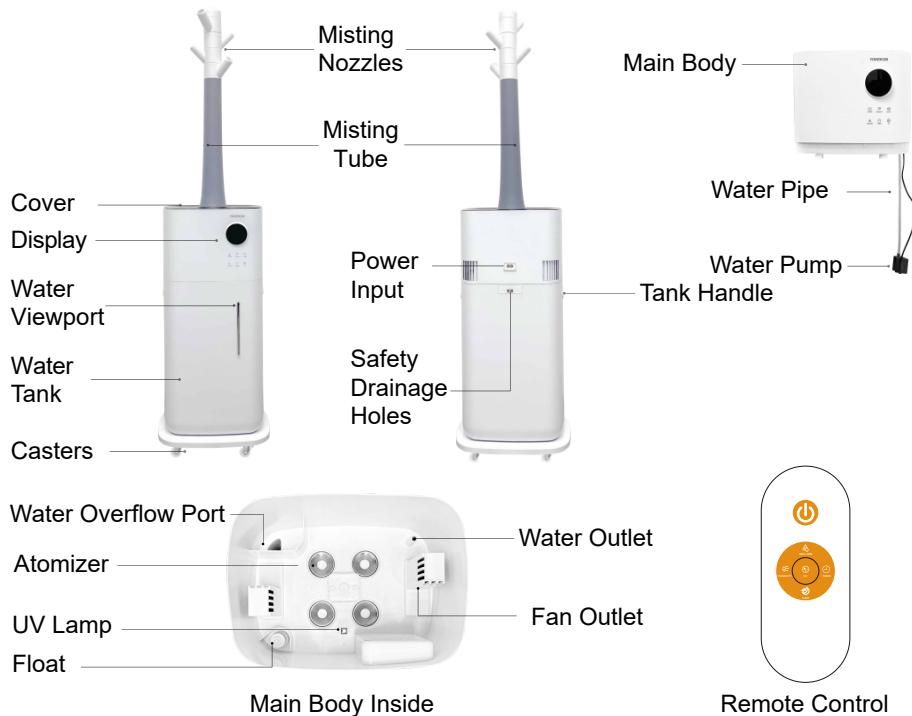

Placement

Please place the humidifier in a horizontal position, at least 50 cm away from walls, furniture, furnace, household appliances, etc.

Please do not use it in the following occasions to avoid water leakage, signal interference or injury, etc.



- ❗ Direct sunlight.
- ❗ On the unstable platform.
- ❗ With high temperatures humidity and dust.
- ❗ Near the air conditioner, furnace, heater and stove.
- ❗ Near mobile phones, computers and other precision instruments.
- ❗ Near the radio and other objects that emit radio waves.
- ❗ Under the table, or on the carpets bedding, etc.

Installation



1. Take off the main body, take out the remote control and other accessories in the water tank.



3. Remove the protective bag from the water pump.

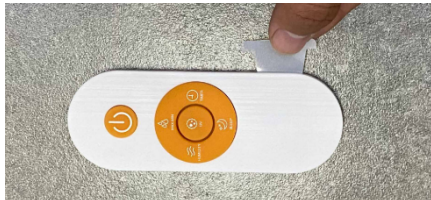

2. Remove the insulating plastic sheet before using the remote control.



4. Place the main body on the water tank properly.

Water Filling & Accessories Assembly



- Open the lid and add water from the top.
- Remove the main body and add water to the water tank directly.

- ❶ Distilled water or RO water is recommended.
- ❶ Please add water below 40°C.
- ❶ Please do not exceed the maximum water mark.
- ❶ Please do not allow water enter the mist outlet or water may enter the inside and cause the machine to malfunction.
- ❶ Please do not add mineral water, plasma water or tap water that has not been used for a long time. If mold or impurities grow, it may cause health problems.
- ❶ When the water is insufficient, the machine will prompt water shortage and automatically shut down. Please refill with water and turn it on.









Control Panel & Remote Control



Display & Buttons



Remote Control

 POWER	Touch the button and the display lights up and the humidifier starts to work.
 MAX-MIN	The mist volume can be adjusted in three levels: low, medium, high.
 HUMIDITY	The humidity can be set between 40-90% in increments of 5%. The humidifier will automatically stop spraying mist when the surrounding humidity reaches the set value.
 SLEEP	Touch the button to enter sleep mode, and the display will be dimmed. Touch any button to exit sleep mode, and the display will light up.
 TIMER	The timer can be set for 1-12 hours in increments of 1 hour. The humidifier will shut down automatically when the time reaches the set value.
 UV	Touch the UV button to turn on/off the sterilization feature.

- ❶ The operation of remote control is the same as the control panel.
- ❷ Please remove the insulating plastic sheet before using the remote control.
- ❸ When turning on the UV light, do not look directly at it for a long time, otherwise it may cause eye discomfort.

Maintenance



Tilt the main body to this side and pour out the water. Take care not to wet the ground.



Clean the water tank with the sponge weekly.



Clean the sink with the sponge weekly.

- ❶ When not in use for a long time (more than 24 hours), please pour out the water in the water tank and sink to prevent mold or impurities from harming your health.
- ❶ Be sure to pull out the power plug before maintaining the humidifier.
- ❶ Do not directly flush the whole machine with water to avoid short circuits and failure.
- ❶ With the use of tap water, minerals and organics may adhere to it, which may cause the function of humidifier to decline or malfunction. If the dirt is not easy to clean, the cloth can be soaked in neutral detergent before wiping.
- ❶ The residue of detergent in the sink and tank should be cleaned up before use.
- ❶ Make sure the main body is completely dry before use.

FAQ

Q: After the power is turned on, the display does not light up.

A: There may be water entering the circuit board. Please air-dry the main body for one day. If it still can't be turned on, please contact customer service by email.

Q: Low mist output.

A: When the ambient humidity exceeds the set value, the machine will stop spraying mist automatically. But if the atomizer is damaged, please contact customer service by email.

Q: Red light flashing.

A: Please open the sink and check whether the water can be pumped up. If not, check whether the water pipe has fallen or broken. None of the above, contact customer service by email.

Q: Abnormal noise.

A: There is too little water in the tank, or the ground is not stable. Please fill water and place the humidifier on a flat and stable surface.

Q: The humidity value is not completely consistent with the room humidity.

A: There is a built-in humidity sensor in the main body. The humidity difference of 5-10 is within the normal range. If not, please contact customer service by email.

FAQ

Q: There is white powder around the humidifier.

A: Tap water contains certain minerals, may adhere to the object, please do not worry and clean the water tank regularly. Keep the precision instrument away from the humidifier to avoid damage to them.

Q: There is scale in the water sink or tank.

A: Tap water contains certain minerals, may adhere to the object, please do not worry and clean the water sink and tank regularly.

Q: Interference with TV remote control signal.

A: Keep the humidifier 1m away from the TV or other objects that emit radio waves.

Q: The floor is wet or there is water around the humidifier.

A: Humidity is too high, or the humidifier is placed in a non-ventilated place, so the mist can not be fully evaporated.

Q: The fire on the stove turned red.

A: Because the composition of the tap water reacts with the flame(Flame reaction), please keep the humidifier away from the stove.

Q: Why didn't the humidifier generate mist?

A: It needs to wait 40-60 seconds to generate mist every refilling.

Product Specifications

Product Name	Ultrasonic Humidifier
Model Number	YK-MH-2118
Operation Mode	Low Medium High
Rated Power	110W
Rated Voltage	110V-240V~
Max Mist Output	2000mL/h
Noise	≤35dB
Tank Capacity	4.49Gal / 17L
Size	295*225*1150mm
N.W.	4.2Kg
Safety Functions	1-12 hours timer
	Waterless auto shut-off
	Automatic shutdown when falling



Warranty Period

- Our company provides a one-year warranty, which starts from the date of purchase.
- When returning the product, please confirm that the product is intact, and the packing boxes and accessories are complete.

Non-Warranty Policy

The following conditions are not covered by the warranty.

- Over the warranty period.
- Damage caused by natural disasters and other force majeure.
- Any damage caused by use not in accordance with the requirements in the User Manual.
- Failure or damage caused by forced use of the product.
- The user disassembles or repairs the product without authorization.

Warranty Requirements

1. Please provide the warranty card and the order number.
2. Please describe the problems in details with pictures or videos.
3. Send e-mail to service@yokekon.com

Sorry that warrant service would not be available if you are unable to provide the above information.

YOKEKON[®]