

Elite 200 V2

Portable Power Station

User Manual v3.0

Important Instructions

For the best experience and performance, fully charge your unit and update to the latest firmware before first use. See the appendix "Update Firmware via BLUETTI App" for guidance.

Read and understand this manual before use and keep it handy for future reference.



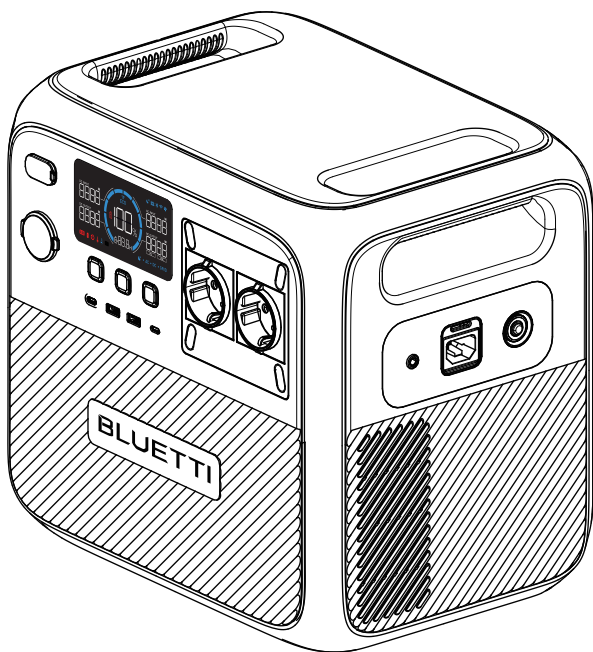

Tips

1. Charge the unit before first use.
2. Do not use solar panels with open circuit voltage higher than 60V. Solar input voltage range for the unit is 12V-60V.
3. If the unit's SoC falls below 5%, please recharge the unit in time. If the SoC drops to 0, power off the unit and charge it for at least 30 minutes before restarting.
4. The unit is for off-grid use only. Do not connect its AC output to the grid.
5. If not used for more than 3 months, charge the unit to 40%-60% SoC and store it with the power off. For optimum battery life, discharge and charge the unit every 3 months.

Legal Information

Copyright © Shenzhen PowerOak Newener Co., Ltd. All rights reserved.

No part of this document may be reproduced or transmitted in any form or by any means without the prior written consent of Shenzhen PowerOak Newener Co., Ltd.

Notice

BLUETTI's products and services are subject to the terms and conditions agreed upon during purchase. Some aspects described in this manual may not be available under your purchase contract. Unless otherwise specified in the contract, BLUETTI makes no express or implied representations or warranties regarding the contents of this manual.

The contents of this manual are subject to change without notice. Please obtain the latest version from BLUETTI official website.

If you have any questions or concerns about this manual, please contact BLUETTI support for further assistance.

Shenzhen PowerOak Newener Co., Ltd.

F19, BLD No.1, Kaidaer, Tongsha RD No.168, Xili street, Nanshan, Shenzhen, China

Website: <https://www.bluettipower.com>

Contents



- 1 Safety Information 05
- 2 What's in the Box 08
- 3 Get to Know Your Elite 200 V2 09
 - 3.1 Elite 200 V2 Overview 09
 - 3.2 Display Screen 10
- 4 Use Your Elite 200 V2 11
 - 4.1 Power On/Off 11
 - 4.2 Charging 12
 - 4.3 Power Your Devices 14
- 5 Configure Your Elite 200 V2 15
 - 5.1 Setting Mode 15
 - 5.2 AC Charging Mode 16
 - 5.3 Power Lifting Mode 16
 - 5.4 ECO Mode 16
- 6 View Device Information 17
- 7 UPS Feature 17
- 8 Grid Self-adaption Mode 19
- 9 Adjust Grid Input Current 20
- 10 System Switch Recovery 20
- 11 Maintenance and Care 21
- 12 Specifications..... 22
- 13 Troubleshooting & FAQ..... 23
- Appendix 24
- Compliance 27

1. Safety Information

INSTRUCTIONS PERTAINING TO RISK OF FIRE, ELECTRIC SHOCK, OR INJURY TO PERSONS

WARNING - When using the product, basic precautions should always be followed, including the following:

- Read all the instructions before using the product.
- Handle the product with care, avoiding drops, violent impacts, or tilting.
- To reduce the risk of injury, close supervision is necessary when the product is used near children.
- Do not put fingers or foreign objects into the product's ports.
- Use of an attachment not recommended or sold by the manufacturer may result in a risk of fire, electric shock, or injury to persons.
- Do not move the product during operation to avoid poor connections.
- Do not expose the battery to high temperatures, as this may cause an explosion or leakage of flammable liquids or gases.
- Do not use the product in the rain or high humidity environments.
- Do not use a battery pack or appliance that is damaged or modified. Damaged or modified batteries may exhibit unpredictable behavior resulting in fire, explosion or risk of injury.
- Handle the product with caution in low air pressure environments to prevent explosions or leaks.
- Charge the product in a well-ventilated area.
- Under abusive conditions, liquid may be ejected from the product's battery; avoid contact. If contact accidentally occurs, flush with water. If liquid contacts eyes, additionally seek medical help. Battery liquid may cause irritation or burns.
- In case of fire, use a dry powder fire extinguisher appropriate for the product.
- Never dispose of the product's battery in fire, hot ovens, or by cutting it.
- Do not operate the product with a damaged cord, plug, or output cable.
- To reduce the risk of damage to the electric plug and cord, pull the plug rather than the cord when disconnecting the product.
- Do not disassemble the product; take it to a qualified service person if service or repair is required. Incorrect reassembly may result in a risk of fire or electric shock.
- Unplug the product before any servicing to prevent electric shock.
- **WARNING - RISK OF EXPLOSIVE GASES.** Follow these instructions and those published by manufacturer of any equipment you intend to use in vicinity of the product to reduce risk of battery explosion.

- **WARNING - RISK OF ELECTRIC SHOCK.** Never use the product to power tools to cut or access live parts, wirings or materials containing them, such as building walls.
- Have servicing performed by a qualified repair person using only identical replacement parts. This will ensure that the safety of the product is maintained.
-   The symbols on unit and its accessories are intended to remind you to read the instructions in the literature accompanying the product before operation and maintenance.
- The socket-outlet should be installed near the product and easily accessible for safety purposes.
- **Caution:** The output of USB-C port is classified as PS3 according to standard IEC 62368-1. Consider implementing safeguards against fire, such as a fire enclosure, for connected equipment or accessories.

Attention



Not permitted on aircraft.

- When charging with lead-acid batteries or using the product to charge them, follow these safety precautions:
 - a. Wear eye and clothing protection; do not touch eyes when working near a battery.
 - b. No smoking, sparks, or flames near the battery or engine.
 - c. Avoid dropping metal tools onto the battery to prevent sparks or short circuits.

Disposal and Recycling

1. Take old electronic components and batteries to designated recycling centers. This prevents improper disposal and supports material recovery.
2. If possible, fully discharge the batteries and then place them in designated battery recycling boxes. The batteries in this product contain hazardous chemicals. Do not dispose of them with regular household waste. Please follow local laws and regulations for proper battery disposal.
3. If a battery cannot fully discharge due to product malfunction, do not place it in the battery recycling box. Instead, contact a professional battery recycling organization for safe handling.

Grounding Instructions (For AC charging only)

- This product must be grounded when connected to the grid. If this product should malfunction, grounding provides a path of least resistance for electric current to reduce the risk of electric shock.
- The product is equipped with an AC charging cable having an equipment grounding conductor and a grounding plug. The plug must be plugged into an appropriate outlet that is properly installed and grounded in accordance with all local codes and ordinances.
- **WARNING** - Improper connection of the grounding conductor can result in a risk of electric shock. Check with a qualified electrician if you're in doubt as to whether the product is properly grounded. Don't modify the plug provided with the product – if it'll not fit the outlet, have a proper outlet installed by a qualified electrician.

SAVE THESE INSTRUCTIONS

2. What's in the Box



Elite 200 V2
Portable Power Station

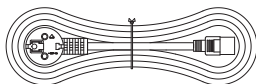

AC Charging Cable
Type B plug - Type A plug
(59.06in / 1.5m)

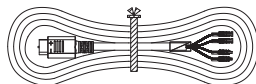

Solar Charging Cable
MC4 - XT60
(59.06in / 1.5m)



Grounding Screw



Documentation

The following accessories are not included.

Please purchase optional accessories below at <https://www.bluetipower.com>

Note: All images are for reference only.

Optional Accessories

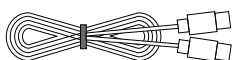

USB-C to USB-C Cable
(78.74in / 2m)

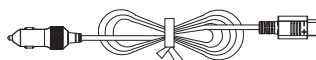

Car Charging Cable
Cigarette Lighter Plug - XT60(F)
(28.35in / 0.72m)



12V DC Power Cable*
Cigarette Lighter Plug - DC5521 (F)
(28.35in / 0.72m)



Lead-acid Battery Charging Cable
Cigarette Lighter Plug - Clamps
(19.69in / 0.5m)

* Used to charge devices with DC5521 input using Elite 200 V2's cigarette lighter port.

3. Get to Know Your Elite 200 V2

3.1 Elite 200 V2 Overview

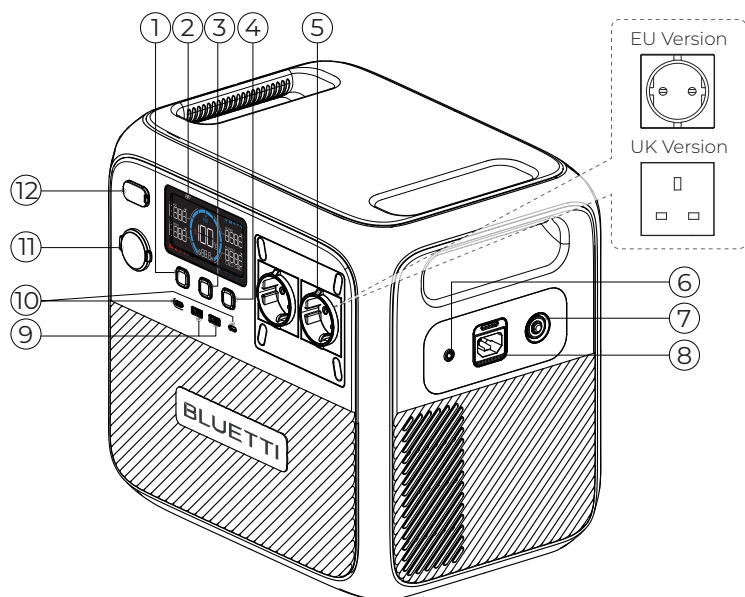

- | | |
|-----------------------|---------------------------------------|
| ① DC Power Button | ⑦ Circuit Breaker |
| ② LCD Display | ⑧ AC Input |
| ③ Power Button | ⑨ USB-A Ports |
| ④ AC Power Button | ⑩ USB-C Ports |
| ⑤ AC Outlet | ⑪ Cigarette Lighter Port (Car Outlet) |
| ⑥ Grounding Terminal* | ⑫ DC Input |

* Used for grounding when powering certain equipment. For assistance, contact us or seek guidance from the appendix "Grounding Guidelines".

3.2 Display Screen

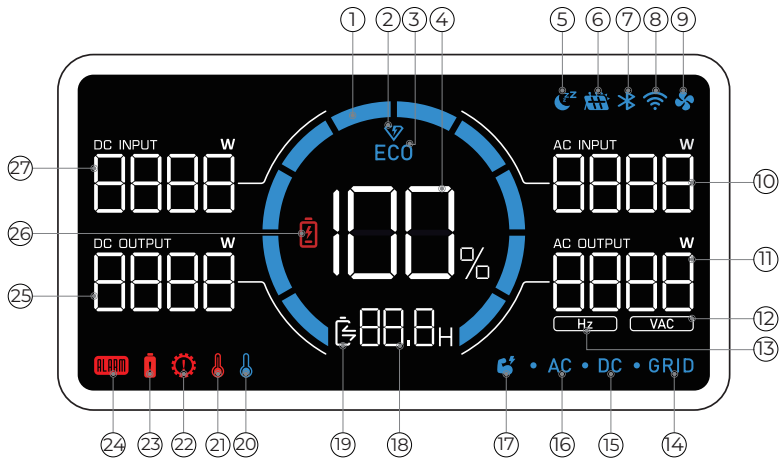

- | | | |
|-------------------------|----------------------|--------------------|
| ① Progress Bar* | ⑩ AC Input Power | ⑲ Battery Status* |
| ② Turbo Charging | ⑪ AC Output Power | ⑳ Low Temperature |
| ③ ECO Mode | ⑫ Inverter Voltage | ㉑ High Temperature |
| ④ State of Charge (SoC) | ⑬ Inverter Frequency | ㉒ Overload |
| ⑤ Silent Charging | ⑭ AC Input* | ㉓ Overcurrent |
| ⑥ DC Input* | ⑮ DC Output* | ㉔ System Fault |
| ⑦ Bluetooth Connection | ⑯ AC Output* | ㉕ DC Output Power |
| ⑧ WiFi Connection | ⑰ Power Lifting Mode | ㉖ Low Battery* |
| ⑨ Fan* | ⑱ Remaining Time* | ㉗ DC Input Power |

* Progress Bar: Fill up while charging and deplete while discharging.



DC Input: Charges from solar panels, cars, or lead-acid batteries.

Fan: Flashing for abnormal fan operation.

AC Input: Charges from a wall outlet or generator.

DC/AC Output: Output is active.

Remaining Time: Remaining charging or discharging time.

Battery Status:  for charging,  for discharging.

Low Battery: SoC below 5%. CHARGE THE UNIT IN TIME.

4. Use Your Elite 200 V2

4.1 Power On/Off

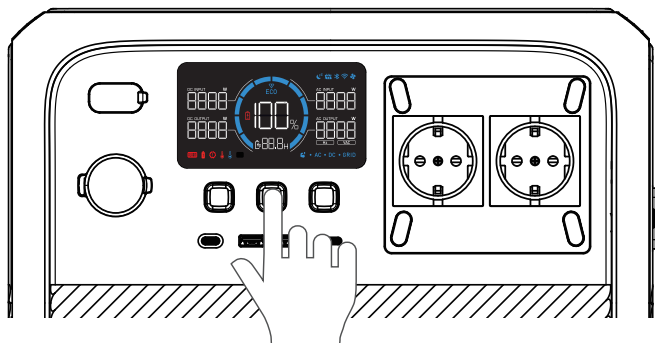

Power On

Press the power button; the lit button indicates that the Elite 200 V2 is on standby.

Power Off

Long press the power button for about 2 seconds to turn off the unit.

AC On/Off

Press AC power button when Elite 200 V2 is on.

DC On/Off

Press DC power button when Elite 200 V2 is on.

Note:

- When Elite 200 V2 is on, press the power button to turn on/off the display.
- If there is no DC or AC output for over one minute, the Elite 200 V2 automatically powers off.
- By default, the display turns off after one minute of inactivity. You can adjust the sleep time via the app.

4.2 Charging

AC Charging (Wall Outlet)

Plug the Elite 200 V2 into a standard wall outlet. It stops charging when fully charged to prevent overcharging. For quicker charging, enable Turbo Charging in the app. This lets the Elite 200 V2 reach 80% charge in approximately 1 hour and 100% in about 1.4 hours, at an ambient temperature of 25°C (77°F).

Note: Do not plug the unit's AC charging cable into its own AC outlets. Doing so could damage the connected device.

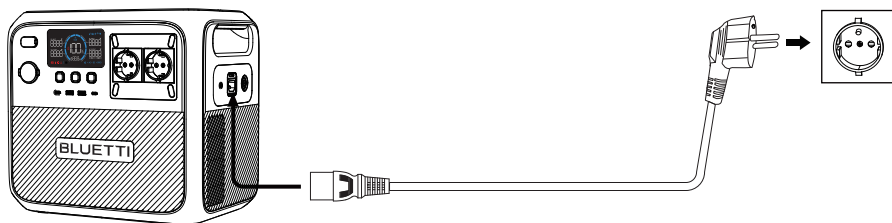

Car Charging

Connect the Elite 200 V2 to your car's 12V or 24V cigarette lighter port or socket using the car charging cable. It charges at up to 96W with a 12V port and 192W with a 24V port.

Note:

- Make sure your car has power and the engine is running while charging.
- The Elite 200 V2 has a safety feature that stops charging when your car's battery is too low, preventing the battery from being over-discharged.

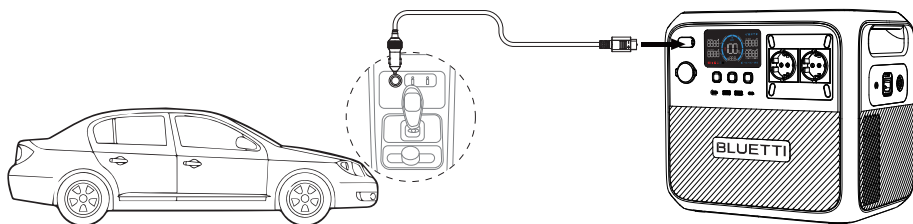

Solar Charging

Connect the solar panel(s) either in series or parallel, and use the solar charging cable to link them to Elite 200 V2. With a continuous input of 1,000W, the Elite 200 V2 reaches full capacity in about 2.4 hours.

Note:

- Make sure the solar panel(s) meets the following requirements:
Voc: 12V-60V Current: 20A Max. Power: 1,000W Max.
- For faster charging, use the two MC4 connectors on the DC input cable. They will be connected in parallel. Ensure that both sets of MC4 connectors use solar panels of the same power rating and type. For example, if one set uses two 200W (20V/10A) solar panels in series, the other set should also use two 200W (20V/10A) solar panels of the same type in series. The maximum allowed current for a single MC4 input is 10A.

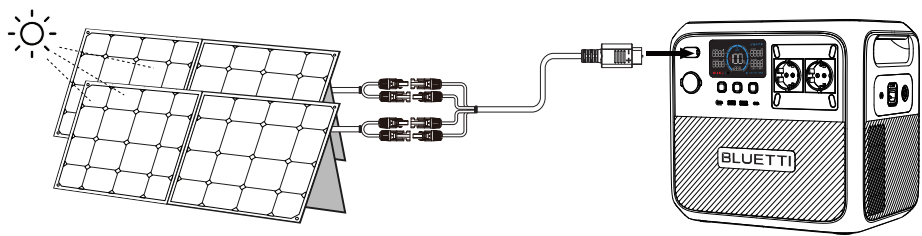

In the app, set the DC input source to "PV" or "other" in the advanced mode. The charging strategies for these two sources are shown below:

DC Input Source	Advanced Mode Settings	Non-Advanced Mode Settings
PV	$11V \leq U^* \leq 16V, I^* \leq 8.2A$ $16V < U \leq 60V, I \leq 20A$	$11V \leq U \leq 30V, I \leq 8.2A$ $30V < U \leq 60V, I \leq 20A$
other	/	

* U: Solar input voltage; I: Input current

Generator Charging

Connect the Elite 200 V2 to a generator using the AC charging cable. The charging stops automatically when fully charged.

Note:

- Make sure the generator delivers a pure sine wave output with matching voltage and frequency.
- It's recommended to enable the Grid Self-Adaption mode when charging the Elite 200 V2 with a generator.

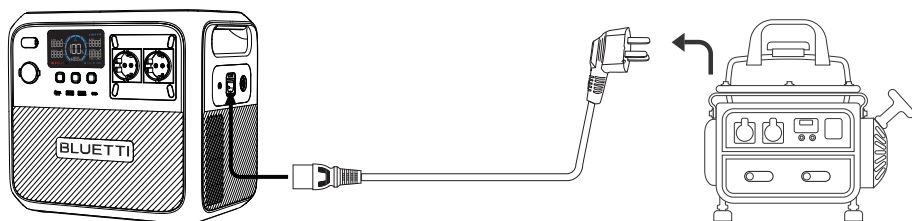

4.3 Power Your Devices

AC Outlets

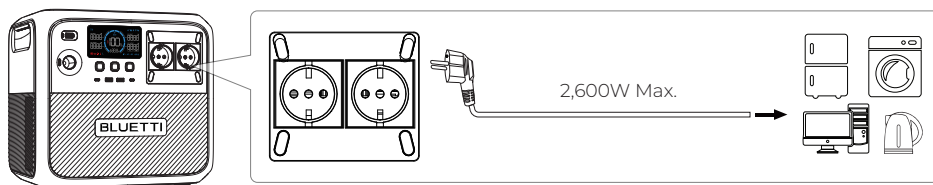

Note: When servicing the devices connected to the unit, remember to unplug them from the outlets. Even if the AC output is turned off, physically unplugging the devices is necessary for complete disconnection.

DC Outlets

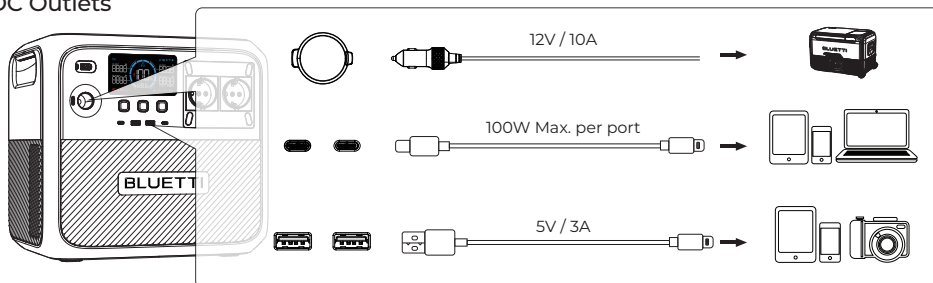

5. Configure Your Elite 200 V2

Press AC or DC button to switch frequencies, toggle WiFi and Bluetooth, and activate modes like Power Lifting, Standard and Silent Charging, and ECO. For advanced settings and features - such as Grid Self-Adaption mode, UPS mode, setting the maximum grid input current, and detailed ECO mode settings - use the BLUETTI app. Refer to the app manual for more details.

5.1 Settings Mode

Enter the Mode: Press and hold the AC and DC power buttons simultaneously for about 2 seconds. The frequency icon flashes.

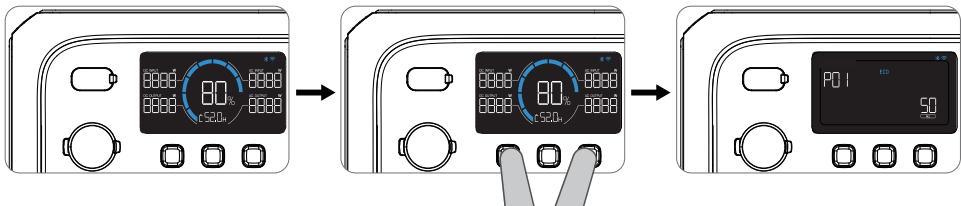

Exit the Mode: Press and hold both the AC and DC power buttons again. If left idle for 1 minute, the Elite 200 V2 automatically exits without saving any changes.

Adjust settings in Settings Mode.

- Turn off the AC power before setting the frequency.
- Press the DC power button to navigate through the items, and press the AC power button to adjust.

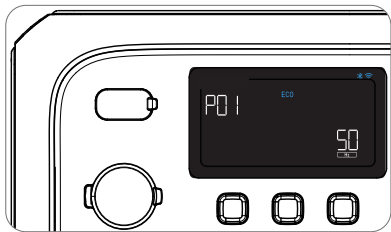

Page Code	Setting
P01	Frequency
P03	Charging Mode
P04	Power Lifting Mode
P05	ECO Mode
P06	Bluetooth
P07	WiFi

5.2 Charging Mode

The Elite 200 V2 offers three charging modes: Standard, Turbo, and Silent. Set Standard and Silent modes directly on the display, and use the app to activate Turbo mode. By default, the unit charges in Standard mode.

Mode	AC Input	Solar Input	AC + Solar Input	AC Charging Time (Estimated)	Note
Standard	1,200W Max.	1,000W Max.	1,200W Max.	2 hrs	Battery-friendly
Turbo	2,300W Max.	1,000W Max.	2,400W Max.	80% in 1 hour, 100% in 1.5 hrs	Quick recharge
Silent	800W Max.	800W Max.	800W Max.	3 hrs	16dB to 30dB

Note: The data above is for reference only. Noise levels were tested at an ambient temperature of 25°C (77°F) and may vary based on the environment, distance, and operating power.

5.3 Power Lifting Mode

Power Lifting mode is disabled by default. It allows Elite 200 V2 to power up to 3,900W pure resistive loads like kettles, electric blankets, hairdryers, and similar heating devices.

Note: This mode is only for pure resistive loads rated 2,600W-3,900W. While the Elite 200 V2 can handle such loads, its actual output power is still 2,600W.

5.4 ECO Mode

AC-ECO and DC-ECO modes are enabled by default. The Elite 200 V2 shuts off the AC or DC output after a period of low or no load.

Note:

- AC-ECO mode is not available when charging with AC power.
- Press the AC power button to turn on/off AC-ECO and DC-ECO Modes together, and use the BLUETTI app to control them separately.
- Disable the ECO mode when connecting small devices under 60W or critical appliances such as lights and refrigerators.

6. View Device Information

View device information in Setting Mode, too.

- Go to the P01 frequency page and long press the DC power button to view the unit's SN. Press the DC power button again to navigate through other information.
- When on Fault History page, long press the AC power button for about 2 seconds, then release to clear the history.

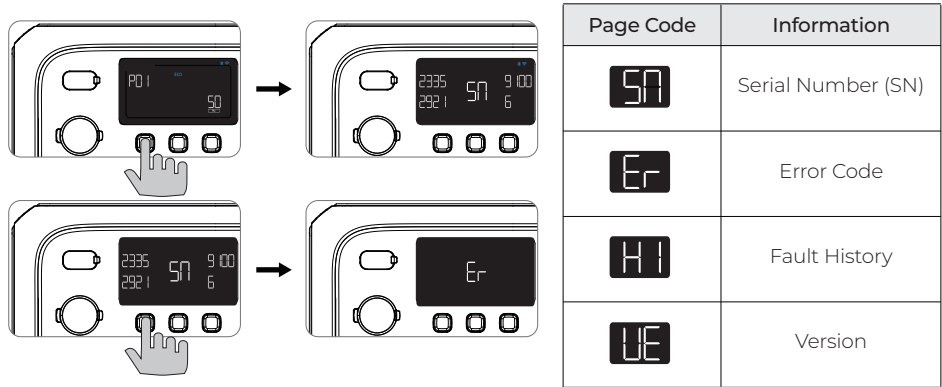

7. UPS Feature

Connect Elite 200 V2 to the wall, and it directly draws power from the outlet to operate connected devices. It swiftly switches to battery power within 15 ms during an outage. Set UPS modes in the app.

• Standard

Elite 200 V2 charges using available solar and grid power, with a priority on solar.

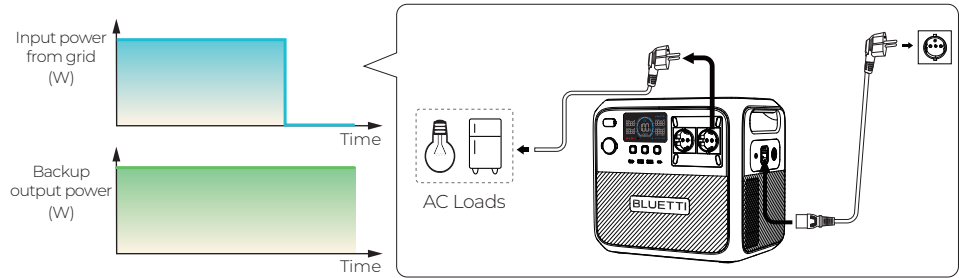

• Time Control

Save costs by scheduling Elite 200 V2 to charge during off-peak hours and power devices during peak hours.

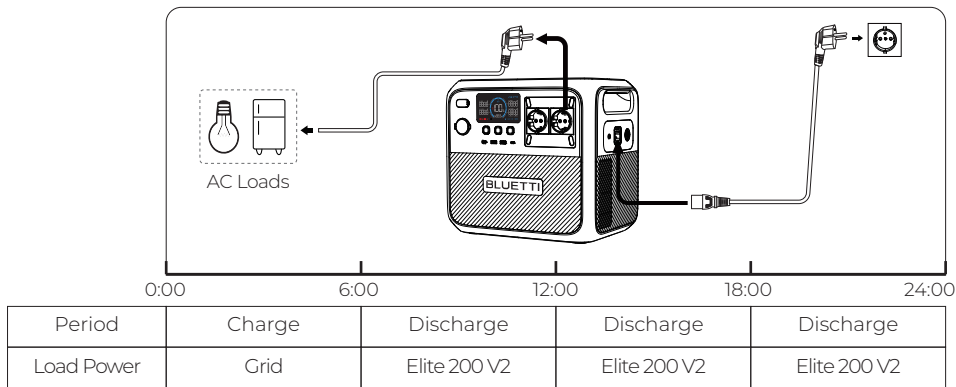

• PV Priority

Efficiently uses solar energy. Elite 200 V2 initially charges from the grid to a set SoC and seamlessly switches to solar replenishment.

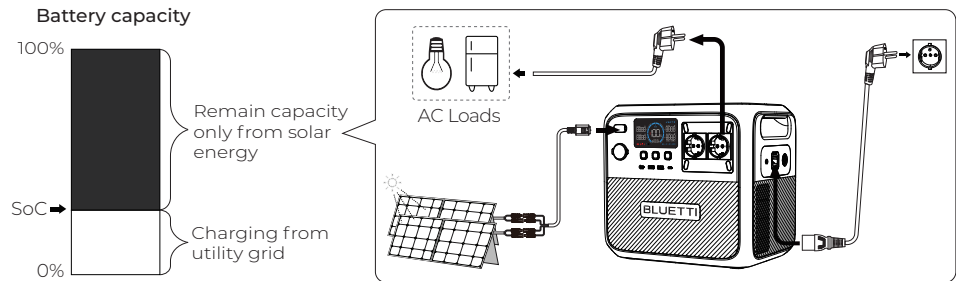

• Custom

Personalize charging/discharging schedule, set battery SoC limits, and control the schedule and grid input switches.

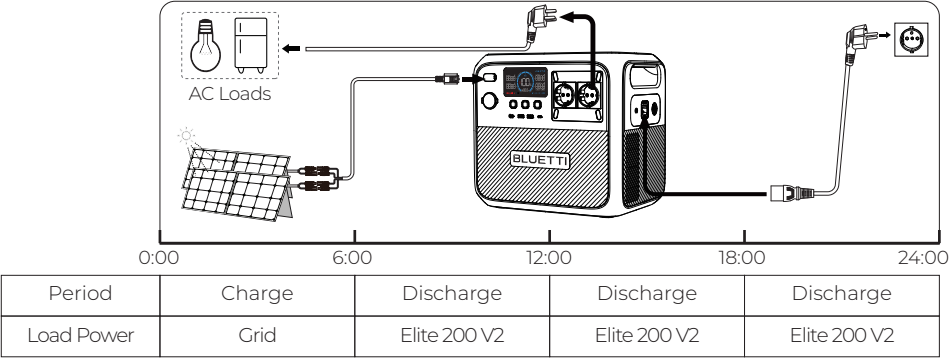

Attention: Not for devices like data servers or workstations that require high-performance UPS. BLUETTI assumes no liability for issues arising from violating this restriction.

8. Grid Self-adaption Mode

When charging with an unstable generator or grid power, or if consumption power exceeds charging power, enable this mode in the app. The Elite 200 V2 automatically adjusts to handle power fluctuations, protecting the unit and connected devices from potential issues due to variations in power quality.

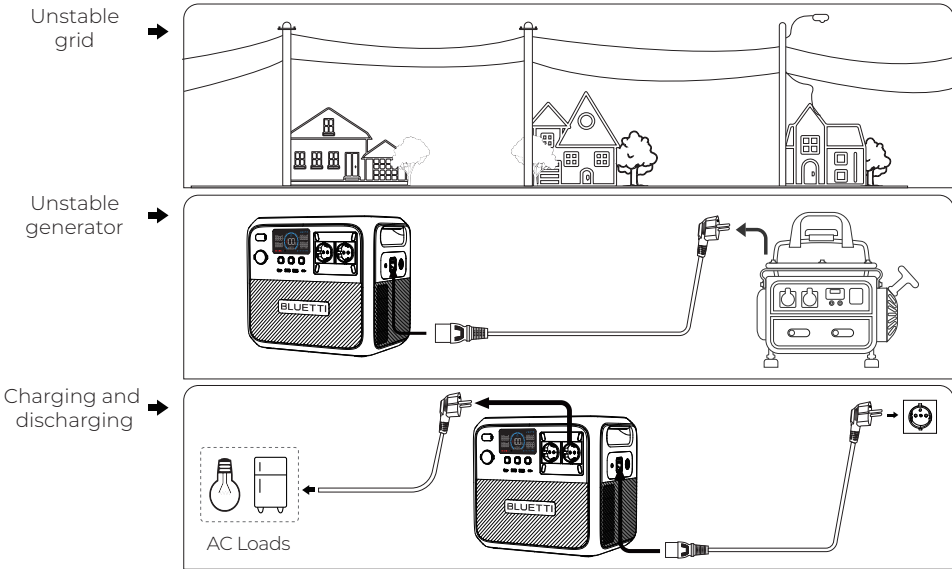

9. Adjust Grid Input Current

The default maximum grid input current is 12A.

Note: If the current is set above 10A, the Elite 200 V2 switches to Turbo charging mode. For settings of 10A or below, it switches to Standard charging mode.

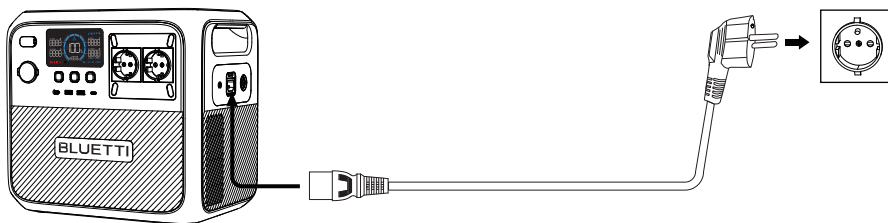

10. System Switch Recovery

When the battery runs out and the unit shuts down, it saves the ON/OFF status of the AC and DC power buttons.

- If connected to grid power, the saved settings will automatically restore when the battery reaches 5%.
- If not connected to grid power, the settings will only restore if the battery reaches 5% and at least 30 minutes have passed since the unit turned off.

For example, in standard UPS mode, if a refrigerator is plugged into the AC outlet of the Elite 200 V2 and the grid power goes out, the unit will provide immediate backup power. If the battery depletes, the unit will shut off but retain the AC output status as ON. When grid power returns and the battery is above 5%, the unit will automatically turn the AC output back ON to continue powering the refrigerator.

Note:

- During recovery, the AC and DC output settings can be adjusted via the app.
- To restore power immediately, turn off this feature.

11. Maintenance and Care

- If the unit's SoC falls below 5%, please recharge the unit in time.
- Before storing, charge to 40%-60% SoC, then power off and disconnect all cables.
- Store it in a cool, dry place, away from flammable materials.
- Safe storage temperature: -10°C to 40°C (14°F to 104°F). For storage over a month, keep it below 35°C (95°F).
- Fully cycle every 6 months to maintain battery health.
- Avoid extended storage; it may impact performance and lifespan.

If SoC drops to 0 during storage or startup:

- Shut down immediately.
- Charge within 48 hours.
- Keep it at 5°C to 35°C (41°F to 95°F) for 6 hours before charging.
- Recommended to charge via an AC source; if using solar energy, ensure an input of over 100W.

12. Specifications

Model	Elite 200 V2 (CN)		Elite 200 V2 (EU / UK / AU / SA)	
Battery Capacity	2,073.6Wh (54Ah)			
Battery Type	LiFePO ₄			
Weight	24.2kg (53.35lbs)			
Dimensions (L × W × H)	350 × 250 × 323.6mm (13.78 × 9.84 × 12.74in)			
Charging Temperature	0°C to 40°C (32°F to 104°F)			
Discharging Temperature	-20°C to 40°C (-4°F to 104°F)			
Storage Temperature	Up to 1 month: -10°C to 40°C (14°F to 104°F) More than 1 month: -10°C to 35°C (14°F to 95°F) Before storage, keep the unit's SoC between 40% and 60%. Fully cycle it every 6 months. For transport, keep it at 25°C (77°F).			
Operating Humidity	10% to 90%			
AC Output	2,600W in total, 220V, 11.8A 50Hz / 60Hz		2,600W in total, 230V, 11.3A 50Hz / 60Hz	
DC Output				
Cigarette Lighter Port	12V / 10A			
2 × USB-A	5V / 3A			
2 × USB-C (PD 3.0)	100W Max. per port, 5V / 3A, 9V / 3A, 12V / 3A, 15V / 3A, 20V / 3A, 20V / 5A			
AC Charging	220V, 10A Max., 50Hz / 60Hz 2,200W Max.(80% in 1 hr, 100% in 1.4 hrs @10°C to 30°C)		230V, 10A Max. , 50Hz / 60Hz 2,300W Max.(80% in 1 hr, 100% in 1.4 hrs @10°C to 30°C)	
AC Input	2,200W Max. (Charging + Bypass)		2,300W Max. (Charging + Bypass)	
DC Input (XT60PM-M)	1,000W Max., 12V to 60V, 20A Max.			
AC + DC Input	2,400W Max.			
Uninterruptible Power Supply (UPS)				
Switchover Time	≤15 ms			
Noise	16dB to 50dB			
Radio Frequency				
	Operating Frequency	Maximum Transmit power	Modulation mode	
BLE5.0	2402MHz~2480MHz	-2.26dBm	GFSK	

13. Troubleshooting & FAQ

On the Error Code page, the **E_r** and error code appears simultaneously on the screen. See the table below for guidance.

Error Code	Description	Solution
E001	Inverter overload	<ul style="list-style-type: none"> • Check device power usage. • Reduce load if too high.
E002	Inverter overtemperature protection, AC output off	<ul style="list-style-type: none"> • Wait 10 mins for the unit to cool down. • Turn on the AC output again.
E003	Inverter short circuit	<ul style="list-style-type: none"> • Check device power usage. • Check devices for short circuits.
E026	Unit overload	<ul style="list-style-type: none"> • Check if the AC and DC output is above 2,800W.
E033	PV overvoltage	<ul style="list-style-type: none"> • Ensure the PV input voltage is within 12V-60V.
E039	PV overtemperature	<ul style="list-style-type: none"> • Wait 10 mins for the unit to cool down. • Re-enable the PV input.
E065	DC output short circuit	<ul style="list-style-type: none"> • Check device power usage. • Check devices for short circuits.
E067	DC output overcurrent	<ul style="list-style-type: none"> • Check device power usage. • Reduce load if too high.
E068	DC output overtemperature	<ul style="list-style-type: none"> • Wait 10 mins for the unit to cool down. • Restart your devices.
E085	Charging temperature too high	<ul style="list-style-type: none"> • Wait for the unit to cool down before charging it again.
E086	Charging temperature too low	<ul style="list-style-type: none"> • Place the unit in an ambient temperature range of 0°C to 40°C (32°F to 104°F).
E087	Discharging temperature too high	<ul style="list-style-type: none"> • Wait for the unit to cool down before using it again.
E088	Discharging temperature too low	<ul style="list-style-type: none"> • Place the unit in an ambient temperature range of -20°C to 40°C (-4°F to 104°F).
E113	Grid overvoltage	<ul style="list-style-type: none"> • Verify home grid voltage. • Contact utility company if necessary.
E114	Grid undervoltage	<ul style="list-style-type: none"> • Verify home grid voltage. • Contact utility company if necessary.
E115	Grid overfrequency	<ul style="list-style-type: none"> • Verify home grid frequency. • Contact utility company if necessary.
E116	Grid underfrequency	<ul style="list-style-type: none"> • Verify home grid frequency. • Contact utility company if necessary.
Others	/	<ul style="list-style-type: none"> • Contact BLUETTI support for help.

FAQ (Frequently Asked Questions)

Q1: How do I know whether my devices will work with this product?

A: Keep the total AC power below 2,600W. Some devices with motors or compressors may start at 2-4 times their rated power, which could easily overload the Elite 200 V2.

Q2: Can I use third-party solar panels to charge this product?

A: Yes, you can use third-party solar panels with open circuit voltage of 12V-60V and MC4 connectors. Avoid mixing different types of solar panels.

Q3: Can it charge and discharge at the same time?

A: Yes, the Elite 200 V2 supports pass-through charging.

Q4: Why is the charging power often too low?

A: The built-in BMS adjusts the charging power based on battery temperature and SoC to protect the battery and extend its life.

Q5: How to calculate the operation time?

A: Operation time = Battery Capacity x DoD x η ÷ (Load + Elite 200 V2 Self-consumption)

Note: DoD (Depth of Discharge) is 95%. η (inverter efficiency) is over 90%. The Elite 200 V2 self-consumption is about 13W.

Q6: Why does a warning come up when using a diesel heating pump with the cigarette lighter port?

A: The pump may require more initial power to start. Use a compatible adapter to start and run the pump with our AC outlets.

Appendix

Update Firmware via BLUETTI App

Keeping firmware updated is IMPORTANT for optimal performance. For detailed instructions, refer to the app user manual in the app.

1. Download the BLUETTI app

Scan the QR code or search for "BLUETTI" in the App Store or Google Play to download the app.

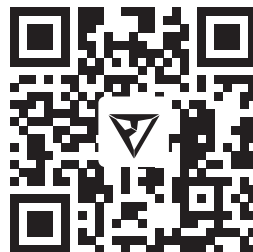

2. Log in or sign up

Log in with a BLUETTI account. If there is no account, create one by following the on-screen instructions.

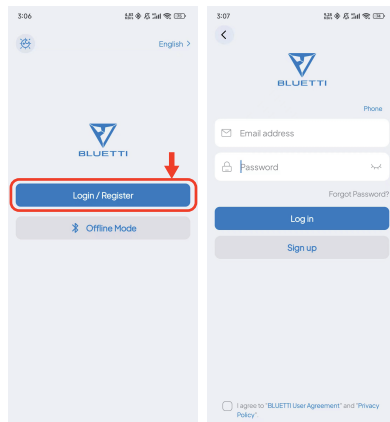

3. Bind the unit

- Tap Add Device directly or access My Devices > Add Device to start the process.
- Select the unit from the available device list, or choose Add Manually and enter the unit's serial number (SN).
- Alternatively, tap Scan on the Home page or in Add Device page to bind via QR code.

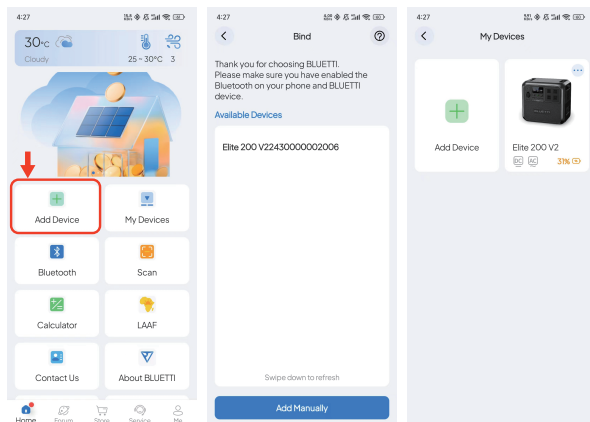

4. Connect via Bluetooth

On the My Devices page, tap the unit and select Bluetooth as the connection method.

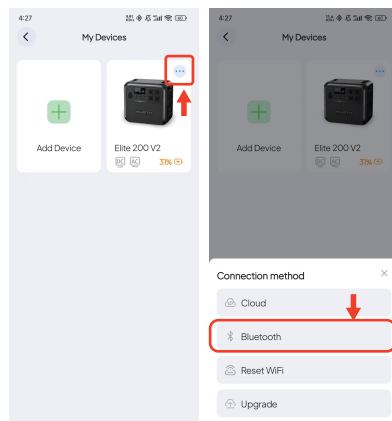

5. Check for Firmware Updates

Tap **Upgrade** to access the Upgrade page.

The app will check for the latest firmware version available for the unit.

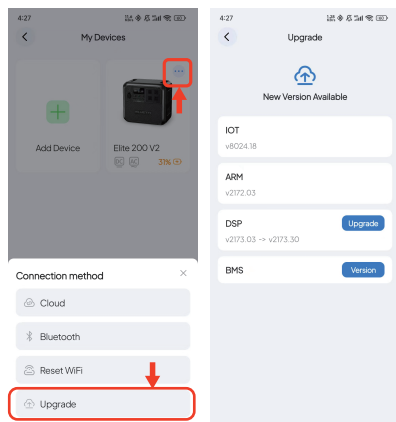

6. Download and Install the Update

If a new firmware update is available, tap

Upgrade and follow the on-screen instructions.

Note:

- Ensure the unit remains powered on and connected during the update.
- Keep your phone and the unit close together (recommended range: 5m / 16.4ft).
- Do not exit app until done.

Grounding Guidelines

Only use the grounding terminal when the product is connected to the home grid using a 2-pin cable, or if the wall outlet's grounding is ineffective, and the connected device features a metal case.

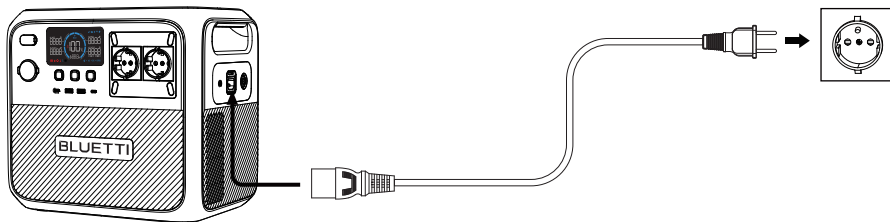

Use a cable with OT terminals for grounding. Connect one end to the grounding terminal with a grounding screw and the other end to the wall outlet or home distribution box ground.

