

HEAVY DUTY WIRE ROPE THIMBLE

CODE	ROPE SIZE	C	D	A	E	B
SS-414-1/4	1/4"	56	10	23.5	7	43
SS-414-5/16	5/16"	63	12.5	28	9	49
SS-414-3/8	3/8"	73	15	29	10.5	55
SS-414-1/2	1/2"	92	20	38	13	65
SS-414-5/8	5/8"	106	23.5	45	17	83
SS-414-3/4	3/4"	125	31	51	23	95
SS-414-1	1"	157.5	37.5	65.5	25.4	118

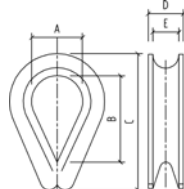

HEAVY DUTY CLOSED WIRE ROPE THIMBLE

CODE	ROPE SIZE	C	D	A	E	B
SS-2344-10	10MM	67	13.5	28.5	10	51
SS-2344-12	12MM	86	16.3	36.5	11	62
SS-2344-16	16MM	109.5	22.5	47	14	82

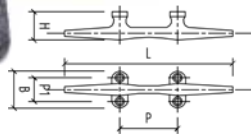

STAINLESS STEEL MOORING CLEAT

CODE	L	B	P	P1	H
SS-508-06	6" 150MM	45	56	27	31.5
SS-508-08	8" 200MM	54	75	34	38
SS-508-10	10" 250MM	69	93	46.7	48.5

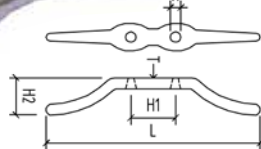

STAINLESS STEEL ROPE CLEAT

CODE	L	H1	H	T	H2
SS-4015-01	68	21	4	4	12
SS-4015-02	113	35	5.8	6	20
SS-4015-03	150	37	6.8	8	29

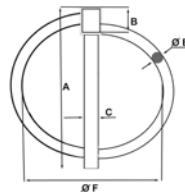

LINCH PIN

CODE	A	B	C	E	F
SS-3193-04	47	7.4	4.4	2.6	37.8
SS-3193-06	55	7.8	6	3.2	44
SS-3193-08	56	8.3	7.4	3.2	44

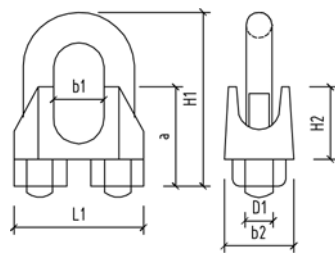

WIRE ROPE GRIP

CODE	ROPE SIZE	B	B1	B2	D1	H1	H2	L1
SS-260-02	2MM	12	4	14	3	18	10	13
SS-260-03	3MM	14	5.5	16	3	22	11	16
SS-260-03/HD	3MM	12	4	14	4	18	10	13
SS-260-04	4MM	16	6	18	4	23	13	18
SS-260-05	5MM	19	7	21	5	27	15	21
SS-260-06	6MM	22	9	22	5	32	17	27
SS-260-08	8MM	27	11	28	8	40	20	34
SS-260-10	10MM	32	12	35	10	50	24	45
SS-260-12	12MM	37	15	38	12	62	28	50
SS-260-14	14MM	40	18	44	13	65	32	52
SS-260-16	16MM	47	20	47	13	78	34	59
SS-260-19	19MM	51	22	53	13	82	39	62
SS-260-25	25MM	65	28	62	16	105	53	76

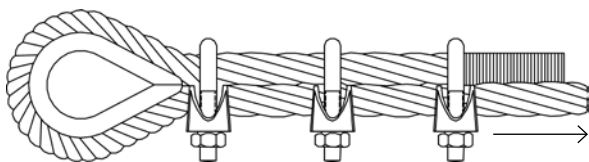

Attach Wire Rope Grips as shown in the above diagram.  
Note: Pulling wire sits on the base of the grip.



DUPLEX WIRE GRIP - 304 GRADE

CODE	ROPE SIZE	L	B
SS-512-03	3MM	40	18