

# TITAN

MULTIGYM

With no moving parts, the TITAN bodyweight multigym is completely tamperproof and was specifically designed for safety and security.



## Real Fitness Equipment for Real Results

The TITAN Multigym takes the basics of indoor commercial fitness equipment and delivers it to the outside world in a tamperproof, durable, and weatherproof package.

Compact, cost effective, and completely safe, the TITAN is designed for any fitness level or ability.

 **TAMPERPROOF.**  **WEATHERPROOF.**  **SAFE.**

### COMPLETELY TAMPERPROOF

The TITAN has no moving parts, eliminating pinch points and entrapment areas. The TITAN's completely tamperproof design also means nothing can be removed from the unit.

### 5 DIFFERENT EXERCISES

The TITAN is designed with five different exercises, offering a full body workout. Its multigym design allows users to move around the equipment in a circuit training format.

### 4 SIMULTANEOUS USERS

The TITAN helps you make the most of your space, with up to four people using the equipment at once.

The TITAN is built to maximize indoor or outdoor exercise areas, with 5 exercises available:

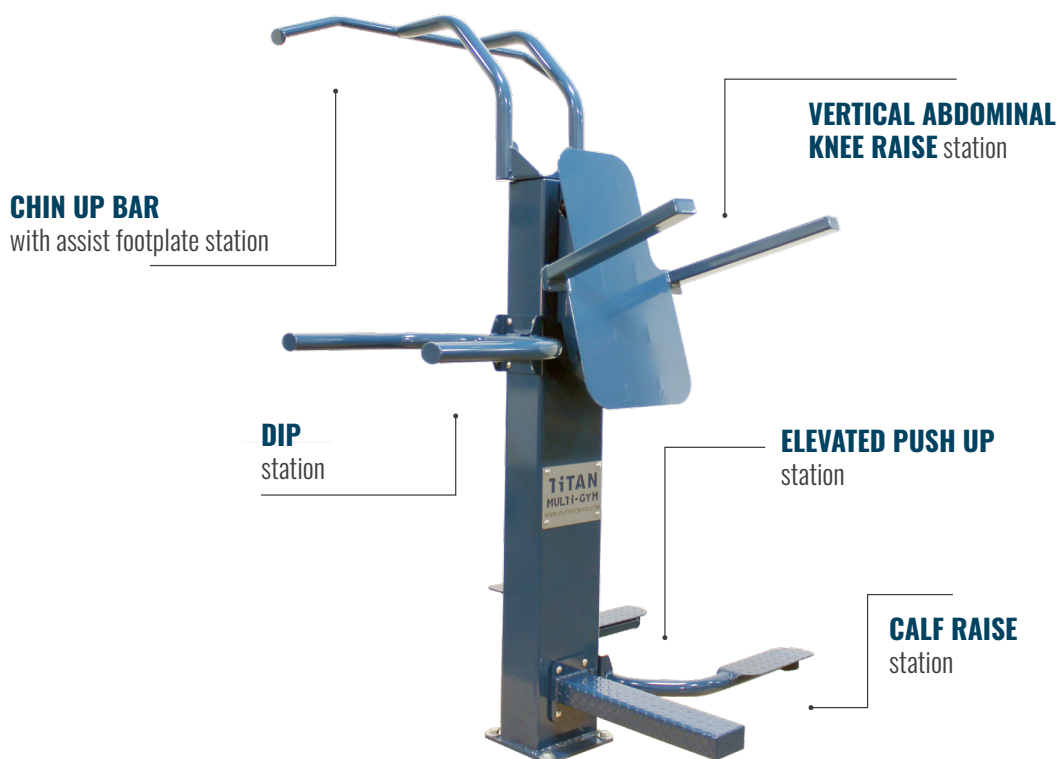

## TECHNICAL SPECIFICATIONS



**Width:** 54" / 138 cm

**Length:** 57" / 145 cm

**Height:** 85" / 216 cm

**Weight:** 253 lbs / 115 kg

**Fall Height:** 84" / 213cm

**Use Zone:** 12'4" x 8'10"

**Shipping Weight:** 385 lbs / 162 kg

**Shipping Dimensions:** 36" wide x 80" long x 30" high /  
91 cm wide x 204 cm long x 76 cm high



**Frame:** Constructed of 3/16" and 1/4" thick heavy-duty steel. All fasteners are tamperproof stainless steel carriage bolts with a smooth, rounded head and square neck. The locking nuts are shielded behind a padlocked access hatch.

### Finish:

- All parts have surfaces prepped and cleaned of all mill scale, rust, oils, and dirt using shot blast and/or chemical wash.
- Primer coat is applied with epoxy zinc-rich primer (3-4 mil thickness) and cured in oven. Primer designed for superior rust protection. Tested for 3000 hours of salt spray resistance.
- Top finish coat is applied with TGIC-FREE weather-resistant polyester powder (3-4 mil thickness) and cured in oven. Tested for 1500 hours of salt spray resistance.
- All parts inspected to be free of paint defects prior to shipping.



### CAD DRAWING

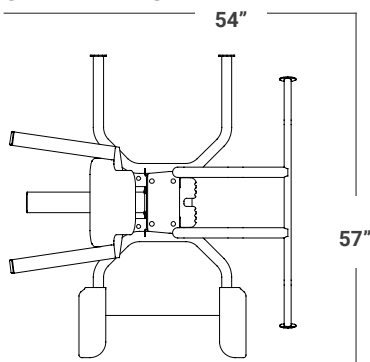

**TiTAN**  
MULTI-GYM



**Accessibility:** It is the manufacturers' opinion that the Titan Multigym conforms to the A.D.A. accessibility standard, assuming an accessible protective surfacing is provided or within the entire use zone.