

# Summit WP 400

Part Number 42440

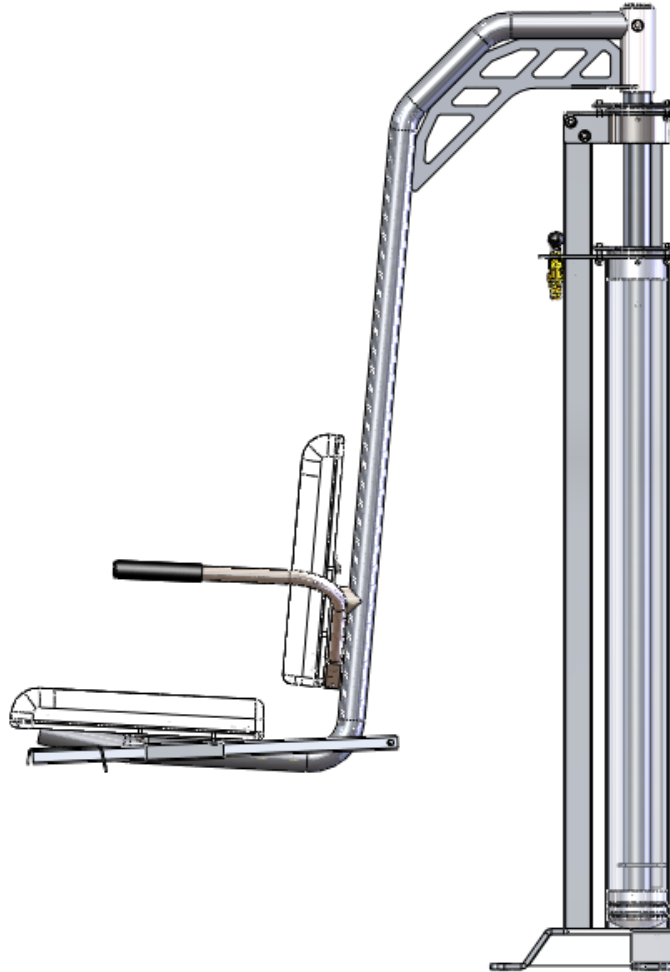

**SPECTRUM**<sup>®</sup>  
Aquatics

A PLAYCORE Company

7100 Spectrum Lane ~ Missoula MT 59808  
800.791.8056 ~ [www.spectrumproducts.com](http://www.spectrumproducts.com)

You have purchased a Spectrum Products Swim Lift® Summit WP 400. Providing the unit is installed correctly and properly maintained, it will furnish you with many years of trouble free use. It is important to read this entire manual prior to beginning assembly or operation.

### **Shipping Information:**

Each lift should arrive fully assembled on a single pallet. Before accepting the shipment from the carrier, inspect for visible damage and match the contents with those listed below.

Spectrum is not responsible for lost or damaged freight.

The Pallet will contain all structural components and hardware. The following is a list of the components included with your shipment from Spectrum. Use Components and Hardware Figure, page 2, as a reference to identify each item listed.

1	Assembled Summit Lift	1	Mounting Hardware
2	Seat Halves	2	Arm Rests (1 Each Right and Left)

# Components and Hardware

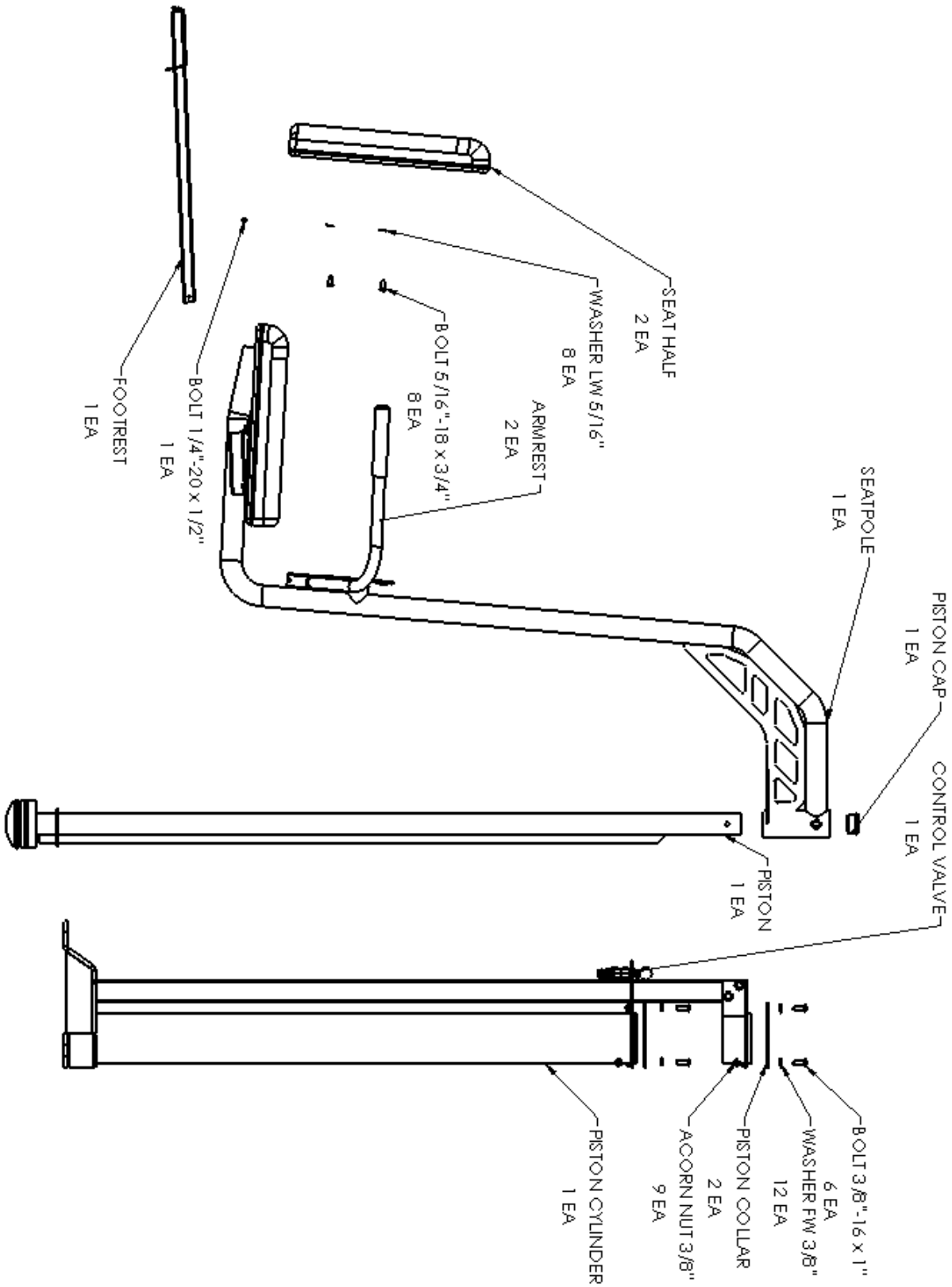

## Installation Overview

Read all instructions before attempting to assemble or install the Lift.

### Anchor Location

It is recommended that the Summit be installed in or near the shallow end of the pool with sufficient deck space and operational area in the pool as shown in Figure 1. For reasons of safety and ADA guidelines, the lift must be installed in a location that is clear from obstacles and other hazards.

**NOTE:** Do not locate the lift in a corner or directly adjacent to pool ladders/handrails or grab rails that could interfere with the rotation of the lift. Do not place the lift where it may be cumbersome or hazardous to any pool users.

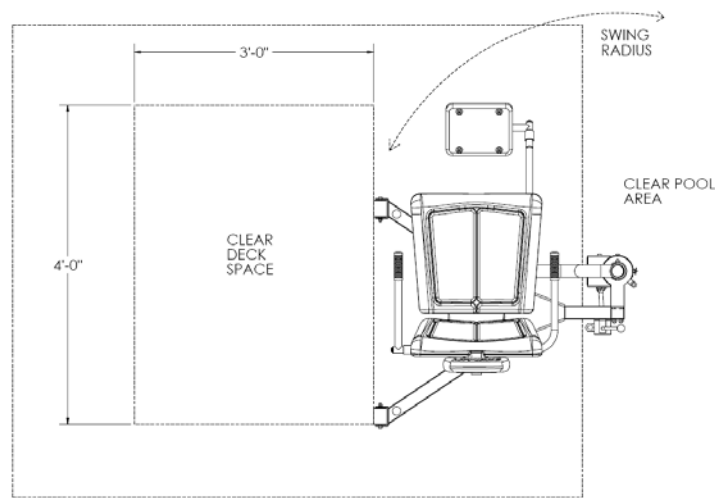

Figure 1

Because the lift can be stopped at any position during lowering, there is no minimum pool depth requirement for the Summit. However, to comply with ADA guidelines, the Summit must be installed at a pool depth no greater than 48-inches and the seat should submerge to a minimum depth of 18" below the surface of the water. There must be at least 6" from the center of each anchor to the nearest joint, crack, curb or similar concrete structure to ensure the strength of the concrete.

In addition, all installations should be in accordance with the ADA guidelines (ADA guidelines are available at the website [www.access-board.gov](http://www.access-board.gov)).

### Anchor Installation

1. Mark the location of each anchor on the deck and use a 1" diameter concrete drill bit to drill a 2 1/4" deep hole at each location. Make sure to drill straight down.
2. Clean all debris from hole and place the expansion anchor into the hole. Tap the anchor into the hole until the top of the anchor is flush with the deck.

3. Set the expansion anchor at the bottom of the anchor hole by tapping the anchor pin with the supplied 1/4" diameter set tool rod with a hammer.
4. Locate a bonding source to bond (ground) the anchor. The steel rebar-bonding grid of the pool deck is the best choice for bonding the anchor. Spectrum recommends using a bonding strip to connect the anchor to one of the anchor bolts. Ensure that bonding meets all state and local requirements.

**NOTE:** *Article 680 of the National Electrical Code requires bonding of all metallic components in relationship to pools and spas.*

### **Lift Assembly**

1. Attach the Lifting Cylinder to the Seat arm using a 3/8" x 3" Button Head screw, two 3/8" flat washers, one 3/8" lock washer and a 3/8" acorn nut.
2. Attach the Rotationally molded Seat halves to the Seat arm using eight 5/16" x 1" Button head screws, 5/16" washers and 5/16" lock washers. Make sure to attach the seatbelt using the rear holes on the bottom seat half.
3. Connect footrest using one button head socket screw 1/4" x 1/2" and one 1/4" lock washer.
4. Place the two armrests into the seat frame behind the seat back, if the armrests do not look parallel to the plane of the seat, switch them.
5. Connect the water supply to the female garden hose coupling on the control valve. Cut the exhaust line to length making sure it is plumbed to an appropriate drain. After purging the air from the cylinder, the Summit Lift is ready for operation.

▪

## Lift Operation

**WARNING!** Read all operating instructions before operating the lift. Make sure that all individuals using the lift have read the instructions and have been made aware of all safety precautions.

**WARNING!** Do not exceed the maximum lifting capacity of 400 lbs (181.4 kg). This may result in damage to the lift or personal injury. Other lift models are available for loads in excess of 400 lbs.

The Swim-Lift® Summit is a water-powered lifting aid designed for use with water systems that have a 55 PSI rating. This lift will function with as little as 45 PSI water pressure. Optional pump kits are available for supplying a constant pressure of 55 PSI. Lifting capacities are based on a continual pressure supply without pressure drops occasionally incurred during peak demand periods of city water systems. The lifting capacity/pressure ratios are as follows:

Pressure	Lift Capacity
55 PSI	400 lbs.
50 PSI	350 lbs.
45 PSI	300 lbs.

**Note:** A backflow check valve may be required on this lift to prevent contamination of the municipal water supply. Please check your state and local codes to see if a backflow check valve is required.

### Lift Preparation:

1. Turn the control valve to the intermediate stop position and attach the water supply hose to the valve. Turn the water supply on.
2. With no weight on the chair, turn the control valve handle to the up position. Allow the chair to fully rise.
3. Turn the control valve handle to the down position. Allow the seat to lower to a fully down position. Repeat steps 2 and 3 until a smooth operation is attained. This process purges the air from the system and should not take more than 5 to 7 cycles to complete.

### Lift Operation:

1. Lift operation is controlled through the use of the control valve. The valve handle turned clockwise will lower the chair, and turned counter-clockwise will raise the chair. The chair will stop at any point along its travel if the valve handle is turned to an intermediate position. Excessive force is not required to turn the valve handle. Instruct all operators on proper use of the control valve prior to operation of the lift.
2. The outer chair arm flips up and back for ease of transfer from a wheelchair to the lift seat. In addition, the stationary arm on the inside of the chair may assist in transferring. Use of the seatbelt is recommended for all users. To facilitate safe loading and unloading of

inexperienced users, we recommend that an attendant always be present. Instruct all operators on the proper use of the chair features and the transfer procedure.

3. A lock pin is attached to the top of the cylinder to lock the chair in the fully raised position or rotated 180° over the pool. Push the pin through the piston rod (lower hole) to lock the chair in the fully raised position when the lift is not in use and/or when the water supply is turned off. Use the 180° rotated lock pin hole (upper hole) to lock the chair in place when removing the lift from the anchors.
4. To drain the water from the lift for storage: disconnect the water source, turn the control valve to down, push the chair down, turn the control valve to up, and push the chair back up. Repeating this step is necessary to get all of the water removed. This process will force the water from the cylinder, valve and hoses.

## Care and Maintenance

The following should be performed periodically to ensure safe and dependable use.

1. Remove any discoloration with a 3M scratch pad (stainless steel components only). Wipe clean with a sponge dampened with Spectra Clean. Repeat these steps several times to passivate the stainless steel. Spectra Clean kits are available from Spectrum (Part Number 202050-00). Do not spray with high-pressure water, only clean with non-chlorinated water.
2. Check all water connections – Check any external hoses for wear and/or breakage in the outer tubing.
3. Check all mechanical connections – inspect the Nylock Nuts on all moving parts and make sure they are snug.



## Troubleshooting

<b>Problem:</b>	<b>Cause:</b>	<b>Solution:</b>
1. Lift will not operate at all:	Unit Not Level Valve Failure Kinked Hose Air in Cylinder Dirty Cylinder Worn Top Collar	Check for level and shim accordingly  Replace Valve (P/N 27285, 27286)  Un kink hose and recheck  Run unit 5-7 times up and down while assisting motion  Call for assistance  Replace Top Collar (P/N 27315)
2. Lift chatters when moving.	Air in Cylinder Dirty Cylinder Worn Top Collar	Run unit 5-7 times up and down while assisting motion  Call for assistance  Replace Top Collar (P/N 27315)
3. Lift moves up slowly	Low water pressure Worn Seals Valve Failure	Use lift with Booster Pump (P/N 27028-00)  Replace Seals (P/N 27245, 27246)  Replace Valve (P/N 27285, 27286)
4. The seat travels much slower than normal.	Low battery Defective or worn-out battery	Recharge battery  Replace battery*
5. Lift descends with valve in neutral position	Valve Failure Worn Seals	Replace Valve (P/N 27285, 27286)  Replace Seals (P/N 27245, 27246)

\*Please contact your local distributor or Spectrum Customer Service to order parts 406.532.6321