

NOTE: NOT ALL LIFTS WORK ON EVERY POOL OR SPA; FIELD MEASUREMENTS ARE NEEDED TO ASSURE THAT THE LIFT YOU ORDER IS APPROPRIATE FOR YOUR POOL. FOLLOW THE INSTRUCTIONS BELOW TO COMPLETE YOUR PROFILE GUIDE(S).

1. Determine if your pool or spa is able to have a lift installed. ADA requires the following:
 - a. An accessible route to the pool and/or spa; generally consisting of a 36" wide clear pathway that can allow a wheelchair easy access. See chapter 4 of the ADA for full information on Accessible Routes.
 - b. Clear deck space to the side of the lifts seat opposite the water that is 36" wide minimum by 48" long minimum. 48" measurement is measured from 12" behind the seat of the lift.
 - c. Lift must be installed at a location where pool depth is at least 42" and not greater than 48" unless the entire pool depth is greater than 48".
 - d. For more information on ADA requirements contact the Department of Justice at www.ada.gov or an Aqua Creek representative.
2. Complete one of these profile guides for each body of water you will need to supply with a lift
3. Fill out your contact information. If you are a dealer, or you are working through a dealer, complete the dealer information too.
4. Choose the pool/spa cross section that most closely matches your pool or spa and provide the measurements for your profile(s).
 - a. If you do not see a pool or spa cross section here that meets your pool or spa, draw one and provide the measurements.
5. (Optional but very helpful) - Take some pictures of your pool and/or spa and send them in with your completed profiles. Make an overhead drawing of your entire pool/spa room with overall dimensions of the pool and your deck spaces. The more information we have about your facility, the easier we can make a recommendation on the appropriate lift for your application(s).
 - a. If you have existing anchors (sockets) in your pool deck that were used for older non-complaint lifts, please include their location in relation to the pool/spa edge and the inside diameter of the anchor.
6. Fax or email completed form(s) to the following:

Fax: (406) 541-8958 – **Attn:** Sales

Email: sales@aquacreek.com or your Direct Aqua Creek sales persons email.

Subject: Pool Profile Info
7. You should hear back from us within one to two working days.

POOL SPA PROFILE GUIDE

Project/Property Name: _____ City: _____ State: _____
 Project/Property Contact: _____ Email: _____ Phone: (____) _____
 Dealer: _____ Phone: (____) _____ Fax: (____) _____
 Dealer Contact: _____ Email: _____ Mobile: (____) _____

CHOOSE THE POOL/SPA CROSS SECTION THAT MOST CLOSELY MATCHES YOURS

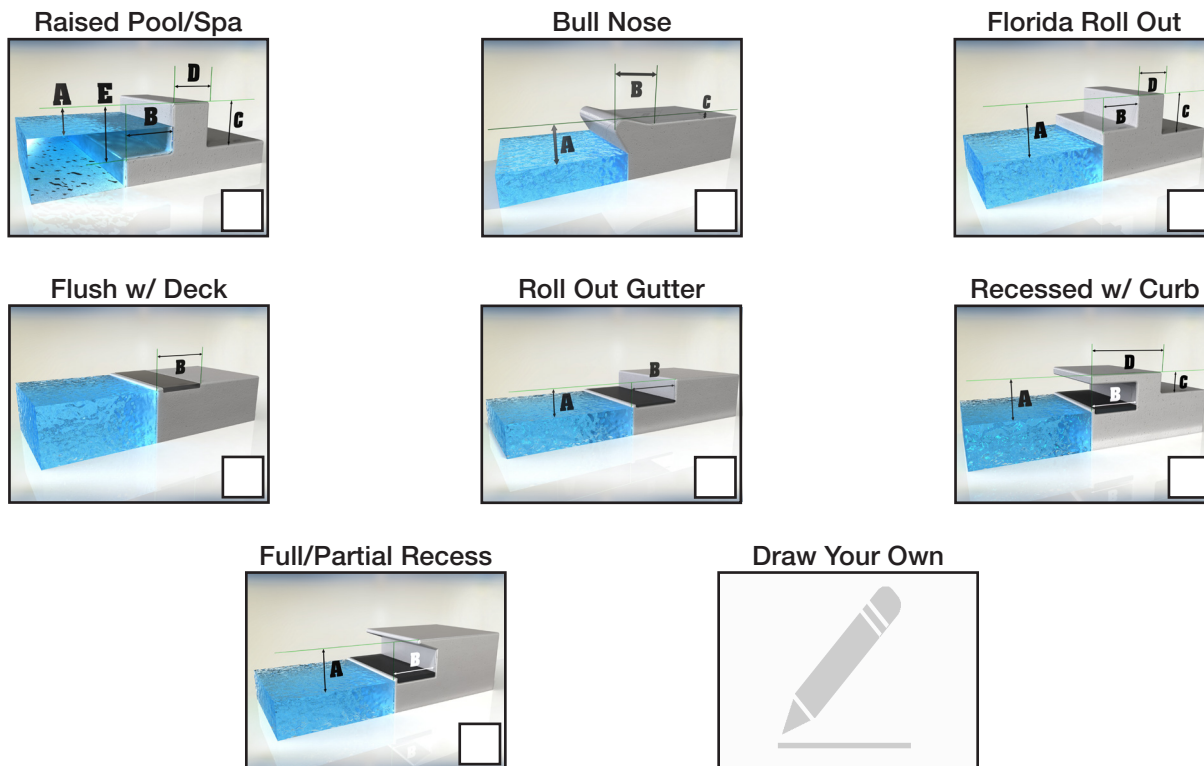

COMPLETE THE NECESSARY INFORMATION BASED ON YOUR CROSS SECTION

POOL/SPA TYPE: Commercial Residential

DECK MATERIAL: Concrete Wood Pavers - On Top Of? _____ Other (please specify) _____

EXISTING SOCKET(S): Inside Diameter _____ Depth of Socket _____ Distance from Pools Edge _____

W/NYLON SLEEVE INSERT

W/OUT NYLON SLEEVE INSERT

MEASUREMENTS:

A = Deck to Water _____ Inches

B = Width of Gutter and/or Coping Stone: _____ Inches

IF APPLICABLE:

C = Height of Curb or Wall _____ Inches

D = Width of Curb or Wall _____ Inches

E = Spa Seat Depth (Top of Wall to Seat) _____ Inches

F = Spa Seat Width _____ Inches

Pool Deck to Ceiling Measurement _____ Inches