

design **TOSCANO**[®]
INSTRUCTIONS
 FOR YOUR **PRODUCT**

Thank you for your recent purchase of this Design Toscano hand-crafted piece of furniture art. We have taken great care to create this piece especially for you. Please review these instructions and assemble this piece with care. Do not over tighten any screw or bolt connection.

Step 1

There are two shallow boxes that make up the base of the desk. Each box has a curved corner and a straight corner. Put the left curved corner box on the left and the right curved corner box on the right. Place the drawer cabinets on top of each base matching the curved corners.

Step 2

Space the cabinets evenly apart and fit the center eagle panel in the middle of the two cabinets. Tighten with bolts provided.

Step 3

Center the top on the cabinets with the brass plate facing out.

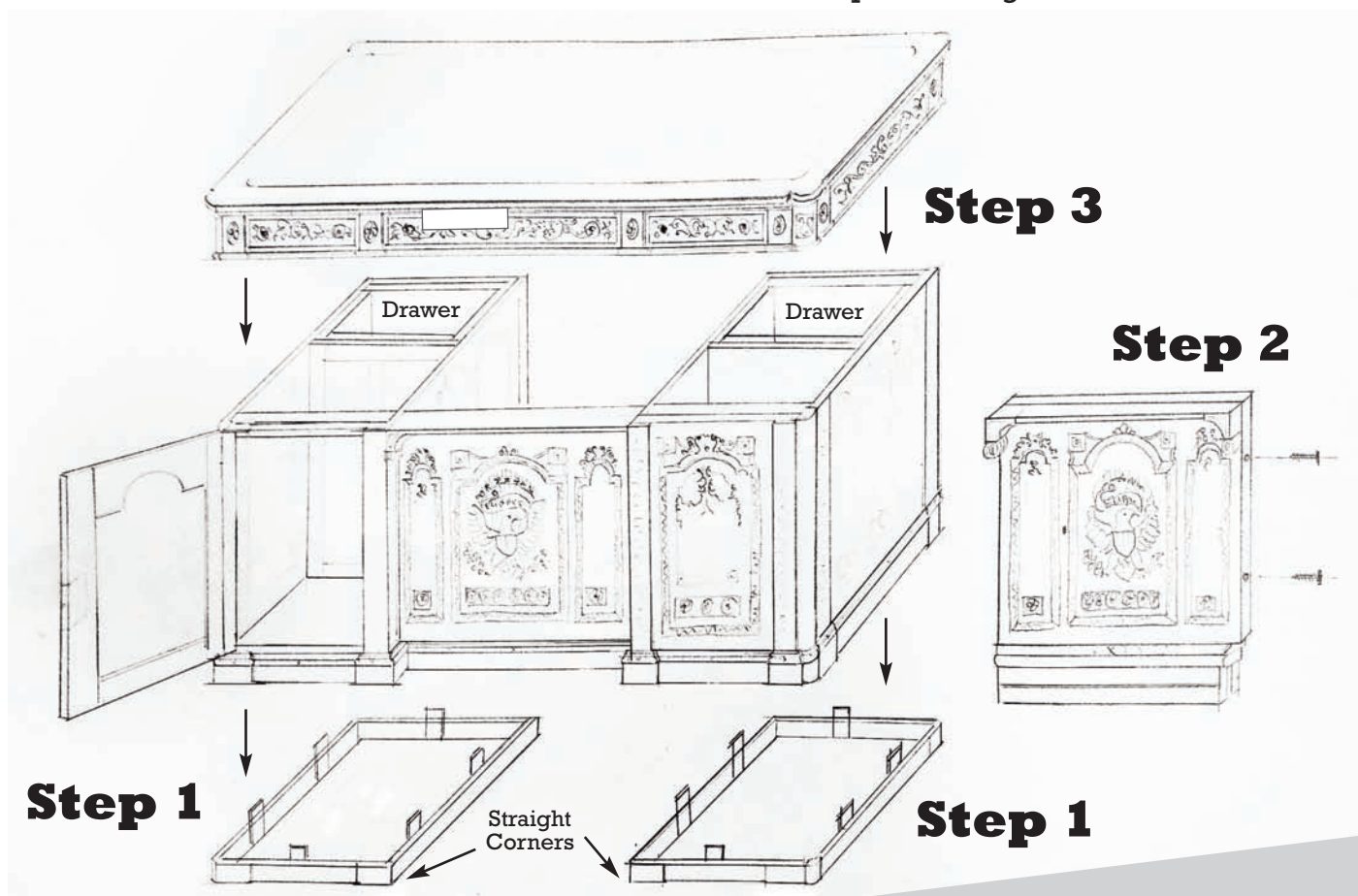

©Copyright 2015, Design Toscano, Inc.

1.800.525.0733
 DESIGNTOSCANO.COM

THANK YOU FOR
 YOUR PURCHASE