

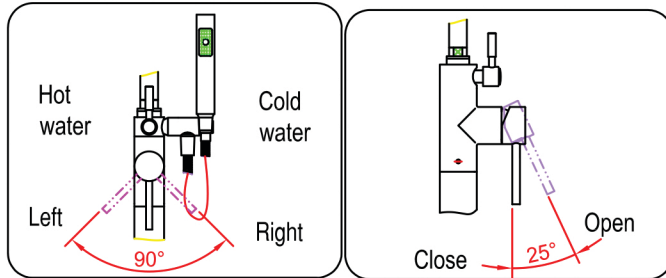

AB2534



☆ The usage of the shower converting assembly:

When the faucet is turned on, if the handle of the shower converting assembly is on the right side, water falls from the Outpipe unit, on the contrary, the water comes from the handle shower.

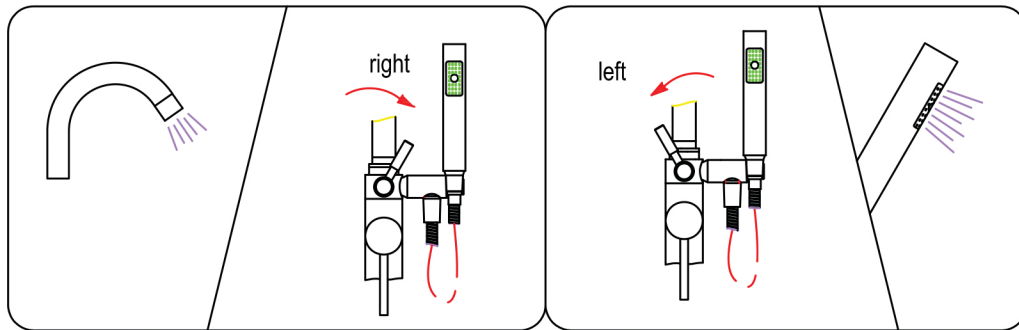

※ Cleaning & Maintenance

☆ To keep the product clean & shining, follow the steps as below:

1. Flush with clean water & dry with soft cloth only;
2. If any dirt, clean with soft liquid or transparent glass detergent.
3. Do not use any scrubbing detergent, polisher, sand-cloth, paper tissue or scraper.
4. Do not use acid detergent, indissolvable grain-like detergent or soap.

