

How To Install

Fabric Cassette

WARNING

*According to the Window Covering Manufacturers Association Inc., all labels must not be removed from the product.

*To comply with child safety standards, all tension devices must be installed, following Tension Installation on page 2.

Tools Needed

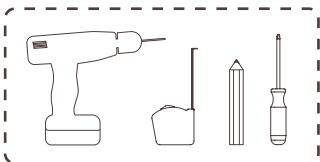

Need Assistance?

Contact a City Shade Associate for help with Installing.

(877)-224-8974

support@cityshadecompany.com

www.cityshadecompany.com

Installing Brackets

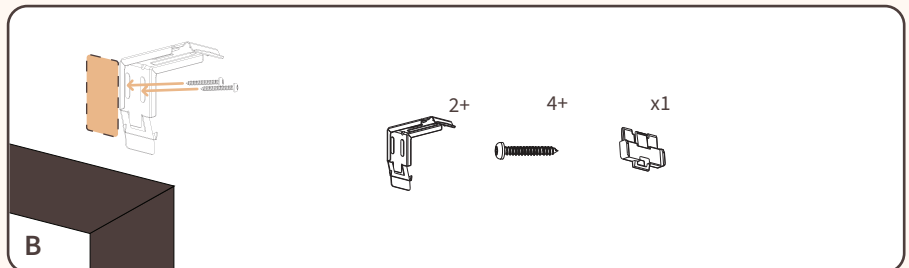
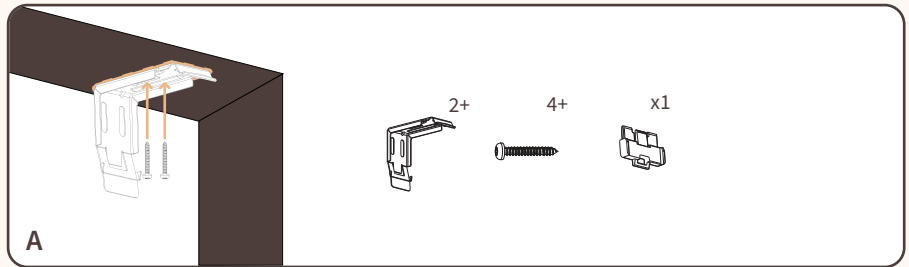

A. Inside Mount: Place brackets minimum 2" from the side frame.

B. Outside Mount: Measure the total width of shade, then center over the window frame. Place the brackets minimum of 2" in from each end. We recommend installing 3" above window frame.

Brackets must be securely attached to the mounting surface. If the screws provided do not hit wood studs you'll have to use a different fastener which can be found at any hardware store.

NOTE: Keep the roller shade up-rolled, do not unroll before installation.

Installing Shade

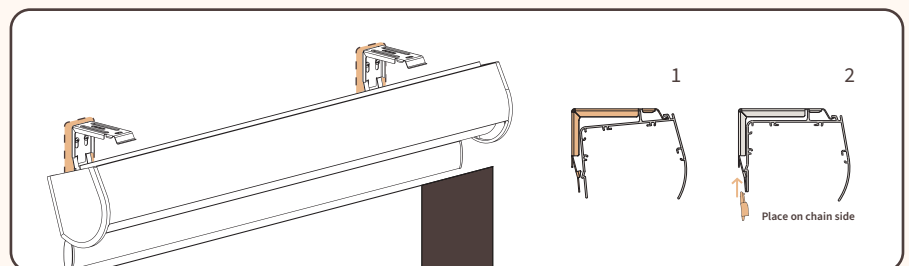

Begin with sliding shade in back end lowered with back end lowered enough for lip of bracket to make contact with lip on top of cassette. Once contact is made begin to lift back end up until you hear a click.

Then place stability block on chain side between mount and wall.

How To Install

Fabric Cassette

WARNING



*Young children can strangle in the loop of pull cords, chains and tapes, and cords that operate window coverings.

*To avoid strangulation and entanglement, keep cords out of the reach of young children. Cords may become wrapped around a child's neck

*Do not tie cords together. Make sure cords do not twist together and form a loop.

Need Assistance?

Contact a City Shade Associate for help with Installing.

(877)-224-8974

support@cityshadecompany.com

www.cityshadecompany.com

Installing Tension Bracket

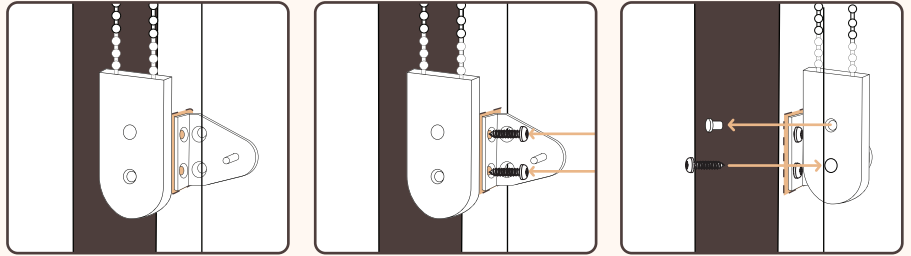

Step 1: Pull tension device down to where there is very little slack. Mark the area where the bracket sits.

Step 2: When placed in the correct spot, use two screws to secure bracket.

Step 3: Place tension device on to bracket, secure with a screw and remove stopper from top hole.