

# Quick Operating Instruction for NovaCaddy X9RD Remote Control Golf Trolley

It takes some time to learn how to operate this device. Here is a brief instruction of how to operate from control panel and remote controller handset.

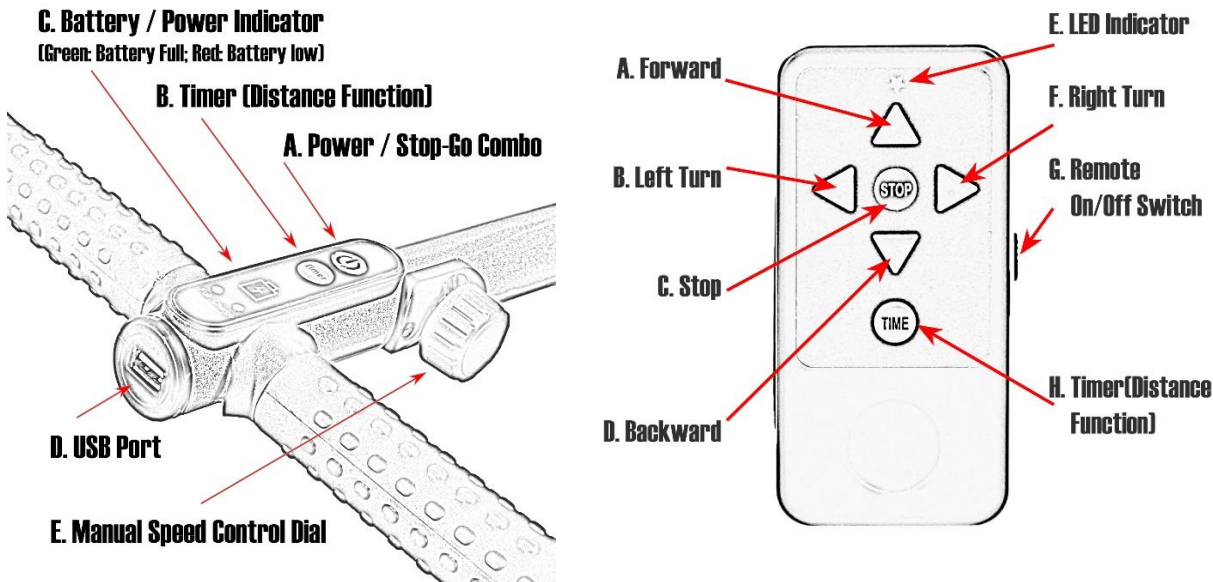

**Power ON/Off.** Press and Hold handle's A. Power/Stop-Go Combo button for 3-5 seconds to turn the cart power ON or OFF. During the manual control mode, briefly press the POWER button to Pause or Replay the cart.

**Battery Status** When main power turns ON, battery LED indicator illuminate. If the Green indicator illuminate, battery is full. If only Red indicator illuminate, battery is running out and need to be recharged.

**Manual Speed Controller** Scrolling of the Manual Speed Control Dial lets you choose your preferred speed to suit your space perfectly. The speed level is from 1 to 9.

**Stop-Go Button and Brake Function:** One brief press Power/Stop-Go Combo button in order to Pause or Run the trolley. Select the speed to match your pace. The cart will remember its last setting when you stop, and travel at that speed automatically when you start again, except when you change the speed knob position.

**Timer (Distance Function)** The Timer button works as 10, 20, 30 Seconds moving control (about 10, 20, 30 yard/meter distance) Increase 10 seconds (10 yards) each press. 30 seconds (30 yards) max. You can stop the Timer program by press Power/Stop-Go combo button on handle or Stop button on remote handset anytime.

**USB Port** Use cart battery to charge Cell Phone, GPS, USB speaker or any other USB device.

**Remote handset** The remote control features Forward, Backward, Left Turn, Right Turn, Stop and 9 speed selections on both forward and backward movement. Press the Forward button each time, it will increase speed to higher level. Always press Forward/Backward button briefly and release it quickly, so you can increase speed level one by one. **Time** button on remote works same as Timers on handle. The **ON/OFF switch** at side of remote is used to turn the remote controller on or off.

## Important Safety Instructions

- Be alert and act responsibly at all time while operating your caddy, just as you would when operating a riding cart, or motor vehicle. We absolutely do not recommend the consumption of alcohol or any other impairing substances while operating our caddies.
- Do not operate the caddy with the remote control in narrow or dangerous spaces, places with valuables or any people gathering areas, such as parking lots, close to flowing traffic, bag drop-off areas, stores, driving ranges, putting greens and practice areas, pro shops, restaurants, and other areas where people or items could be harmed through an error or lack of skill in operation. In such situations the caddy should be best operated with its manual controls or free-wheeling mode (power off). **Also, please make sure to always turn the power off and secure the caddy when you park and leave the unit for any reason, either on or off course.**
- With its optimized balance and straight front wheel the caddy has extraordinarily narrow and responsive turning and maneuvering abilities. However, it sometimes tends to react to severe uneven weight distribution of its load or steep slope variations and follows the slope of the golf course. Therefore, please make sure the weight in your bag is distributed evenly (move heavy balls and items to both sides, or shift the bag on the caddy). Also, when operating your caddy by remote control anticipate the slope of the course in order to avoid frequent corrections in directions. In some extreme environments, such as very uneven terrain, steep hills, narrow and/or sloped cart paths, muddy areas, gravel paths, close to bunkers and hazard, around bushes and trees, it is recommended to operate the caddy via manual control in order to prevent any collisions, damage or the need for complicated correction adjustment maneuvers.
- **Make sure you are close to the caddy at all time while testing it and familiarizing yourself with the remote control!** We **strongly recommend** to operate the caddy in closer range of 10-30 yards (do not exceed 50 yards) to be able to react to any unforeseen events, such as other golfers crossing your path or to avoid hidden obstructions (creeks, bunkers, GUR, etc.) or a unexpected disconnection in remote operation.

### Please Get User Manual Online for Detail Product Information and Instruction

See and download e-manual from Our website at

<https://www.novacaddy.com/pages/manuals>

For service, spare parts and accessories supply, please visit our website:

<https://www.novacaddy.com/>

We can be reached by

TI: 905-209-9937

Email: [service.novacaddy@oneontarget.com](mailto:service.novacaddy@oneontarget.com)

NovaCaddy Golf Products.