

Note: Some designs in this collection may have been created using unique special stitches and/or techniques. To preserve design integrity when rescaling or rotating designs in your software, always rescale or rotate designs using the handles directly on-screen.



12547-01 Paper Piecing Sun Mug Rug
Rug
 5.37 X 7.00 in.
 136.40 X 177.80 mm
 8,804 St. **L**



12547-02 Paper Piecing Feather Mug Rug
Mug Rug
 5.37 X 6.98 in.
 136.40 X 177.29 mm
 6,629 St. **L**



12547-03 Paper Piecing Hot Mug Rug
Rug
 5.37 X 6.88 in.
 136.40 X 174.75 mm
 4,884 St. **L**



12547-04 Yellow Bird Mug Rug
Appliqué
 5.37 X 6.96 in.
 136.40 X 176.78 mm
 8,009 St. **L**



12547-05 Tea Kettle Mug Rug
Appliqué
 5.37 X 6.88 in.
 136.40 X 174.75 mm
 8,003 St. **L**



12547-06 Apple A Day Mug Rug
Appliqué
 5.37 X 6.88 in.
 136.40 X 174.75 mm
 9,446 St. **L**

⌘ Design contains a loose fill.
 ⚙ Some solid areas shown are not stitched.

L Design is larger than 5" (127 mm) in either direction.
S Design is smaller than 1.5" (38.1 mm) in either direction.

It is a violation of Copyright law to make and distribute copies of electronic designs or artwork.
 Electronic designs are licensed to the original purchaser for use at one location. ©2014 OESD, LLC. All rights reserved.



In The Hoop Mug Rugs

#12547 / 6 Designs

Listings below indicate color sample, stitching order and suggested thread color number. Most numbers indicate Isacord thread. Colors beginning with 20501 refer to YLI Fine Metallics, 7 refer to Yenmet Metallic, 8 refer to YLI Variations Variegated Thread and 9 refer to Isacord Multicolor Variegated.

12547-01 Paper Piecing Sun Mug Rug

| | |
|---|------|
| ■ 1. Batting Placement Stitch..... | 0020 |
| ■ 2. Design Placement Guides & Placement Guide 1..... | 0700 |
| ■ 3. Placement Guide 2..... | 0700 |
| ■ 4. Tackdown & Fold Line 2..... | 0700 |
| ■ 5. Placement Guide 3..... | 0700 |
| ■ 6. Tackdown & Fold Line 3..... | 0700 |
| ■ 7. Placement Guide 4..... | 0700 |
| ■ 8. Tackdown & Fold Line 4..... | 0700 |
| ■ 9. Placement Guide 5..... | 0700 |
| ■ 10. Tackdown & Fold Line 5..... | 0700 |
| ■ 11. Placement Guide 6..... | 0700 |
| ■ 12. Tackdown & Fold Line 6..... | 0700 |
| ■ 13. Placement Guide 7..... | 0700 |
| ■ 14. Tackdown & Fold Line 7..... | 0700 |
| ■ 15. Placement Guide 8..... | 0700 |
| ■ 16. Tackdown & Fold Line 8..... | 0700 |
| ■ 17. Placement Guide 9..... | 0700 |
| ■ 18. Tackdown & Fold Line 9..... | 0700 |
| ■ 19. Placement Guide 10..... | 0700 |
| ■ 20. Tackdown & Fold Line 10..... | 0700 |
| ■ 21. Linework..... | 0700 |
| ■ 22. Seam Stitch..... | 0020 |

12547-02 Paper Piecing Feather Mug Rug

| | |
|---|------|
| ■ 1. Batting Placement Stitch..... | 0020 |
| □ 2. Design Placement Guides & Placement Guide 1..... | 0015 |
| □ 3. Placement Guide 2..... | 0015 |
| □ 4. Tackdown & Fold Line 2..... | 0015 |
| □ 5. Placement Guide 3..... | 0015 |
| □ 6. Tackdown & Fold Line 3..... | 0015 |
| □ 7. Placement Guide 4..... | 0015 |
| □ 8. Tackdown & Fold Line 4..... | 0015 |
| □ 9. Placement Guide 5..... | 0015 |
| □ 10. Tackdown & Fold Line 5..... | 0015 |
| □ 11. Placement Guide 6..... | 0015 |
| □ 12. Tackdown & Fold Line 6..... | 0015 |
| □ 13. Placement Guide 7..... | 0015 |
| □ 14. Tackdown & Fold Line 7..... | 0015 |
| □ 15. Placement Guide 8..... | 0015 |
| □ 16. Tackdown & Fold Line 8..... | 0015 |
| □ 17. Placement Guide 9..... | 0015 |
| □ 18. Tackdown & Fold Line 9..... | 0015 |
| □ 19. Placement Guide 10..... | 0015 |
| □ 20. Tackdown & Fold Line 10..... | 0015 |
| □ 21. Placement Guide 11..... | 0015 |
| □ 22. Tackdown & Fold Line 11..... | 0015 |
| □ 23. White Feather Linework..... | 0015 |
| ■ 24. Gray Feather Linework..... | 0108 |
| ■ 25. Seam Stitch..... | 0020 |

12547-03 Paper Piecing Hot Mug Rug

| | |
|---|------|
| ■ 1. Batting Placement Stitch..... | 0020 |
| □ 2. Design Placement Guides & Placement Guide 1..... | 0015 |
| □ 3. Placement Guide 2..... | 0015 |
| □ 4. Tackdown & Fold Line 2..... | 0015 |
| □ 5. Placement Guide 3..... | 0015 |
| □ 6. Tackdown & Fold Line 3..... | 0015 |
| □ 7. Placement Guide 4..... | 0015 |
| □ 8. Tackdown & Fold Line 4..... | 0015 |
| □ 9. Placement Guide 5..... | 0015 |
| □ 10. Tackdown & Fold Line 5..... | 0015 |
| □ 11. Placement Guide 6..... | 0015 |
| □ 12. Tackdown & Fold Line 6..... | 0015 |
| □ 13. Placement Guide 7..... | 0015 |
| □ 14. Tackdown & Fold Line 7..... | 0015 |
| □ 15. Placement Guide 8..... | 0015 |
| □ 16. Tackdown & Fold Line 8..... | 0015 |
| □ 17. Placement Guide 9..... | 0015 |
| □ 18. Tackdown & Fold Line 9..... | 0015 |
| □ 19. Placement Guide 10..... | 0015 |
| □ 20. Tackdown & Fold Line 10..... | 0015 |
| □ 21. Placement Guide 11..... | 0015 |
| □ 22. Tackdown & Fold Line 11..... | 0015 |
| □ 23. Placement Guide 12..... | 0015 |
| □ 24. Tackdown & Fold Line 12..... | 0015 |
| □ 25. Placement Guide 13..... | 0015 |
| □ 26. Tackdown & Fold Line 13..... | 0015 |
| □ 27. White Linework..... | 0015 |
| ■ 28. Seam Stitch..... | 0020 |

12547-04 Yellow Bird Mug Rug Appliqué

| | |
|--|------|
| ■ 1. Batting Placement Stitch..... | 0020 |
| ■ 2. Bottom Background Placement Stitch..... | 3840 |
| ■ 3. Bottom Background Tackdown..... | 3840 |
| ■ 4. Top Background Placement Stitch..... | 3840 |
| ■ 5. Top Background Tackdown..... | 0922 |
| ■ 6. Leaves..... | 6051 |
| ■ 7. Bird Placement Stitch..... | 3840 |
| ■ 8. Bird Tackdown..... | 0600 |
| ■ 9. Orange Bird & Background Linework..... | 0700 |
| ■ 10. Seam Stitch..... | 0020 |

12547-05 Tea Kettle Mug Rug Appliqué

| | |
|------------------------------------|------|
| ■ 1. Batting Placement Stitch..... | 0020 |
| ■ 2. Background Tackdown..... | 0138 |
| ■ 3. Gray Swirls..... | 0138 |
| ■ 4. Pot Placement Stitch..... | 0108 |
| ■ 5. Pot Tackdown..... | 5912 |
| □ 6. Pot White Linework..... | 0015 |
| □ 7. Lettering..... | 0015 |
| ■ 8. Seam Stitch..... | 0020 |

12547-06 Apple A Day Mug Rug Appliqué

| | |
|-------------------------------------|------|
| ■ 1. Batting Placement Stitch..... | 0020 |
| □ 2. Background Tackdown..... | 0015 |
| □ 3. White Linework..... | 0015 |
| □ 4. Triangle Placement Stitch..... | 1860 |
| ■ 5. Triangle Tackdown..... | 0640 |
| □ 6. Apple Placement Stitch..... | 1860 |
| ■ 7. Apple Tackdown..... | 1800 |
| ■ 8. Stem..... | 1055 |
| □ 9. Leaf Placement Stitch..... | 1860 |
| ■ 10. Leaf Tackdown..... | 5933 |
| ■ 11. Green Linework..... | 5531 |
| ■ 12. Seam Stitch..... | 0020 |

Isacord Thread Colors Used in "In the Hoop Mug Rugs"

Collection #12547

| | | |
|------------------|--------------------|------------------|
| 0015 White | 0700 Bright yellow | 3840 Oxford |
| 0020 Black | 0922 Ashley gold | 5531 Pear |
| 0108 Cobblestone | 1055 Bark | 5912 Erin green |
| 0138 Heavy storm | 1800 Wildfire | 5933 Grasshopper |
| 0600 Citrus | 1860 Shell | 6051 Jalapeno |
| 0640 Parchment | | |

1. Print out the necessary pages from the PDF of the appliqué pattern(s).
2. Mark the right side of the pattern pieces so you'll know which direction to lay the pattern on the fabric.
3. Lightly spray the wrong side of the pattern pieces with temporary adhesive spray and allow it to set for a few minutes.
4. Place the pattern pieces on the right side of the fabric and carefully cut them out. **PHOTO 1**
5. Sew the placement stitch on your hooped fabric. **PHOTO 2**
6. With the paper still stuck to the right side of the appliqué fabric, spray the wrong side of the fabric with temporary spray adhesive.
7. Place the fabric inside the sewing placement stitch so that it matches the stitching line, and then remove the paper pattern. **PHOTO 3**
8. Sew the tackdown. **PHOTO 4**
9. Sew the remainder of the design and repeat for any remaining pieces. **PHOTO 5**

NOTE: The patterns are sized for the designs as they were made. If you resize the design, you will need to resize the pattern the same amount. You can print out the pattern at the normal size then copy it on a copy machine at the changed size. For example, resize the designs to 80%, resize the printed pattern to 80%.

TIP: When Printing the patterns, make sure that the "Fit to page" option is UNCHECKED in the Print Dialog Box. If this option is checked the printed patterns will not be actual size.

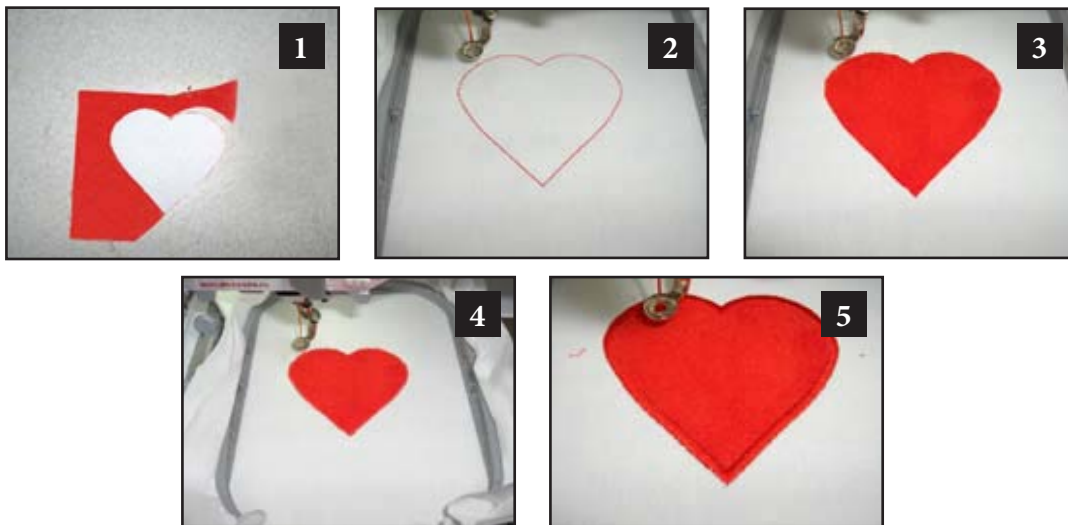

A fun collection of In the Hoop Mug Rugs #12547 which features half of them using a paper-pieced technique and the other half appliqué. Sun rays saying “Hello Morning”, a feather, and a cup of hot coffee are the paper pieced designs. The appliqué designs are a singing bird, a tea kettle saying “Sip slowly & Smile”, and an apple. Create a matching set using the same fabrics or mix and match using what you have on hand.



Supplies

- OESD embroidery collection In the Hoop Mug Rugs #12547
- Medium weight tear away stabilizer
- OESD Appliqué Fuse and Fix
- Embroidery thread
- Temporary spray adhesive
- Embroidery machine
- Fabrics for each mug rug: (refer to diagram for each paper pieced mug rug numbered sections)
 - **12547-01 Sun Mug Rug -**
 - ¼ yd. rays (#1, 5 & 9) and backing fabric
 - 8" x 8" rays (#2, 4 & 7)
 - 8" x 8" rays (#3, 6 & 8)
 - 4" x 4" sun (#10)
 - 5 ½" x 8" cotton batting
 - **12547-02 Feather Mug Rug -**
 - ¼ yd. outer edges (#6, 7, 8, 9, 10 & 11) and backing fabric
 - 4" x 4" triangle of feather (#2)
 - 6" x 6" large feather pieces (#1 & 3)
 - 2" x 6" slender piece of feather (#4)
 - 3" x 4" triangle of feather (#5)
 - 5 ½" x 8" cotton batting
 - **12547-03 Hot Mug Rug -**
 - 6" x 6" coffee cup (#2, 3, 4, 5 & 10)
 - 6" x 10" background (#1, 6, 7, 8, 9, 11 & 12)
 - 3" x 5" side piece (#13)
 - 5 ½" x 18" backing fabric
 - 5 ½" x 8" cotton batting
 - **12547-04 Yellow Bird Mug Rug -**
 - 5 ½" x 5 ½" bottom background fabric
 - 3" x 5 ½" top background fabric
 - 5" x 5" piece bird appliqué
 - 5 ½" x 18" backing fabric
 - 5 ½" x 8" cotton batting
 - **12547-05 Tea Kettle Mug Rug -**
 - 5 ½" x 8" background fabric
 - 5" x 5" piece tea kettle appliqué fabric
 - 5 ½" x 18" backing fabric
 - 5 ½" x 8" cotton batting
 - **12547-06 Apple a Day Mug Rug -**
 - 5 ½" x 8" background fabric
 - 5" x 5" apple appliqué
 - 2" x 3" leaf appliqué
 - 5 ½" x 4" triangle appliqué
 - 5 ½" x 18" backing fabric
 - 5 ½" x 8" cotton batting

Cut

- For Paper Pieced Mug Rugs – Following diagrams for each mug rug, cut out pieces of fabric for each numbered sections. Cut them slightly larger than each section allowing for ¼" seam on all sides.
- For Appliqué Mug Rugs – Following manufacturer’s directions, use OESD Fuse and Fix on the wrong side of the appliqué fabrics. Cut out appliqué using the appliqué template provided.
- For the back pieces of the Mug Rugs – cut a 5 ½" x 11" piece and 5 ½" x 5 ½" piece from backing fabric. Wrong sides together, fold each in half and press.

NOTE: To hold the pieces together better and to create a more stable backing, press a piece of OESD Fuse and Fix between the wrong sides, and then peel off the paper backing and stick together.

Paper Pieced Mug Rugs (12547-01, 12547-02 & 12547-03) Instructions

- Hoop one layer medium weight tear away stabilizer.
- Stitch first color called Batting Placement Stitch.
NOTE: Use a pencil to extend the two sets of parallel lines to make them more clear later. **PHOTO 1**
- Place cotton batting piece over the Batting Placement Stitch. **PHOTO 2**
- Stitch next color called Design Placement Guide/
Placement Guide 1.
- Using a protective shield to cover your hoop, spray the batting with temporary spray adhesive. **PHOTO 3**
- Following the diagram, place fabric right side up over section 1. **PHOTO 4**
- Stitch the next color called Placement Guide 2.
- Right sides together, place fabric for section 2 over the Placement Guide 2 extending past the stitching line $\frac{1}{4}$ " and on the previous fabric. Stitch the next stitch which is the Tackdown/Fold Line 2.
NOTE: Trim both fabrics $\frac{1}{4}$ " from Tackdown stitch. **PHOTO 5**
- Flip and finger press the second fabric right side up over the line just stitched, leaving no wrinkles.
- Stitch the next color called Placement Guide 3. **PHOTO 6**
- Right sides together, place fabric for section 3 over the Placement Guide 2 extending past the stitching line $\frac{1}{4}$ " and on the previous fabrics. Stitch the next stitch which is the Tackdown/Fold Line 3.
NOTE: Trim all fabrics $\frac{1}{4}$ " from Tackdown stitch. **PHOTO 7**
- Flip and finger press the third fabric right side up over the line just stitched, leaving no wrinkles. **PHOTO 8**
- Continue stitching the remainder of the design in this process until the batting is covered with the pieced design. **PHOTO 9**
- Stitch the linework color(s). **PHOTO 10**
- Follow the Finishing All Mug Rugs Instructions below.

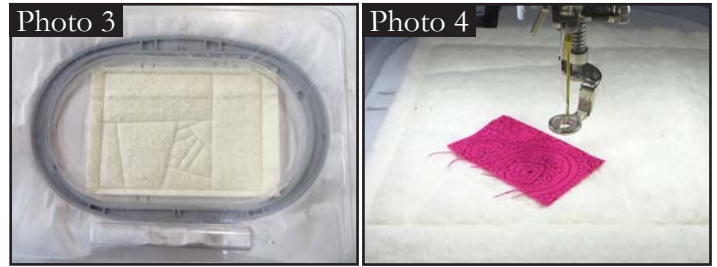

Appliqué Mug Rugs (12547-04, 12547-05, 12547-06) Instructions

- Hoop one layer medium weight tear away stabilizer
- Stitch first color called Batting Placement Stitch.
NOTE: Use a pencil to extend the two sets of parallel lines to make them more visible later. **PHOTO 1**
- Layer background fabric right side up with cotton batting. Center and place layered fabric and batting over the Batting Placement Stitch. **PHOTO 11**

NOTE: For the Yellow Bird Mug Rug (12547-04), center and place the cotton batting over the Batting Placement Stitch. Stitch the next stitch called Top Background Placement Stitch. Place the top background fabric right side up over the Top Background Placement Stitch. Stitch the next stitch called Top Background Tackdown. Stitch the next stitch called Bottom Background Placement Stitch. Place the bottom background fabric right side up over the Bottom Background Placement Stitch. Stitch the next stitch called Bottom Background Tackdown.

- Stitch the next color called Background Tackdown. **PHOTO 12**
- Follow the basic *pre-cut appliqué instructions*. **PHOTOS 13 & 14**
- Stitch the linework color and remainder of design. **PHOTO 15**
- Follow the Finishing All Mug Rugs Instructions below.



Finishing All Mug Rugs Instructions

- Before the last color change called Seam Stitch, find the two sets of parallel lines that were stitched during the Batting Placement Stitch, and use them as a guide to place your two folded back pieces so that they are overlapping. Place the smaller backing piece on first lining up folded edge with the lower placement line and raw edges even. **PHOTO 16**
- Then place the larger backing piece overlapping with the smaller piece and lining up folded edge with the upper placement line and raw edges even. **PHOTO 17**
- Stitch the last color change called Seam Stitch. **PHOTO 18**
- Trim 1/4" around the seam, and clip corners. **PHOTO 19**
- Turn your mug rug right side out and enjoy!

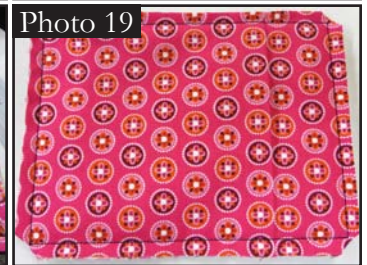

ATTENTION

When printing this document, any page scaling or page fitting options in your print dialog box must be turned OFF or set to NONE so that your files will print out at their actual size. Images not printed at actual size will not function as intended.

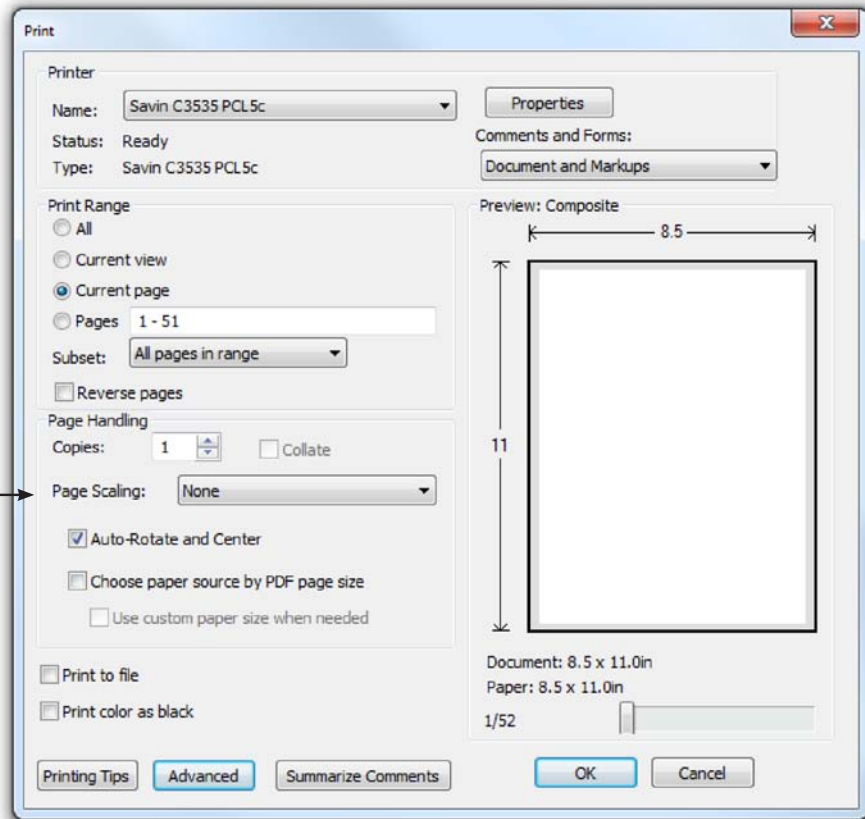

TO SAVE PAPER

Only print the desired image by navigating to the image's page, go to File > Print and select "Current page" in the print dialog box. Repeat for each desired image.

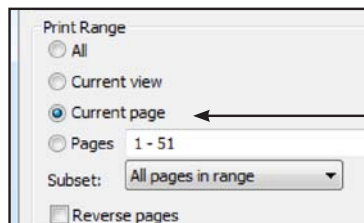

12547-01

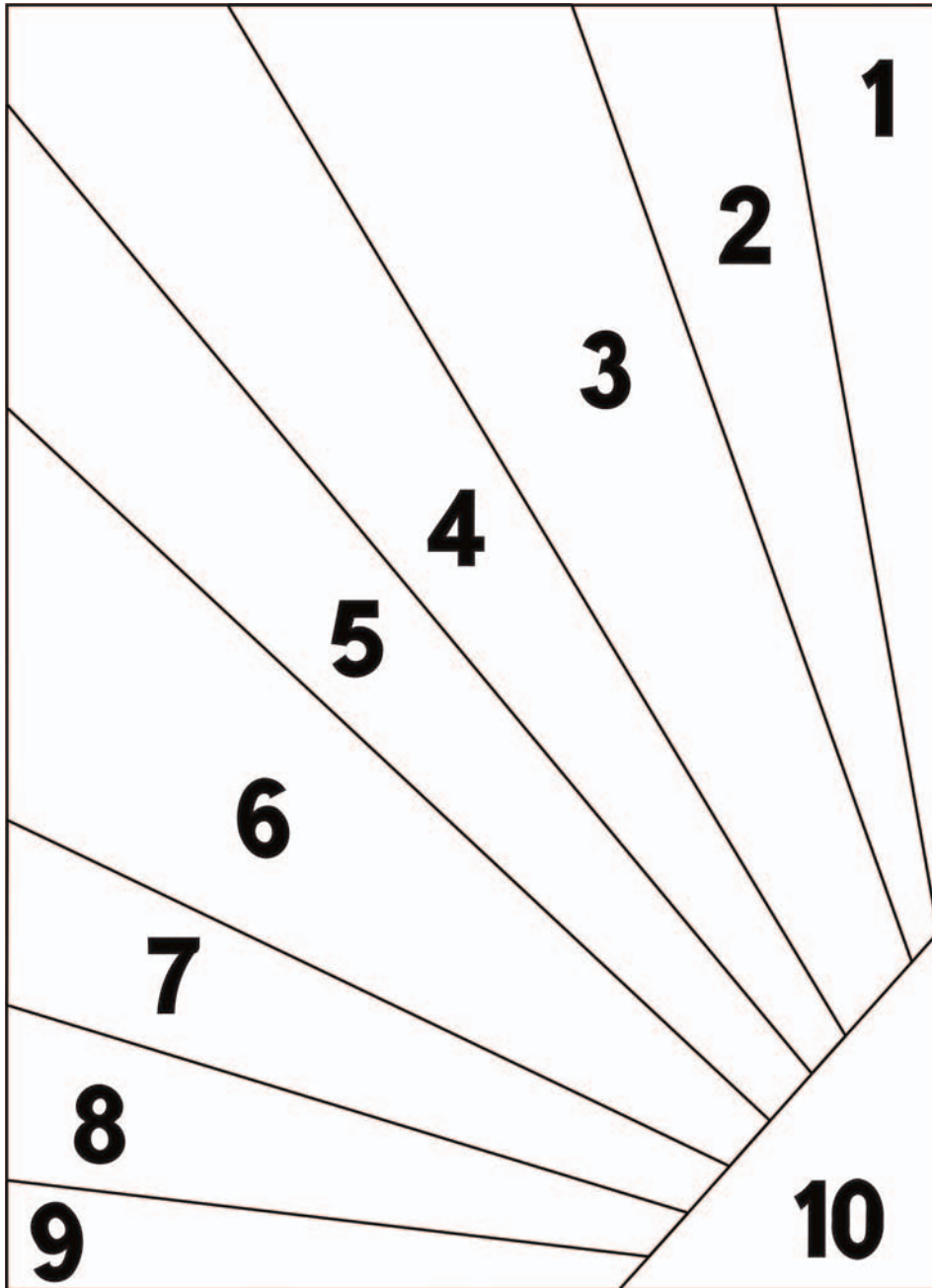

12547-02

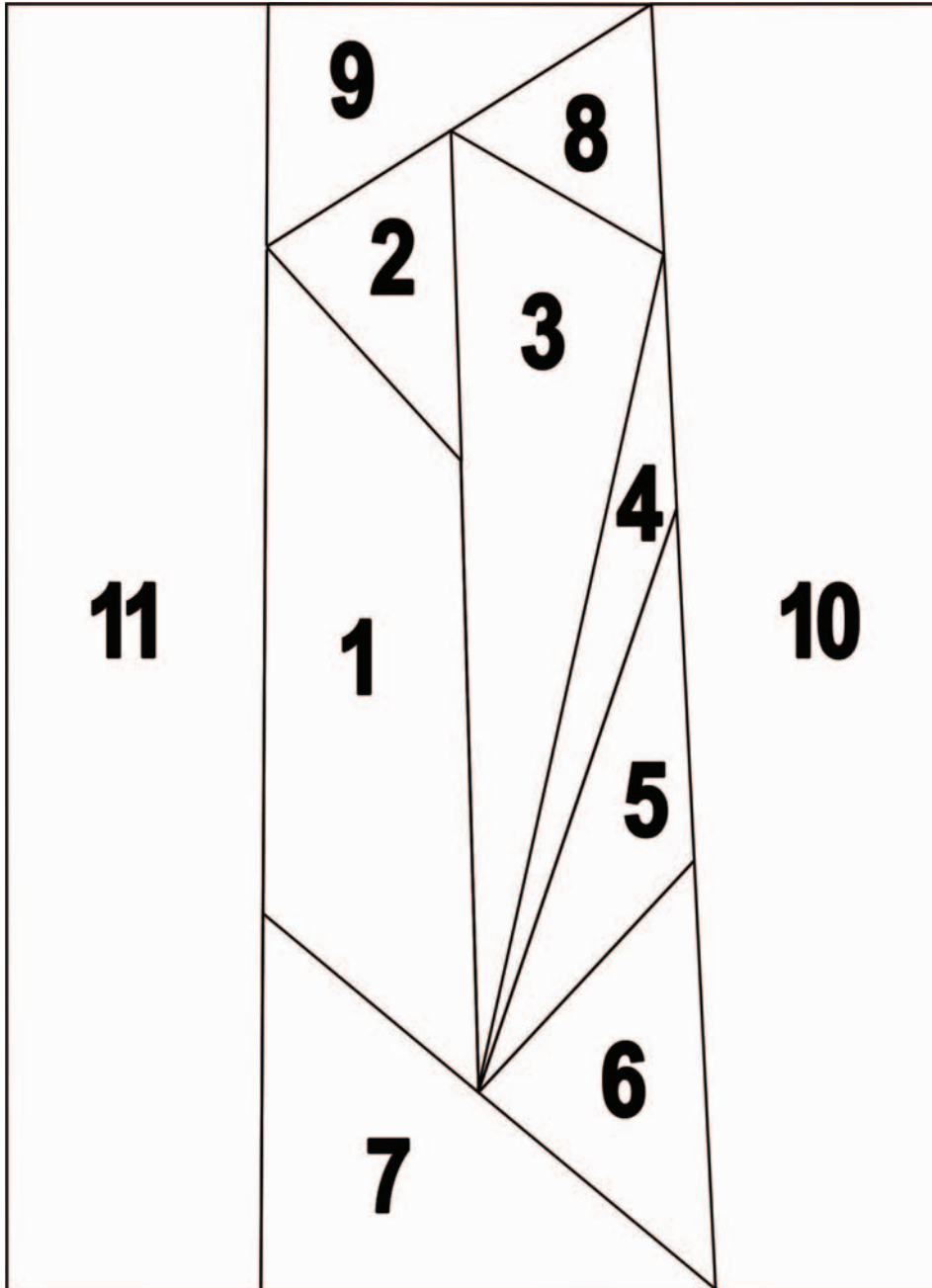

12547-03

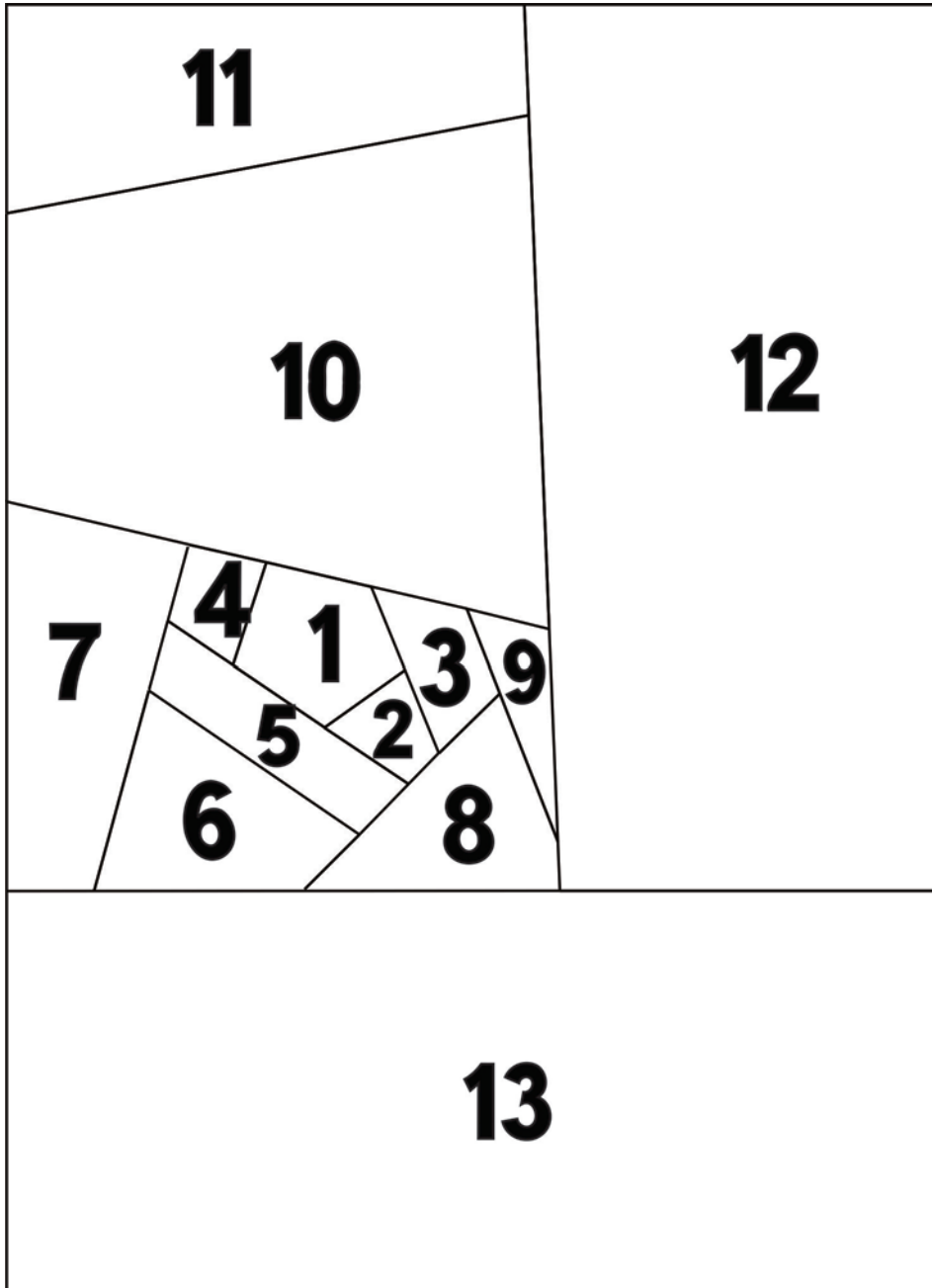

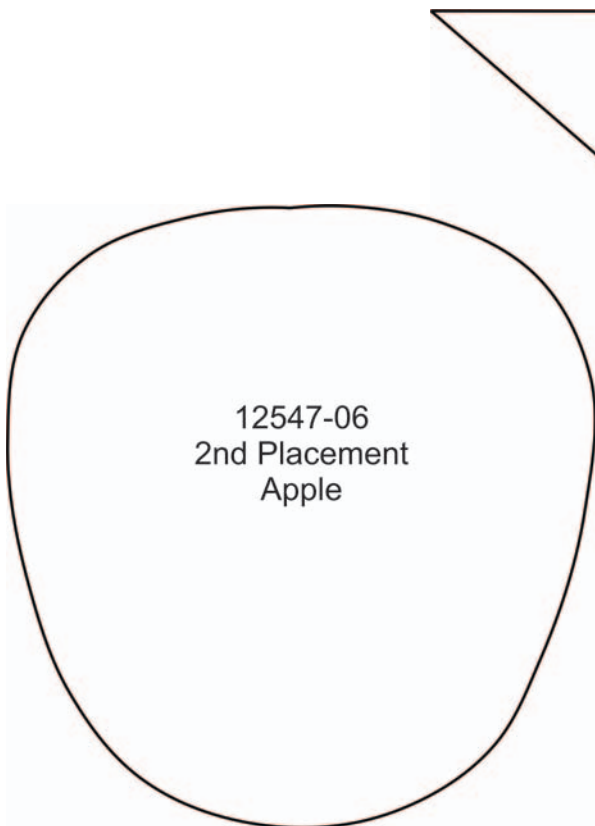
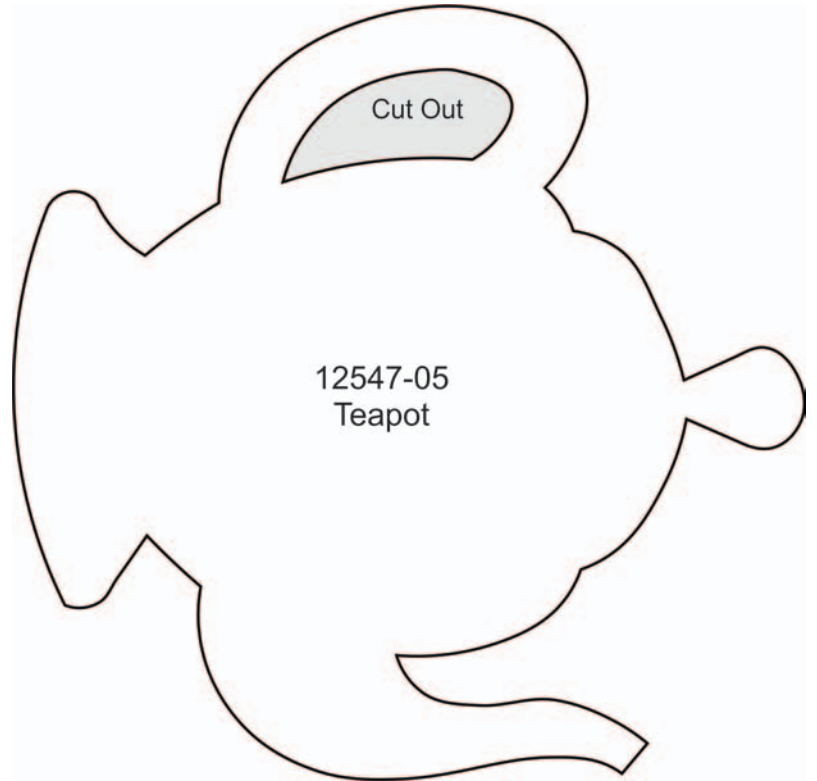
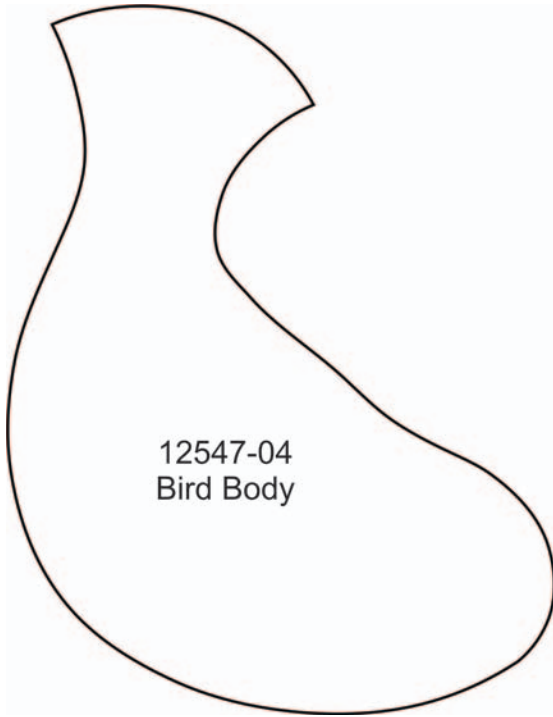

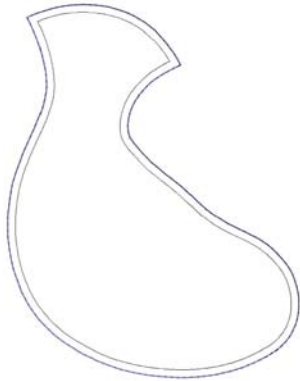

12547-04_CWA Yellow Bird Mug Rug CutWork Appliqué
 3.00 X 3.84 in.
 76.20 X 97.54 mm
 1,400 St.

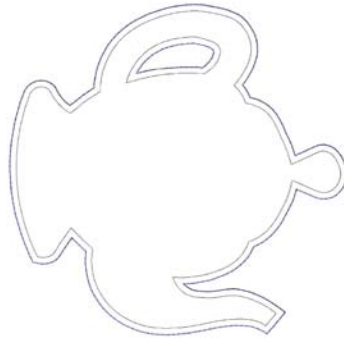

12547-05_CWA Tea Kettle Mug Rug CutWork Appliqué
 4.28 X 4.18 in.
 108.71 X 106.17 mm
 2,500 St.

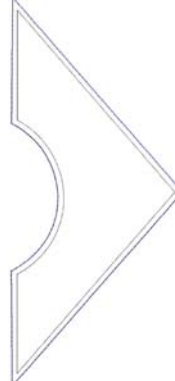

12547-06_CWA_A Apple A Day Mug Rug CutWork Appliqué A
 2.35 X 5.35 in.
 59.69 X 135.89 mm
 1,300 St. **L**



12547-06_CWA_B Apple A Day Mug Rug CutWork Appliqué B
 3.21 X 3.39 in.
 81.53 X 86.11 mm
 1,300 St.

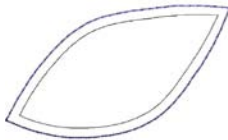

12547-06_CWA_C Apple A Day Mug Rug CutWork Appliqué C
 1.87 X 1.11 in.
 47.50 X 28.19 mm
 600 St. **S**

NOTE: Placement Stitch and Basting Stitch should match your background fabric.

12547-04_CWA Yellow Bird Mug Rug CutWork Appliqué

| | |
|--|-------|
| ■ 1. Basting Stitch | 3600 |
| ■ 2. Bernina CutWork Accessory Cut 1 | Cut 1 |
| ■ 3. Bernina CutWork Accessory Cut 2 | Cut 2 |
| ■ 4. Bernina CutWork Accessory Cut 3 | Cut 3 |
| ■ 5. Bernina CutWork Accessory Cut 4 | Cut 4 |

12547-06_CWA_A Apple A Day Mug Rug CutWork Appliqué A

| | |
|--|-------|
| ■ 1. Basting Stitch | 3600 |
| ■ 2. Bernina CutWork Accessory Cut 1 | Cut 1 |
| ■ 3. Bernina CutWork Accessory Cut 2 | Cut 2 |
| ■ 4. Bernina CutWork Accessory Cut 3 | Cut 3 |
| ■ 5. Bernina CutWork Accessory Cut 4 | Cut 4 |

12547-06_CWA_C Apple A Day Mug Rug CutWork Appliqué C

| | |
|--|-------|
| ■ 1. Basting Stitch | 3600 |
| ■ 2. Bernina CutWork Accessory Cut 1 | Cut 1 |
| ■ 3. Bernina CutWork Accessory Cut 2 | Cut 2 |
| ■ 4. Bernina CutWork Accessory Cut 3 | Cut 3 |
| ■ 5. Bernina CutWork Accessory Cut 4 | Cut 4 |

12547-05_CWA Tea Kettle Mug Rug CutWork Appliqué

| | |
|--|-------|
| ■ 1. Basting Stitch | 3600 |
| ■ 2. Bernina CutWork Accessory Cut 1 | Cut 1 |
| ■ 3. Bernina CutWork Accessory Cut 2 | Cut 2 |
| ■ 4. Bernina CutWork Accessory Cut 3 | Cut 3 |
| ■ 5. Bernina CutWork Accessory Cut 4 | Cut 4 |

12547-06_CWA_B Apple A Day Mug Rug CutWork Appliqué B

| | |
|--|-------|
| ■ 1. Basting Stitch | 3600 |
| ■ 2. Bernina CutWork Accessory Cut 1 | Cut 1 |
| ■ 3. Bernina CutWork Accessory Cut 2 | Cut 2 |
| ■ 4. Bernina CutWork Accessory Cut 3 | Cut 3 |
| ■ 5. Bernina CutWork Accessory Cut 4 | Cut 4 |

L Design is larger than 5" (127 mm) in either direction.
S Design is smaller than 1.5" (38.1 mm) in either direction.