



# MANUAL



GEBRAUCHSANWEISUNG **D**

MANUAL **GB**

MODE D'EMPLOI **F**

[KED-HELMSYSTEME.DE](http://KED-HELMSYSTEME.DE)

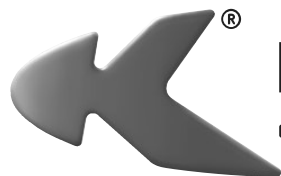

**KED**  
GERMANY

## DE GEBRAUCHSANLEITUNG



KED Fahrradhelme entsprechen der Norm:  
EN 1078:2012+A1:2012  
Verordnung (EU) 2016/425  
Materialprüfungsanstalt Universität Stuttgart (MPA)  
Pfaffenwaldring 32, 70569 Stuttgart  
Notifizierte Stelle: 1080 Reg.-Nr. ZLS-NB-0293

## GB INSTRUCTION FOR USE



KED cycling helmets meet the following standards:  
EN 1078:2012+A1:2012  
Regulation (EU) 2016/425  
Materialprüfungsanstalt Universität Stuttgart (MPA)  
Pfaffenwaldring 32, 70569 Stuttgart  
Notifizierte Stelle: 1080 Reg.-Nr. ZLS-NB-0293

## FR NOTICE D'UTILISATION



Les casques de vélo KED sont conformes à la norme suivante:  
EN 1078:2012+A1:2012  
Regulation (EU) 2016/425  
Materialprüfungsanstalt Universität Stuttgart (MPA)  
Pfaffenwaldring 32, 70569 Stuttgart  
Notifizierte Stelle: 1080 Reg.-Nr. ZLS-NB-0293

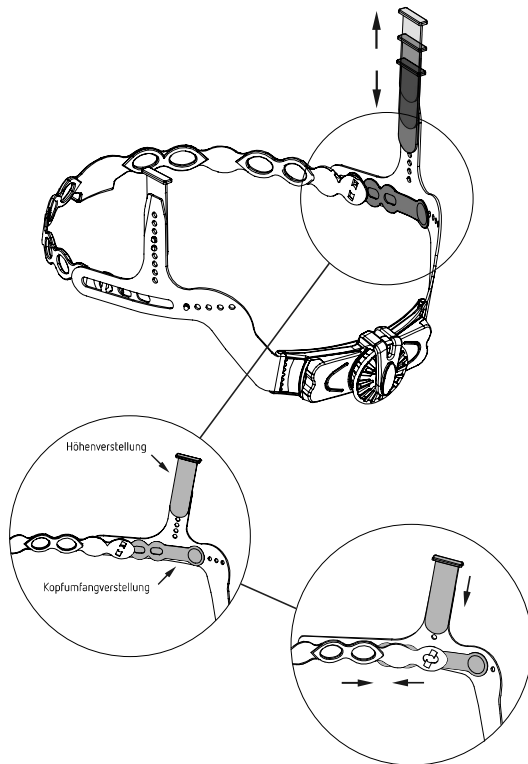
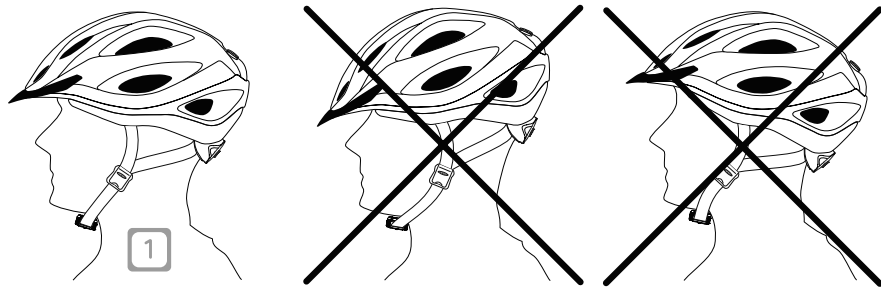
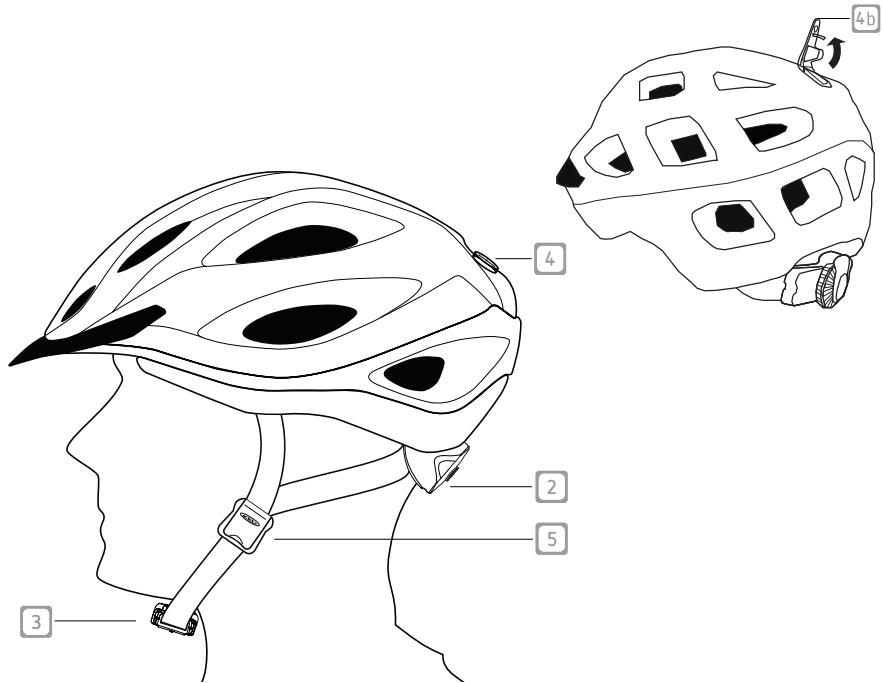

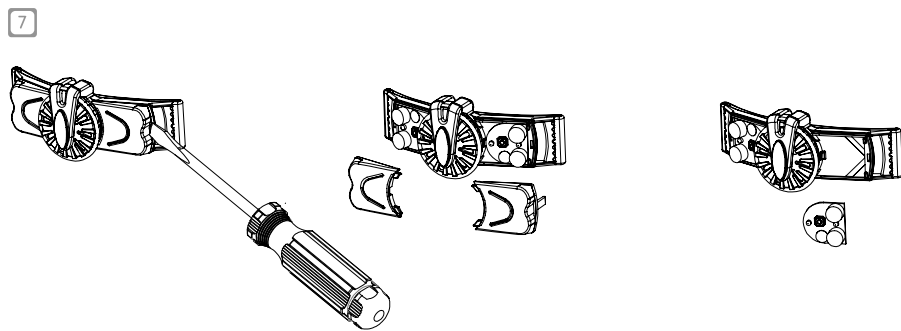
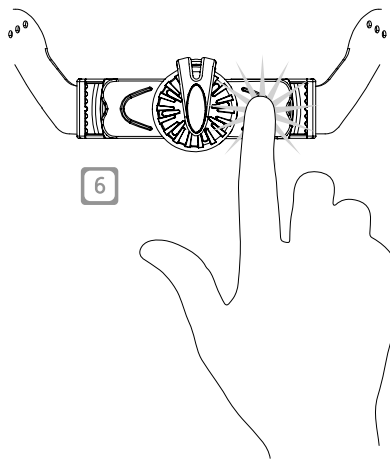
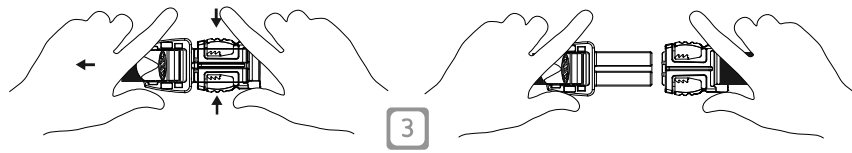
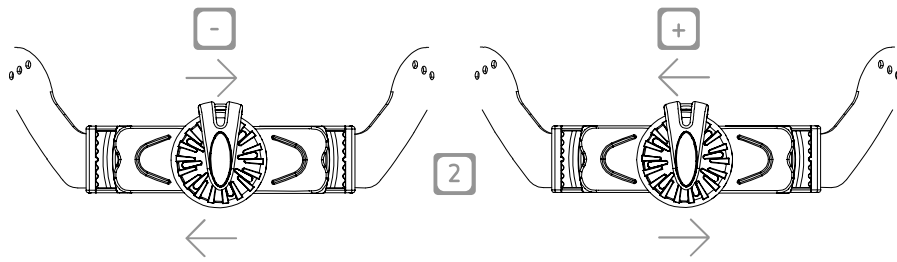

# **GB** INSTRUCTION FOR USE

Thank you for choosing a KED helmet. Protective helmets are part of your personal protection equipment and help avoid head injuries or at least significantly reduce the consequences. Please take some time to read the following instructions and information on adjusting your helmet. It is in the interest of your safety and comfort.

Detailed information and illustrations can be found on the front pages.

## **1. General Information**

According to the current technological standards, this cycling helmet represents the best possible protection for your head against external adverse effects. It can, however, never guarantee complete prevention of injuries. Our cycling helmets fulfil the European standard 1078.

All helmets correspond with the European Regulation (EU) 2016/425 and bear the CE marking. Within the scope of this standard, helmets are tested for shock absorption, slipping, chin strap strength and coverage zones.

## **2. Selecting the right helmet size**

A KED helmet can only protect you if it fits properly. Measure your head circumference at the widest point and then select the right size.

The sizes of KED helmets are found on a label inside the helmet.

The helmet must feel safe and comfortable on your head. Try out different helmets; you will notice initial differences straight away. Look in the mirror - your helmet should suit you too.

## **3. Altering the size adjustment system**

A good fit is a prerequisite for the best possible protection. This is why the helmet is equipped with the QuickSafe adjustment system. The head ring size can be suitably adjusted by turning the adjustment wheel. If you turn the wheel in the „-“ direction the head ring tightens, and then releases when turned in the „+“ direction (see figure 2).

## **4. Correct positioning**

Always position the helmet horizontally on your head, so that your forehead is protected but your vision is not impaired. Your helmet should not be positioned towards the back of your head either (see figure 1).

## **5. Tight fit**

You can check your helmet for a tight fit by shaking your head lightly with the chin strap open. In doing so, the helmet should not slip. An optimal fit is necessary so that the helmet fulfils its safety function 100%.

## **6. Strap adjustment**

a)

If your helmet is equipped with a Quickstopp System (see fig. 4a or 4b), you can fix your strap in the optimum position so that the strap always stays optimally set for you. If your helmet does not have Quickstopp, continue reading at b), and if it does, (fig. 4a) turn the Quickstopp in the „Off“ direction to release the strap or (fig. 4b) open the lever.

b)

Close the clip (see figure 3). Open and slide the belt tensioner (see fig. 5) so that the front and back straps run together behind your ear, and then center the clip-in lock beneath your chin. If the straps are not tight and close-fitting, you need to tighten the excess length of the strap on the clip-in lock. Open the locking plate on the male part and set the strap length. Repeat this step until the belt system is tight and close-fitting. Close the locking plate on the clip-in lock again and close tight on the belt tensioners. The clip-in lock should not be directly against your chin.

c)

The chin strap should be close-fitting but not restrict breathing or swallowing.

d)

Lock the strap in position by turning the Quickstopp, if available, (fig. 4a) to „On“ until it clicks in or (fig. 4b) close the lever until it clicks.

## **7. Extras**

### **7.1 Lighting**

The KED Quicksafe is equipped with flashing lamps. You can switch the lights on and off by pressing (see figure 6).

Battery change: use a narrow flat screwdriver to open the housing (see figure 7), remove the board and replace the batteries.

## **8. Care, cleaning and storage**

The comfortable padding can be cleaned with a moist cloth. A mild soapy solution or diluted, delicate washing powder can be used as a detergent. The padding and straps should be dried at room temperature.

The shell of the helmet should be cleaned with lukewarm water and a mild soapy solution. Do not use any solvents such as thinners or similar products.

Excessively high temperatures or strong UV rays can damage your helmet. It should therefore not be stored in temperatures above 60° C, such as on the back shelf of a car. Do not place it on or near to a source of heat such as an oven. The helmet should simply be kept in a dry place.

The helmet should be checked for visible defects at regular intervals. Minor scratches do not affect your helmet's level of protection.

Only original parts should be used for repairs.

Please consult your dealer.

## **9. Safe use**

This helmet is only suitable for cycling and skating. It is not suitable for other sports such as skiing, motorcycling or riding a scooter.

Check your helmet for a correct fit before setting off. The clip system on the chin strap must be fully closed. The straps must be closely fitted. Please check the helmets of any children accompanying you.

Do not draw or paint on the helmet and do not apply stickers. The inks, paints and glues may contain components that have a negative influence on the stability of your helmet and its protection level.

Do not make any alterations to the helmet shell. Do not drill into it or screw

on any objects.

As a result of a fall or a heavier impact, the protection level of the helmet shell can be adversely affected, even if no external damages can be identified. Therefore, always replace the helmet and never use one involved in an accident! After a maximum of 5 years following the date of manufacture (see date-stamp on helmet) the helmet should be replaced. Please ride carefully, even when wearing a helmet, and do not take any unnecessary risks.

**YOU DON'T HAVE TO BE GOING FAST TO SUSTAIN AN INJURY!**

The protection given by a helmet depends on the circumstances of the accidents, whereby wearing a protective helmet doesn't always prevent a fatal accident or invalidity.

**ALWAYS USE A HELMET WHEN CYCLING AND PROCEED CAREFULLY! A HELMET CAN ONLY PROTECT WHAT IT COVERS!**

Always wear your helmet in the correct position. No helmet can protect uncovered areas of the neck or head.

**HELMETS MAY NOT BE USED BY CHILDREN TO CLIMB OR PLAY IF THERE IS ANY RISK OF STRANGULATION.**

**THE QUICKSAFE IS NOT A SUBSTITUTE FOR A REAR LIGHT ON YOUR BICYCLE!**

The EU Declaration of Conformity for this helmet can be found at:  
[www.ked-helmsysteme.de](http://www.ked-helmsysteme.de)

#### **10. Guarantee**

KED provides a two year guarantee on materials and manufacturing. The guarantee does NOT extend to normal wear and tear, changes to the product made by the customer or accidents caused by incorrect use. The sales receipt with a stamp and the date of purchase is required to check the validity of any guarantee claims.