



# HydroGenerator® Bottle

## USER MANUAL



If you prefer video instructions, just visit our website [www.purify.com](http://www.purify.com), or scan the code to watch a step by step tutorial video on how to set up your HydroGenerator® Bottle!



## 1 Product Structure

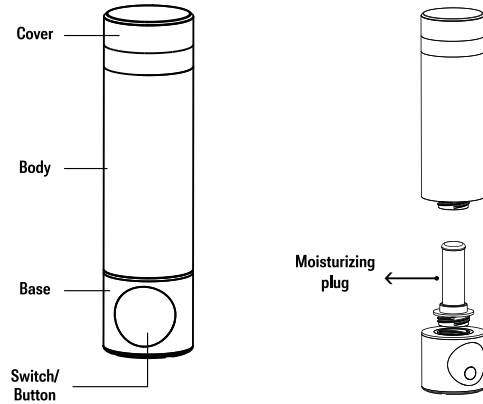

Before using the product for the first time, it is essential to remove the moisturizing plug that comes equipped with the bottle. To do so, detach the bottle body from the base and carefully turn the base upside down to unscrew the moisturizing plug. This will help avoid spilling the water that is inside. Once the moisturizing plug has been removed, reattach the bottle body to the base and ensure that it is firmly secured.

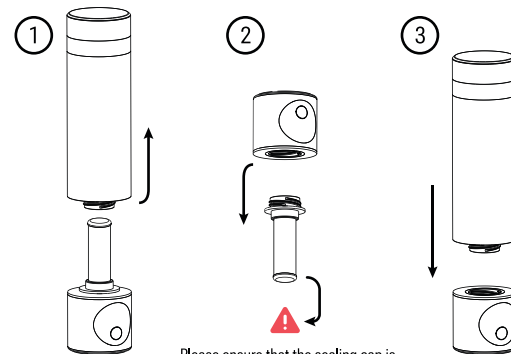

Please ensure that the sealing cap is properly inserted into the Moisturizing plug to prevent any water spillage.



## 2 Notice



- 1 Please use a power adapter of 5V/2A, do not use the unmatched power adapter, to avoid product damage or potential safety hazard.
- 2 Please stay away from the heat and fire



- 3 To avoid damage to the product, please do not disassemble or repair.
- 4 To avoid mechanical failure due to water penetration, please do not wash or immerse in water directly.



- 5 After the electrolysis process, avoid placing the machine upside down or laying it flat.

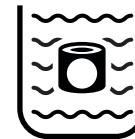

- 6 To prevent damage to the product, avoid soaking it in water. If water is accidentally spilled on the product, promptly wipe it dry.

- 7 Carbonated beverages must not be used to generate high concentrations of hydrogen water due to the high internal pressure that may cause explosion risk.

- 8 Using high-concentration mineral water is prohibited as it may block the proton membrane channel and negatively affect hydrogen production.

- 9 It is not permitted to use tea water as it may generate tea scale minerals or other substances that may affect the quality of the hydrogen water.

- 10 The recommended water types and temperatures are pure water and warm water ranging from 5°C to 60°C.

- 11 Although the hydrogen generated by the product is mostly soluble in water, it is advised to secure the cover when producing hydrogen. As hydrogen dissolves over time, it is recommended to consume the water within 30 minutes of hydrogen generation to ensure high hydrogen concentration. If the hydrogen water has been kept for more than 30 minutes, it is recommended to generate it again to achieve optimal hydrogen concentration.

- 12 To ensure proper storage when not in use, add an appropriate amount of purified water to the cup to keep the membrane electrode moist. Before reuse, clean the product with clean water.

- 13 The presence of water mist is normal since the proton membrane requires a humid environment for storage.

- 14 After the electrolysis process, it is recommended to release pressure by unscrewing the bottle cover. This helps prevent water leakage at the bottom of the bottle under high pressure.

- 15 Please do not start the electrolysis process without water in the bottle.

- 16 Do not exceed the maximum water level when adding water to the bottle.

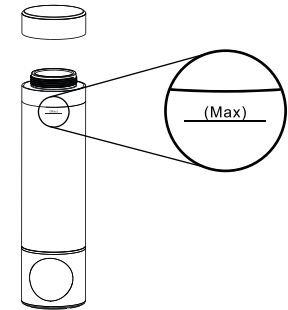



## 3 Usage methods and procedures

**!** Before first use, clean the bottle thoroughly. Then, fill the cup with purified water below 60°C and allow it to soak for 10 minutes. Run the electrolysis process 1-2 times before using the product.

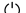
### 1 Start-up

To start the machine, press and hold the  power/mode button for 2 seconds until you hear a "di" sound. The screen will display the remaining power and working time.

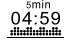
Press and hold  for 2 seconds →  → 

### 2 Selecting the Working Time

#### 2.1 Mode of 5 min

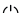
When the screen displays 5min, and the  power/mode button is not tapped within 2 seconds, the LED in the cup will illuminate. The screen will display a dynamic dot matrix flashing, which indicates that the electrolysis process is in progress for the 5-minute mode.

#### 2.2 Mode of 10 min

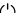
When the screen displays 5min, tap the  power/mode button again to switch to the working mode of 10 min.

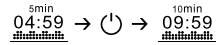

### 3 Switching of time display/PPB display

During operation, press the  power/mode button to switch between the time display and the PPB display.

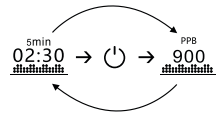

### 4 Finalization



When the electrolysis process is complete, the hydrogen water bottle will emit a "di" sound and then automatically shut down.

### 5 Shutting Down the Product

If you need to terminate the process or turn off the power supply during startup, simply press and hold the  power/mode button for approximately 2 seconds. Once the screen goes out, the power will be turned off automatically.

### 6 Low battery

Press and hold the  power/mode button for at least 2 seconds until you hear a distinctive "di" sound. This indicates that the machine has started, and the remaining power will be displayed on the screen. When the power level drops to only one bar, it means that the product is low on battery, and it's time to charge it. We highly recommend charging the device as soon as possible to avoid running out of power during use.

Press and hold the button for 2 seconds  → 

## 7 The product is completely powerless

If the lightning icon appears on the screen , it means that the product has completely run out of power and cannot operate. In this state, the product is completely powerless and requires a recharge to resume normal functionality.

## 8 Product charging

To charge the product, please use a charger with a rating of 5V/2A. While the device is charging, the battery symbol on the screen will incrementally increase, cycling back and forth. When the battery symbol appears full and no longer fluctuates, it means that the product is fully charged and ready for use.

## 9 Using the Nasal Cannula

1 Disconnect the bottle body from the base.

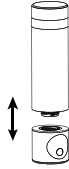

2 Add purified water into the Moisturizing plug and securely attach it to the base of the bottle.



3 Remove the sealing cap located at the top of the Moisturizing plug.



4 Connect the Nasal Cannula to the designated port on the Moisturizing plug.



5 Insert the prongs into your nostrils and start inhaling the hydrogen.

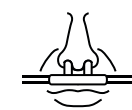

The use of the Nasal Cannula is optional and serves as an additional feature for those who prefer inhalation as a complementary method (for optimal results and maximum benefits of hydrogen intake, we recommend primarily drinking hydrogen water).

## 4 Technical Specifications

Product Specification	Related parameters	Notice
Capacity of the Cup	280ml	
Power	4W	
Battery capacity	1800MAH	
Charger Requirements	Output: 5V/2A	TYPE-C interface
Product Size	Φ60 x 230mm	The diameter is 60 and the height is 230
Hydrogen content in 5 min	1600PPB	
Hydrogen content in 10 min	3000PPB	
Working 5 min on full charge	>12 cycles	
Working 10 min on full charge	>8 cycles	

## 5 Package including



Hydrogen Water Bottle  
1pc



Cable  
1pc



User manual  
1pc



Moisturizing plug  
1pc



Nasal Cannula  
1pc

## 6 Maintenance

- 1 To clean the product, wipe the exterior with a soft, damp cloth. Additionally, make sure to remove any foreign matter that may have accumulated inside the water bottle or on the electrode.
- 2 If the product is not going to be used for an extended period of time, add a small amount of purified water to the bottle to maintain the proton membrane in a moist state.
- 3 After each use, unscrew the bottle cover to release any pressure that may have built up within the bottle.
- 4 If the bottle has not been used for a long period, it is recommended to disinfect the membrane for hygiene purposes. To do so, pour 100ml (3 oz) of lemon juice or white vinegar into the bottle and let it sit for 1 hour. **Do not turn on the device during this time.** After 1 hour, drain the contents of the bottle and thoroughly rinse it with water to remove any residue.

## 7 Common troubleshooting

In the event of any abnormalities occurring during the use of the product, please check the possible causes listed below and take corrective action. If the issue persists, please contact the dealer or the manufacturer for further assistance.

When using the cup for the first time, there are little to no bubbles appearing.

1. Proton membrane is dry or not activated.
2. Add purified water to the container, allow it to soak for 10 minutes, and then perform several rounds of electrolysis to see if the amount of bubbles increases.

The amount of bubbles in the cup may decrease during operation.

This is a normal phenomenon. As the electrolysis progresses, the inner pressure of the cup increases, resulting in a reduction in the amount of bubbles.

Water seepage at the bottom of the cup

It is important to unscrew the cup cover after each electrolysis to release the pressure inside the cup, even if you don't intend to drink the water. Failure to do so may result in a buildup of pressure, so it is strongly recommended to follow this step.