

# INSTRUCTION MANUAL

FPV001

Pet Grooming Kits & Vacuum Cleaner

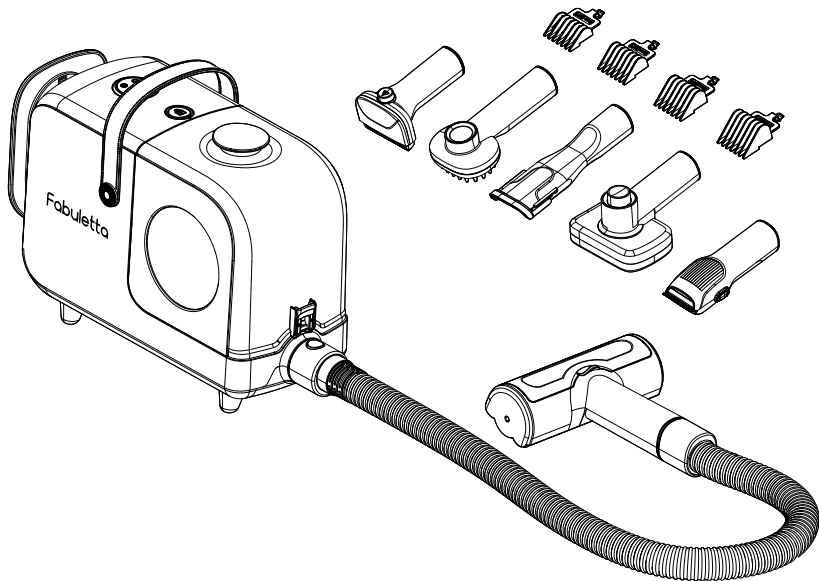

6 IN 1 PET GROOMING KITS & VACUUM CLEANER

## IMPORTANT SAFETY INSTRUCTIONS

---

# IMPORTANT SAFETY INSTRUCTIONS

### BEFORE USING THIS APPLIANCE READ ALL INSTRUCTIONS AND CAUTIONARY MARKINGS IN THIS MANUAL AND ON THE APPLIANCE

When using an electrical appliance, basic precautions should always be followed, including the following:



## WARNING

**These warnings apply to the appliance, and also where applicable, to all tools, accessories, chargers or mains adapters.**

### TO REDUCE THE RISK OF FIRE, ELECTRIC SHOCK OR INJURY:

1. This Fabuletta appliance can be used by children aged from 10 years and above and persons with reduced physical, sensory or reasoning capabilities, or lack of experience and knowledge, only if they have been given supervision or instruction by a responsible person concerning use of the appliance in a safe way and understand the hazards involved. Cleaning and user maintenance should not be performed by children without supervision.
2. **Do not** allow to be used as a toy.  
Close attention is necessary when used by or near children. Children should be supervised to ensure that they do not play with the appliance.
3. Use **only** as described in this Fabuletta Operating Manual. **Do not** carry out any maintenance other than that shown in this manual, or advised by the Fabuletta Support.
4. Suitable for dry locations **ONLY**. **Do not** use outdoors or on wet surfaces.
5. **Do not** handle any part of the plug or appliance with wet hands.
6. **Do not** use with a damaged cable or plug.  
If the supply cable is damaged it must be replaced by Fabuletta, its service agent or similarly qualified person in order to avoid a hazard.
7. If the appliance is not working as it should, has received a sharp blow, has been dropped, damaged, left outdoors, or dropped into water, **do not** use and contact the Fabuletta Support.

## IMPORTANT SAFETY INSTRUCTIONS

---

8. Contact the Fabuletta Support when service or repair is required.  
**Do not** disassemble the appliance as incorrect reassembly may result in an electric shock or fire.
9. **Do not** stretch the cable or place the cable under strain.  
Keep the cable away from heated surfaces. **Do not** close a door on the cable, or pull the cable around sharp edges or corners. Arrange the cable away from traffic areas and where it will not be stepped on or tripped over. **Do not** run over the cable.
10. **Do not** unplug by pulling on the cable. To unplug, grasp the plug, not the cable. The use of an extension cable is not recommended.
11. **Do not** use to pick up water.
12. **Do not** use to pick up flammable or combustible liquids, such as petrol, or use in areas where they or their vapours may be present.
13. **Do not** pick up anything that is burning or smoking, such as cigarettes, matches, or hot ashes.
14. Keep hair, loose clothing, fingers, and all parts of the body away from openings and moving parts, such as the brush bar. **Do not** point the hose, wand or tools at your eyes or ears or put them in your mouth.
15. **Do not** put any object into openings. Do not use with any opening blocked; keep free of dust, lint, hair and anything that may reduce airflow.
16. Use only Fabuletta recommended accessories and replacement parts.
17. **Do not** use without the clear bin and filter in place.
18. Unplug when not in use for extended periods and before maintenance or servicing.
19. Use extra care when cleaning on stairs.
20. **Do not** install, or use this appliance outdoors, in a bathroom or within 3 metres (10 feet) of a pool. **Do not** use on wet surfaces and do not expose to moisture, rain or snow.
21. FIRE WARNING – **Do not** place this product on or near a cooker or any other hot surface and **do not** incinerate this appliance even if it is severely damaged. The battery might catch fire or explode.
22. Always turn 'OFF' the appliance before connecting or disconnecting the motorised brush bar.

## IMPORTANT SAFETY INSTRUCTIONS

---

23. FIRE WARNING – **Do not** apply any fragrance or scented product to the filter(s) of this appliance. The chemicals in such products are known to be flammable and can cause the appliance to catch fire.

**READ AND SAVE THESE  
INSTRUCTIONS**



## SAFETY INSTRUCTION

---

READ AND SAVE THESE INSTRUCTIONS  
THIS MACHINE IS INTENDED FOR HOUSEHOLD  
USE ONLY.

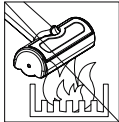

**Do not** use  
near open  
flames.

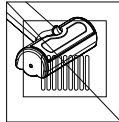

**Do not**  
store near  
heat  
sources.

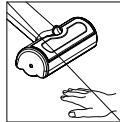

**Do not** put  
hands  
near the  
brush bar  
when the  
machine  
is in use.

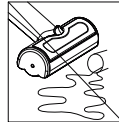

**Do not** pick  
up water or  
liquids.

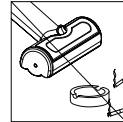

**Do not** pick  
up burning  
objects.

USING YOUR MACHINE  
PLEASE READ THE “SAFETY INSTRUCTIONS”  
IN THIS OPERATING  
MANUAL BEFORE PROCEEDING OPERATION.

- **Do not** use outdoors or on wet surfaces or to vacuum water or other liquids –electric shock could occur.
- Ensure the machine remains upright in use. Dirt and debris may be released if it is turned upside down.
- **Do not** operate while checking for blockages as doing so could result in personal injury.
- For domestic indoor and car use only. **Do not** use it while the car is in motion or while driving.
- Use appropriate mounting hardware for your wall type and ensure that the docking station is mounted securely. Ensure no pipe work (gas, water, air) or electrical cables, wires or ductwork are located directly behind the mounting area.

# PRODUCT INSTRUCTIONS

---

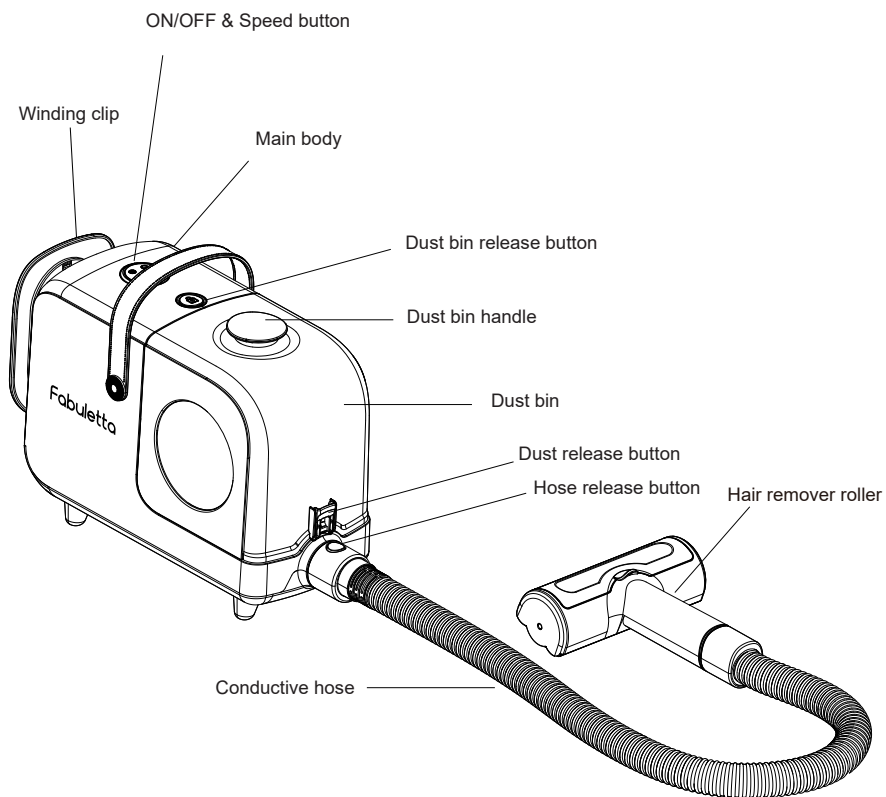

# PRODUCT INSTRUCTIONS

---

FPV001 Accessories:



Conductive hose

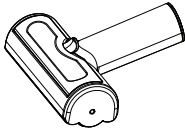

Hair Remover Roller

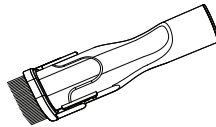

Crevice Tool

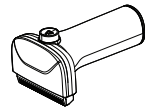

Deshedding Brush

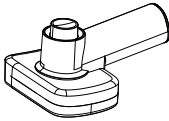

Grooming Brush

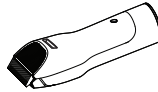

Electric Trimmer

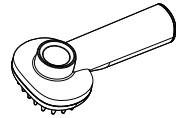

Massage Comb



6mm Guard Comb



12mm Guard Comb



18mm Guard Comb

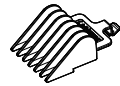

24mm Guard Comb

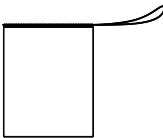

Storage Bag

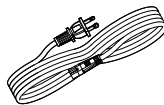

Power Cable

# PRODUCT INSTRUCTIONS

---

## 1) Hair Remover Roller

Used for cleaning the hair on the floor, sofa and clothes and inhale the collecting bin.

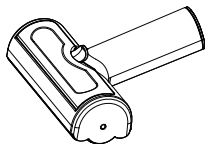

## 2) Crevice Tool

Used for cleaning bookcases, stairs, keyboards and so on.

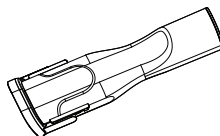

## 3) Deshedding Brush

Used to remove loose or tangled hair of the pet.

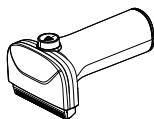

## 4) Grooming Brush

Remove floating, old hair or litter from your pet, and make it more fluffy.

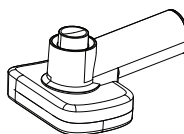

## 5) Electric Trimmer

Shave pet's hair and inhale it. No residue dropping on the floor, no hair flying around.

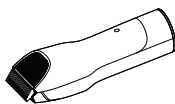

## 6) Massage Comb

Massage your pet's head or body, and your pet will be more gentle and obedient.

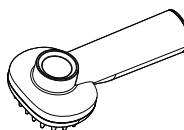

## 7) Guard Comb

Design hairstyles for pets with electric Trimmer.

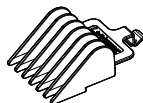

## 8) Storage Bag

Used for store accessories.



# PRODUCT INSTRUCTIONS

---

## Product Installation

I. Use as pet grooming kits & vacuum cleaner.

1. Insert the Conductive hose into the body until you hear a CLICK.

Insert the Electric Timmer to the head of the Conductive hose until you hear a CLICK.

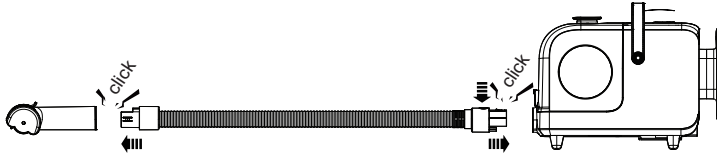

2. Press ON/OFF button, the machine will start work at low suction level.

01	Low suction level
02	Middle suction level
03	High suction level

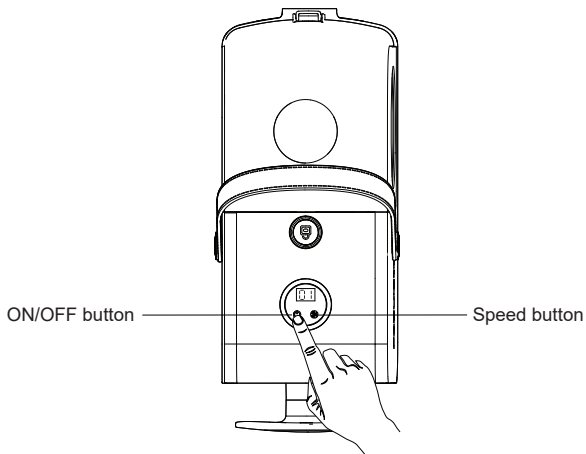

a) Press the speed button, the machine will work at low suction level, switch to middle and high suction level by pressing SPEED button again.

b) When the machine is working at any suction, press the ON/OFF button, the machine will stop working.

# PRODUCT INSTRUCTIONS

---

## II. Use with other accessories

Put the hose into one of the accessories until you hear a CLICK.

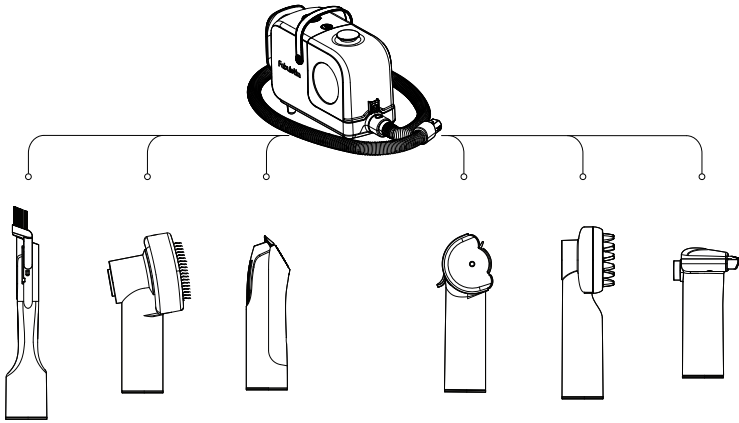

Put the guard comb to electric trimmer until you hear a CLICK.

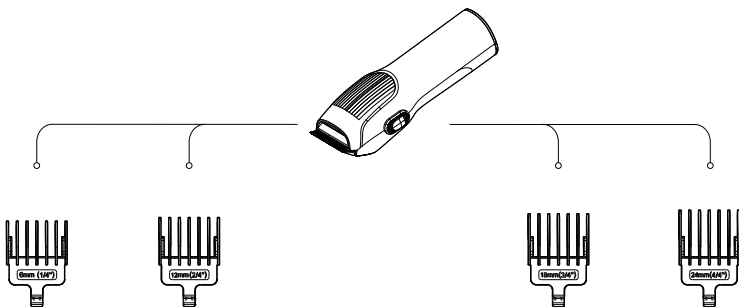

# PRODUCT INSTRUCTIONS

---

## III. How to empty the dust bin

- 1) Press the dust bin release button, and take the dust bin out .

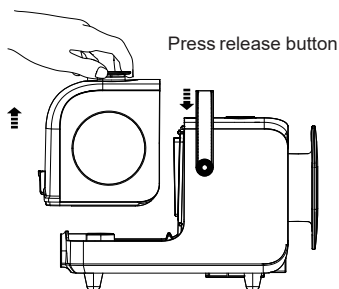

- 2) Push the dust release button and open the dust bin as below.

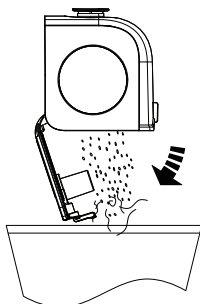

- 3) Take the sponge & HEPA filter off as below.

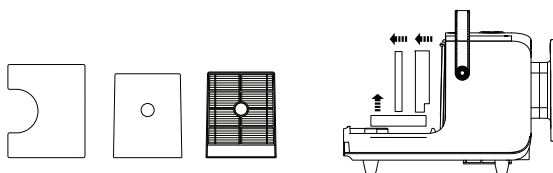

### Note:

1. Can be washed and reused after completely drying for 24 hours.
2. Rinse the filter sponge with cold water at least once a month.
3. For different use frequency and conditions, the maintenance period is also different, regularly check if the dirt has been cleaned.
4. When cleaning, make sure to cut off the power, and unplug from the socket.
5. Be sure to install the filter sponge after it is completely dry, as moist filter sponge may cause electric shock or power failure.

# DEMOLITION INSTRUCTIONS

---

IV.How to install the sponge &HEPA filter and the dust bin

- 1) Put the the sponge &HEPA filter back into the main body .

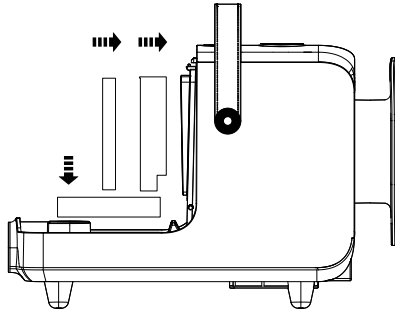

- 2) Put the dust bin to the main body and press dust bin handle until you hear a CLICK.

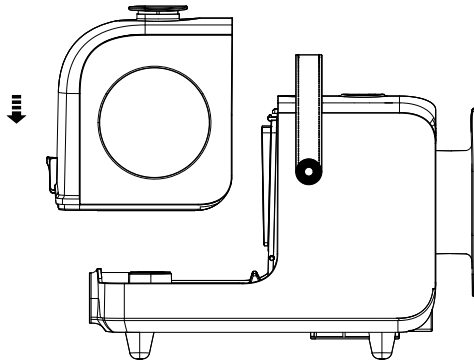



## DISMANTLE INSTRUCTIONS

---

V. How to clean the Electric Trimmer

1) Remove the Electric Trimmer from the conductive hose.

2) Remove the Guard Comb as below.

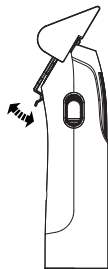

3) Remove the trimmer head as below.



4) Remove residual hair from the suction port.

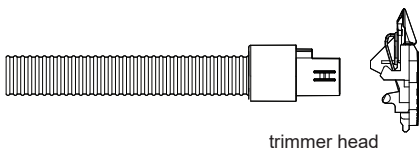

trimmer head

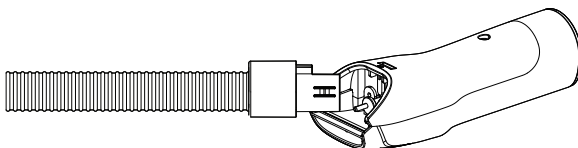

trimmer holder

## DISMANTLE INSTRUCTIONS

---

- 5) Put the trimmer head back into the trimmer holder as Figure 1.
- 6) Hold the trimmer head, then press the trimmer head until you hear a CLICK. Refer to Figure 2.

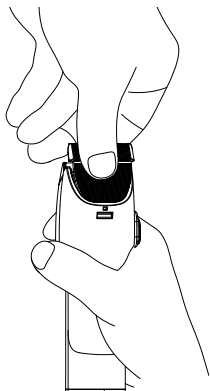

Figure 1

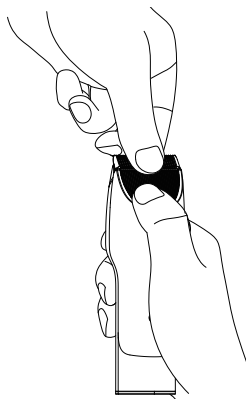

Figure 2

- 7).Please scan the QR code to view the Electric Trimmer cleaning video.



# SAFETY INSTRUCTION

---

## MACHINE MAINTENANCE

- **Do not** carry out any maintenance or repair work other than that shown and described in this Operating Manual.
- Store the machine indoors.  
Ensure the machine is at room temperature before operating.
- Clean the machine **only** with a dry cloth. **Do not** use any lubricants, cleaning agents, polishes or air fresheners on any part of the machine.

## VACUUMING

- **Do not** use without the dust bin and filters in place.
- **Do not** use the machine to pick up sharp hard objects, small toys, pins, paperclips, etc. They may damage the machine.
- When vacuuming, pet hair, or sofa may generate small static charges in the dust bin or wand. These are harmless and won't cause any electrical hazards. To minimize any effect from this, **do not** put your hand or insert any object into the dust bin before emptying the dust bin. Clean the dust bin with a damp cloth only.
- **Do not** rest the machine on chairs, tables, etc.
- **Do not** press down on the nozzle with excessive force when using the machine as this may cause damage.

## EMPTYING THE DUST BIN

1. To minimize dust/allergen contact when emptying, encase the dust bin tightly in a plastic bag.
2. Remove the dust bin carefully from the bag.
3. Seal the bag tightly, dispose as normal.

## SAFETY INSTRUCTION

---

### CLEANING THE DUST BIN

- Ensure the machine is unplugged the outlet before removing the dust bin.
- Clean the dust bin with a damp cloth only.
- **Do not** use detergents, polishes or air fresheners to clean the dust bin.
- **Do not** put the dust bin in a dishwasher.
- Ensure the dust bin is completely dry before replacing.
- To replace the dust bin, align the tabs on the dust bin with the grooves on the main body and press down until the tabs CLICK.

### CLEANING THE FILTERS

- Make sure the machine is unplugged before removing the filter.
- Regular check and cleaning of the filter according to the instructions can ensure the normal performance of the appliance .
- If the appliance is used frequently, the filter may need to be cleaned more frequently.
- To remove the dust bin, take out the sponge and HEPA filter from the main body.
- Clean the filter at least once a month.
- Suggest to replace the filters every 3 (three) months.
- **Do not** put the filter in a dishwasher, washing machine, tumble dryer, oven, microwave or near an open flame.
- To reinstall, put the filters back into the main body. Make sure it is installed correctly.

## TROUBLESHOOTING & TECHNICAL SPECIFICATION

---

### TROUBLE SHOOTING

Problem	Solutions
No power on	<ol style="list-style-type: none"><li>1. Make sure the power cable is properly connected to the outlet.</li><li>2. Make sure the power cable is properly connected to the machine.</li><li>3. Make sure to press ON/OFF button.</li></ol>
Stop or doesn't work	<ol style="list-style-type: none"><li>1. Power cable is disconnect.</li><li>2. Hose clogged leading to protection, cleaning the dust bin.</li><li>3. Over working may lead to overheat, restart after cooling down.</li></ol>
Suction poor	<ol style="list-style-type: none"><li>1. Hose clogged leading to protection.</li><li>2. Dust bin full, cleaning the dust bin.</li></ol>
The Electric Trimmer is not power on	<ol style="list-style-type: none"><li>1. The conductive hose is not well connected to the machine</li><li>2. The electric clipper is not well connected with the conductive hose</li><li>3. The machine or trimmer is not turned on</li><li>4. Electric clippers blocked by hair, The screen displays <b>E1</b>, reference How to clean the Electric Trimmer.</li></ol>

### TECHNICAL SPECIFICATION

Input Voltage	AC 120V 60Hz
Rated Power	350W
Net. weight	1.8kg
Vacuum	MAX. 11KPA

## **Fabuletta ONE-YEAR WARRANTY**

---

The One-Year Limited Warranty is valid for products purchased from our Fabuletta only, starting from the date of original retail purchase against defects in quality and materials under normal, non-commercial use.

According to the requirements outlined in this instruction manual, subject to the following conditions and exclusions.

### **WHAT IS COVERED**

The repair or replacement of your Fabuletta appliance if your Fabuletta appliance is found to be defective due to faulty materials, workmanship or function within one year of purchase or delivery (if any part is no longer available or out of manufacture, Fabuletta will replace it with a functional replacement part).

This warranty provides, at no extra cost to you, all labor and parts necessary to ensure your machine is in proper operating condition during the warranty period.

### **WHAT IS NOT COVERED**

Under your Fabuletta guarantee, Fabuletta shall not be liable for costs of repair or replacement of a product incurred as a result of: Accidental damage, faults caused by negligent use or care, misuse, neglect, careless operation or handling of the Fabuletta appliance which is not in accordance with this Fabuletta Operating Manual  
Machines purchased from an unauthorized dealer.

Use of parts and accessories other than those produced or recommended by Fabuletta.

Repairs or alterations carried out by unauthorized parties or agents.

Use of the machine other than for normal domestic purposes within the United States, e.g. for commercial or rental purposes.

### **WARRANTY SERVICE**

If you have a query about your Fabuletta appliance, please contact the Fabuletta customer service email : [support.us@fabuletta.com](mailto:support.us@fabuletta.com)  
Please inform us your model name/number, purchase date ,order number, machine problem and your requirement.

Your model number can be found on rating plate. For information on your rating plate see the inside front cover.

Please keep your purchase receipt in a safe place to ensure you have this information.

Service under this warranty will not extend the period of this warranty.

## We're Here to Help!

---

If you have any questions about our products, please contact our customer support team.

✉ [support.us@fabuletta.com](mailto:support.us@fabuletta.com)

[support@fabuletta.com](mailto:support@fabuletta.com)



[www.Fabuletta.com](http://www.Fabuletta.com)

\*Please have your invoice and order ID ready before contacting Customer Support.

**Thanks for your purchase!**  
**Hope you will love it as much as we do.**

# Fabuletta

Start your fabulous life with Fabuletta

