

Before beginning, read the instructions below and follow all local plumbing and building codes.

Unpack and inspect your new water lines for any shipping damages and ensure no pieces are missing.

If any damages are discovered DO NOT INSTALL.

SHUT OFF ALL WATER AT THE TUB WHEN INSTALLING.

### TOOLS AND MATERIALS NEEDED :

Adjustable Wrench	Plumber's Tape	Level
-------------------	----------------	-------

Because tubs can vary in size, measure your working space thoroughly before installation. Trim pipes accordingly to ensure a correct fit.

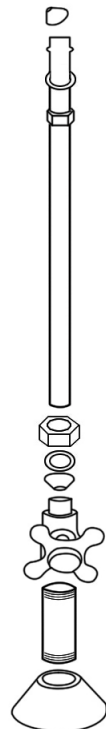
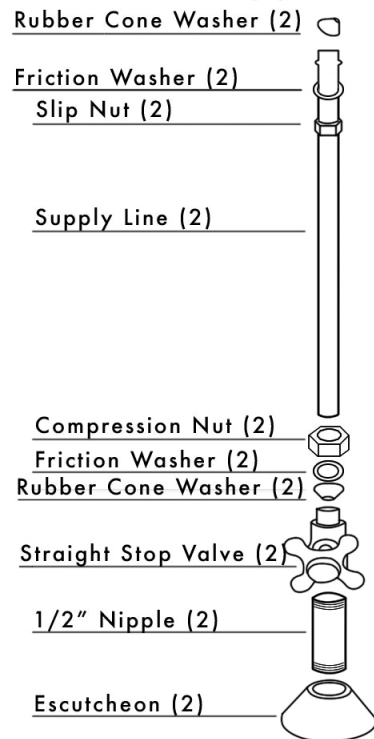

It is always suggested to apply plumber's tape to any threads before installation

1. Locate the nipple. Attach the nipple to the water supply on the floor. Slide the escutcheon down to cover the connection.

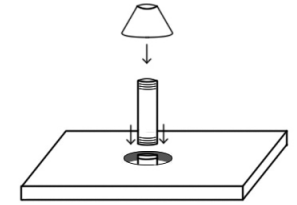

2. Once the nipple is tightened down, thread the straight stop valve onto the nipple. The handle on the valve should be facing away from the tub for easy access. On top of the valve will be a compression nut, friction washer, and rubber cone washer. Take these off for the next step.

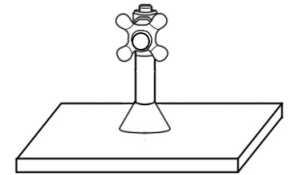

3. Take a friction washer and slip nut and slide them onto a supply line. The slip nut needs to be upside down when placing it on the supply line for later steps.

Place the compression nut, friction washer, and rubber cone washer on the end of one of the supply lines in that order. Next, place the end of the supply line into the top of the stop valve and tighten the nut down. The waterline can still move freely so do not pull up when adjusting or it will be pulled out.

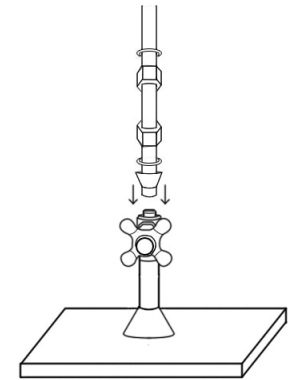

4. On the opposite end of the supply line, take a rubber cone washer and place it on the supply line with the flat side against the lip in the lines. Slide the slip nut and friction washer that you put on the pipe in step 3, up to the top of the lines. Tighten the nut to the faucet through the mouting holes of the tub.

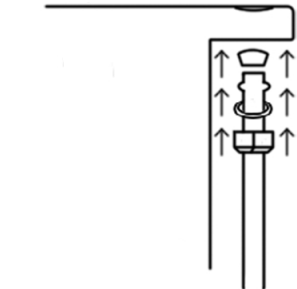

5. Repeat all the steps for the second water line and once fully installed, turn on the water to test for leaks.