

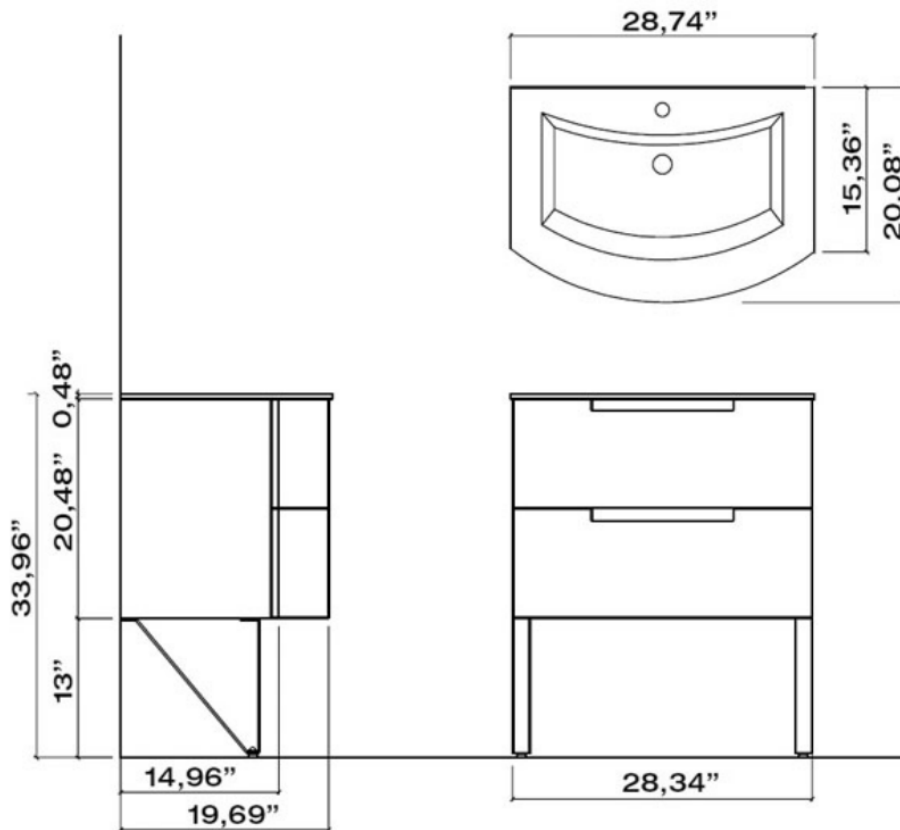

OA39OPT1



Oasi 39" Vanity
38.19" x 20.08" x 20.96"
WT: 113LBS
Includes: L036 (vanity), LV048 (sink)



Bath/Vanities

OA39OPT1

Oasi 39" Vanity

STANDARDS

- Compliant with ASME A112.18.1-B125.1
- Compliant with AB1953
- Compliant with ANSI NSF61 – Annex G
- Certified by CSA International
- Compliant with ANSI A117.1

| Finishes | OA39OPT1B | OA39OPT1W | OA39OPT1R | OA39OPT1G | OA39OPT1T | OA39OPT1S |
|-----------------|-----------|-----------|-----------|-----------|-----------|-----------|
| Black Glossy | X | | | | | |
| White Glossy | | X | | | | |
| Red Glossy | | | X | | | |
| Grey Glossy | | | | X | | |
| Slate Glossy | | | | | X | |
| Sand Glossy | | | | | | X |

| Features | OA39OPT1B | OA39OPT1W | OA39OPT1R | OA39OPT1G | OA39OPT1T | OA39OPT1S |
|--|-----------|-----------|-----------|-----------|-----------|-----------|
| Two (2) Soft Close Drawers | X | X | X | X | X | X |
| Tekorlux Sink Top With Overflow | X | X | X | X | X | X |
| Wall Mounted Unit (hardware included) | X | X | X | X | X | X |
| Legs Available OA-AM-LEGS (sold sep.) | X | X | X | X | X | X |
| Step-by-Step Installation Instructions | X | X | X | X | X | X |
| Limited Lifetime Warranty | X | X | X | X | X | X |