

series
Quadro



- | | | | |
|---|---|---|---|
| CR | PW | OK | BL |
|  |  |  |  |
| CHROME | BRUSHED
NICKEL | MATT GOLD
PVD | MATT BLACK
PVD |



QU..211

Single handle lavatory faucet with lever handle.
 6.7/16" overall height.
 5.9/16" spout reach.
 2 3/4" maximum deck thickness.
 Pop up drain included.

Flow Rate: 1.2 GPM @ 60 PSI

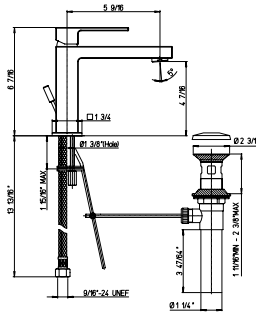

\$275,00 \$374,00 \$412,50

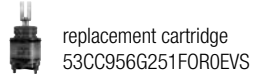

replacement cartridge
 53CC956G251FOR0EVS

QU..211LL

Single handle tall lavatory faucet with lever handle.
 10.15/16" overall height.
 5.9/16" spout reach.
 2 3/4" maximum deck thickness.
 Push drain included.

Flow Rate: 1.2 GPM @ 60 PSI

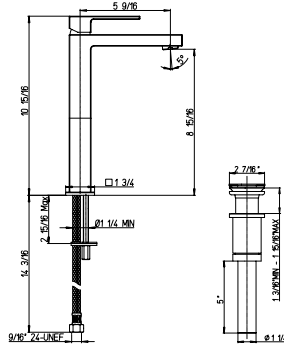

\$385,00 \$506,00 \$533,50

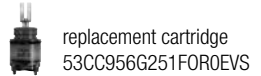

replacement cartridge
 53CC956G251FOR0EVS

QU..208

Single-lever wall mounted mixer with plate
 9" spout reach.

Flow Rate: 1.2 GPM @ 60 PSI

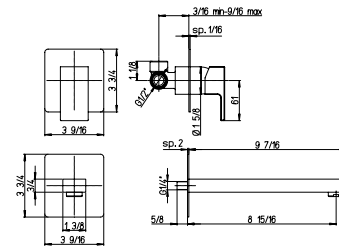

\$330,00 \$385,00 \$412,50



replacement cartridge
 53CC956GM

QU..214

Widespread lavatory faucet with lever handles.
 8" centers.
 5.3/4" spout height.
 6.1/2" spout reach.
 2 3/4" maximum deck thickness.
 Push drain included.

Flow Rate: 1.2 GPM @ 60 PSI

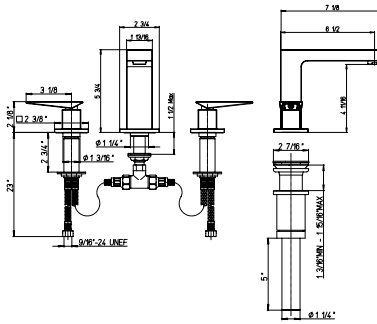

\$577,50 \$715,00 \$770,00



replacement valve
 53CC581XAD right
 53CC581XAS left

QU..102

Roman tub with lever handles.
 3" spout height.
 9 3/4" spout reach.
 2 3/4" maximum deck thickness.

Flow Rate: 9.6 GPM @ 60 PSI

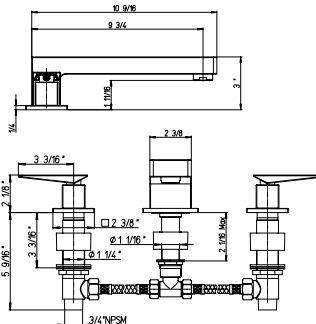
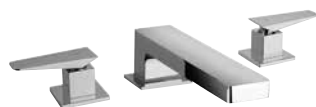

\$660,00 \$770,00 \$825,00





replacement valve
 53CC5813/4D right
 53CC5813/4S left

QU..109
\$960,00 \$1.120,00 \$1.225,00

Roman tub with lever handles and a diverter with hand held shower.
 3" spout height.
 9 3/4" spout reach.
 2 3/4" maximum deck thickness.

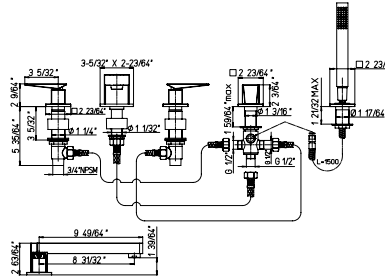
Flow Rate: 9.6 GPM @ 60 PSI
 Flow Rate and spray: 1.2 GPM @ 60 PSI



 replacement valve
 53CC5813/4D right
 53CC5813/4S left

QU..136
\$1.430,00 \$1.650,00 \$1.760,00

Floor mounted tub filler.
 Single Hole Free-Standing
 Tub Filler with Hand held shower.
 78" flexible hose.

Flow Rate: 9.6 GPM @ 60 PSI
 Flow Rate and spray: 1.8 GPM @ 80 PSI

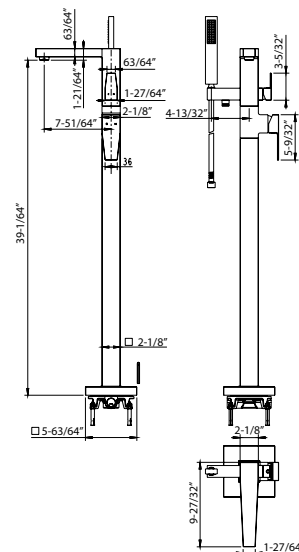
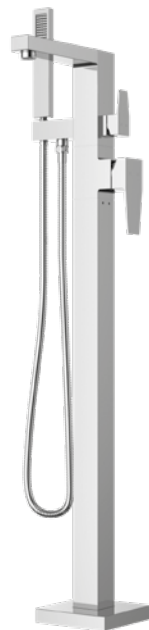
NEEDS ROUGH VALVE 136

 replacement valve
 diverter cartridge
 53CC956G25
 volume control
 53CC956G11

VALVE 136
\$192,50

Rough-in Valve
 3/4" inlet connections

Flows 9.0 GPM @ 60 PSI

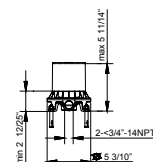
VALVE 697
\$110,00

Pressure Balance
 Rough-in Valve
 1/2" inlet connections

Flows 5.0 GPM @ 60 PSI

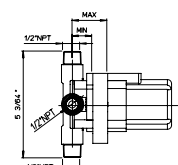

VALVE 788

Pressure Balance
Rough-in Valve
½" inch inlet connections

Flows 5.0 GPM @ 60 PSI

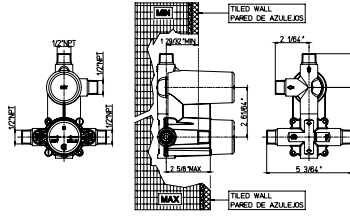

\$154,00

VALVE 690

Thermostatic Valve
with ¼" volume control
½" inch inlet connections

Flows 7.1 GPM @ 60 PSI

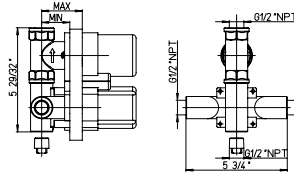

\$190,00

VALVE 691

Thermostatic Valve
2 ways diverter cartridge
½" inch inlet connections

Flows 5.5 GPM @ 60 PSI

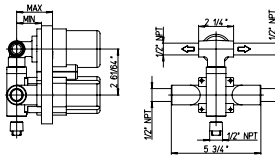

\$200,00

VALVE 711

Thermostatic Valve
¾" inch inlet connections

Flows 9.6 GPM @ 60 PSI

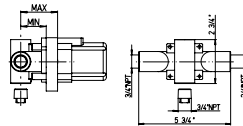

\$154,00

VALVE 400

½" Volume Control
¾" inch inlet connections
Flows 12.5 GPM @ 60 PSI

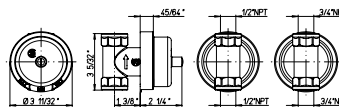

\$82,50

VALVE 402

¾" Volume Control
¾" inch inlet connections
Flows 15.0 GPM @ 60 PSI

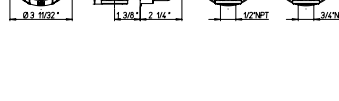

\$82,50

VALVE 425

3 ways Diverter Rough-in Valve
½" inch inlet connections

Flows 9.7 GPM @ 60 PSI

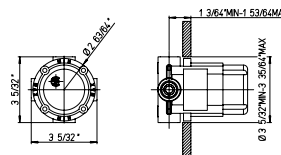

\$137,50

QU..697

Pressure balance valve shower set.

NEEDS ROUGH VALVE 697

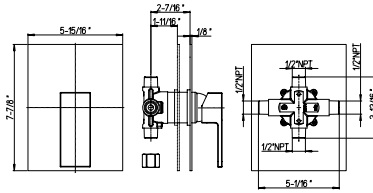

\$220,00 \$258,50 \$286,00

QU..788

Pressure balance valve tub and shower set.

NEEDS ROUGH VALVE 788

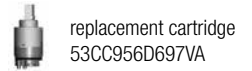
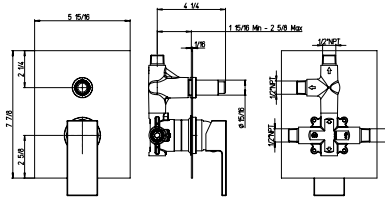

\$247,50 \$286,00 \$313,50

QU..690

Thermostatic valve with 3/4" ceramic disc volume control.

NEEDS ROUGH VALVE 690

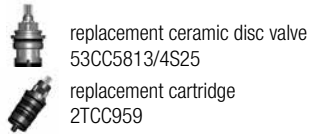
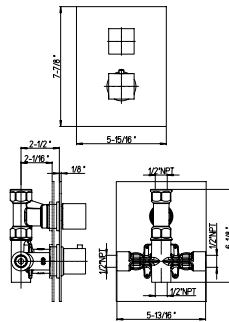

\$361,50 \$412,50 \$440,00

QU..691

Thermostatic valve with 2 way diverter volume control.

NEEDS ROUGH VALVE 691

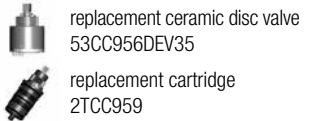
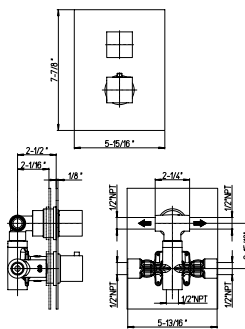

\$402,50 \$456,50 \$484,00

QU..711

3/4" thermostatic valve only.

NEEDS ROUGH VALVE 711

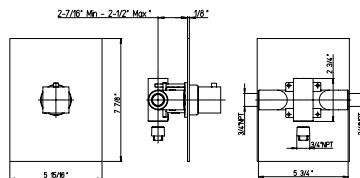

\$267,00 \$350,00 \$377,00

QU.400

Volume control trim kit.

NEEDS ROUGH VALVE 400 OR 402

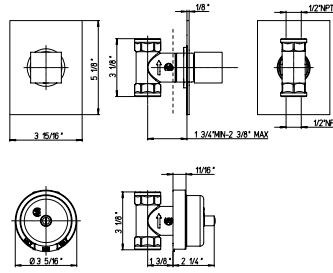

\$181,50	\$220,00	\$247,50
----------	----------	----------



replacement ceramic disc valve
53CC5813/4S25

QU.425

3 way diverter. 3/4" ceramic disc valve. 1/2" inlet connections.

NEEDS ROUGH VALVE 425

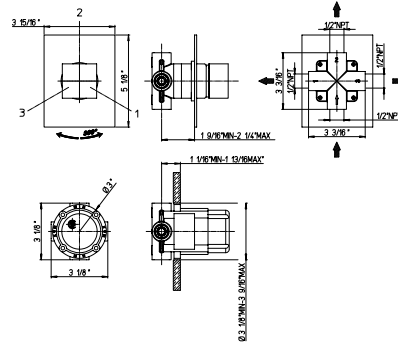

\$181,50	\$220,00	\$247,50
----------	----------	----------



replacement diverter cartridge
FR53CC956DRG40

KIT 1

Pressure balance tub & shower KIT including:
 - 8" Brass Square rain shower head - Anti Limestone
 - 12" Brass Square wall mounted arm & flange
 - Trim 788 with diverter & ceramic disc valve cartridge
 - Rough in valve 788
 - 8 17/64" Brass tub spout
 1/2" NPT inlet connections

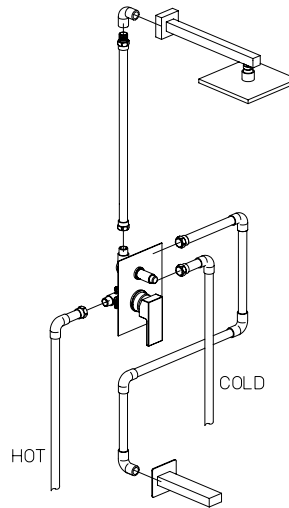

\$770,00	\$902,00	\$1.017,00
----------	----------	------------

KIT 2

Thermostatic tub & shower KIT including:
 - 8" Brass Square rain shower head - Anti Limestone
 - 12" Brass Square wall mounted arm & flange
 - Trim 691 with thermostatic valve & 2 way diverter volume control
 - Rough in valve 691
 - 8 17/64" Brass tub spout
 1/2" NPT inlet connections

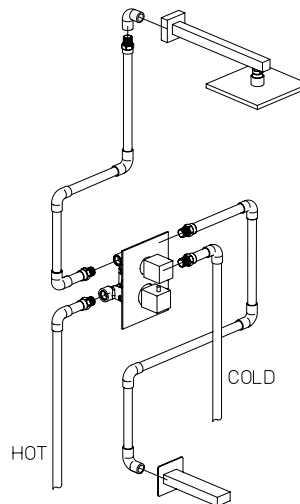

\$931,00	\$1.076,00	\$1.190,00
----------	------------	------------

KIT 3

Pressure balance shower KIT including:
 - 8" Brass Square rain shower head - Anti Limestone
 - 12" Brass Square wall mounted arm & flange
 - Trim 697 ceramic disc valve cartridge
 - Rough in valve 697
 1/2" inlet connections

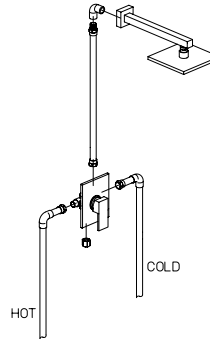

\$546,00	\$647,00	\$740,00
----------	----------	----------

KIT 4

Thermostatic shower KIT including:
 - 8" Brass Square rain shower head - Anti Limestone
 - 12" Brass Square wall mounted arm & flange
 - Trim 690 with thermostatic valve & 3/4" ceramic disc volume control
 - Rough in valve 690
 1/2" inlet connections

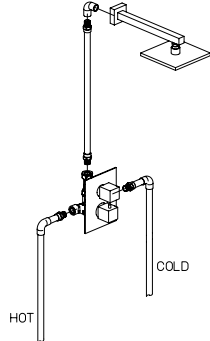

\$723,00	\$834,00	\$927,00
----------	----------	----------

KIT 5

Pressure balance hand shower KIT including:
 - 8" Brass Square rain shower head - Anti Limestone
 - 12" Brass Square wall mounted arm & flange
 - Trim 788 with diverter & ceramic disc valve cartridge
 - Rough in valve 788
 - Square wall mounted brass handshower set including 1-jet square handshower, wall mounted bracket & supply elbow + flange, 78" flexible hose
 1/2" inlet connections

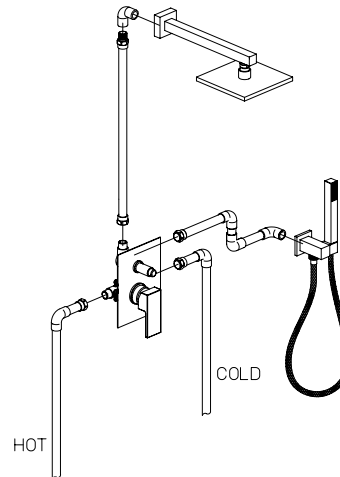

\$762,00	\$907,00	\$1.034,00
----------	----------	------------

KIT 6

Thermostatic hand shower KIT including:
 - 8" Brass Square rain shower head - Anti Limestone
 - 12" Brass Square wall mounted arm & flange
 - Trim 691 with thermostatic valve & 2 way diverter volume control
 - Rough in valve 691
 - Square wall mounted brass handshower set including 1-jet square handshower, wall mounted bracket & supply elbow + flange, 78" flexible hose
 1/2" inlet connections

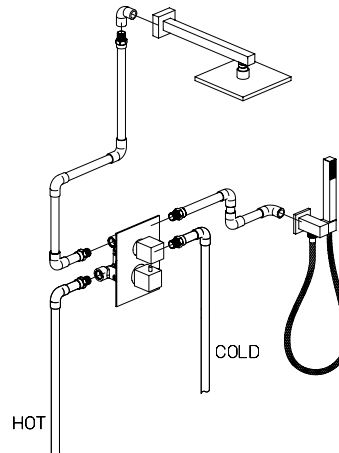

\$885,00	\$1.043,00	\$1.171,00
----------	------------	------------

SQ..74512

12" wallmount shower arm with strengthened fixing.

\$143,00 \$165,00 \$192,50

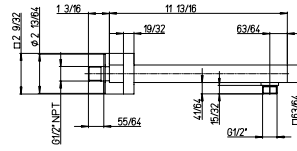

SQ..74516

16" wallmount shower arm with strengthened fixing.

\$159,50 \$209,00 \$247,50

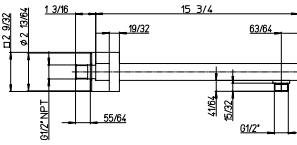

SQ..74406

6" Ceiling mount shower arm with strengthened fixing.

\$102,00 \$135,00 \$170,50

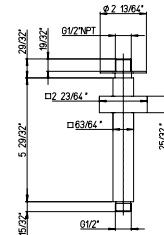

SQ..74408

8" Ceiling mount shower arm with strengthened fixing.

\$126,50 \$159,50 \$203,50

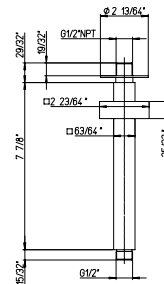

QU..75908

8" square brass shower head. Anti-limestone.

\$209,00 \$275,00 \$335,50

Flow Rate: 1.8 GPM @ 60 PSI MAX

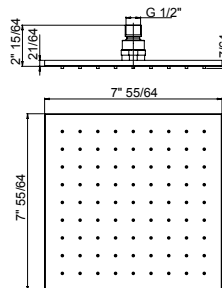

QU..75910

10" square brass shower head.
Anti-limestone.

Flow Rate: 1.8 GPM @ 60 PSI MAX

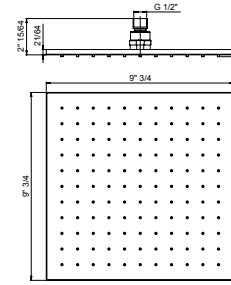

\$302,50	\$346,50	\$429,00
----------	----------	----------

QU..75912

12" square brass shower head.
Anti-limestone.

Flow Rate: 1.8 GPM @ 60 PSI MAX

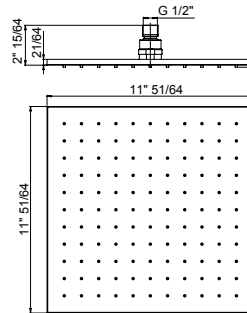

\$429,00	\$588,50	\$715,00
----------	----------	----------

SQ..75908

Extraslim 8" showerhead only.
Square design.
1/2" Connections.

Flow Rate: 1.8 GPM @ 60 PSI MAX

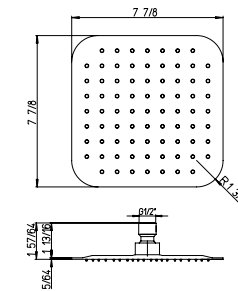
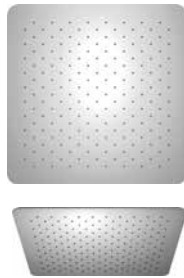

\$110,00	\$137,50	NA
----------	----------	----

SQ..75910

Extraslim 10" showerhead only.
Square design.
1/2" Connections.

Flow Rate: 1.8 GPM @ 60 PSI MAX

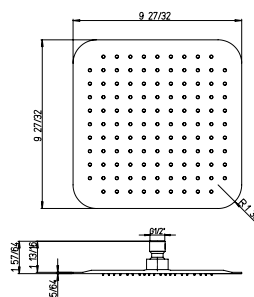
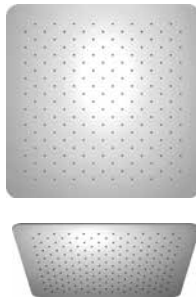

\$137,50	\$165,00	NA
----------	----------	----

SQ..75912

Extraslim 12" showerhead only.
Square design.
1/2" Connections.

Flow Rate: 1.8 GPM @ 60 PSI MAX

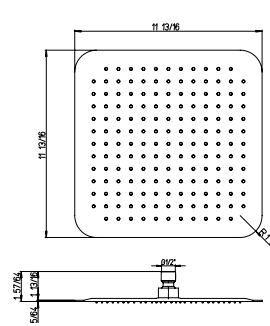
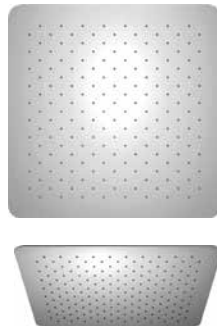

\$165,00	\$192,50	NA
----------	----------	----

QU..689

\$1.430,00 \$2.062,50 \$2.475,00

Shower column with thermostatic mixer, 38° safety button, integrated diverter, brass tube, wall mounted shower holder.
 10" inch square shower head.
 Single jet square hand shower.
 78" flexible hose.

Flow Rate: 1.8 GPM @ 60 PSI MAX

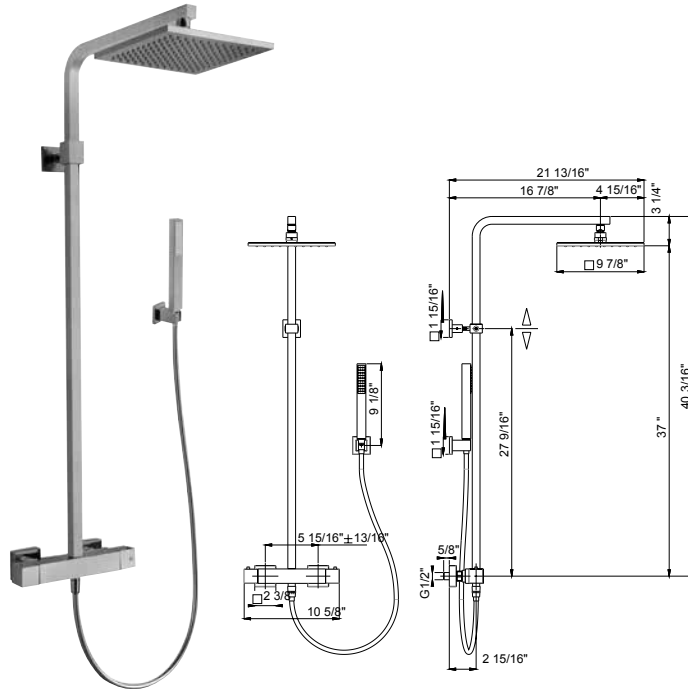

QU..129

\$396,00 \$489,50 \$544,50

24" brass slide bar kit.
 Single jet square hand shower
 Wall mount bracket & supply elbow.
 Single jet square hand shower.
 78" flexible hose.

Flow Rate: 1.8 GPM @ 60 PSI MAX

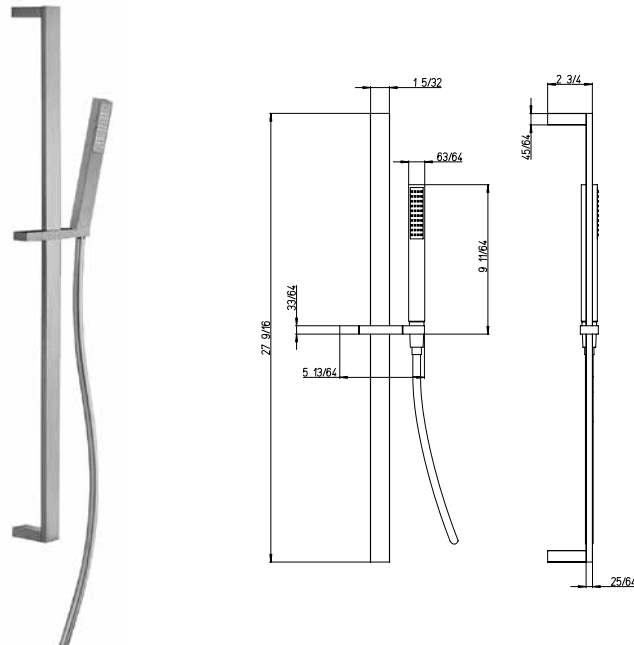

QU..440

\$198,00 \$253,00 \$297,00

Wallmounted brass handshower kit.
 1-jet hand shower.
 Wall mount bracket & supply elbow.
 78" flexible hose.

Flow Rate: 1.8 GPM @ 60 PSI MAX

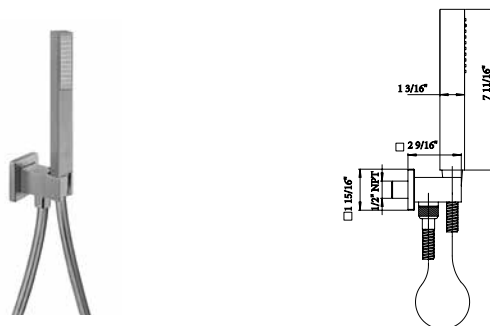

50..162

78" metal shower hose.

\$27,50	\$49,50	\$60,50
---------	---------	---------

SQ..503

Square brass drop elbow.

1/2" NPT Connection.

\$88,00	\$110,00	\$132,00
---------	----------	----------

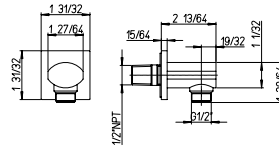
SQ..721

Square brass body tile spray.

Directional Body Spray.

30° Rotation.

1/2" Female NPT Connection.

Flow Rate: 1.5 GPM @ 60 PSI MAX

\$220,00	\$253,00	\$319,00
----------	----------	----------

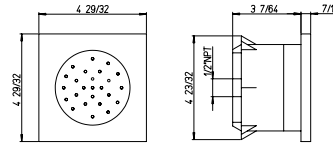
89..721

Square brass body spray.

Directional Body Spray.

30° Rotation.

1/2" Female NPT Connection.

Flow Rate: 1.5 GPM @ 60 PSI MAX

\$126,50	\$154,00	\$176,00
----------	----------	----------

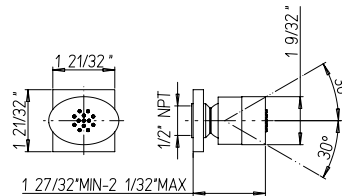
QU..430

Brass tub spout wall mount.

\$209,00	\$247,50	\$275,00
----------	----------	----------

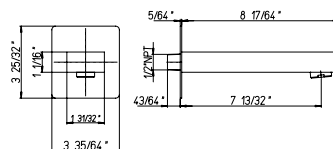

SQ..945

Push down pop up drain
with square top.

\$82,50	\$110,00	\$137,50
---------	----------	----------

