

series
Lady



CR



CHROME

PW



BRUSHED
NICKEL

OK



MATT GOLD
PVD



Conformità
EN 12944:2017

89..211

Single handle lavatory faucet with lever handle.
 7.77" overall height.
 5.5/7" spout reach.
 2 3/4" maximum deck thickness.
 Pop up drain included.

Flow Rate: 1.2 GPM @ 60 PSI

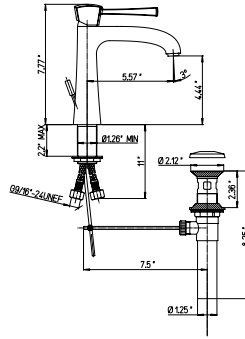

\$299,00 \$382,00 \$398,00



replacement cartridge
 53CC956G251FOR0EVS

89..211LL

Single handle tall lavatory faucet with lever handle.
 10.8" overall height.
 6" spout reach.
 2 3/4" maximum deck thickness.
 Push drain included.

Flow Rate: 1.2 GPM @ 60 PSI

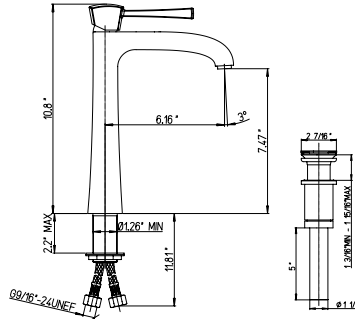

\$429,00 \$517,00 \$539,00



replacement cartridge
 53CC956G251FOR0EVS

89..214

8" centers widespread lavatory faucet with lever handles.
 6.7/16" spout height.
 5.37/64" spout reach.
 2 3/4" maximum deck thickness.
 Push drain included.

Flow Rate: 1.2 GPM @ 60 PSI

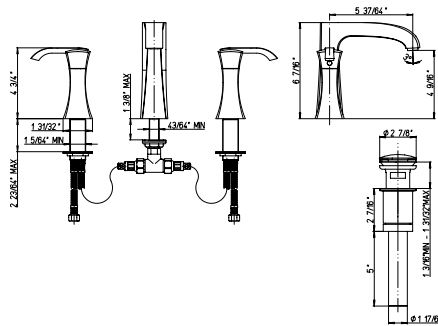

\$454,00 \$531,00 \$564,00



replacement valve
 53CC581XAD right
 53CC581XAS left

89..102

Roman tub with lever handles.
 8.3/16" spout height.
 5.29/32" spout reach.
 2 3/4" maximum deck thickness.

Flow Rate: 9.6 GPM @ 60 PSI

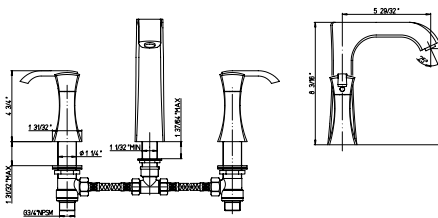

\$605,00 \$715,00 \$770,00



replacement valve
 53CC5813/4D right
 53CC5813/4S left

89..109

Roman tub with lever handles and a diverter with hand held shower.
 8.3/16" spout height.
 5.29/32" spout reach.
 2 3/4" maximum deck thickness.

Flow Rate: 7.6 GPM @ 60 PSI
 Flow Rate and spray: 1.8 GPM @ 60 PSI

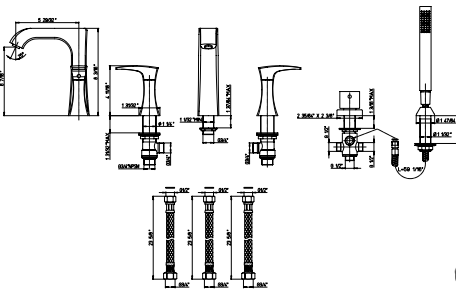

\$935,00 \$1,045,00 \$1,155,00



replacement valve
 53CC5813/4D right
 53CC5813/4S left

VALVE 697

Pressure Balance
 Rough-in Valve
 1/2" inch inlet connections
 Flows 5.0 GPM @ 60 PSI

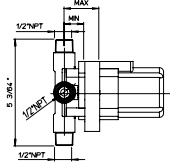
\$110,00
VALVE 788

Pressure Balance
 Rough-in Valve
 1/2" inch inlet connections
 Flows 5.0 GPM @ 60 PSI

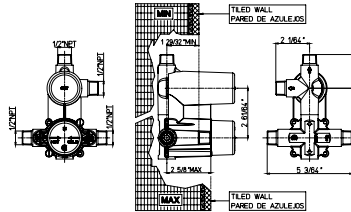
\$154,00
VALVE 690

Thermostatic Valve
 with 3/4" volume control
 1/2" inch inlet connections
 Flows 7.1 GPM @ 60 PSI

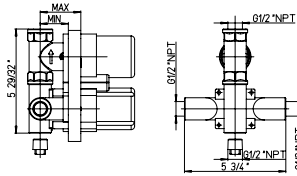
\$190,00
VALVE 691

Thermostatic Valve
 2 ways diverter cartridge
 1/2" inch inlet connections
 Flows 5.5 GPM @ 60 PSI

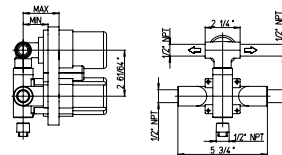
\$200,00
VALVE 711

Thermostatic Valve
 3/4" inch inlet connections
 Flows 9.6 GPM @ 60 PSI

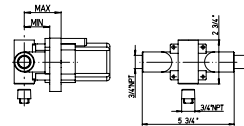
\$154,00
VALVE 400

1/2" Volume Control
 3/4" inch inlet connections
 Flows 12.5 GPM @ 60 PSI

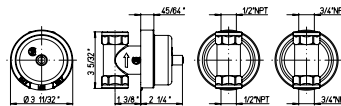
\$82,50
VALVE 402

3/4" Volume Control
 3/4" inch inlet connections
 Flows 15.0 GPM @ 60 PSI

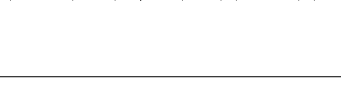
\$82,50
VALVE 425

3 ways Diverter Rough-in Valve
 1/2" inch inlet connections
 Flows 9.7 GPM @ 60 PSI

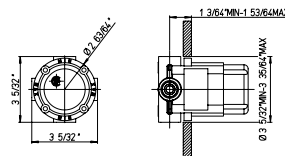
\$137,50

89..697

Pressure balance valve shower set.

NEEDS ROUGH VALVE 697

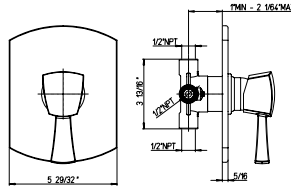

replacement cartridge
53CC956D697VA

\$220,00 \$258,50 \$286,00

89..788

Pressure balance valve tub and shower set.

NEEDS ROUGH VALVE 788

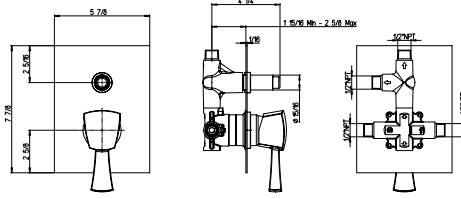

replacement cartridge
53CC956D697VA

\$247,50 \$286,00 \$313,50

89..690

Thermostatic valve with 3/4" ceramic disc volume control.

NEEDS ROUGH VALVE 690

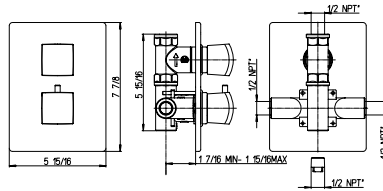

replacement ceramic disc valve
53CC5813/4S25



replacement cartridge
2TCC959

\$275,00 \$385,00 \$396,00

89..691

Thermostatic valve with 2 way diverter volume control.

NEEDS ROUGH VALVE 691

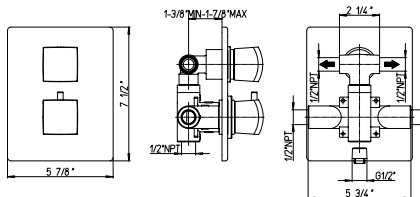

replacement ceramic disc valve
53CC956DEV35



replacement cartridge
2TCC959

\$330,00 \$412,50 \$423,50

89..711

3/4" thermostatic valve only.

NEEDS ROUGH VALVE 711

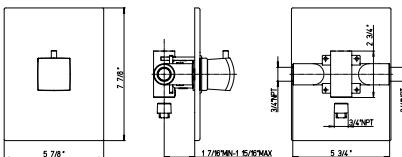

replacement cartridge
2TCC959

\$239,00 \$321,00 \$330,00

89..400

\$88,00 \$143,00 \$165,00

Volume control trim kit.

NEEDS ROUGH VALVE 400 OR 402

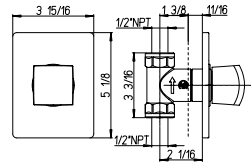

replacement ceramic disc valve
53CC5813/4S25

89..425

\$137,50 \$225,50 \$236,50

3 way diverter. 3/4" ceramic disc valve. 1/2" inlet connections.

NEEDS ROUGH VALVE 425

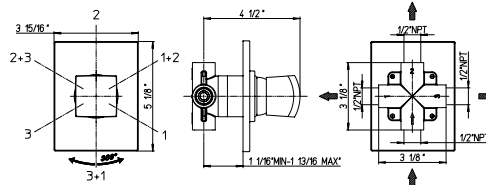

replacement diverter cartridge
FR53CC956DRG40

KIT 1

\$735,00 \$880,00 \$995,00

Pressure balance tub & shower KIT including:
 - 8" Brass Square rain shower head - Anti Limestone
 - 12" Brass Square wall mounted arm & flange
 - Trim 788 with diverter & ceramic disc valve cartridge
 - Rough in valve 788
 - 5 3/4" Brass tub spout
 1/2" NPT inlet connections

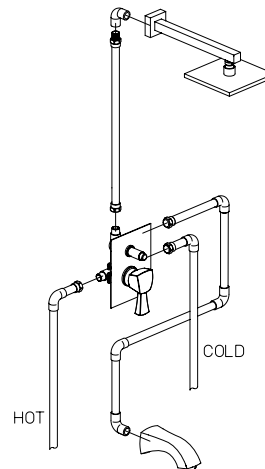

KIT 2

\$838,00 \$1.018,00 \$1.120,00

Thermostatic tub & shower KIT including:
 - 8" Brass Square rain shower head - Anti Limestone
 - 12" Brass Square wall mounted arm & flange
 - Trim 691 with thermostatic valve & 2 way diverter volume control
 - Rough in valve 691
 - 5 3/4" Brass tub spout
 1/2" NPT inlet connections

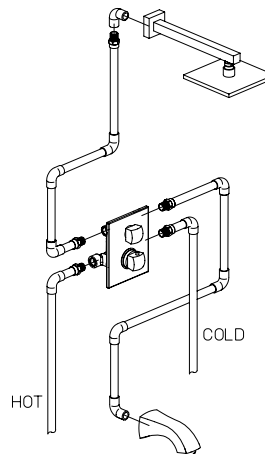

KIT 3

- Pressure balance shower KIT including:
- 8" Brass Square rain shower head - Anti Limestone
 - 12" Brass Square wall mounted arm & flange
 - Trim 697 ceramic disc valve cartridge
 - Rough in valve 697
 - 1/2" inlet connections

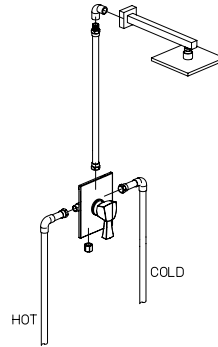

\$546,00	\$647,00	\$740,00
----------	----------	----------

KIT 4

- Thermostatic shower KIT including:
- 8" Brass Square rain shower head - Anti Limestone
 - 12" Brass Square wall mounted arm & flange
 - Trim 690 with thermostatic valve & 3/4" ceramic disc volume control
 - Rough in valve 690
 - 1/2" inlet connections

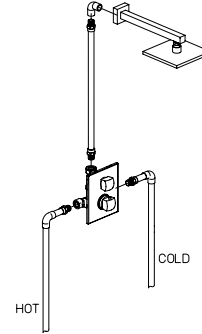

\$654,00	\$812,00	\$892,00
----------	----------	----------

KIT 5

- Pressure balance hand shower KIT including:
- 8" Brass Square rain shower head - Anti Limestone
 - 12" Brass Square wall mounted arm & flange
 - Trim 788 with diverter & ceramic disc valve cartridge
 - Rough in valve 788
 - Square wall mounted brass handshower set including 1-jet square handshower, wall mounted bracket & supply elbow + flange, 78" flexible hose
 - 1/2" inlet connections

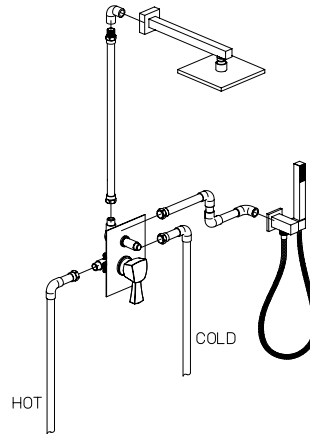

\$762,00	\$907,00	\$1.034,00
----------	----------	------------

KIT 6

- Thermostatic hand shower KIT including:
- 8" Brass Square rain shower head - Anti Limestone
 - 12" Brass Square wall mounted arm & flange
 - Trim 691 with thermostatic valve & 2 way diverter volume control
 - Rough in valve 691
 - Square wall mounted brass handshower set including 1-jet square handshower, wall mounted bracket & supply elbow + flange, 78" flexible hose
 - 1/2" inlet connections

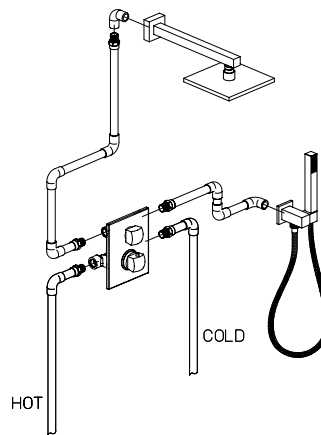

\$828,00	\$1.008,00	\$1.122,00
----------	------------	------------

SQ..74512

\$143,00	\$165,00	\$192,50
----------	----------	----------

12" wallmount shower arm with strengthened fixing.

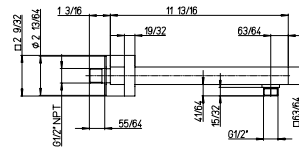
SQ..74516

\$159,50	\$209,00	\$247,50
----------	----------	----------

16" wallmount shower arm with strengthened fixing.

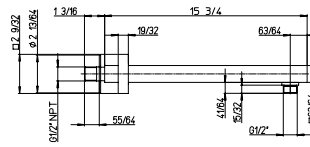
SQ..74406

\$102,00	\$135,00	\$170,50
----------	----------	----------

6" Ceiling mount shower arm with strengthened fixing.

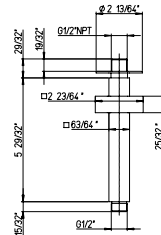
SQ..74408

\$126,50	\$159,50	\$203,50
----------	----------	----------

8" Ceiling mount shower arm with strengthened fixing.

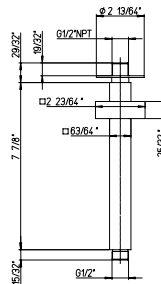
QU..75908

\$209,00	\$275,00	\$335,50
----------	----------	----------

8" square brass shower head. Anti-limestone.

Flow Rate: 1.8 GPM @ 60 PSI MAX

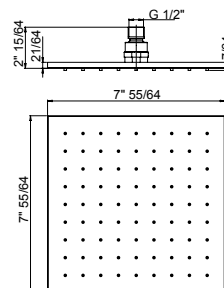

QU..75910

10" square brass shower head.
Anti-limestone.

Flow Rate: 1.8 GPM @ 60 PSI MAX

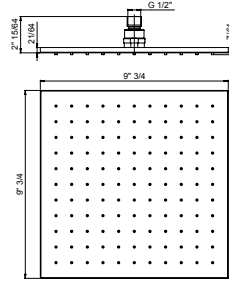

\$302,50	\$346,50	\$429,00
----------	----------	----------

QU..75912

12" square brass shower head.
Anti-limestone.

Flow Rate: 1.8 GPM @ 60 PSI MAX

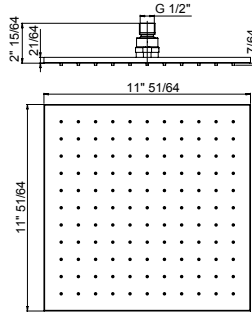

\$429,00	\$588,50	\$715,00
----------	----------	----------

SQ..75908

Extraslim 8" showerhead only.
Square design.
1/2" Connections.

Flow Rate: 1.8 GPM @ 60 PSI MAX

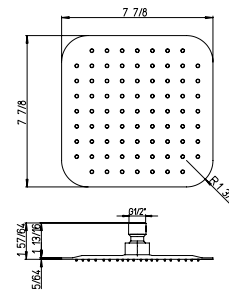
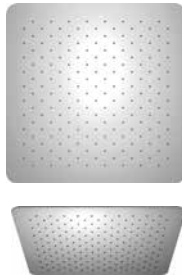

\$110,00	\$137,50	NA
----------	----------	----

SQ..75910

Extraslim 10" showerhead only.
Square design.
1/2" Connections.

Flow Rate: 1.8 GPM @ 60 PSI MAX

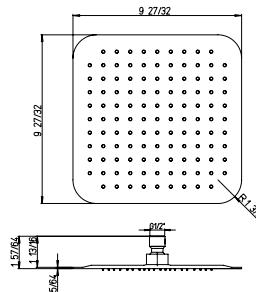
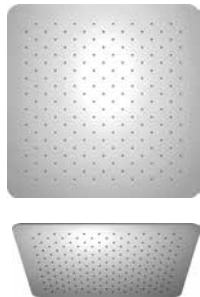

\$137,50	\$165,00	NA
----------	----------	----

SQ..75912

Extraslim 12" showerhead only.
Square design.
1/2" Connections.

Flow Rate: 1.8 GPM @ 60 PSI MAX

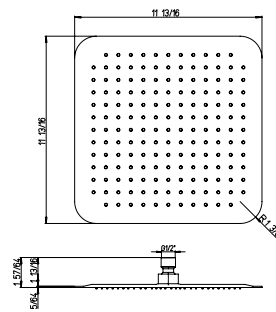
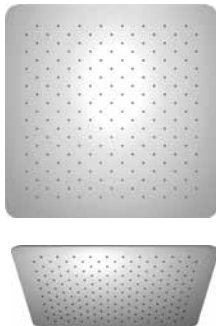

\$165,00	\$192,50	NA
----------	----------	----

QU..129

24" brass slide bar kit.
Includes: Handshower,
Wall mount bracket & supply elbow,
78" flexible hose.

Flow Rate: 1.8 GPM @ 60 PSI MAX

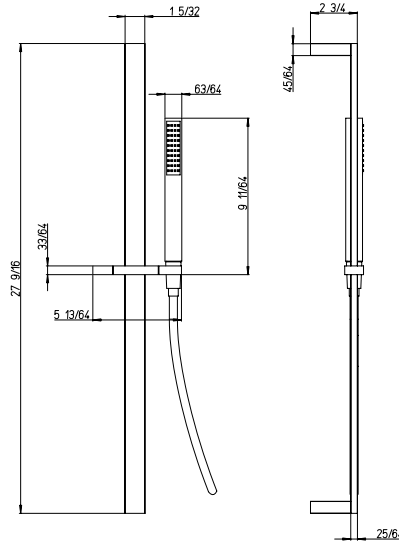

\$396,00	\$489,50	\$544,50
----------	----------	----------

QU..440

Wallmounted brass handshower kit.
1-jet hand shower.
Wall mount bracket & supply elbow.
78" flexible hose.

Flow Rate: 1.8 GPM @ 60 PSI MAX

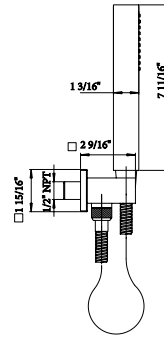

\$198,00	\$253,00	\$297,00
----------	----------	----------

50..162

78" metal shower hose.



\$27,50	\$49,50	\$60,50
---------	---------	---------

SQ..503

Square brass drop elbow.

1/2" NPT Connection.

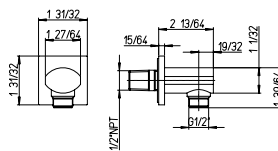

\$88,00	\$110,00	\$132,00
---------	----------	----------

SQ..721

\$220,00 \$253,00 \$319,00

Square brass body tile spray.
 Directional Body Spray
 30° Rotation
 1/2" Female NPT Connection

Flow Rate: 1.5 GPM @ 60 PSI MAX

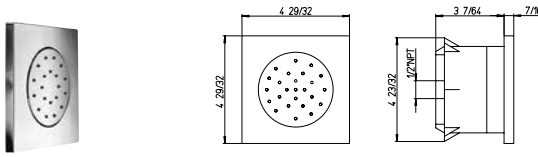

89..721

\$126,00 \$154,00 \$176,00

Square brass body spray.
 Directional Body Spray
 30° Rotation
 1/2" Female NPT Connection

Flow Rate: 1.5 GPM @ 60 PSI MAX

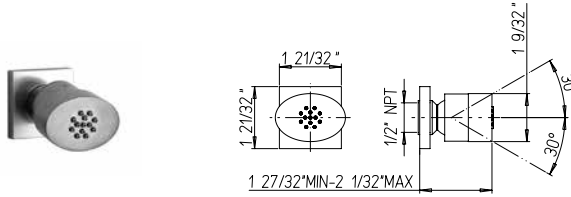

89..430

\$165,00 \$220,00 \$247,50

Brass tub spout wall mount.
 5 3/4" Brass tub spout

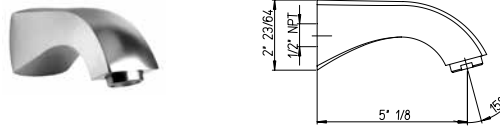

SQ..945

\$82,50 \$110,00 \$137,50

Push down pop up drain
 with square top.

