

series  
*Elba*



- |   |   |   |   |
|---|---|---|---|
| <b>CR</b>   | <b>PW</b>   | <b>OK</b>   | <b>BL</b>   |
|  |  |  |  |
| CHROME  | BRUSHED<br>NICKEL   | MATT GOLD<br>PVD  | MATT BLACK<br>PVD   |



## 78,211

Single handle lavatory faucet.  
6 7/16" overall height.  
4" spout reach.  
2 3/4" maximum deck thickness.  
Deck plate & pop-up drain  
included.

Flow Rate: 1.2 GPM @ 60 PSI

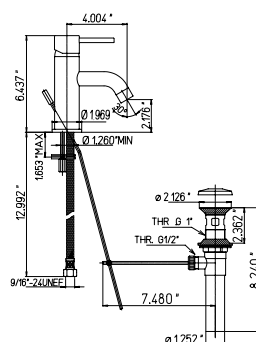

\$247,50    \$308,00    \$330,00



replacement cartridge  
53CC956GMD

## 78..211LL

Single handle lavatory faucet.  
12 3/4" overall height.  
6" spout reach.  
2 3/4" maximum deck thickness.  
Deck plate & pop-up drain  
included.

Flow Rate: 1.2 GPM @ 60 PSI

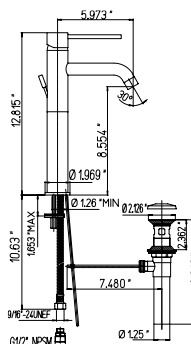

\$357,50    \$434,50    \$467,50



replacement cartridge  
53CC956GMD

## 78.214

Widespread lavatory faucet.  
8" centers.  
12 3/4" overall height.  
6 1/2" spout reach. Spout rotates.  
2 3/4" maximum deck thickness.  
Pop-up drain included.

Flow Rate: 1.2 GPM @ 60 PSI

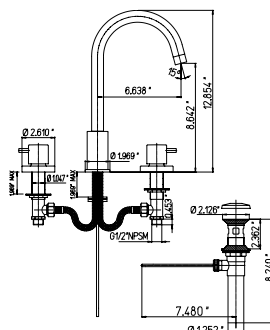

\$495,00    \$572,00    \$605,00



replacement valve  
53CC581XAD right  
53CC581XAS left

**78,250**

Single handle lavatory faucet.  
10 1/2" spout height.  
6 5/8" spout reach. Spout rotates.  
2 3/4" maximum deck thickness.  
Pop-up drain included.

Flow Rate: 1.2 GPM @ 60 PSI

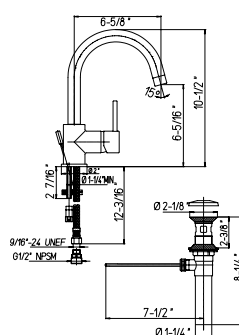

\$313,50    \$379,50    \$412,50



replacement cartridge  
53CC956GM

## 78.207

Wall mount lavatory faucet.  
8" centers.  
8 1/2" spout reach.

Flow Rate: 1.2 GPM @ 60 PSI

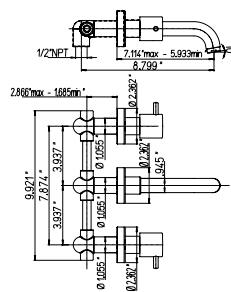

\$385,00    \$440,00    \$467,50



replacement valve  
53CC581XAD right  
53CC581XAS left

### 78..102

Roman tub with lever handles.  
9" spout height.  
6" spout reach.  
2 3/4" maximum deck thickness.

Flow Rate: 9.6 GPM @ 60 PSI

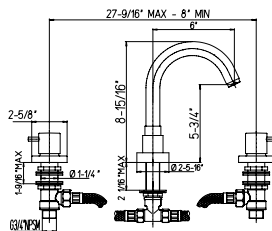

replacement valve  
53CC5813/4D right  
53CC5813/4S left

\$495,00 \$577,50 \$632,50

### 78..109

Roman tub with lever handles and diverter with hand held shower.  
9" spout height.  
6" spout reach.  
2 3/4" maximum deck thickness.

Flow Rate: 7.0 GPM @ 60 PSI  
Flow Rate and spray: 1.8 GPM @ 80 PSI

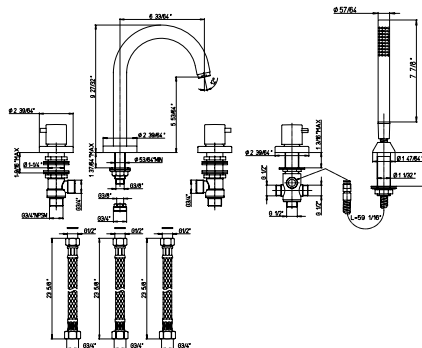

replacement valve  
53CC5813/4D right  
53CC5813/4S left

\$715,00 \$797,50 \$852,50

### 78..136

Floor mounted tub filler.  
Single Hole Free-Standing  
Tub Filler with Hand held shower.  
78" flexible hose.

Flow Rate: 7.0 GPM @ 60 PSI  
Flow Rate and spray: 1.8 GPM @ 80 PSI

NEEDS ROUGH VALVE 136

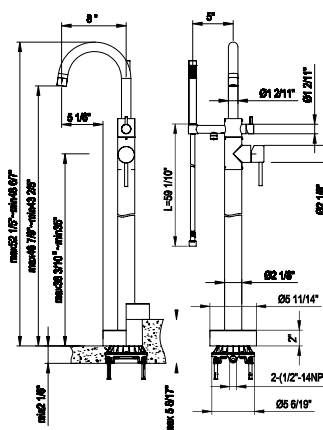

replacement valve  
diverter cartridge  
53CC956G25



volume control  
53CC956G11

\$1.072,50 \$1.292,50 \$1.402,50

### VALVE 136

Rough-in Valve  
3/4" inch inlet connections

Flows 9.0 GPM @ 60 PSI

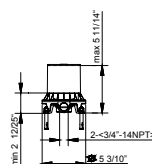

\$192,50

### VALVE 697

Pressure Balance  
Rough-in Valve  
1/2" inch inlet connections

Flows 5.0 GPM @ 60 PSI

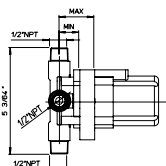

\$110,00

**VALVE 788**

Pressure Balance  
Rough-in Valve  
½" inch inlet connections

Flows 5.0 GPM @ 60 PSI

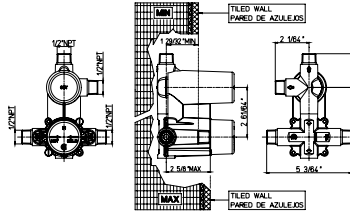

\$154,00

**VALVE 690**

Thermostatic Valve  
with ¾" volume control  
½" inch inlet connections

Flows 7.1 GPM @ 60 PSI

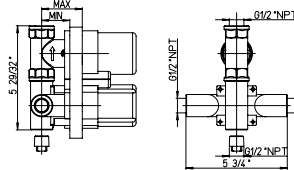

\$190,00

**VALVE 691**

Thermostatic Valve  
2 ways diverter cartridge  
½" inch inlet connections

Flows 5.5 GPM @ 60 PSI

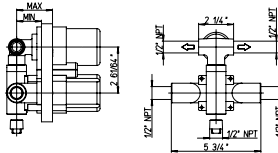

\$200,00

**VALVE 711**

Thermostatic Valve  
¾" inch inlet connections

Flows 9.6 GPM @ 60 PSI

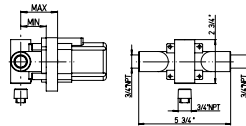

\$154,00

**VALVE 400**

½" Volume Control  
¾" inch inlet connections  
Flows 12.5 GPM @ 60 PSI

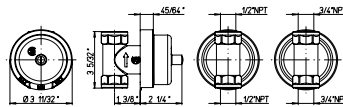

\$82,50

**VALVE 402**

¾" Volume Control  
¾" inch inlet connections  
Flows 15.0 GPM @ 60 PSI



\$82,50

**VALVE 425**

3 ways Diverter Rough-in Valve  
½" inch inlet connections

Flows 9.7 GPM @ 60 PSI

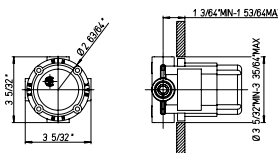

\$137,50

**78..697**

Pressure balance valve shower set.

NEEDS ROUGH VALVE 697

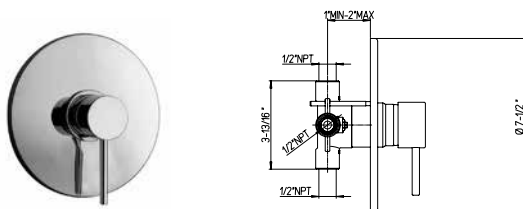

replacement cartridge  
53CC956D697VA

\$154,00	\$231,00	\$275,00
----------	----------	----------

**78..788**

Pressure balance valve tub and shower set.

NEEDS ROUGH VALVE 788

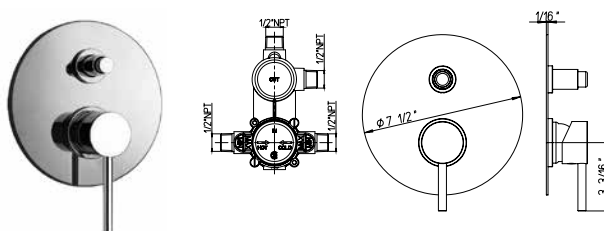

replacement cartridge  
53CC956D697VA

\$220,00	\$302,50	\$330,00
----------	----------	----------

**78..690**

Thermostatic valve with 3/4\" ceramic disc volume control.

NEEDS ROUGH VALVE 690

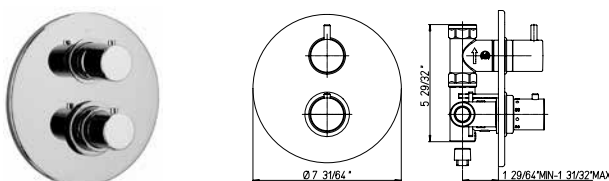

replacement ceramic disc valve  
53CC5813/4S25



replacement cartridge  
2TCC959

\$275,00	\$385,00	\$412,50
----------	----------	----------

**78..691**

Thermostatic valve with 2 way diverter volume control.

NEEDS ROUGH VALVE 691

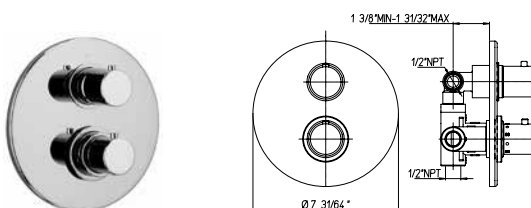

replacement ceramic disc valve  
53CC956DEV35



replacement cartridge  
2TCC959

\$330,00	\$429,00	\$467,50
----------	----------	----------

**78..711**

3/4\" thermostatic valve only.

NEEDS ROUGH VALVE 711

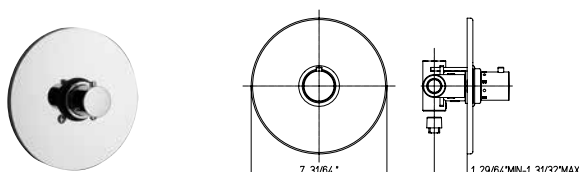

replacement cartridge  
2TCC959

\$220,00	\$302,50	\$330,00
----------	----------	----------

## 78..400

Volume control trim kit.

NEEDS ROUGH VALVE 400 OR 402

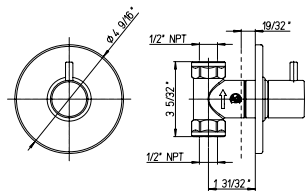

\$110,00	\$165,00	\$192,50
----------	----------	----------



replacement ceramic disc valve  
53CC5813/4S25

## 78..425

3 way diverter. 3/4" ceramic disc valve. 1/2" inlet connections.

NEEDS ROUGH VALVE 425

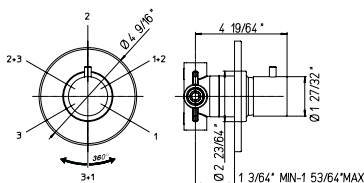

\$165,00	\$220,00	\$247,50
----------	----------	----------



replacement diverter cartridge  
53CC956DRG40

## KIT 1

Pressure balance tub & shower KIT including:

- 8" Brass round rain shower head - Anti Limestone
- 12" Brass round wall mounted arm & flange
- Trim 788 with diverter & ceramic disc valve cartridge
- Rough in valve 788
- 5 3/4" Brass tub spout
- 1/2" NPT inlet connections

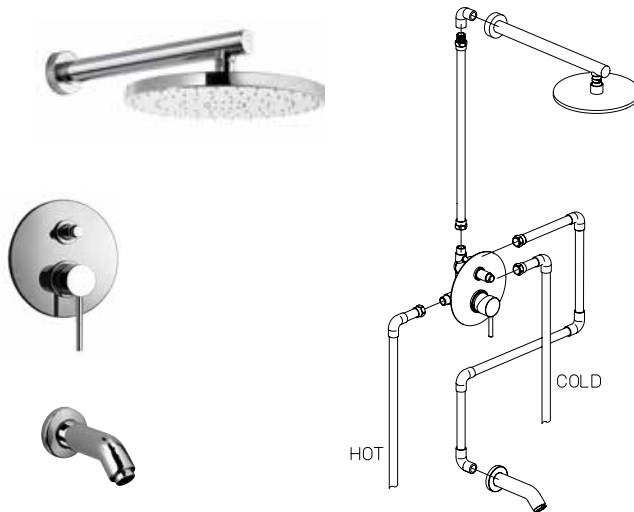

\$719,00	\$801,00	\$894,00
----------	----------	----------

## KIT 2

Thermostatic tub & shower KIT including:

- 8" Brass round rain shower head - Anti Limestone
- 12" Brass round wall mounted arm & flange
- Trim 691 with thermostatic valve & 2 way diverter volume control
- Rough in valve 691
- 5 3/4" Brass tub spout
- 1/2" NPT inlet connections

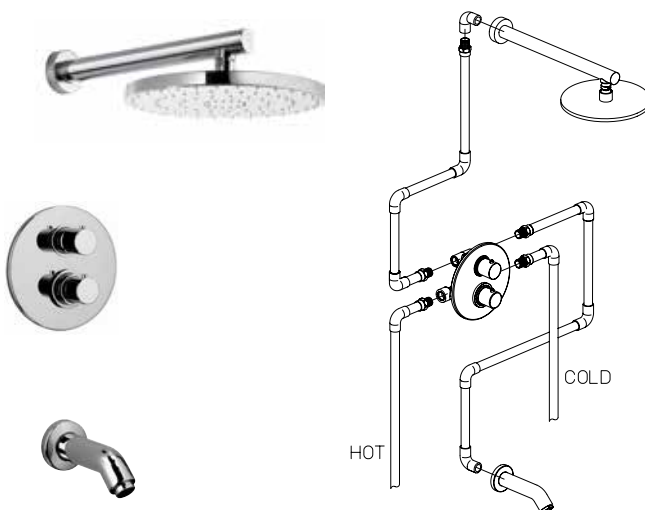

\$744,00	\$939,00	\$1.040,00
----------	----------	------------

**KIT 3**

Pressure balance shower KIT including:

- 8" Brass round rain shower head - Anti Limestone
- 12" Brass round wall mounted arm & flange
- Trim 697 ceramic disc valve cartridge
- Rough in valve 697
- 1/2" inlet connections



\$452,00	\$599,00	\$697,00
----------	----------	----------

**KIT 4**

Thermostatic shower KIT including:

- 8" Brass round rain shower head - Anti Limestone
- 12" Brass round wall mounted arm & flange
- Trim 690 with thermostatic valve & 3/4" ceramic disc volume control
- Rough in valve 690
- 1/2" inlet connections



\$612,00	\$786,00	\$870,00
----------	----------	----------

**KIT 5**

Pressure balance hand shower KIT including:

- 8" Brass round rain shower head - Anti Limestone
- 12" Brass round wall mounted arm & flange
- Trim 788 with diverter & ceramic disc valve cartridge
- Rough in valve 788
- Round wall mounted brass handshower set including 1-jet round handshower, wall mounted bracket & supply elbow + flange, 78" flexible hose
- 1/2" inlet connections



\$694,00	\$1.278,00	\$1.371,00
----------	------------	------------

**KIT 6**

Thermostatic hand shower KIT including:

- 8" Brass round rain shower head - Anti Limestone
- 12" Brass round wall mounted arm & flange
- Trim 691 with thermostatic valve & 2 way diverter volume control
- Rough in valve 691
- Round wall mounted brass handshower set including 1-jet round handshower, wall mounted bracket & supply elbow + flange, 78" flexible hose
- 1/2" inlet connections

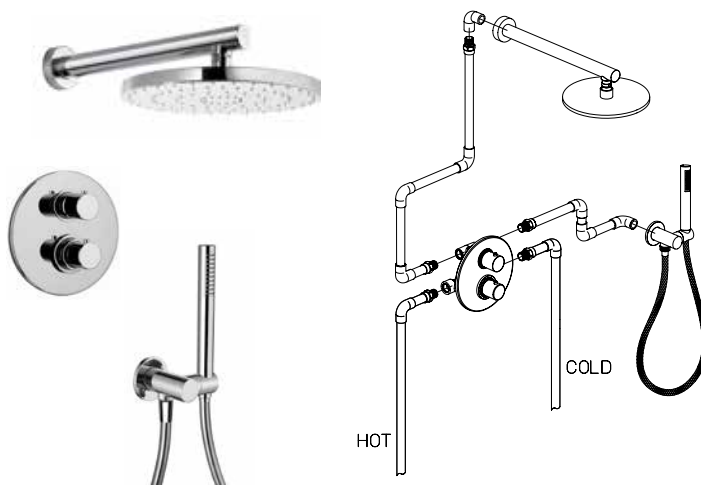

\$782,00	\$990,00	\$1.105,00
----------	----------	------------

\$126,50    \$176,00    \$198,00

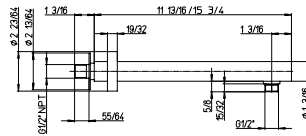

\$137,50	\$187,00	\$209,00
----------	----------	----------

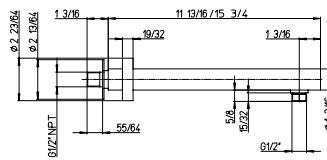

\$71,50      \$93,50      \$115,50

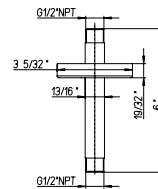

\$104,50    \$137,50    \$159,50

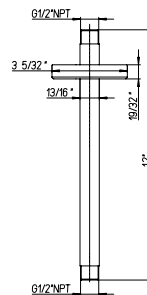

\$99,00	\$126,50	NA
---------	----------	----

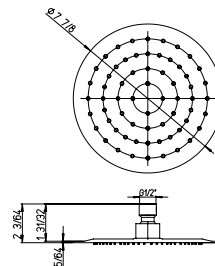



**RD..75910**

Extraslim 10" showerhead only.  
Round design.  
½" connections.

Flow Rate: 1.8 GPM @ 60 PSI MAX

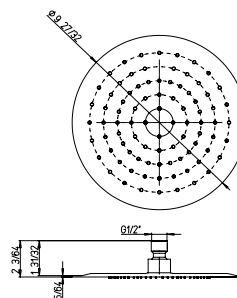
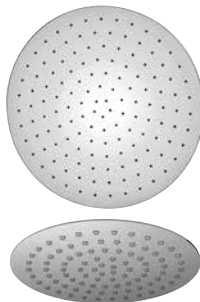

\$126,50	\$154,00	NA
----------	----------	----

**RD..75912**

Extraslim 12" showerhead only.  
Round design.  
½" connections.

Flow Rate: 1.8 GPM @ 60 PSI MAX

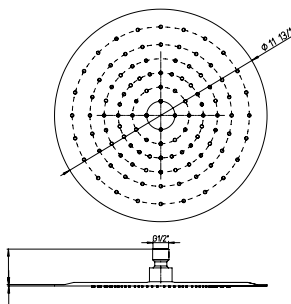
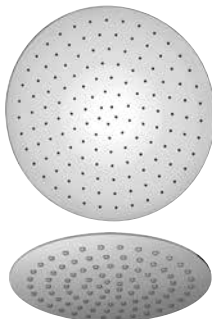

\$154,00	\$181,50	NA
----------	----------	----

**78..75908**

8" round brass shower head.  
Anti-limestone.  
½" connections.

Flow Rate: 1.8 GPM @ 60 PSI MAX

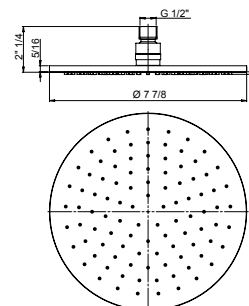

\$173,50	\$231,00	\$286,00
----------	----------	----------

**78..75910**

10" round brass shower head.  
Anti-limestone.  
½" connections.

Flow Rate: 1.8 GPM @ 60 PSI MAX

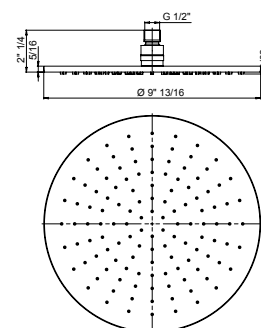

\$242,00	\$330,00	\$412,50
----------	----------	----------

**78..75912**

12 round brass shower head.  
Anti-limestone.  
½" connections.

Flow Rate: 1.8 GPM @ 60 PSI MAX

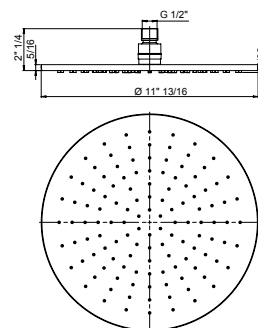

\$385,00	\$522,50	\$660,00
----------	----------	----------

### 78..689

Shower column with thermostatic mixer, ABS handles, 38° safety button, integrated diverter, brass tube, adjustable shower holder. 8" inch round shower head. 3 jets hand shower. 78" flexible hose.

Flow Rate: 1.8 GPM @ 60 PSI MAX

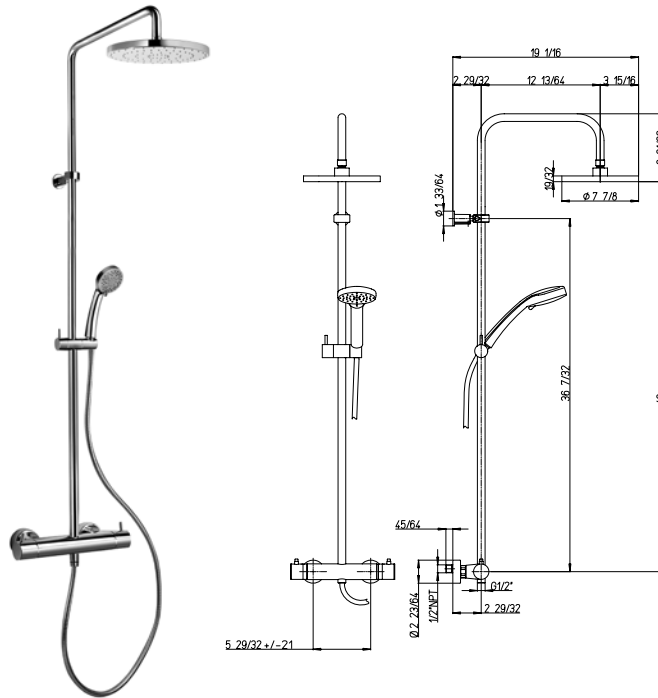

\$687,50	NA	NA
----------	----	----

### RD..129

24" brass slide bar kit. Includes: Handshower, Wall mount bracket & supply elbow. Single jet hand shower. 78" flexible hose.

Flow Rate: 1.8 GPM @ 60 PSI MAX

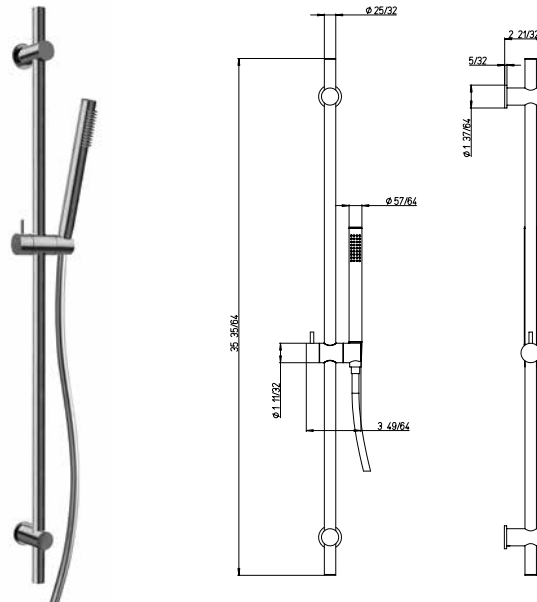

\$330,00	\$467,50	\$495,00
----------	----------	----------

### RD..440

Wallmounted brass handshower kit. 1-jet hand shower. Wall mount bracket & supply elbow. 78" flexible hose.

Flow Rate: 1.8 GPM @ 60 PSI MAX

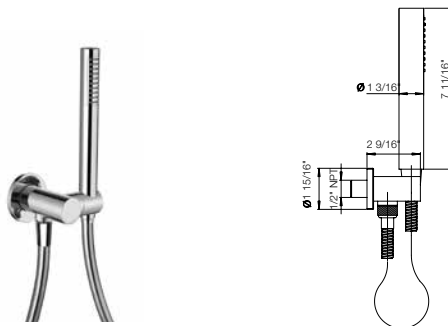

\$192,50	\$247,50	\$275,00
----------	----------	----------

**50..162**

\$27,50	\$49,50	\$60,50
---------	---------	---------

78" metal shower hose.

**RD..503**

\$38,50	\$60,50	\$71,50
---------	---------	---------

Round brass drop elbow.

1/2" NPT Connection

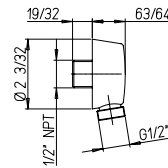
**RD..721**

\$220,00	\$253,00	\$275,00
----------	----------	----------

Round brass body tile spray.

Directional Body Spray.

30° Rotation.

1/2" Female NPT Connection.

Flow Rate: 1.5 GPM @ 60 PSI MAX

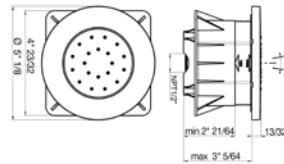
**86..721**

\$110,00	\$137,50	\$148,50
----------	----------	----------

Round brass body spray.

Directional Body Spray.

30° Rotation.

1/2" Female NPT Connection.

Flow Rate: 1.5 GPM @ 60 PSI MAX

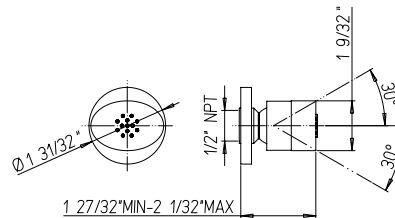
**78..430**

\$99,00	\$137,50	\$148,50
---------	----------	----------

Brass tub spout wall mount.

5 3/4" Brass tub spout.

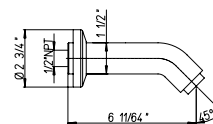

**RD..945**

Push down pop up drain.

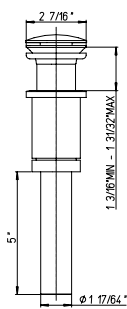

\$82,50	\$110,00	\$137,50
---------	----------	----------