

series  
*Alessandra*



**CR**  
  
CHROME

**PW**  
  
BRUSHED  
NICKEL



completa  
ORA. [www.completa.it](http://www.completa.it)





**VALVE 711**

\$154,00

Thermostatic Valve  
3/4" inch inlet connections

Flows 9.6 GPM @ 60 PSI

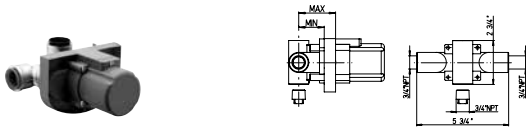

**VALVE 400**

\$82,50

1/2" Volume Control  
3/4" inch inlet connections  
Flows 12.5 GPM @ 60 PSI

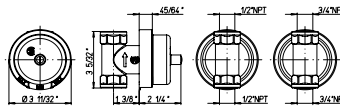

**VALVE 402**

\$82,50

3/4" Volume Control  
3/4" inch inlet connections  
Flows 15.0 GPM @ 60 PSI

**VALVE 425**

\$137,50

3 ways Diverter Rough-in Valve  
1/2" inch inlet connections

Flows 9.7 GPM @ 60 PSI

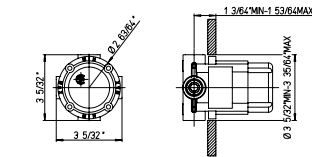

**19..690**

\$330,00 \$412,50 NA

Thermostatic valve with 3/4" ceramic disc volume control.

NEEDS ROUGH VALVE 690

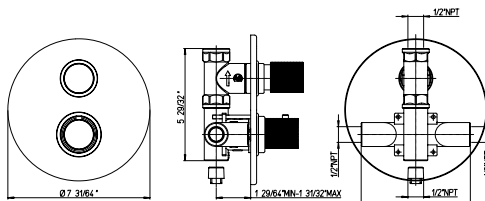

**19..691**

\$385,00 \$467,50 NA

Thermostatic valve with 2 way diverter volume control.

NEEDS ROUGH VALVE 691

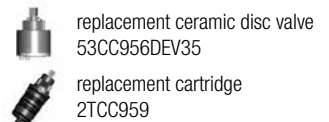
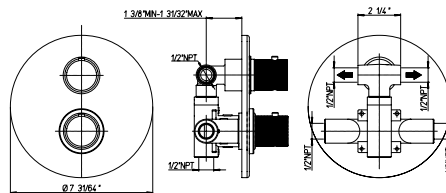

**19.711**

\$247,50 \$330,00 NA

3/4" thermostatic valve only.

NEEDS ROUGH VALVE 711

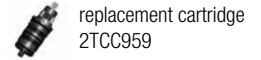
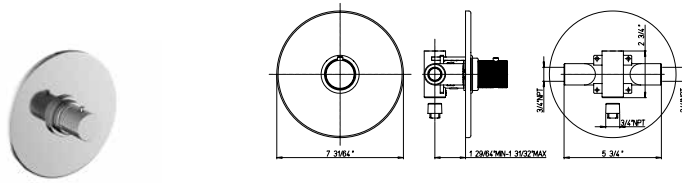

**19.400**

\$165,00 \$203,50 NA

Volume control trim kit.

NEEDS ROUGH VALVE 400 OR 402

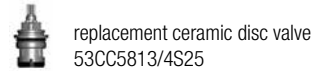
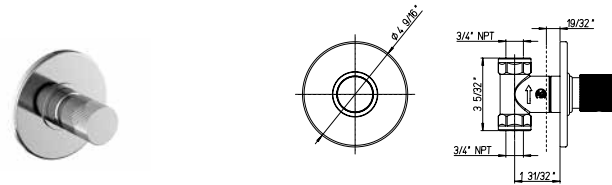

**19.425**

\$192,50 \$247,50 NA

3 way diverter. 3/4" ceramic disc valve. 1/2" inlet connections.

NEEDS ROUGH VALVE 425

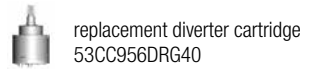
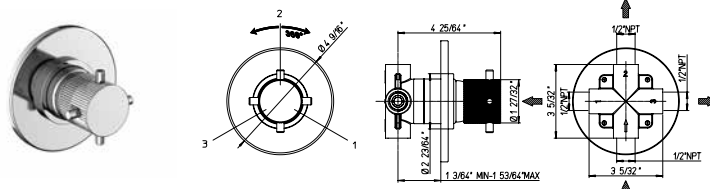

**KIT 2**

\$788,00 \$970,00 NA

- Thermostatic tub & shower KIT including:
- 8" Brass round rain shower head - Anti Limestone
  - 12" Brass round wall mounted arm & flange
  - Trim 691 with thermostatic valve & 2 way diverter volume control
  - Rough in valve 691
  - 5 3/4" Brass tub spout
  - 1/2" NPT inlet connections

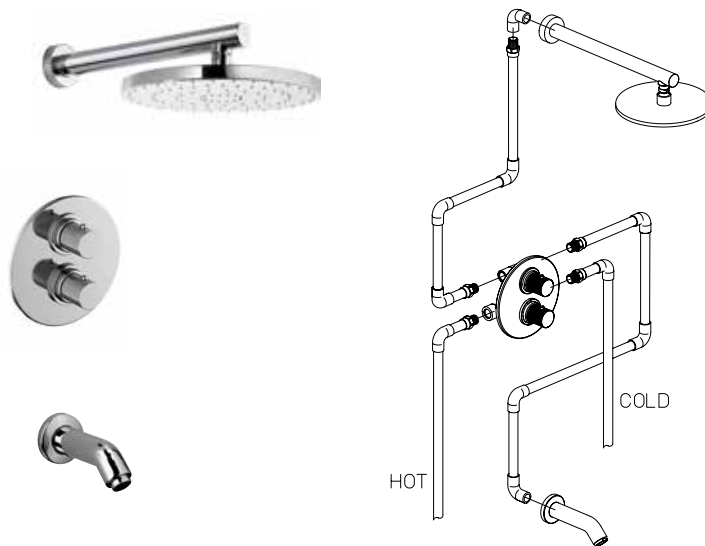

**KIT 4**

- Thermostatic shower KIT including:
- 8" Brass round rain shower head - Anti Limestone
  - 12" Brass round wall mounted arm & flange
  - Trim 690 with thermostatic valve & 3/4" ceramic disc volume control
  - Rough in valve 690
  - 1/2" inlet connections



\$656,00 \$808,00 NA

**KIT 6**

- Thermostatic hand shower KIT including:
- 8" Brass round rain shower head - Anti Limestone
  - 12" Brass round wall mounted arm & flange
  - Trim 691 with thermostatic valve & 2 way diverter volume control
  - Rough in valve 691
  - Round wall mounted brass handshower set including 1-jet round handshower, wall mounted bracket & supply elbow + flange, 78" flexible hose
  - 1/2" inlet connections

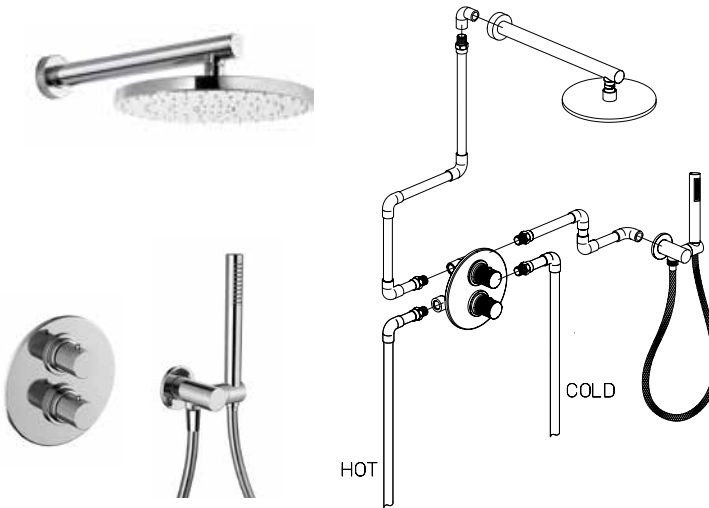

\$826,00 \$1.021,00 NA

**RD..74512**

12" wallmount shower arm with strengthened fixing.

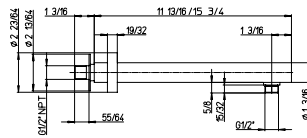

\$126,50 \$176,00 NA

**RD..74516**

16" wallmount shower arm with strengthened fixing.

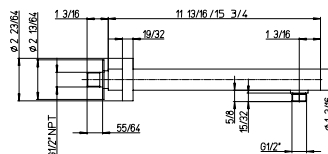

\$137,50 \$187,00 NA

**RD..74406**

\$71,50	\$93,50	NA
---------	---------	----

6" Ceiling mount shower arm with strengthened fixing.

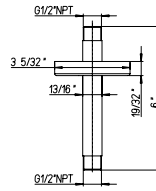
**RD..74412**

\$104,50	\$137,50	NA
----------	----------	----

12" Ceiling mount shower arm with strengthened fixing.

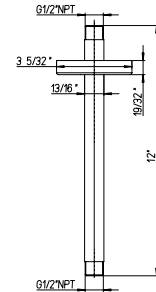
**RD..75908**

\$99,00	\$126,50	NA
---------	----------	----

Extraslim 8" showerhead only. Round design. 1/2" connections.

Flow Rate: 1.8 GPM @ 60 PSI MAX

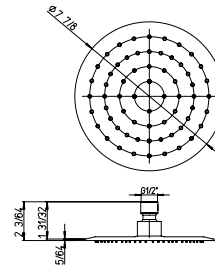
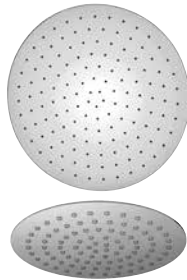
**RD..75910**

\$126,50	\$154,00	NA
----------	----------	----

Extraslim 10" showerhead only. Round design. 1/2" connections.

Flow Rate: 1.8 GPM @ 60 PSI MAX

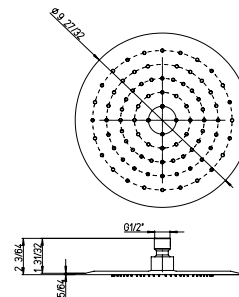
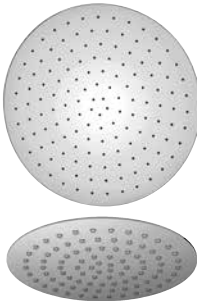
**RD..75912**

\$154,00	\$181,50	NA
----------	----------	----

Extraslim 12" showerhead only. Round design. 1/2" connections.

Flow Rate: 1.8 GPM @ 60 PSI MAX

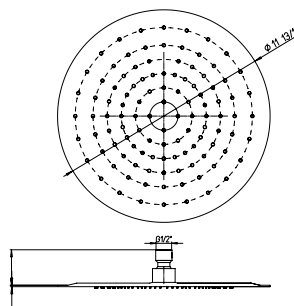
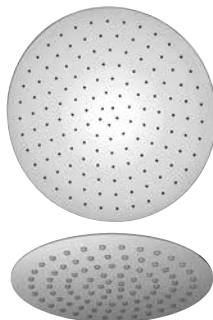

**78..75908**

8" round brass shower head.  
Anti-limestone.  
1/2" connections.

Flow Rate: 1.8 GPM @ 60 PSI MAX

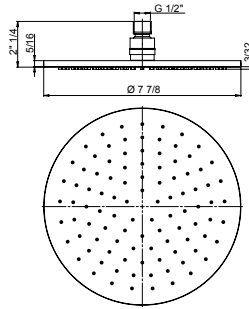

\$173,50 \$231,00 NA

**78..75910**

10" round brass shower head.  
Anti-limestone.  
1/2" connections.

Flow Rate: 1.8 GPM @ 60 PSI MAX

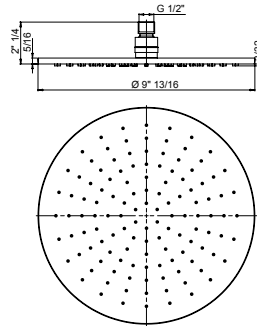

\$242,00 \$330,00 NA

**78..75912**

12" round brass shower head.  
Anti-limestone.  
1/2" connections.

Flow Rate: 1.8 GPM @ 60 PSI MAX

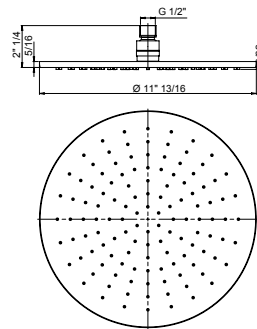

\$385,00 \$522,50 NA

**RD..129**

24" brass slide bar kit.  
Includes: Handshower,  
Wall mount bracket & supply elbow,  
78" flexible hose.

Flow Rate: 1.8 GPM @ 60 PSI MAX

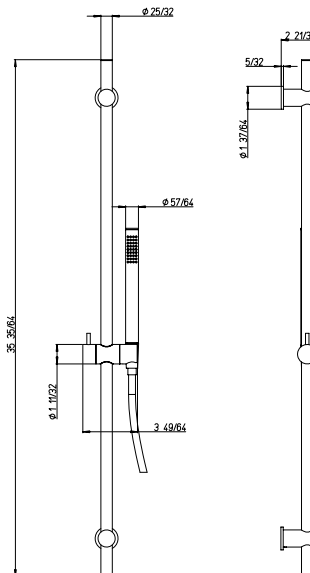

\$330,00 \$467,50 NA



**RD..440**

Wallmounted brass handshower kit.  
 1-jet hand shower.  
 Wall mount bracket & supply elbow.  
 78" flexible hose.

Flow Rate: 1.8 GPM @ 60 PSI MAX

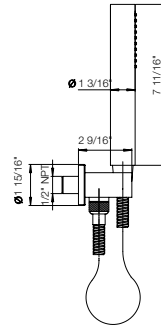

\$192,50	\$247,50	NA
----------	----------	----

**50..162**

78" metal shower hose.



\$27.50	\$49.50	\$60.50
---------	---------	---------

**RD..503**

Round brass drop elbow.

1/2" NPT Connection

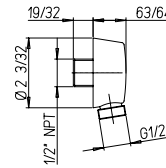

\$38,50	\$60,50	NA
---------	---------	----

**RD..721**

Round brass body tile spray.  
 Directional Body Spray.  
 30° Rotation.  
 1/2" Female NPT Connection.

Flow Rate: 1.5 GPM @ 60 PSI MAX

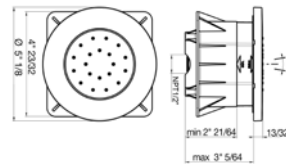

\$220,00	\$253,00	NA
----------	----------	----

**86..721**

Round brass body spray.  
 Directional Body Spray.  
 30° Rotation.  
 1/2" Female NPT Connection.

Flow Rate: 1.5 GPM @ 60 PSI MAX

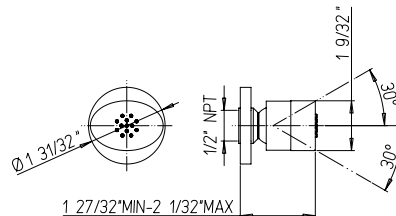

\$110,00	\$137,50	NA
----------	----------	----

**78..430**

\$99,00    \$137,50    NA

Brass tub spout wall mount.  
5 3/4" Brass tub spout

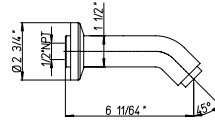

**RD..945**

\$82,50    \$110,00    NA

Push down pop up drain.

