

INSTALLATION INSTRUCTIONS

STAINLESS STEEL SINKS

Drop-In Sinks & Undercounter Mounting Sinks



Thank you for selecting American Standard - the benchmark of fine quality for over 100 years. To ensure this product is installed properly, please read these instructions carefully before you begin. (Certain installations may require professional help.) Also be sure your installation conforms to local codes

▲ CAUTION: PRODUCT IS FRAGILE. TO AVOID BREAKAGE AND POSSIBLE INJURY HANDLE WITH CARE!

NOTE: *Pictures may not exactly define contour of china and components.*

Recommended Tools & Materials

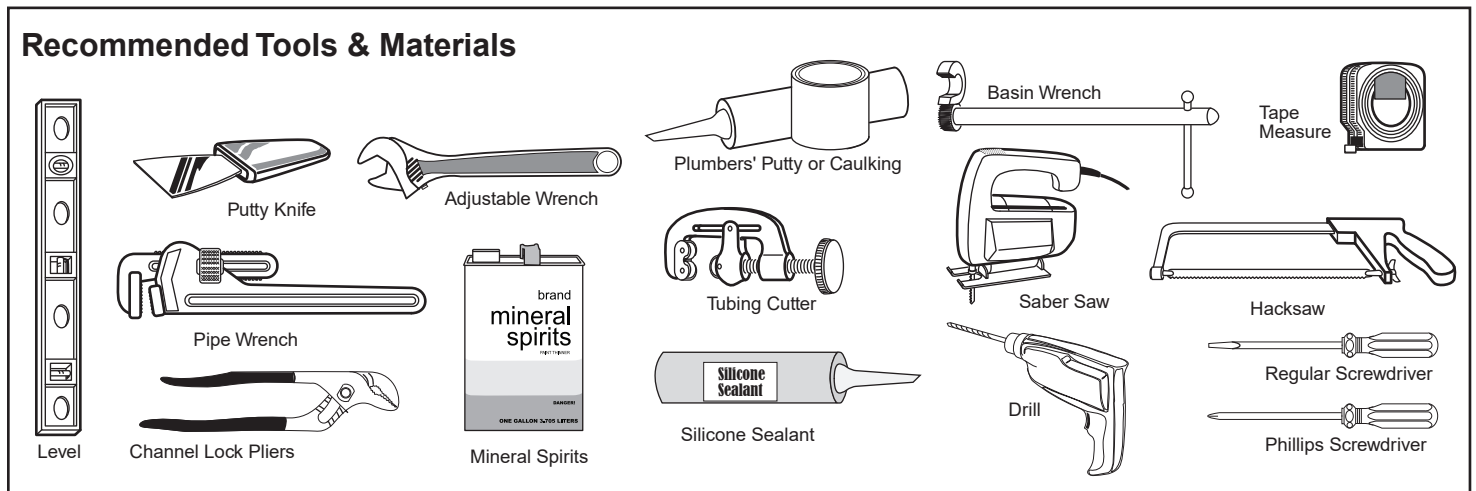

MAINTENANCE FOR STAINLESS STEEL SINKS:

To keep the original quality of your Stainless Steel Sink, we recommend regular cleaning. Use a mild liquid dish detergent and water to clean the product after use. Rinse carefully and dry.

PLEASE HAVE THE FOLLOWING IN MIND:

- Do not let water or other liquids dry on the product. Liquids that are left to dry leave a grey build-up stain on the steel.
- Stainless steel can stand hard treatment, but sharp objects can easily scratch the surface. These scratches are more visible when the product is new. After a period of use these marks will be smoothed out without the product losing its luster.
- Never use scouring powder or steel wool to clean the surface. Apart from the risk of scratches, there is also a risk that rust stains will attack the steel.
- Avoid Chlorine-based solutions from coming into contact with the stainless steel.
- Silver polish leaves spots that cannot be removed.
- Acidic foods (e.g. juices, salt, mustard, mayonnaise, etc.) must be cleaned up immediately.

DISCOLORATION

More stubborn spots are often caused by impurities in the water or household substances. These can be removed with special polish agents for stainless steel. Dull spots can become lustrous again if rubbed with chalk on a soft cloth.

FOR DROP-IN SINK INSTALLATION

1 PREPARING THE COUNTERTOP

Make sure there are no obstructions such as cabinets, plumbing, etc. below or above the countertop. Place template on countertop checking to make sure the sink will line up correctly with plumbing. To begin the cutout for the sink, drill a hole then use a sabersaw to carefully cut along the template.

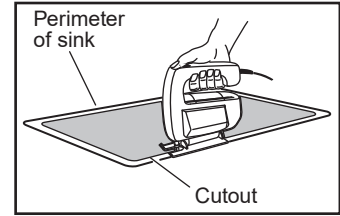
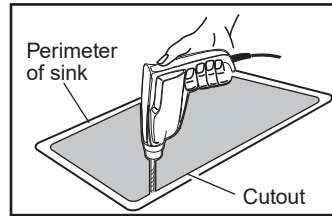

2 CHECK THE CUTOUT DIMENSIONS

Check the countertop cutout opening by placing the sink in the opening to be sure it is sized properly. The rim of the sink must be set uniformly on the countertop to ensure the corners of the sink seat properly. If the sink does not fit adjust the cutout opening using the saber saw.

3 Apply a generous portion of sealant inside line traced on countertop.

4 A. Carefully lower sink into cutout. Make sure the sink is in the proper location and press down firmly.

WARNING: Improper tightening of screws could result in improper installation or cause damage to the sink.

B. Loosen the screw and turn the clamp 90 degrees so the clamp can catch the bottom of countertop as shown. Hand tighten the screws.

C. Recheck sink position on countertop. Tighten all screws an additional 1/4 turn with a flat head screwdriver.

WARNING: DO NOT OVERTIGHTEN

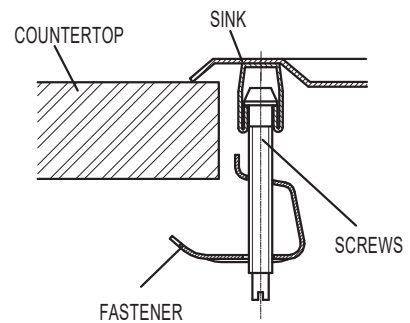

FOR UNDERCOUNTER MOUNTING SINK INSTALLATION

BEFORE YOU BEGIN...

Unpack new sink and inspect carefully for damage. Notify your DUKO Plumbing Fixtures distributor of any damage. Replace the sink in its original packing carton to protect it until you are ready to begin installation.

CAUTION

Strongly Recommend For Professional Installers to Perform Installation.

- Locate sink to be installed. Provide proper clearance under the countertop for the faucet supply lines and the structural parts of your cabinet. NOTE: Some templates share the drop-in and undercounter mounting. Make sure you used the undercounter mounting portion of the template.
- Cut the inner portion from the supplied template and discard.
- Attach the outer portion of the template to the countertop using masking tape. Be sure there is enough clearance for the faucet and supply line. If the template has a hole for the faucet, use 1-3/8" (35 mm) diameter hole saw to cut hole on the countertop.

- 1** Drill a clearance hole inside the cutout line.

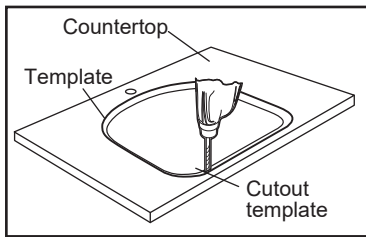

- 2** Cut opening on cut line of the template.
NOTE: Contact your countertop distributor for the best method of cutting materials such as marble, hard synthetics, etc.

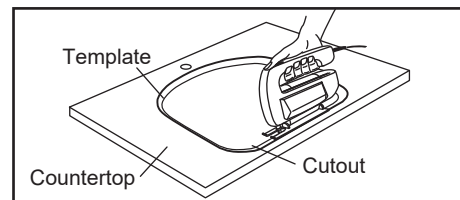

- 3** The mounting kit is supplied with each sink. It includes the brackets, inserts and fasteners. Consult your countertop supplier to use the proper inserts and fasteners depend on the type of countertop material. Locate and drill the mounting hole for insert (following with countertop supplier's suggestion) as shown below. The mounting hole should allow even spacing of mounting brackets around the sink.

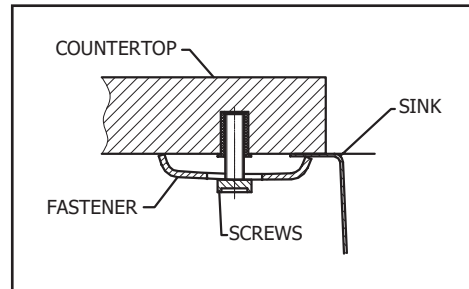

- 4** Apply sealant to the rim of the sink near the inside edge. Be careful not to miss or skip an area.

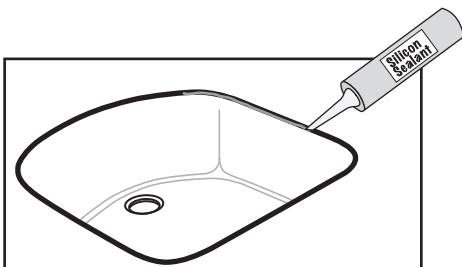

- 5** Lift the sink into place. Follow the instructions from your countertop supplier in order to tighten the mounting hardware evenly.

⚠ DO NOT OVERTIGHTEN

- 6** Apply sealant to the rim of the sink near the inside edge. Be careful not to miss or skip an area.

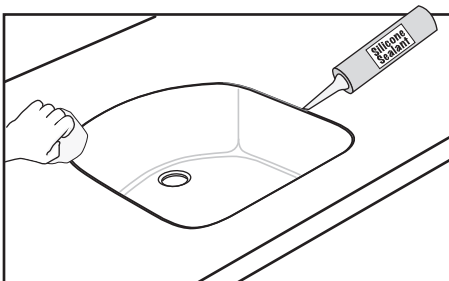

- 7** Mount the faucet and strainer assembly following the manufacturer's instructions.

NOTE: Your sink may not come with the strainer and faucet assembly in which case you will need to purchase separately and follow instructions included with the purchased products.