

OWNER'S MANUAL

Swash DS725 Advanced Bidet Toilet Seat

DS725-EW
DS725-RW

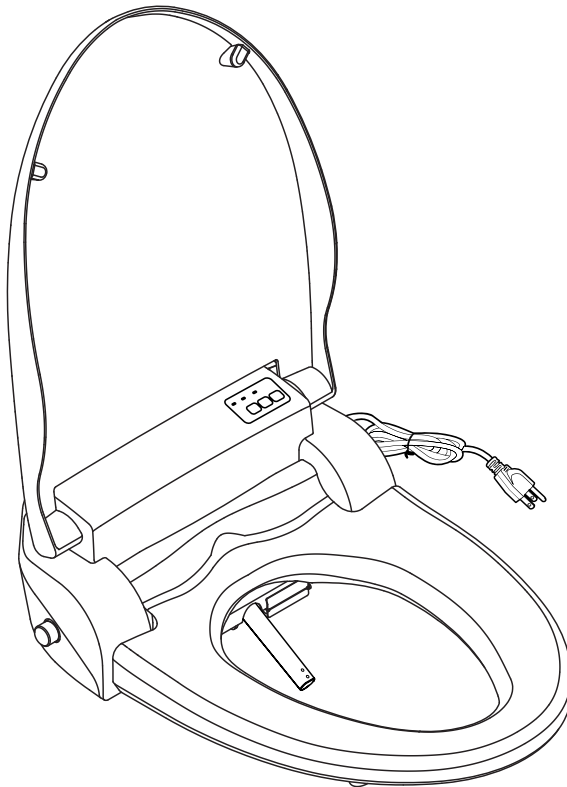

Attach Proof of Purchase to This Page

Adjunte prueba de compra a esta Página

Joindre une preuve d'achat à cette Page

CONTENTS

This manual contains important safety information. Before operating the bidet, please read this manual thoroughly, and retain it for future reference.

GENERAL INFO

- 02 SAFETY INFORMATION
- 06 PRODUCT INFORMATION
- 06 Product Features
- 07 Product Dimensions
- 08 Product Parts

PRODUCT INSTALLATION

- 09 PRODUCT INSTALLATION
- 09 Installation Parts
- 10 Before Installation
- 11 Swash Installation
- 14 Remote Control Installation
- 15 External Bidet Filter Installation

PRODUCT OPERATION

- 16 OPERATING THE SWASH
- 16 DS725 Remote Control
- 18 DS725 Auxiliary Controls
- 19 Using the Swash DS725
- 21 Special Mode Operations

TECHNICAL INFO

- 22 PRODUCT SPECIFICATIONS
- 23 MAINTENANCE
- 23 Seat Cleaning & Removal
- 23 Nozzle Cleaning
- 24 Cleaning the Mesh Filter
- 24 Product Storage & Use
- 25 TROUBLESHOOTING
- 28 WARRANTY

SAFETY INFORMATION (IMPORTANT SAFEGUARDS)

READ ALL INSTRUCTIONS BEFORE USING

BE CAREFUL TO KEEP THIS SAFETY INFORMATION. PLEASE READ THIS INFORMATION TO PREVENT PROPERTY LOSS AND ENSURE SAFETY.

 **DANGER:** If not observed, serious injury or even death may occur as a result.

 **WARNING:** If not observed, serious physical injury or property damage may occur as a result.

 **CAUTION:** If not observed, minor physical injury or property damage may occur as a result.



DANGER

Failure to observe the following warnings may result in electric shock, fire, personal injury, property damage or product damage.

- Do not use a damaged power plug or plug into a loose electric outlet.
- Do not move the product by pulling the power cord.
- Do not handle the product or power plug with wet hands.
- Do not forcefully bend the power cord or place heavy objects on it to prevent it from being damaged or deformed.
- Do not connect and pull out the power plug or cord repeatedly.
- Unplug the product before cleaning, repairing, inspecting, or replacing parts.
- Remove any dust or water from the power plug prior to plugging in.
- Do not plug the product into an electrical outlet or power strip that is being used by too many other products. Use an electrical outlet adequate for the wattage of the product rated for a minimum of 15 amps.
- If the power cord is damaged, do not attempt to repair, modify, or replace the cord yourself.
- If the product produces a strange noise, a burning smell, or emits smoke, unplug it immediately from the electrical outlet and contact Brondell. Failure to do so may result in electric shock or fire.
- Do not insert any wires or sharp objects into any product gaps. This may result in electric shock, fire, or product damage.
- Do not place an electronic or gas heater near the product or dispose of any burning materials such as a lit cigarette in the toilet. This may result in fire or product deformation. Do not place any containers filled with water or other liquids, food, metallic objects, or any flammable material on top of the product. If foreign material enters the product, this may result in electric shock or fire.
- Do not use the product in locations exposed to excessive moisture and do not splash water onto the product.

SAFETY INFORMATION

(IMPORTANT SAFEGUARDS)



DANGER

Failure to observe the following warnings may result in electric shock, fire, personal injury, property damage or product damage.

- While cleaning the bathroom, pull the power plug out of the electrical outlet and exercise caution to ensure that water or cleaning supplies do not splash onto the bidet. Failure to do so may result in electric shock or fire.
- If foreign material enters the product, pull the power plug out of the electrical outlet, turn off the main water valve, and call the Brondell Service Center.
- Do not disassemble, repair, or modify the product yourself.
- Do not use the product while wet from bathing or showering.
- Do not place or store the product where it can fall or be pulled into a tub or sink.
- Do not place in or drop the product into water or any other liquid.
- Do not reach for the product if it has fallen into water. Unplug the product immediately and call the Brondell Service Center.
- Do not use the product if it is not working properly. Please unplug the product immediately, close the main water supply valve, and call the Brondell Service Center



WARNING

Failure to observe the following warnings may result in electric shock, fire, personal injury, property damage or product damage.

- Do not plug in, operate, or store the unit in locations where flammable or combustible materials are used or kept.
- Do not use industrial water, or gray water for the supply, as this may cause skin damage or disease.
- Turn off the main water supply valve when cleaning.
- For children and seniors who may have difficulties with adjusting temperatures or those with sensitive skin or impaired heat sensitivity, set the temperature of the wash spray and seat to “low” or “off” to prevent burning.
- Close supervision is necessary when this product is used by children, seniors, or persons requiring general assistance.
- Do not press the buttons using excessive force.
- Do not stand on top of or place any heavy objects onto the seat cover.
- Use this product for its intended use only, as described in this manual. Do not use any attachments that are not recommended by Brondell.

SAFETY INFORMATION

(IMPORTANT SAFEGUARDS)



WARNING

Failure to observe the following warnings may result in electric shock, fire, personal injury, property damage or product damage.

- Never operate this product if it has a damaged cord or plug, if it is not working properly, if it has been dropped or damaged, or dropped into water. Contact the Brondell Service Center for examination and repair.
- Keep the cord away from heated surfaces and heating vents.
- Never block the air openings of the product or place it on a soft surface, such as a bed or couch, where the air openings may be blocked. Keep the air openings free of lint, hair, etc.
- Never drop or insert any object into any opening or hose.
- Do not use the product outdoors or operate where aerosol (spray) products are being used or a room where it could be exposed to oxygen.
- Connect this product to a properly grounded outlet only. Refer to the Grounding Instructions in the next pages of the manual.



CAUTION

Failure to observe the following warnings may result in electric shock, fire, personal injury, property damage or product damage.

- Do not connect the main water supply to the hot water pipe or supply (only connect to the cold water supply).
- After the installation, make sure to check all water supply connections for leaks. Rubber washers should be in place for the water connection hoses & T-Valve.
- Do not open/close the seat or seat cover with excessive force.
- Exercise caution that urine does not come into contact with the product - failure to do so may result in bad odors or malfunction.
- If the product will not be used for a long period of time, unplug the power cord, close the main water supply valve, and drain any water in the water tank.
- Do not pull out the bidet hose using excessive force.
- Do not use thinner, benzene, acidic chemicals, chloride, or hydrochloric acid detergent on or near the product. This may result in corrosion to the metal parts or discoloration or scratches to the bidet body.
- This appliance is not intended for use by persons (including children and seniors) with reduced physical, sensory, or mental capabilities, or lack of experience and knowledge, unless they have been given supervision or instruction concerning the use of the appliance by a person responsible for their safety.
- Children should be supervised to ensure that they do not play with the appliance.

SAFETY INFORMATION

(IMPORTANT SAFEGUARDS)



ATTENTION

For those with certain medical or mobility issues in the bathroom, we recommend our Swash 1400 or Swash 1000 bidet seats, as their mounting systems are engineered for the most secure transitions from wheelchairs or walkers.

GROUNDING AND GFI OUTLET INSTRUCTIONS

This product should only be used with a grounded GFCI (Ground Fault Circuit Interrupter) outlet and a grounded three-prong electrical cord as shown to the right. In the event of an electrical short circuit, using a grounded GFCI outlet reduces the risk of electric shock.

This product is equipped with a grounded cord and is for use on a nominal 120V circuit only (minimum 15 amps) and must be plugged into an outlet that is properly grounded with a GFCI breaker as shown. Replace or repair a damaged cord immediately.

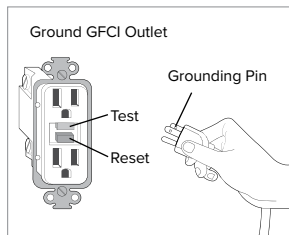

IMPROPER USE OF THE GROUNDING PLUG CAN RESULT IN A RISK OF ELECTRIC SHOCK.

- If repair or replacement of the cord or plug is necessary, do not connect the grounding wire to either flat blade terminal. The wire with green insulation (either with or without a yellow stripe) is the grounding wire.
- Check with a qualified electrician if the grounding instructions are not completely understood, or if there is doubt if the product is properly grounded.

Product Features

Stainless-Steel Nozzle System

Stainless steel resists soiling and bacterial contamination for enhanced hygiene.

Posterior and Feminine Warm Water Wash

Experience the ultimate in clean with adjustable temperature, position, pressure, massage, and oscillation settings.

Positionable Nozzle

The nozzle has five different positions to ensure the most comfortable and complete wash.

Wireless Remote Control

The intuitive remote control allows the user to easily select functions and settings.

Adjustable Water Temperature and Pressure

Each wash mode (Front and Rear) has four available water temperature settings, and five water pressure settings.

Massage

When activated, the water pressure automatically increases and decreases to provide a pulsating, cleaning spray.

Warm Air Dryer

Includes adjustable temperature with five levels for a hands-free experience and toilet paper reduction.

Nozzle Oscillation

The Move function provides a massaging, oscillating cleanse during the wash cycle ensuring a thorough and comfortable wash.

Auto Function

Activates a preset for a rear wash cycle followed by a drying cycle.

Ergonomic Heated Seat

With four temperature settings (High/Med/Low/Off).

Illuminating Nightlight

The cool blue hue of the nightlight means no more blinding lights during midnight trips to the bathroom.

Gentle-Closing Seat and Lid

“Slam free” gentle closing seat and lid are user friendly.

Eco Mode

When activated, this function automatically lowers the water temperature and seat temperature after the Swash was last used.

Deodorizer

The activated charcoal deodorizing filter eliminates odors at the source. It does not cover or mask odors, but eliminates them by removing air from the toilet bowl, passing it through the filter and expelling the clean air through the vent in the back of the Swash.

Product Dimensions

Elongated Top View

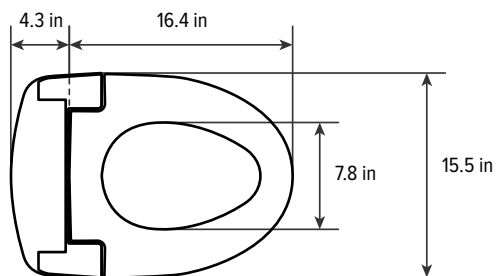

Round Top View

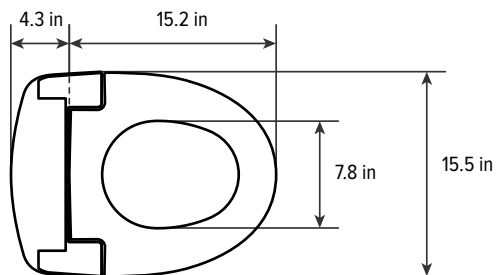

Required Distance Between Mounting Holes

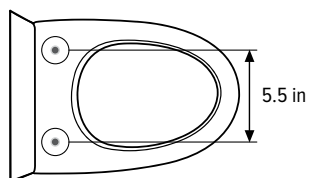

Product Parts

1. Lid
2. Seat Sensor
3. Warm Seat
4. Warm Air Dryer
5. Nozzle Assembly
6. LED Nightlight
7. Power Plug
8. Water Inlet with Mesh Filter
9. Auxiliary Control Panel

10. Drain Plug
11. Mounting Plate
12. IR Receiver (x2)

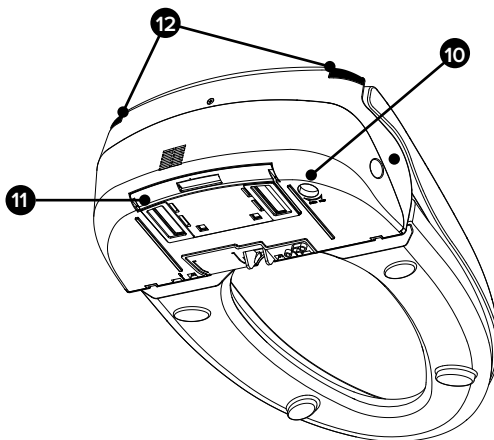
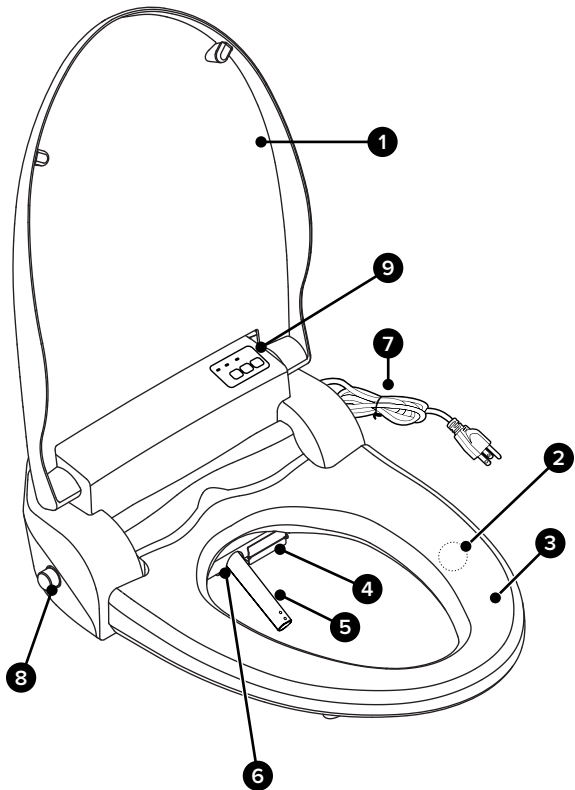

Installation Parts

1. Mounting Bolt (2)
2. Rubber Cone Washer (2)
3. Flat Washer (2)
4. Nuts (2)
5. Mounting Plate
6. Top Mount Brackets
7. T-Valve Connector with Rubber Washer
8. Bidet Hose
9. Remote Control
10. Remote Control Wall Mount
11. Batteries (2 x AAA)

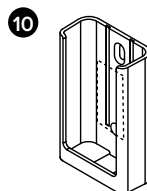
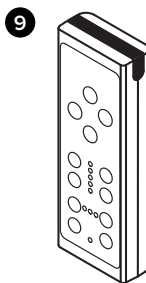
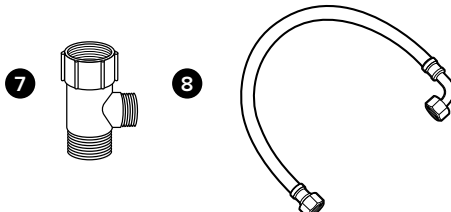
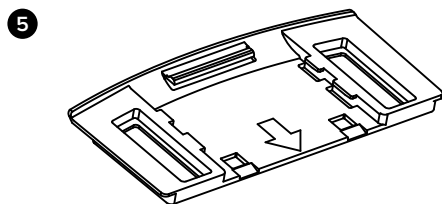
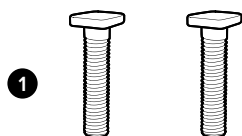

Before Installation



DO NOT PLUG THE PRODUCT IN WHILE THE UNIT IS UPSIDE DOWN

This may cause damage to the internal components.

WATCH OUR INSTALLATION VIDEO

Installation for all Swash products can be found online at brondell.com

CHECK BOLT SPREAD

This bidet seat can only be installed on toilets with a bolt hole spread of 14 cm / 5.5 in. (see Product Dimensions on page 7 for more information).

CHECK FOR TOP MOUNT INSTALLATION

If your fixture only has top-side access to the mounting bolts that hold the seat to the toilet, use the Top-Mount Brackets included in the hardware pack (see page 12).

CHECK FOR A CONCEALED TOILET FILL VALVE

Many modern toilets have sleek designs intended to cover and camouflage plumbing connections, which makes a standard Swash installation difficult or impossible. For this, we recommend using our Alternate Swash Bidet Seat T-Valve, found on brondell.com.

CHECK WATER SUPPLY LINE

Check the line that connects the toilet tank to the water shut off valve. If it is a rigid pipe, you may need to purchase a flexible hose to replace it before installing the Swash. The length of the hose and the size of the connectors will vary.

RESIDUAL MOISTURE IS NORMAL

Every product is tested with pure water during production to ensure the highest quality and performance. It is normal to find a small amount of residual moisture on the product and in the reservoir and filter.

TOOLS

A Phillips head or standard screwdriver may be needed to remove the existing toilet seat and a standard wrench may be needed for tight water supply connections. Teflon tape can be helpful in creating a water-tight seat between plumbing connections.

Swash Installation

Please read these instructions carefully before installing the Swash.
Failure to do so could result in flooding, leaking or damage to the product.

NOTE: Steps may vary by type of seat and toilet

1. Existing Toilet Seat Removal

- Lift hinge covers and use a screwdriver to remove the mounting bolts.
- Remove the toilet seat. Keep for future use.

2. Turn Off Water Supply Valve and Flush Toilet

- Turn water valve off to stop the flow of water.
- Flush toilet and hold down handle to completely empty tank.
- Disconnect water supply hose from toilet tank. Do not disconnect from the water supply valve.

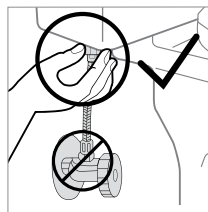

Step 2c

NOTES

- You may wish to place a container under the tank to catch excess water.
- Do not continue without completing the above steps
- Failure to do so could result in flooding, leaking or damage to the Swash.

3. Connect the female side of the T-Valve to the incoming water connection on the bottom of your toilet tank, ensuring the rubber washer is properly seated.

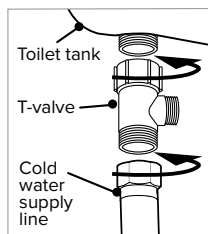

Steps 3-4

NOTES

- The T-Valve connects to the fill valve directly under your toilet tank - it does not connect at the wall.
- Only connect to the cold toilet water supply line.
- If your water supply line is rigid you may need to replace the water supply line before continuing.

4. Connect the water supply line coming from the wall to the bottom of the T-Valve

5. Install Mounting Plate for Standard Installation (see page 12, step 6 for instructions on using the Top-Mount Brackets)

- Place adjustable mounting plate over mounting holes on toilet, rubber side facing down, arrow pointing to the toilet bowl.
- Insert the mounting bolts through the mounting plate and mounting holes of the toilet. Be sure that the square mounting bolt head is even with the sides of the mounting plate.

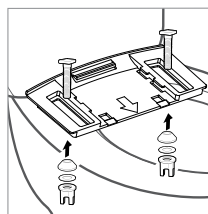

Steps 5b & 5c

Swash Installation

- c. Slide rubber cone washer, flat washer, and then nut onto mounting bolts under the toilet bowl. Tighten to keep mounting plate in place.
-
6. Install Mounting Plate for top-mounted toilet seats (see page 11, step 5 for instructions on Standard Installation). This method will use a combination of the included Top-Mount Brackets and the original toilet seat mounting bolts.
 - a. Place adjustable mounting plate over mounting holes on toilet, rubber side facing down, arrow pointing to the toilet bowl.
 - b. Place provided Top Mount Brackets, flat side down, into the slots of the mounting plate, over the bolt holes.
 - c. Insert the original toilet seat mounting bolts through the Top-Mount Brackets and into the threaded bolt holes of the toilet, using a screwdriver to tighten.
 7. Connect the Bidet Hose to the Seat
 - a. Connect the elbow side of the bidet hose to the water inlet. Hand-tighten to secure. Take care not to twist the bidet hose, excessively bend it, or strip the plastic screw threads when screwing the hose onto the bidet seat.
 8. Attach the Swash to the Mounting Plate
 - a. Set the Swash flat on the toilet bowl in front of the mounting plate, and slide seat onto plate until it is secure.
 - b. If the seat appears too short or too long for the toilet, adjust the mounting plate accordingly. To adjust the mounting plate, loosen the nuts underneath the toilet and slide seat forward or backwards as needed. Once the seat is lined up properly, tighten the nuts to hold in place.
- NOTE:** For those with mobility issues, we recommend our Swash 1400 or Swash 1000 bidet seats, as their mounting systems are engineered for the most secure transitions from wheelchairs or walkers.
9. Connect the open end of the Bidet Hose to the T-Valve.
 10. Turn On Water Supply
 - a. Open the main water supply valve slowly and check for leaks.
 - b. Wait 5 minutes, check again and if there are no leaks continue.

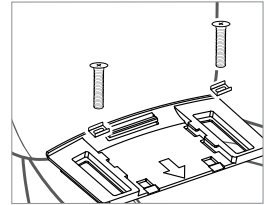

Steps 6b & 6c

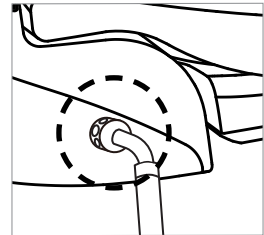

Step 7a

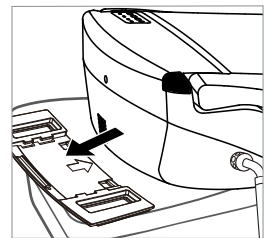

Step 8b

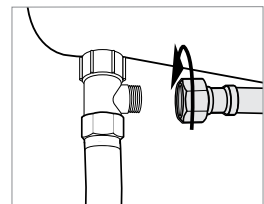

Step 9

Swash Installation

11. Plug the Power Cord into an Electrical Outlet
 - a. If the Power Indicator is not illuminated press any button on the control panel.

NOTE: Make sure to only use a grounded GFCI (ground fault circuit interrupter) electrical outlet. In the case of a short circuit, a grounded GFCI outlet may help prevent electric shock or injury.

12. Fill the Water Reservoir Tank
 - a. Press either the "Rear" or "Front" button on the remote control to fill the Water Reservoir Tank with water.
 - b. The Swash will beep continuously while the tank is filling and will emit one long beep to indicate when the tank is full.
 - c. Wait 3-5 minutes for the water to heat up, and the Swash will be ready for use.
13. Follow instructions on page 19 for using the Swash.

Remote Control Installation

1. Battery Installation*

- Remove the Remote Control from the Wall Mount.
- Turn remote over and remove the battery compartment. Insert the two included AAA batteries and replace battery cover.
- To confirm the batteries are installed correctly, press and release the DRY button. One of the center vertical LED lights will illuminate for twenty seconds.

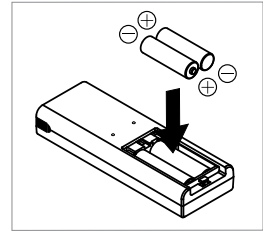

Step 1b

* IMPORTANT BATTERY INFORMATION

- Always purchase the correct size and grade of battery most suitable for the intended use.
- Clean the battery contacts and also those of the device prior to battery installation.
- Remove batteries from equipment which is not to be used for an extended period of time.
- Remove batteries if consumed or if product is to be left unused for a long time.

2. Mount Remote (optional)

- Identify a location in the bathroom for the remote control that is visible and reachable from the toilet.
- Use the provided double-stick tape on the back of the remote wall mount. Make sure the remote mount is fully secure so that it does not fall and damage the remote control.
- Slide the remote control into the mount.

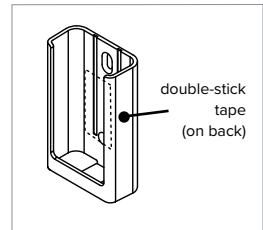

Step 2b

External Bidet Filter Installation

NOTE: Customers with hard water, well water, and softened water can extend the life of their bidet seat by purchasing and installing an external inline water filter to be used with the Swash. The bidet filter should be changed every six months, and can be purchased online at brondell.com.

1. Turn Off Water Supply Valve and Flush Toilet.
 - a. Turn water valve off to stop the flow of water.
 - b. Flush toilet and hold down handle to completely empty tank.
2. Disconnect the Bidet Hose from the T-Valve
3. Connect the female end of the Swash Filter to the open T-Valve connection.
4. Connect the Bidet Hose to the male end of the Swash Filter.
5. Turn the toilet water supply valve back on.

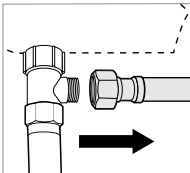

Step 2

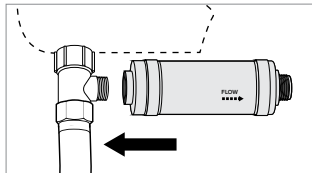

Step 3

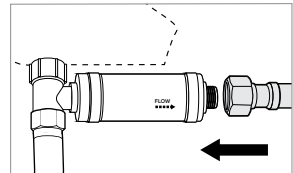

Step 4

OPERATING THE SWASH

DS725 Remote Control

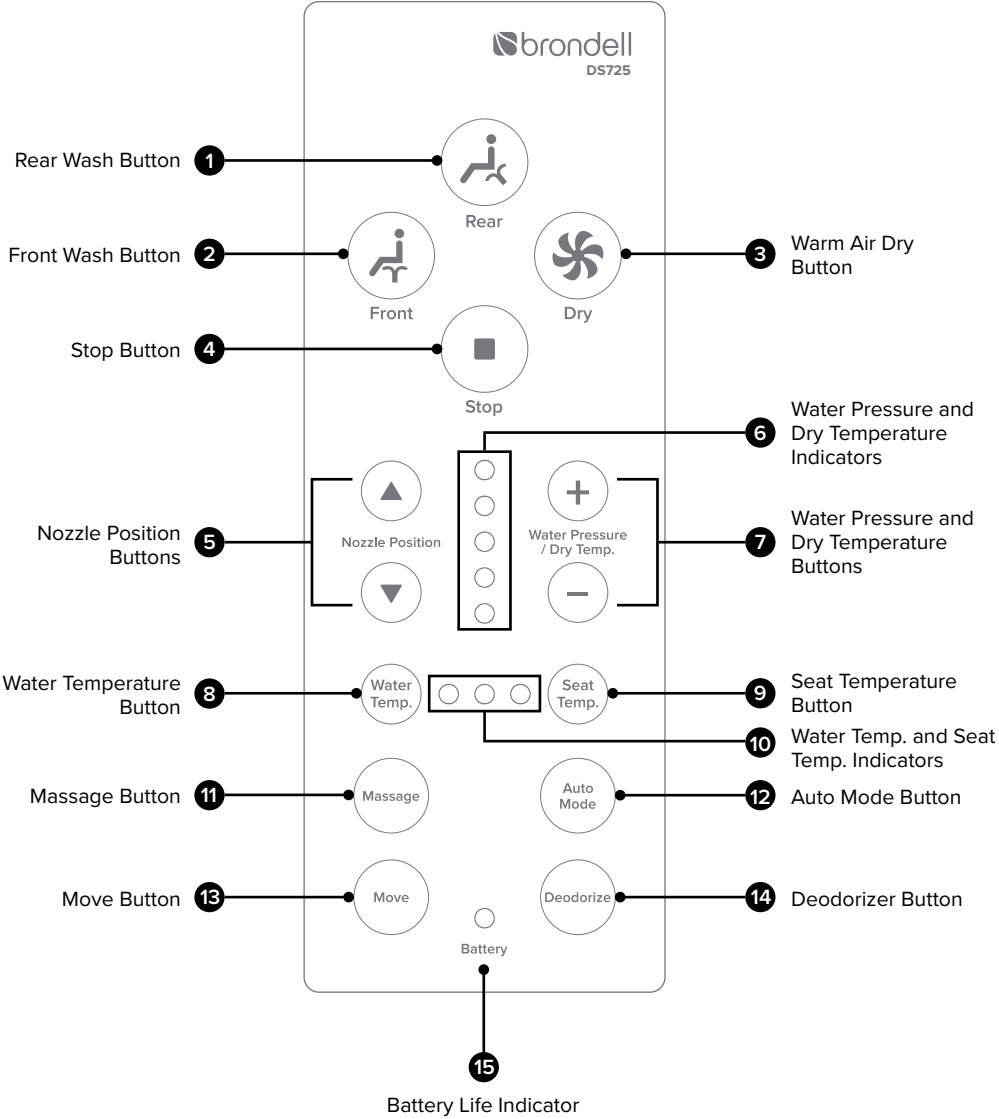

DS725 Remote Control

1. Rear Wash Button

Press once to initiate a two-minute rear wash.

2. Front Wash Button

Press once to initiate a two-minute front (feminine) wash.

3. Warm Air Dry Button

Press once to initiate a two-minute warm air dry cycle.

4. Stop Button

Press to stop all wash or dry functions currently operating.

5. Nozzle Position Buttons

Press the arrow up and arrow down buttons to adjust the nozzle position forward and backward during a wash cycle.

6. Water Pressure and Dry Temperature Indicators

These lights indicate the Water Pressure setting during a wash cycle, and the dryer temperature during a Dry cycle.

7. Water Pressure and Dry Temperature Buttons

Press the "+" and "-" buttons to increase and decrease the outgoing water pressure to one of five settings. Pressing these buttons while the Warm Air Dryer is operating will adjust the drying temperature. Settings will be saved for the next use.

8. Water Temperature Button

Press and release this button to adjust the outgoing water temperature to one of four settings (LO: 34° C / 93.2° F, MED: 37° C / 98.6° F, HI: 40° C / 104° F, and OFF). Settings will be saved for the next use.

9. Seat Temperature Button

Press and release the "Seat Temp" button to adjust the seat temperature to one of four settings (LO: 35° C / 95° F, MED: 38° C / 100.4° F, HI: 40° C / 104° F, and OFF). Settings will be saved for the next use.

10. Water Temperature and Seat Temperature Indicators

These lights indicate the water temperature setting while a wash cycle is active, and the seat temperature setting during all other times.

11. Massage Button

Pressing this button while a wash is running enables the water to repeatedly increase and decrease in pressure in a pulsating pattern. Press again to stop.

12. Auto Mode Button

Press this button once to initiate a one minute rear wash cycle followed by a one minute dry cycle. See Page 20 for more information.

13. Move Button

Press to initiate nozzle oscillation (repetitive forward and backward nozzle movement) during either the Front or Rear Wash. Press again to stop the oscillation.

14. Deodorizer Button

Press this button to activate a one-minute Deodorizer cycle.

15. Battery Life Indicator

This indicator will light up when the batteries are low. See Page 14 on how to replace the batteries.

DS725 Auxiliary Control

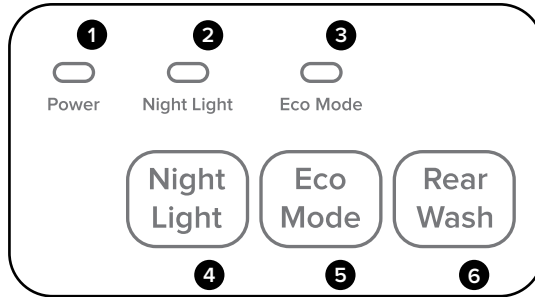

AUXILIARY CONTROL PANEL

1. Power Indicator Light

This light is illuminated when there is electricity running to the bidet seat.

2. Night Light Indicator

This indicator is illuminated when the Night Light is on. The indicator extinguishes when the Night Light is turned off.

3. Eco Mode Indicator

This indicator is illuminated when Eco Mode is selected.

4. Night Light Button

Pressing this button turns the Night Light on and off.

5. Eco Mode Button

Pressing this button turns Eco Mode on and off. See page 20 for more details on Eco Mode.

6. Rear Wash Button

Pressing this button initiates the Rear Wash cycle. Press this button again to stop the Rear Wash cycle.

Using the DS725

NOTE: The wash functions will not work unless the sensor in the seat detects someone sitting down (with the built-in skin conductivity sensor). To override the Seat Sensor, please see the instructions on Page 20.

Prepare for Wash

Sit on the seat to ensure skin-to-seat contact on the Seat Sensor. Once contact is made the seat will automatically:

1. Give an audible beep letting you know the Seat Sensor has been engaged.
2. If the bidet was set to Eco Mode, the seat and water temperature will rise to the set temperature settings.

Warm Water Wash

When ready to wash, press the Rear Wash or Front Wash button on the remote control one time to initiate a wash. The nozzle will self-clean, extend into the toilet bowl, spray for two minutes, turn off automatically, retract, and self-clean once again.

1. While washing, users can adjust the water temperature, pressure, and nozzle position settings, as well as initiate the Massage and Pulse features by following the notes on Page 17.
2. If you would like to stop the wash before the two minute cycle ends, press the Stop button to discontinue water flow.
3. After extended use the water may decrease in temperature if a LOW, MEDIUM, or HIGH water temperature setting is selected. To regain warmer water, stop all wash functions for three minutes to allow the bidet to reheat the water.

Warm Air Dryer Function

Press the Dry button to activate the warm air dryer. The dryer will run for two minutes and turn off automatically.

1. While the air dryer is operating, users can adjust the dryer temperature to a comfortable level using the Dry “+” and “-” buttons. The dry temperature will be reflected on the five indicator LED lights (see Page 17).
2. If you would like to stop the dryer before the two minutes has elapsed, press Stop.

Deodorizer

Press the Deodorizer button to activate the deodorizer for a one minute cycle. Push the Stop button to turn the deodorizer off.

NOTE: The deodorizer will not function during any wash or dry cycle.

Using the DS725

Auto Mode

Pressing the “Auto Mode” button will initiate a one-minute Rear Wash with the following parameters preset:

- Seat Temperature set to Medium
- Nozzle Oscillation (Move) on
- Water Pressure set to Level 3
- Water Temperature set to Medium

After the wash cycle is over, Auto Mode will initiate a one-minute Warm Air Dry cycle on Level 2.

NOTE: All wash and dry settings are adjustable, while the Auto Mode wash cycle is running, to suit your preferences

Eco Mode

In this mode the water in the tank and the seat temperature will be heated to 30°C / 86°F when the bidet is not in use. Once a person sits on the bidet the Swash will revert to the last seat and water temperature settings used. To select this option press and release the “Eco Mode” button on the Seat Control Panel to illuminate its indicator.

Special Mode Operations

NOTE: Do not sit on the seat when programming Special Mode Operations. The process will not work while the seat is occupied.

Seat Sensor Override

The Seat Sensor is activated at the factory by default. Completing the following steps will bypass the seat sensor located in the seat and allows the wash functions and dry functions to operate without the sensor being engaged. Use caution in this mode.

1. Unplug the Swash from the outlet.
2. Press and hold the Night Light and Rear Wash buttons on the auxiliary control panel, and plug the Swash back in while continuing to hold the two buttons down.
3. If the water tank is full, you will hear a total of two beeps. You'll hear one beep once the Swash has been plugged back in. Keep holding the Night Light and Rear Wash buttons down until you hear a second beep (about five seconds later).
4. The second beep indicates that the Seat Sensor has been overridden.
5. To reactivate the Seat Sensor, repeat Steps 1-3.

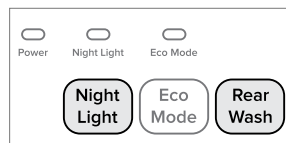

Steps 2 & 3

Activating/Deactivating Silent Mode

By default, the Swash will beep to confirm commands from the remote control and auxiliary control panel. Follow the steps below to silence the beeping sounds.

1. Press and hold the Night Light and Eco Mode buttons on the auxiliary control panel
2. A beep will sound, indicating that Silent Mode has been activated.
3. To deactivate Silent Mode, repeat Steps 1 and 2.

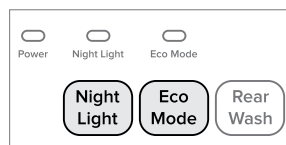

Steps 1 & 2

Product Specifications

BRONDELL SWASH ADVANCED BIDET SEAT

Model	DS725-EW, DS725-RW
Power Voltage	120 V, 60 Hz
Power Consumption	660 W
Supply Water Pressure	14.2 psi – 106.6 psi
Dimensions	Elongated: 15.5 in x 20.87 in x 6.10 in Round: 15.5 in x 19.5 in x 6.10 in
Weight	Elongated: 9.7 lbs / Round: 9.5 lbs
Seat / Lid Weight Limit	275 lbs. / 178 lbs.
Operating Temperature	37.4° F – 104° F
Mesh Filter	0.43 in x 0.6 in diameter

WARM WATER WASHING DEVICE

Rear Wash	Maximum .95 L/min., automatic nozzle self-cleaning
Front Wash	Maximum .95 L/min., automatic nozzle self-cleaning
Standard Time	Rear Wash: 2 minutes / Front Wash: 2 minutes
Water Pressure Control	5 Levels
Water Temperature Control	4 Levels: Off - incoming water temperature, Low – 93.2° F, Medium – 98.6° F, High - 104° F
Heater Power Consumption	600W
Safety Devices	Thermal Fuse, Thermostat, Water Level Sensor

HEATED SEAT

Seat Temperature Control	4 Levels: Off - room temperature Low - 95° F, Medium – 100.4° F, High - 104° F
Heater Power Consumption	55 W
Safety Devices	Thermostat

NOTE: The specifications listed above are subject to change without prior notice for reasons of improving the product performance.

Seat Cleaning & Removal, Nozzle Cleaning



Unplug the Swash from the power source before cleaning or removing the seat.

Seat Cleaning & Removal

Use a soft, damp cloth and mild cleanser (such as dish soap, Simple Green or Windex) to wipe down the seat. **DO NOT** scrub or use harsh, abrasive products to clean the Swash. **DO NOT** use thinner, benzene, acidic chemicals, chloride, or hydrochloric acid detergent. This may result in corrosion to the metal parts or discoloration or scratches to the bidet body.

For a more thorough cleaning, you may remove the Swash. To remove the bidet, forcefully pull the bidet away from the toilet tank off of the mounting plate.

NOTE: Be cautious of leaving home and beauty products in contact with the bidet seat, the result of which can be irreversible discoloration. Most stains can be removed using a 1:1 mix of rubbing alcohol and water and a soft cloth or towel. However, some permanent stains are the result of substances left on the seat while the seat heater was activated. Be cautious of home and beauty products (including but not limited to various hair and air freshener sprays, lotions, body wash, skin tanners, body butters, and oils) that come in contact with the seat. Wash off any substances that come in contact with the seat as soon as possible. If necessary, replacement seat parts can be purchased through Brondell customer support.

Nozzle Cleaning

1. Press and release the Eco Mode and Rear Wash buttons on the auxiliary control panel simultaneously. The nozzle will extend into the toilet bowl.
2. Gently clean the nozzle manually with a soft cloth or toothbrush.
3. To retract the nozzle press the “Stop” button on the Remote Control.

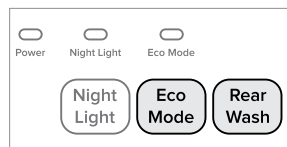

Step 1

NOTE: The Nozzle Cleaning function will not work if the seat is occupied.

Cleaning the Mesh Filter & Product Storage

Cleaning the Mesh Filter

Cleaning intervals will differ depending on use and water quality. It is recommended to check the filter at least once a year.

1. Turn off the water supply and hold the toilet's flush lever down until all of the water has drained from the tank.
2. Unplug the Swash, remove the bidet from the toilet, and disconnect the bidet hose. You may want to use a bucket to catch any dripping water from the bidet hose.
3. Remove the Mesh Filter from the water inlet with a pair of tweezers or needle-nosed pliers.
4. Clean the filter with a toothbrush while running under tap water to effectively remove any foreign substances or build-up.
5. Replace the Mesh Filter and carefully check that it is installed correctly. If improperly installed, it could result in the product leaking water.
6. Reconnect the bidet hose and place the seat back on the toilet. Plug the cord back in, and turn the water supply back on.
7. Press either the Rear or Front button on the remote control to refill the Reservoir Tank with water.

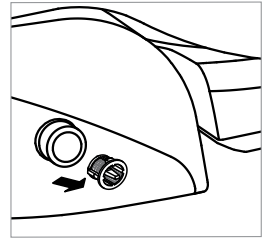

Step 3

Product Storage

Short Term Non-Use

If the product will not be used for more than a few weeks, you can simply unplug it. You may also consider shutting the water supply off at the wall for extra precaution.

Long Term Non-Use

If the product will not be used for an extended time (longer than four months), you should unplug the unit, shut the water supply off at the wall, remove the Swash from the toilet by forcefully pulling the Swash away from the tank off of the mounting plate. Remove the bidet hose. To drain the Hot Water Heater, unscrew the drain plug by turning it counterclockwise by 90 degrees towards “OPEN,” allowing any residual water to drain out.

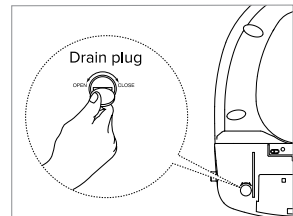

Troubleshooting

If the bidet appears to be operating abnormally, please review the troubleshooting tips before calling the Brondell Service Center as most issues are easily resolved with a few simple steps. If you are unable to resolve the issue after checking the following items, please call the Service Center at 888-542-3355, Mon–Fri, 9am–5pm PST (English and Spanish spoken), or email us at support@brondell.com.

Check before continuing:

- Make sure the Swash is connected to power and that the outlet is working properly.
- Make sure you check & test the reset button on the GFCI outlet (Standard 120V GFCI outlet).
- Make sure main water supply valve is open.
- Make sure the seat is not in Eco Mode.
- Confirm there are no leaks from hoses or water supply.
- Make sure Mesh Filter is clean and free of build up or debris (see maintenance section).

After checking items above, refer to the following troubleshooting chart for additional solutions

Problem	Possible Cause(s)	Solution(s)
The bidet seat is not working	1. Bidet not plugged in	1. Make sure the bidet is plugged in.
	2. No power to Swash	2. Check and reset GFCI outlet.
	3. The incoming water is too hot	3. Ensure that the bidet seat is connected to the cold water supply.
	4. Not activating Seat Sensor	4a. Adjust sitting position to fully cover the Seat Sensor. 4b. Override the Seat Sensor.
Product shuts off during use	1. Washing time exceeded the cycle time	1. The wash cycles run for two minutes. Press the wash button after the wash has finished to continue the wash cycle.
	2. Power failure	2. Check and reset GFCI outlet.
	3. Water supply too hot	3. Ensure that the Swash is connected to the cold water supply only.
Low water flow or spray pressure	1. Clogged filter	1. Remove, clean, and reinstall mesh filter (see maintenance section).
	2. Water supply valve not opened fully	2. Check that the water supply valve at wall is fully open.
	3. Nozzle is dirty	3. Clean nozzle (see maintenance section).
	4. External bidet filter	4. If you have an external bidet filter, check and replace if necessary.
	5. Pressure settings	5. Increase the water pressure settings.

Troubleshooting

Problem	Possible Cause(s)	Solution(s)
Nozzle does not function properly	<ol style="list-style-type: none"> 1. Nozzle is dirty 2. Clogged filter 3. Water pressure is too low 4. External bidet filter 	<ol style="list-style-type: none"> 1. Clean nozzle (see Page 23). 2. Remove, clean, and reinstall mesh filter (see Page 24). 3. Check water supply valve at wall is fully open. 4. If you have an external bidet filter, check and replace if necessary.
Water Temperature is low	<ol style="list-style-type: none"> 1. Water comes out cold 2. Water comes out lukewarm 3. Water starts out hot but decreased in temperature 	<ol style="list-style-type: none"> 1. The Water temperature level is turned off or set to "LOW". Adjust temperature on control panel. 2. Turn off Eco Mode. 3. Warm water can be used for about 40 seconds at the "MEDIUM" setting. Stop all wash functions to allow the heater to warm the water.
Seat is not heated	<ol style="list-style-type: none"> 1. Seat temperature set to off 	<ol style="list-style-type: none"> 1. Make sure that the Seat temperature setting is on.
Bidet wash feature does not work or fails to spray	<ol style="list-style-type: none"> 1. Body sensor does not detect that you are sitting on the Swash 	<ol style="list-style-type: none"> 1a. Adjust sitting position to fully cover the Body Sensor (see Page 8). 1b. Override the body sensor – refer to Special Mode Operation section on Page 21 to unlock the body Seat Sensor.
Water (wash spray) not heated	<ol style="list-style-type: none"> 1. Water temperature set to off 2. Resettable fuse blown 	<ol style="list-style-type: none"> 1. Make sure that the Water temperature setting is on. 2. The bimetal resettable fuse may blow if the temperature exceeds over the normal level. The bidet will not work and show an error message until the bidet cools down.
Water flows before or after use	<ol style="list-style-type: none"> 1. Water coming from nozzles 	<ol style="list-style-type: none"> 1a. The water that comes out between the nozzle before or after a wash cycle is the self-clean cycle and is not a malfunction. 1b. Residual water may drip into the bowl for several seconds after a wash cycle or self-clean cycle, and is not a malfunction.

Troubleshooting

Problem	Possible Cause(s)	Solution(s)
Water leaks from areas other than the nozzle	1. Water leaking from the T-valve	1. Make sure that the rubber gasket is inserted correctly into the T-valve (flat side down with lip pointing up towards the toilet tank connection) and firmly tighten the connector.
	2. Water leaking from the bidet hose connection	2. Make sure that the bidet hose is correctly connected and tight. Check any rubber washers and do not over tighten.
	3. Water leaking from under the seat	3. Check if there is anything between the mesh filter and bidet. Remove, clean, and reinstall mesh filter. Check if the filter is damaged (see maintenance section).
	4. Water leaking from behind the seat	4. Check the water tank plug in the back of the seat (see maintenance section under product storage and use).

Warranty

Brondell products are backed by some of the most comprehensive warranties in the industry. Brondell warrants that all products (excluding consumable items) shall be free from defects in material and workmanship under normal use and service.

DS725 Residential One-Year Limited Warranty

100% Coverage of all parts and labor for the entire product (excluding consumable filters) for the first year from original date of purchase.

DS725 Commercial Warranty

Warranty period one year from original purchase date for all Brondell products. Warranties may not apply to products that are used for heavy commercial, hospital, or other high use non-residential applications.

Exclusions and Limitations

1. BRONDELL warrants its products to be free from manufacturing defects under normal use and service. This warranty is extended only to the ORIGINAL PURCHASER.
2. BRONDELL's obligations under this warranty are limited to repairs or replacement, at BRONDELL's option, of products or parts found to be defective, provided that such products were properly installed and used in accordance with instructions. BRONDELL reserves the right to make such inspections as may be necessary in order to determine the cause of the defect. BRONDELL will not charge for labor or parts in connection with warranty repairs for the first year from date of purchase on all products except those that may be subject to commercial use limitations.
3. BRONDELL is not responsible for the cost of removal, return (shipping) and/or re-installation of products. This warranty does NOT apply to:
 - Damage or loss which occurs during shipment.
 - Damage or loss sustained through any natural or man-made causes beyond the control of BRONDELL, including but not limited to fire, earthquake, floods, etc.
 - Damage or loss resulting from sediments or foreign matter contained in a water system.
 - Damage or loss resulting from negligent or improper installation including installation of a unit in a harsh or hazardous environment.
 - Damage or loss resulting from removal, improper repair, modification of the product, or improper maintenance including damage caused by chlorine or chlorine related products
 - Damage or loss resulting from electrical surges, electrical outages, lightning strikes, or other acts which are not the fault of Brondell or which the Product is not specified to tolerate.
4. This warranty gives you specific legal rights. You may have other rights which vary from state to state. THIS WRITTEN WARRANTY IS THE ONLY WARRANTY MADE BY BRONDELL. REPAIR OR REPLACEMENT AS PROVIDED UNDER THIS WARRANTY SHALL BE THE EXCLUSIVE REMEDY AVAILABLE TO THE PURCHASER. BRONDELL SHALL NOT BE RESPONSIBLE FOR LOSS OF USE OF THE PRODUCT OR FOR OTHER INCIDENTAL, SPECIAL, FOR CONSEQUENTIAL DAMAGES OR EXPENSES INCURRED BY THE PURCHASER OR FOR LABOR OR OTHER COSTS DUE TO INSTALLATION OR REMOVAL OR COSTS OF REPAIRS BY OTHERS, OR FOR ANY OTHER EXPENSE NOT SPECIFICALLY STATED ABOVE. EXCEPT TO THE EXTENT PROHIBITED BY APPLICABLE LAW, ANY IMPLIED WARRANTIES, INCLUDING THAT OF MERCHANTABILITY, ARE EXPRESSLY LIMITED TO THE DURATION OF THIS WARRANTY. SOME STATES DO NOT ALLOW LIMITATIONS, SO THE ABOVE LIMITATION AND EXCLUSION MAY NOT APPLY TO YOU.

How to Obtain Service

To obtain repair service under this warranty, you must contact an authorized BRONDELL Service Center to obtain an RMA (Return Merchandise Authorization) number. Proof of purchase in the form of a copy of the original receipt must accompany the returned unit for the warranty to be valid. Take or ship the unit pre-paid to the closest Brondell authorized service center along with the RMA number and proof of purchase.



MANUFACTURED BY:
Brondell, Inc.

Made in Korea

**Please retain receipt records for any
warranty claims.**