

CRAFTMADE™

GWYNETH

#50401-BNK /#50401-BNK-WG /#50401-FB/#50401-FB-WG
#50402-BNK /#50402-BNK-WG /#50402-FB/#50402-FB-WG
#50403-BNK /#50403-BNK-WG /#50403-FB/#50403-FB-WG
#50404-BNK /#50404-BNK-WG /#50404-FB/#50404-FB-WG

PLEASE READ AND SAVE FOR FUTURE REFERENCE.

CAUTION

1. Turn off the main power at the circuit breaker before installing the fixture in order to prevent possible shock.
2. All electrical connections must be in accordance with local and National Electrical Code (N.E.C.) standards. If you are unfamiliar with proper electrical wiring connections, obtain the services of a qualified electrician.

GENERAL

Remove all parts and hardware from the box and make sure that none are missing by referencing the illustrations provided.

Bulb Required (not included): 1 -Medium Base 100 Watt Max.(for 1-Light Wall Sconce)
2 -Medium Base 100 Watt Max.(for 2-Light Vanity)
3 -Medium Base 100 Watt Max.(for 3-Light Vanity)
4 -Medium Base 100 Watt Max.(for 4-Light Vanity)

1-LIGHT WALL SCONCE

2-LIGHT VANITY

3-LIGHT VANITY

4-LIGHT VANITY

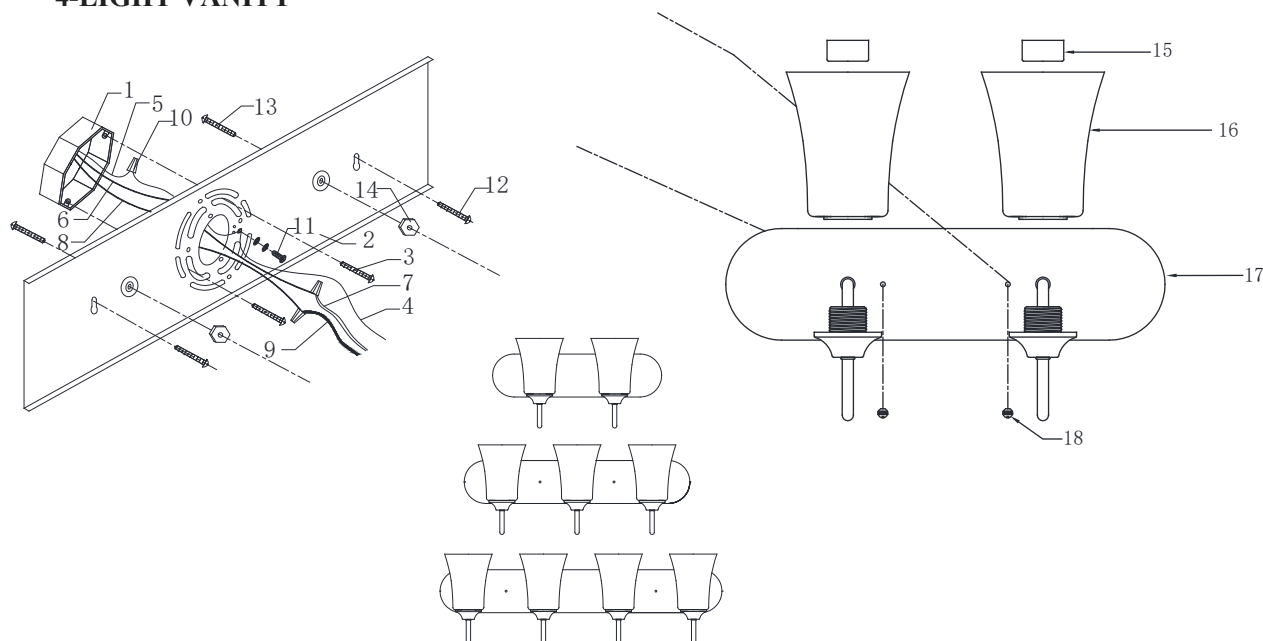

1. OUTLET BOX (NOT INCLUDED)
2. BACK PLATE
3. MOUNTING SCREW
4. FIXTURE GROUND WIRE
5. SUPPLY GROUND WIRE(not included)
6. WHITE SUPPLY WIRE
7. RIBBED(or WHITE) FIXTURE LEAD WIRE
8. BLACK SUPPLY WIRE
9. SMOOTH(or BLACK)FIXTURE LEAD WIRE
- 10.WIRE CONNECTORS

11. GROUND SCREW(pre-attached)
12. ANCHOR SCREWS
- 13.WALL ANCHORS
14. HEXSSSS NUTS(pre-attached)
15. SOCKET RING(pre-attached)
- 16.SHADES
17. FIXTURE
18. DECORATIVE NUTS(pre-attached)