

CRAFTMADE™

ALBANY #39702-CH / #39703-CH / #39704-CH
#39702-OB / #39703-OB / #39704-OB

PLEASE READ AND SAVE FOR FUTURE REFERENCE.

CAUTION

1. Turn off the main power at the circuit breaker before installing the fixture in order to prevent possible shock.
2. All electrical connections must be in accordance with local and National Electrical Code (N.E.C.) standards. If you are unfamiliar with proper electrical wiring connections, obtain the services of a qualified electrician.

GENERAL

Remove all parts and hardware from the box and make sure that none are missing by referencing the illustrations provided.

Bulbs Required (not included): 2 Medium Base 60 Watt Max. Incandescent (or CFL/LED equivalent),
(For 2-Light Vanity)
3 Medium Base 60 Watt Max. Incandescent (or CFL/LED equivalent),
(For 3-Light Vanity)
4 Medium Base 60 Watt Max. Incandescent (or CFL/LED equivalent),
(For 4-Light Vanity)

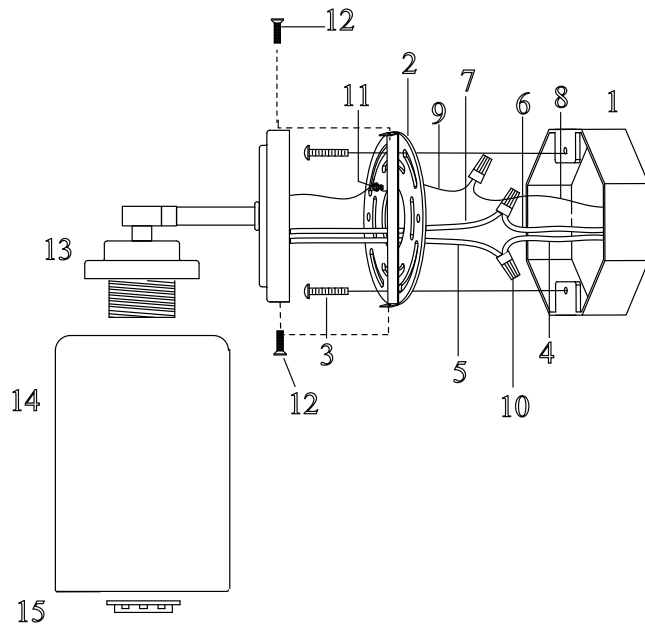
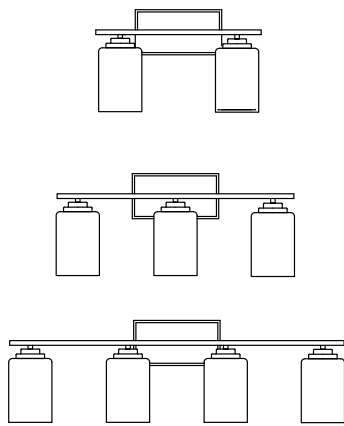

2-LIGHT VANITY

3-LIGHT VANITY

4-LIGHT VANITY

- | | |
|---|--------------------------------------|
| 1. OUTLET BOX (not included) | 8. SUPPLY GROUND WIRE (not included) |
| 2. MOUNTING PLATE | 9. FIXTURE GROUND WIRE |
| 3. OUTLET BOX SCREWS and WASHERS (pre-attached to outlet box) | 10. WIRE CONNECTORS |
| 4. BLACK SUPPLY WIRE (not included) | 11. GROUND SCREW (pre-attached) |
| 5. SMOOTH (or BLACK) FIXTURE LEAD WIRE | 12. FIXTURE SCREWS |
| 6. WHITE SUPPLY WIRE (not included) | 13. FIXTURE |
| 7. RIBBED (or WHITE) FIXTURE LEAD WIRE | 14. GLASS SHADES |
| | 15. SOCKET RINGS (pre-attached) |