

CRAFTMADE™

CELESTE #16712BNK2 / #16720BNK3 / #16727BNK4

PLEASE READ AND SAVE FOR FUTURE REFERENCE.

CAUTION

1. Turn off the main power at the circuit breaker before installing the fixture, in order to prevent possible shock.
2. All electrical connections must be in accordance with local and National Electrical Code (N.E.C.C) standards.
If you are unfamiliar with proper electrical wiring connections, obtain the services of a qualified electrician.

GENERAL

Remove all parts and hardware from the box and make sure that none are missing by referencing the illustrations provided.

Bulb Required(not included): 2 Candelabra 60 Watt Max. (for 2-light Vanity Bar)
3 Candelabra 60 Watt Max. (for 3-light Vanity Bar)
4 Candelabra 60 Watt Max. (for 4-light Vanity Bar)

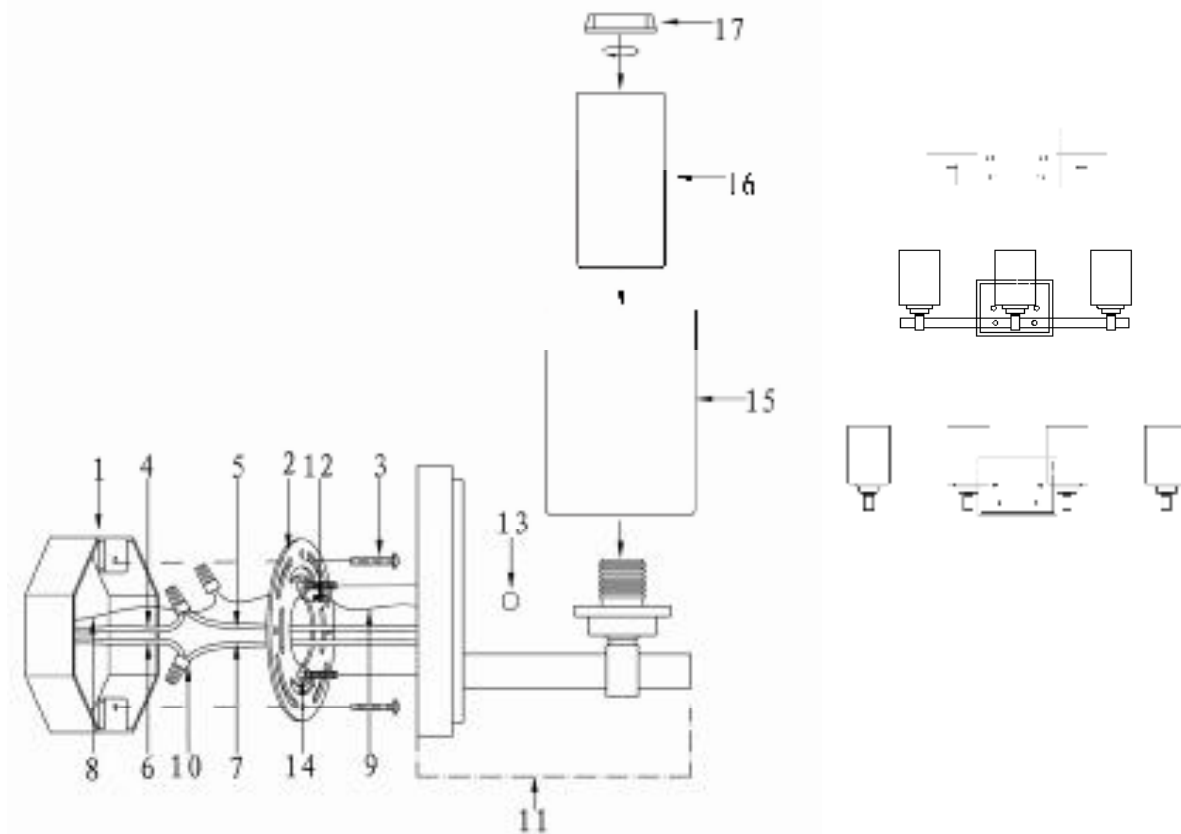

2-LIGHT VANITY BAR

3-LIGHT VANITY BAR

4-LIGHT VANITY BAR

- | | |
|-----------------------------|--|
| 1. OUTLET BOX | 9. BLACK SUPPLY WIRE |
| 2. MOUNTING BRACKET | 10. BLACK FIXTURE LEAD WIRE |
| 3. #8-32 IPS MOUNTING SCREW | 11. FIXTURE |
| 4. 1/8 IPS HEX NUT | 12. GROUND SCREW (pre-attached) |
| 5. NIPPLE | 13. DECORATIVE NUTS (pre-attached) |
| 6. SUPPLY GROUND WIRE | 14. FIXTURE SCREWS and HEX NUTS (pre-attached) |
| 7. FIXTURE GROUND WIRE | 15. OUTER GLASS SHADE |
| 8. WIRE NUT | 16. INNER GLASS SHADE |
| | 17. SOCKET RINGS (pre-attached) |