

# Installation



## Caution before installation!

- Check whether the size and shape of the toilet seat are suitable for installation.
- Check all the accessory parts are in place.
- Do not connect the power until installation is finalized.
- Ground connection should be done by authorized service person only.

### 1 Remove the existing toilet seat.

- Remove the existing toilet seat and lid by unfastening fixation nuts underneath.
- Keep the detached seat, lid and nuts for later use.

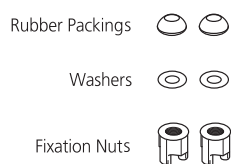

### 2 Drain toilet water tank completely after turning off the water supply by turning the shut off valve clockwise.

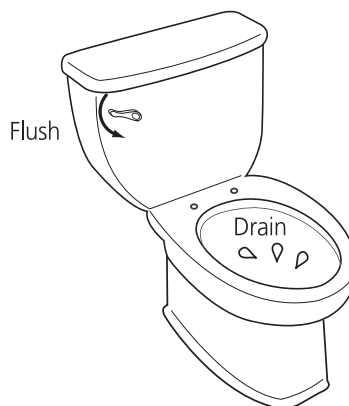
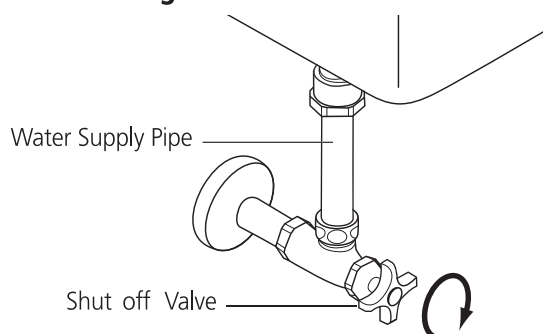

---

**3 Detach the water supply hose on the part of the toilet water tank, then install the T-valve.**

- In case of a rigid pipe, T-valve cannot be installed. Needs to purchase and install the separate flexible hose(for water tank).

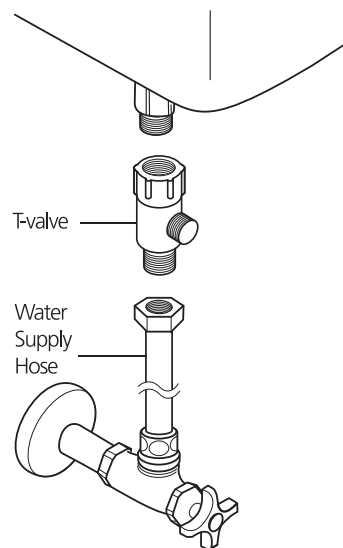

**4 Place the groove of the catch plate on the fixation holes of the toilet.**

- Possible to install for 140mm hole distance only.

**5 Insert the fixation bolts into the holes of the toilet.**

**6 Fix the catch plate tightly by fastening the Fixation bolts with Rubber packings, Washers, Fixation nuts.**

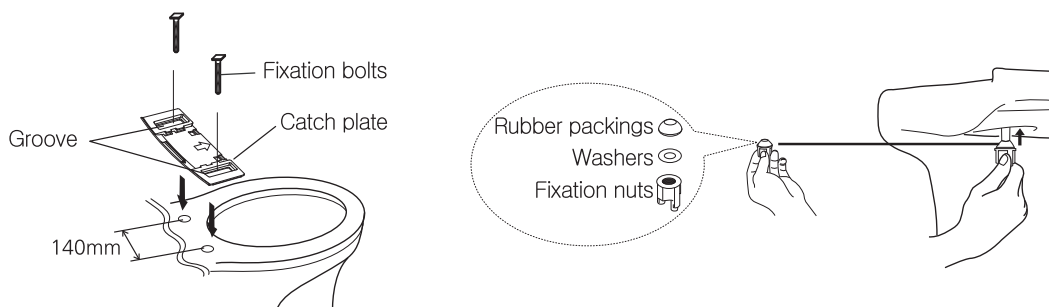

# Installation

## < For toilets with top tighten bolts >

Please, use brackets included in the package and the mounting bolts of the existing toilet seat.

- 4** Place the groove of the catch plate on the fixation holes of the toilet.
- 5** Set in place the brackets on the catch plate.
- 6** Fasten the catch plate with bolts (unfastened bolts from a existing toilet seat).

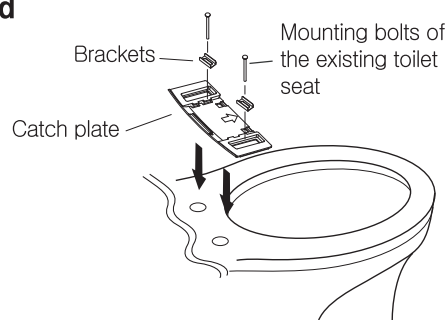

- 7** Connect the PVC flexible hose to the unit.

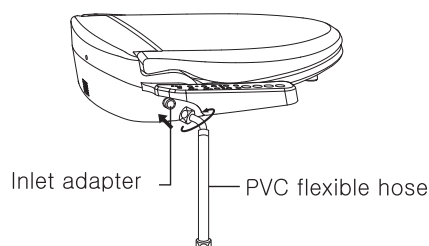

- 8** Slide the unit to the catch plate installed according to grooves underneath the unit.

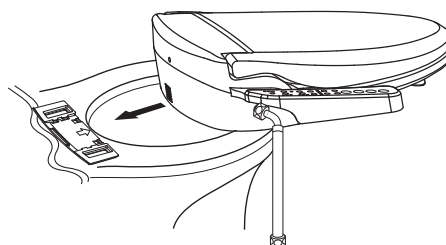

- 9** Connect the PVC flexible hose to the T-valve

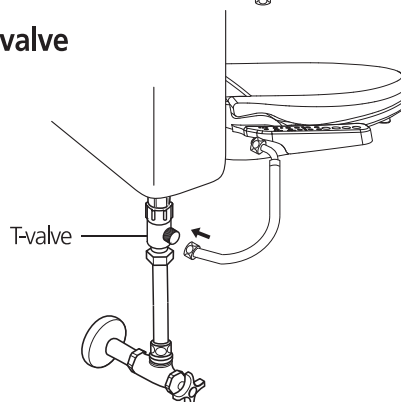

## [ Remote control equipped model ]

- 10** Attach the remote control on the wall with double stick tape

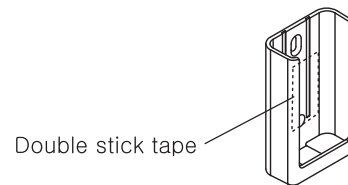

- 11** Insert batteries as illustration below and put the remote control into the remote control holder.

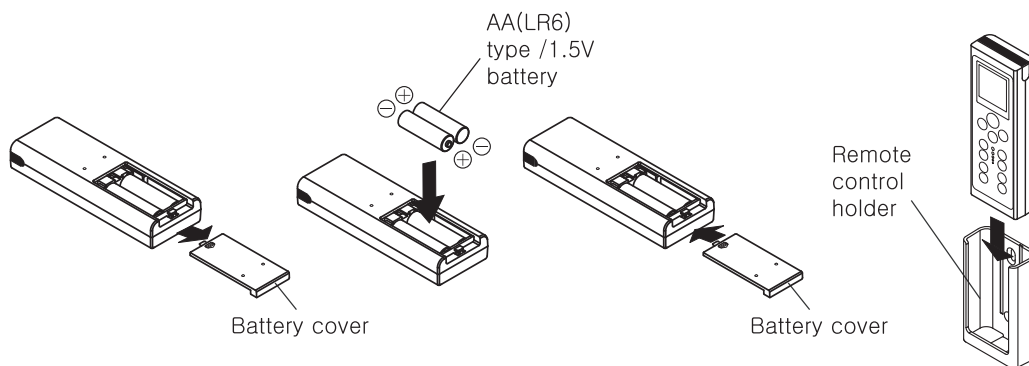

# Trial Operation

- 1 Open the shut off valve by turning counterclockwise.
- 2 Check for any water leakage on the connection hoses.

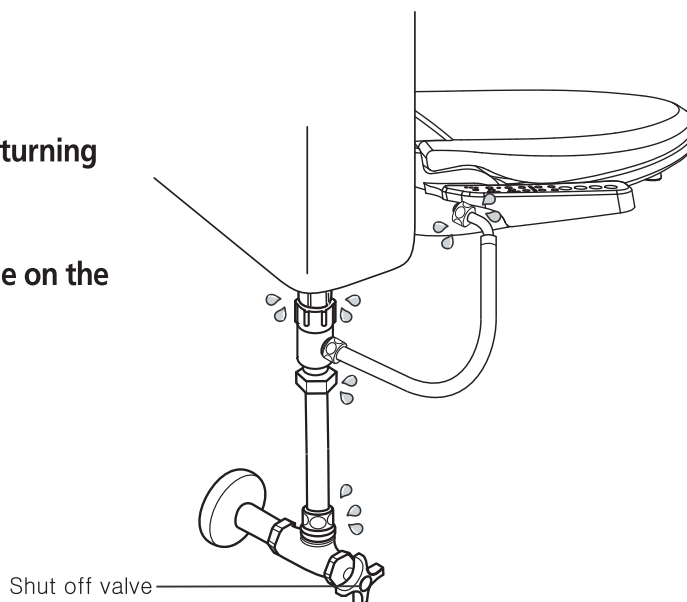

## 3 Connect the power plug.

- If the power indication light is not turned on after the power plug connection, press any button, then power goes ON.  
[ Remote control equipped model : Except "FR", "BK", "HI", "LO" button on the remote control ]

### ★ WARNING

Do not turn over or move the unit after power connection.  
It may cause electric shock.

- 4 To test the water spray operation, press either "CLEANSING" or "BIDET" button putting a hand on the seat sensor.

\*Cover the nozzle with a hand for water not to spatter out.

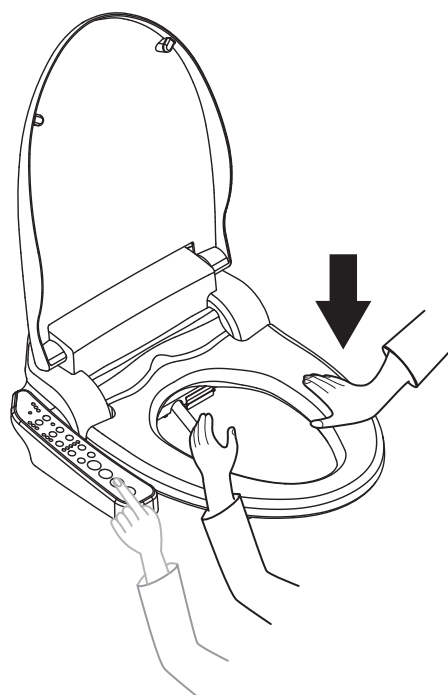

# Detachment and Service Request

Follow the below instructions if in need to detach the unit for to move.

- 1 Disconnect the power plug.
- 2 Close the water supply by turning the shut off valve clockwise and drain the toilet water tank completely.
- 3 Disconnect the PVC flexible hose from the T-valve and unfix the unit from the toilet. And unfix the catch plate from the toilet.

To detach the unit, pull forward at a state of lifting up the front part of the unit as shown on the illustration.

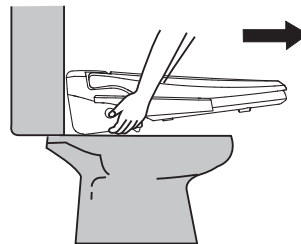

- 4 Disconnect the T-valve.
- 5 Connect the water-supply hose to the toilet water tank.
- 6 Open the shut off valve by turning counterclockwise and check any leakages on the connections.
- 7 Reinstall the original seat and lid to the toilet.

## < For service request >

Please send the unit detached to service center with a strong packing materials not to be damaged in transit. For the information of service center, please refer to "Product Registration" on the operating instruction manual.