



**ALLORA**USA

Sink & Faucet  
Wholesaler



## KITCHEN AND BATHROOM ACCESSORIES

Allora USA is a family owned and operated business that strives to be the best distributor on the east coast. By catering to the needs of the industry professionals such as builders, contractors, granite fabricators, and kitchen & bath dealers; Allora USA has quickly gained loyal customers within the trade.

Our goal at Allora USA is to offer top quality kitchen and bathroom accessories. We provide innovative and cost effective product designs to meet the specialized needs of our customers. Allora USA supports its reliable product line by utilizing the latest technologies and providing short lead times.

We offer a wide variety of kitchen and bath products to meet the unique needs of our clientele. The advantage that Allora USA holds over the competition lays in our ability to offer the most advance sinks, faucets, and other sanitary products on the market. We pay attention to every last detail as if it were the first.

### PRODUCTS

Today's faucets and sinks are held to a higher standard of luxury and function. The kitchen is becoming an entertainment center and you want your faucet and sink to be nothing short of stunning, with top-quality construction, of course.

### OUR MISSION

A relationship you'll value more with each passing year. Your Allora USA products are built for the long term, and so is the support behind it. Not only do we provide a strong warranty, we also offer an open line to product experts at our sterling headquarters.

We welcome the opportunity to serve your needs because family owned Allora USA takes this relationship personally.

# RAW MATERIAL

We use the low-impurity brass with the Pb content is less than 0.2%.

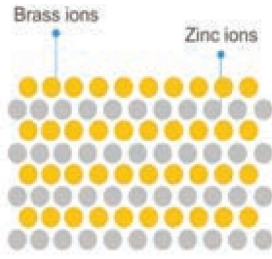

★★★★  
High-purity brass: less impurity, tight structure.

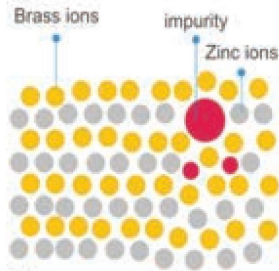

★★  
Normal brass: much impurity, unstable structure.



# GOOD PLATING

With high standard plating technology, our plating meet requirement of ASME A 112.18.1-2012 and CSAB 125.1-12.

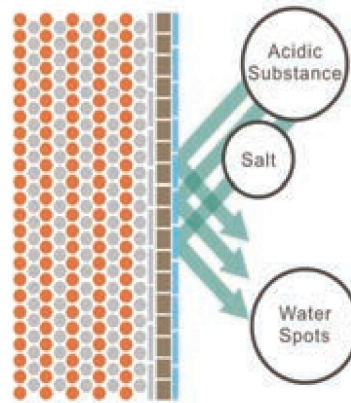
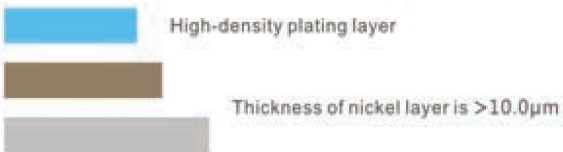

# WATER SAVING

Matching with worldwide recognized Neoperl aerator, water flow rate meets Watersense requirement

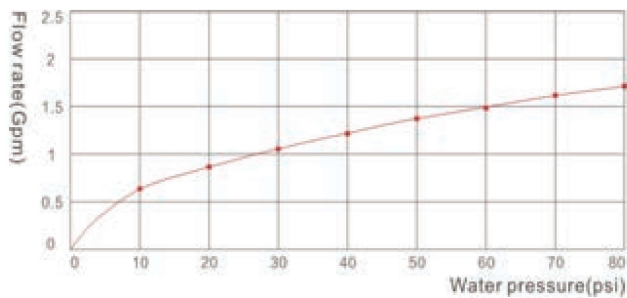

Professional surface treatment technology



# Tulip Series

Where elegance  
meets beauty



A-750-BN



## FLOW RATE CHARACTERISTICS



Flow rate complies with:  
ASME A112.18.1-2012/CSA B125.1-12.

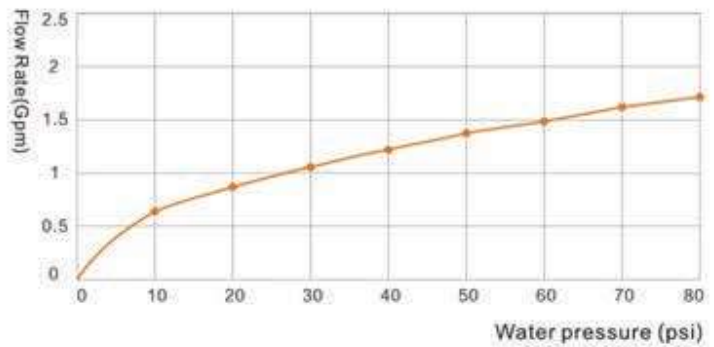

## TECHNICAL CHARACTERISTICS OF THE CARTRIDGE:



Max. Opening Angle:	23°
Max. Turning Angle:	90°
Max. Temperature:	90°C /194 °F
Recommended Tightening Torque:	6-8 Nm/53-70lbf • in
Hand-feel Torque:	0.2~0.4Nm/1.7-2.4lbf • in
Lever Break Torque:	7~9Nm/62-79.6lbf • in
Pressure Resistance Test:	Pneumatic:0.7Mpa Hydraulic:3.5Mpa
Flow Rate (under 3bar water pressure):	13.2L/min
Life Test:	ASME A 112.18.1-2005 500,000 times



① Ergonomic design for easy operation.



② Neoperl aerator, water saving and without splash.

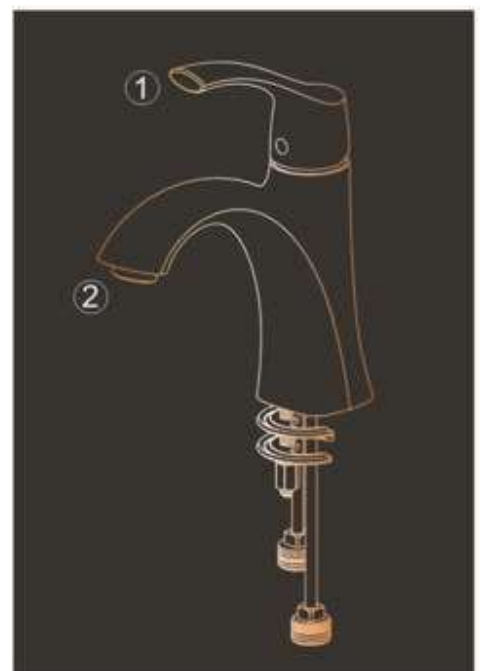

# TULIP BATHROOM SERIES

AVAILABLE FINISHES:  Polished Chrome  Brushed Nickel PVD



**MODEL: A-6550-BN** 

**MODEL: A-6550-C** 

- Premium material construction for durability and reliability.
- Ceramic disc valves exceed industry longevity standards, ensuring durable performance for life.
- Special coating features an easy to clean surface.
- Features a high-arched spout for more space to work with.
- Single or three hole installation.
- Includes drain set.
- Lifetime warranty.

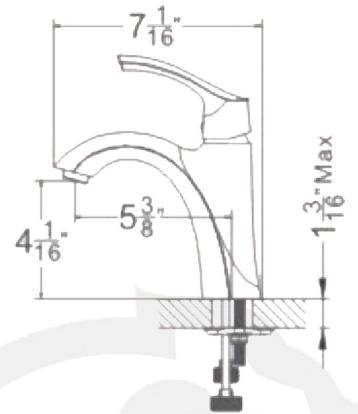

**MODEL: A-6560-BN** 

**MODEL: A-6560-C** 

- Premium material construction for durability and reliability.
- Ceramic disc valves exceed industry longevity standards, ensuring durable performance for life.
- Special coating features an easy to clean surface.
- Features a high-arched spout for more space to work with.
- Three hole installation.
- Includes drain set.
- Lifetime warranty.

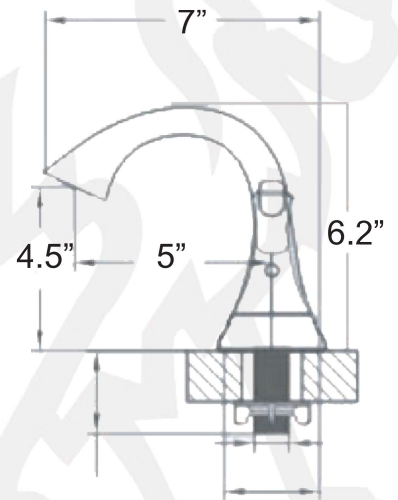

**MODEL: A-6570-BN** 

**MODEL: A-6570-C** 

- Two handle widespread lavatory faucet for 8"-16" centers.
- Premium material construction for durability and reliability.
- Special coating features an easy to clean surface.
- Features a high-arched spout for more space to work with.
- Three hole installation.
- Includes drain set.
- Lifetime warranty.

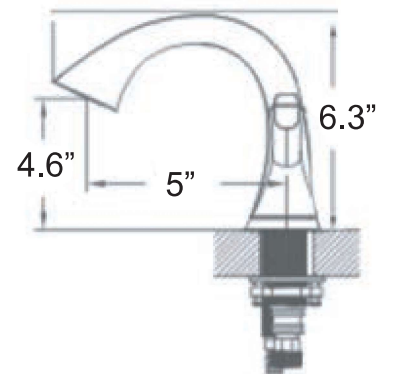

# TULIP BATHROOM SERIES

AVAILABLE FINISHES:  Polished Chrome  Brushed Nickel PVD

KITCHEN FAUCETS

BATHROOM FAUCETS

BAR FAUCETS

MODEL: **TUB-6580-BN** 

MODEL: **TUB-6580-C** 



- Premium material construction for durability and reliability.
- Ceramic disc valves exceed industry longevity standards, ensuring durable performance for life.
- Special coating features an easy to clean surface.
- Features a high-arched spout for more space to work with.
- Includes hand shower set.
- Four hole installation.
- Lifetime warranty.

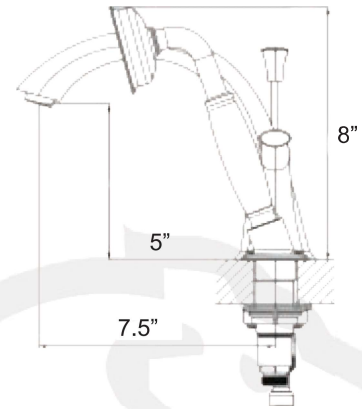



MODEL: **A-6550-BN** 



MODEL: **A-6550-C** 

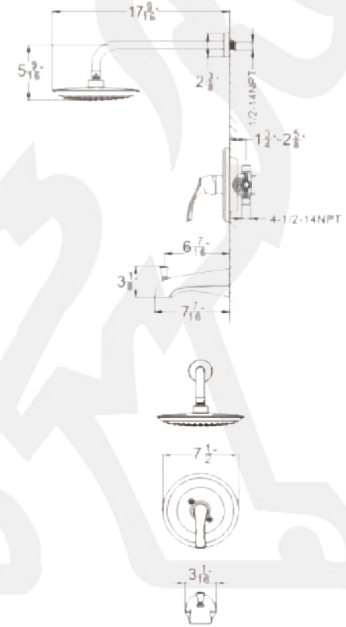





- Premium material construction for durability and reliability.
- Ceramic disc valves exceed industry longevity standards, ensuring durable performance for life.
- Special coating features an easy to clean surface.
- Single function shower head with shower arm.
- Lifetime warranty.



**AC-651-BN**   
**AC-651-C** 

**AC-653-BN**   
**AC-653-C** 

**AC-657-BN**   
**AC-657-C** 

**AC-659-BN**   
**AC-659-C** 



Clothes Hook



Pivoting Toilet Tissue Holder



Towel Ring



Towel Bar

# BATHROOM FAUCETS

AVAILABLE FINISHES:



Polished Chrome



Brushed Nickel PVD

## MODEL: A-4520-BN



- Premium material construction for durability and reliability.
- Ceramic disc valves exceed industry longevity standards, ensuring durable performance for life.
- Special coating features an easy to clean surface.
- Features a high-arched spout for more space to work with.
- Single hole installation.
- Lifetime warranty.

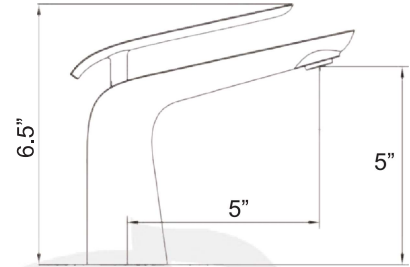

## MODEL: 8737-VBF

## MODEL: 8737-VOF



- Premium material construction for durability and reliability.
- Ceramic disc valves exceed industry longevity standards, ensuring durable performance for life.
- Special coating features an easy to clean surface.
- Features a high-arched spout for more space to work with.
- Single hole installation.
- Lifetime warranty.

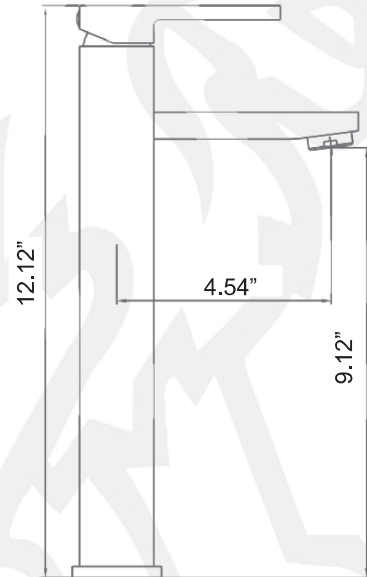

# Cartridges



Strict life test - up to 500000 times.  
Green and environmental protection.

Performance test				
The strength test	Static pressure 500PSI		Torque test	≥ 15Nm
Left and right rotation torque test when static pressure is zero			0.08-0.18Nm	
Sealing test	Static pressure	Air	High pressure	125PSI
			Low pressure	10PSI
	Dynamic pressure	Cold water	High pressure	300PSI
			Low pressure	10PSI
			60PSI	
Life test	500,000 open and close cycles			



# VANITY SINKS

---



White

**MODEL ADA-1218**



White - Biscuit - Black

**MODEL VCS-1218**



White - Biscuit

**MODEL VCS-1216**



White

**MODEL ADA-1417**



White - Biscuit - Black

**MODEL VCS-1417**



White

**MODEL VCS-1115**



White - Biscuit

**MODEL VCS-1316**



White - Biscuit

**MODEL VCS-1215**



White - Biscuit

**MODEL VCS-1114**



White - Biscuit

**MODEL VCS-1013**



**MODEL CVS-1615**



**MODEL CVS-1615BK**



**MODEL CVS-1816**



**MODEL CVS-2318**



**MODEL CVS-2416**



## VANITY SINK



MODEL: **VCS-1115**

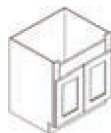
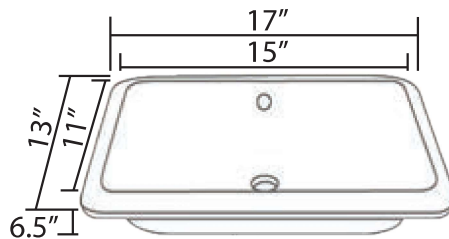

18" Minimum  
Cabinet Size

## RECOMMENDED FAUCETS



MODEL: **A-6550-BN**



MODEL: **A-4520-BN**

# VANITY SINKS



MODEL: **VCS-1216**  
 MODEL: **VCS-1216-B**

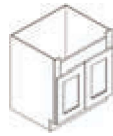
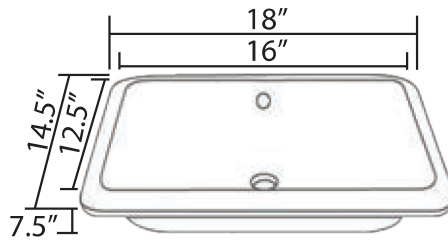

21" Minimum Cabinet Size

## RECOMMENDED FAUCETS



MODEL: **A-6550-BN**



MODEL: **A-4520-BN**

HANDMADE SINKS

KITCHEN SINKS

LUXURY SERIES



MODEL: **VCS-1218**  
 MODEL: **VCS-1218-B**  
 MODEL: **VCS-1218-BLK**

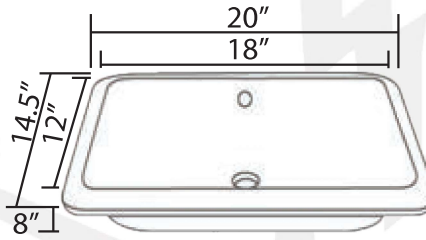

24" Minimum Cabinet Size

## RECOMMENDED FAUCETS



MODEL: **A-6550-BN**



MODEL: **A-4520-BN**

BAR SINKS

TOP MOUNT SINKS



MODEL: **ADA-1218**

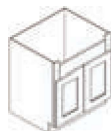
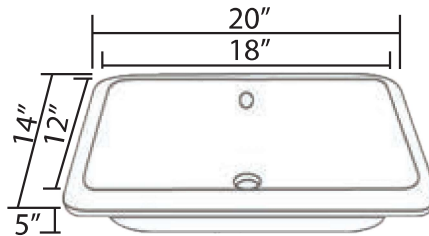

21" Minimum Cabinet Size

## RECOMMENDED FAUCETS



MODEL: **A-6560-BN**



MODEL: **A-6570-BN**

VANITY SINKS

VESSEL SINKS

## VANITY SINK



MODEL: **VCS-1013**  
MODEL: **VCS-1013-B**

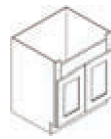
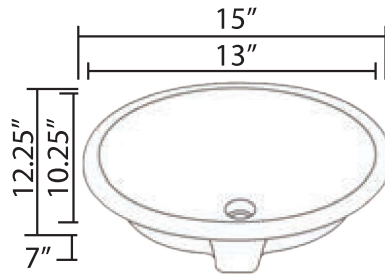

18" Minimum  
Cabinet Size

### RECOMMENDED FAUCETS



MODEL: **A-6560-BN**



MODEL: **A-6570-BN**



MODEL: **VCS-1114**  
MODEL: **VCS-1114-B**

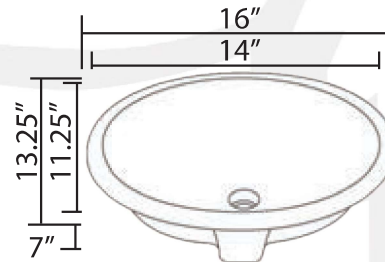

18" Minimum  
Cabinet Size

### RECOMMENDED FAUCETS



MODEL: **A-6550-BN**



MODEL: **A-4520-BN**



MODEL: **VCS-1215**  
MODEL: **VCS-1215-B**

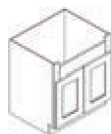
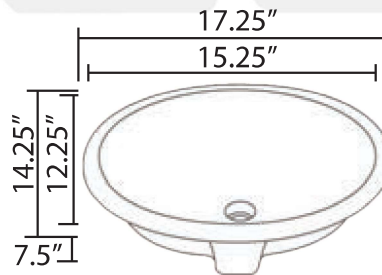

18" Minimum  
Cabinet Size

### RECOMMENDED FAUCETS



MODEL: **A-6560-BN**



MODEL: **A-6570-BN**



# VANITY SINKS

HANDMADE SINKS

KITCHEN SINKS

LUXURY SERIES

BAR SINKS

TOP MOUNT SINKS

VANITY SINKS

VESSEL SINKS



MODEL: **VCS-1316**  
MODEL: **VCS-1316-B**

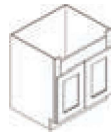
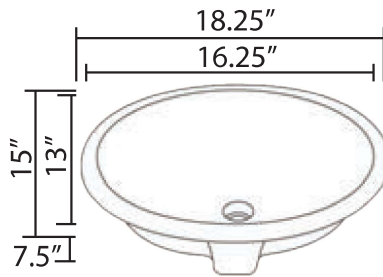

18" Minimum Cabinet Size

## RECOMMENDED FAUCETS



MODEL: **A-6550-BN**



MODEL: **A-4520-BN**



MODEL: **VCS-1417**  
MODEL: **VCS-1417-B**  
MODEL: **VCS-1417-BLK**

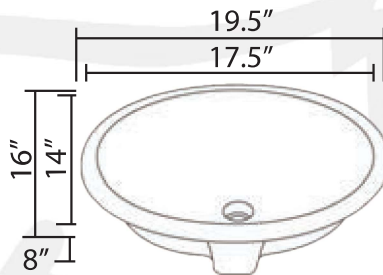

21" Minimum Cabinet Size

## RECOMMENDED FAUCETS



MODEL: **A-6550-BN**



MODEL: **A-4520-BN**



MODEL: **ADA-1417**

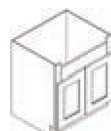
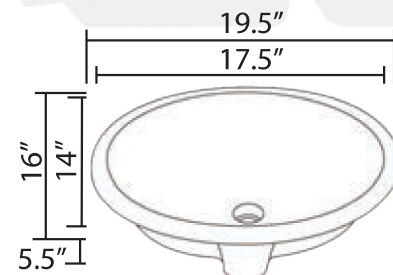

21" Minimum Cabinet Size

## RECOMMENDED FAUCETS



MODEL: **A-6560-BN**



MODEL: **A-6570-BN**

# VESSEL SINKS

MODEL: **CVS-1615**



Glossy  
Natural  
Granite  
Radius 16" x 5.5"

MODEL: **CVS-1615BLK**



Glossy  
Natural  
Granite  
Radius 16" x 5.5"

MODEL: **CVS-1816**



Glossy  
Ceramic  
Radius 18" x 16"  
Can also be wall mounted

MODEL: **CVS-2318**



Glossy  
Ceramic  
Radius 23" x 18"  
Can also be wall mounted

MODEL: **VCS-2416**



Glossy  
Ceramic  
Radius 24" x 16"

# CARE & MAINTENANCE



## 3 SIMPLE STEPS IN CARING FOR YOUR SINK

Clean regularly with a mild detergent solution and/or clean water applied with a soft cloth or sponge. Rinse and towel dry everyday after use to prevent mineral deposits from building up on the surface of the sink. Deep clean once a week, with an approved cleanser (be sure to rub in the direction of the finish lines) and a soft cloth or sponge, rather than an occasional aggressive single cleaning. Cleansers should be state approved or suitable for stainless steel.

## SCRATCHES

As with various metallic surfaces, your stainless sink will get scratches. These are simply usage scratches and over time will blend in the overall finish of your sink. However, there are steps that can be taken to reduce the appearance of scratches. To reduce the appearance of usage scratches, use a nylon pad with an iron-free abrasive polishing compound. Follow the direction of the original polish lines to blend out scratches in small areas. Please be cautious while performing this process. Being overly aggressive in the scratch removal process can result in a bright stain on the surface.

## WATER QUALITY

Regular routine cleaning usually prevents lime scale deposits from hard water. Be sure not to allow excessive build-up before treating. Soaking in a 25% vinegar solution can be helpful in treating hard water spots. Periodically rub the sink with a synthetic scouring pad. Then rinse and towel dry.

## RUST MARKS

If you develop rust marks due to the presence of, or contact with ferrous (iron coating) materials, swab with a sponge wet with dilute solution of (10-15%) nitric acid (HN03) and follow with routine cleaning. Avoid prolonged contact of ferrous (ie. Cast iron pans) materials with stainless steel.

## SOME DON'T

Do not use coarse abrasive powders, metallic scourers, (steel or wool), and brushed with metallic bristles.  
Do not use silver cleaner.  
Do not leave wet sponges, cloths, cleaning pads, rubber mats, or dishpans in the sink.  
Do not leave standing solutions of chlorine, bleach, or water in the sink for extended periods of time.  
Routinely rinse the sink after using the solutions mentioned above.  
Do not allow liquid soap or other cleansers to dry on the surface of the sink.

## SATISFACTION GUARANTEE

All of Allora USA products are accompanied by 100% money back guarantee. We are so absolutely, positively, 100% sure that you will be happy with your new sink and/or faucet, our company will refund 100% of the purchase price of the sink and/or faucet if you are dissatisfied for any reason. Just return it to us within 15 days of the sale and the money will be processed back to your credit card\*.

Our product is TOP OF THE LINE - first line products, never any seconds!

\*Returns received after 15 days from the date of the sale are subject to a 20% restocking fee. Returns received 30-60 days from the date of sale are subject to a 30% restocking fee. Please allow up to 30 days for refunds to be processed.

## LIFETIME WARRANTY

Our products are also backed by a limited lifetime warranty. Allora USA will replace without charge, (excluding labor) any product supplied by Allora USA that is proven to be defective, with an equivalent replacement during the life of the product, to the original owner, and installed correctly, used and cleaned as recommended, and not damaged due to abuse, misuse, or negligence. This warranty will not cover any damages which might be caused by the product.

Allora USA reserves the right to inspect and sink and/or faucet reported to be defective prior to replacement of the sink and/or faucet. All decisions are final. Replacement cost EXCLUDES transportation and any labor costs for the removal or reinstallation.

## ALLORA USE SHALL NOT BE LIABLE IN THE CASE OF:

- \* Damages resulting from abuse, such as heavy impact or dropped objects
- \* Improper care of maintenance
- \* Improper application (exposure to corrosive chemicals, photographic solutions, etc.)
- \* Improper installation/modification
- \* Commercial application.

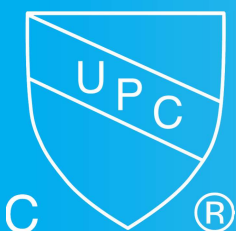

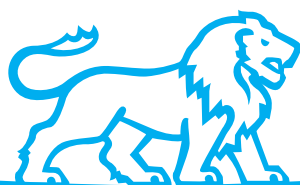

**ALLORAUSA**