

TYPE: TE001-Upgrade

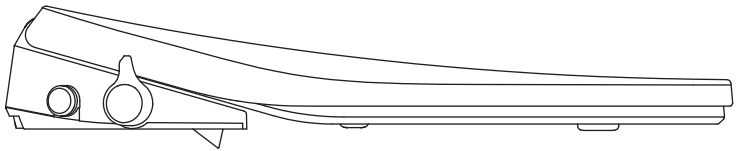

E-bidet
USER MANUAL

Contents

| | | |
|---------------------------------------|----|-----------------------------|
| Safety notes | 1 | Before use |
| Use precautions | 4 | |
| Component description | 5 | |
| Installation steps | 6 | Installation and use |
| Product description | 8 | |
| Function introduction | 9 | |
| Cleaning and maintenance | 13 | Other matters |
| Faults and solutions | 15 | |
| Product dimension drawing | 17 | |
| Product technical specification | 18 | |
| Warranty Card | 19 | |

Safety notes

Read the safety instructions carefully before use so as to properly use the product.
Note the following warnings relevant to the safety.



Warning



Prohibition



Compulsory observance



Note

Failure to operate pursuant to the above-mentioned warning signs may result in injury or life-threatening risk.

People (including children) who are deficient in body, perception, intellectual capacity, or experience and common sense (including children) are cognized. Limited ability and/or lack of knowledge necessary to use the device without supervision. In addition to, they were given custody or guidance on the use of the product by those responsible for their safety. Without the The child of the tube shall not use the equipment alone, and ensure that children cannot play with instruments.



Avoid water splashing on the product.

- May result in fire or electric shock.

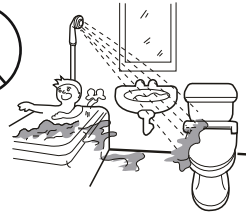

Grounding

Check if the 3-pole grounding structure is grounded.

- 3-pole grounding structure must be grounded, or otherwise the product failure or electricity leakage will occur.



Compulsory observance

The power cord of this product is Y-type connection. if the power cord is damaged, it must be replaced by the manufacturer or technicians to avoid dangers



Safety notes

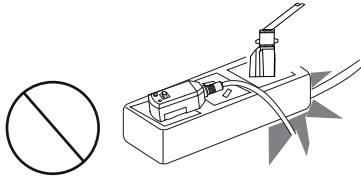

Only suitable for the power in technical specification; It is strictly prohibited to use excessive loads on the same socket.

- May result in overheating or fire.

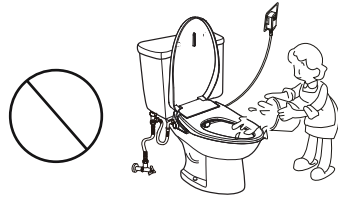

Ensure that the water, cleaning agent or urine does not wet the power plug.

- May result in fire or electric shock.

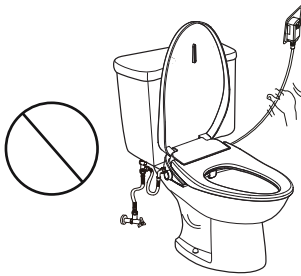

Do not pull the power plug/ power cord at will.

- May result in fire or electric shock.

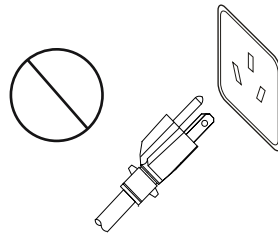

Do not use a loose socket.

- May result in fire or electric shock.

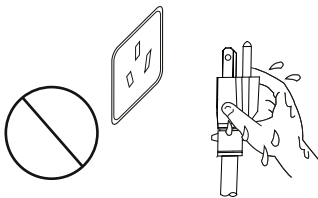

Do not plug/ pull the power plug when the hand is wet.

- May result in electric shock.

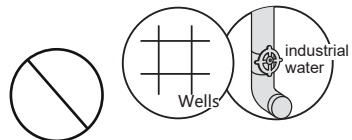

Do not connect to the substandard water pipe.

- May result in skin infections or product damage.

Safety notes

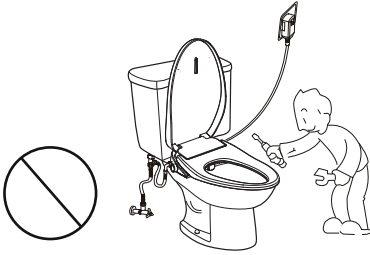

Do not disassemble, repair and modify products by without authorization.

- May result in fire or electric shock.

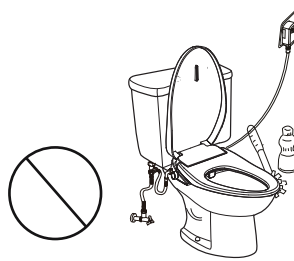

Please unplug the power supply when cleaning the product.

- May result in electric shock.



Please don't keep the lighted cigarette or other combustion items near the product

- May result in fire.

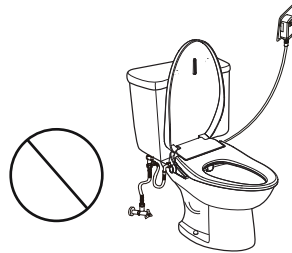

Do not bend or twist the water supply hose.

- May result in water leakage.

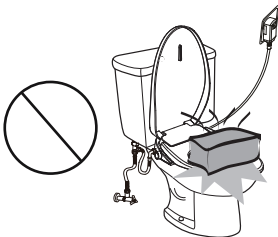

Do not place heavy objects on the toilet seat or the toilet cover

- May result product damage.

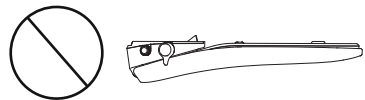

Do not invert product.

- May result in product damage.



Please clean with the diluted kitchen cleaning agent and do not use the following items:
Benzene, paint thinner, detergent powder, nylon brush, etc.

- May result in product damage.

Use precautions



Do not place this product in direct sunlight.

- It may cause product discoloration and failure of seat heating function.



The room temperature of toilet shall be above 0°C.

- Otherwise, it is possible to freeze the product. Use warm air and other methods to improve the temperature in the toilet.



Do not shower urine on the bidet body and nozzle.

- May result in blockage.

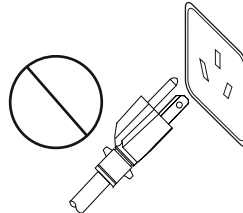

Please not use substandard power supply.

- May cause product failure.

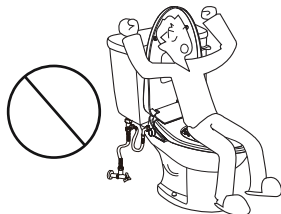

Do not lean against the toilet lid when in use

- May cause damage to the toilet lid.

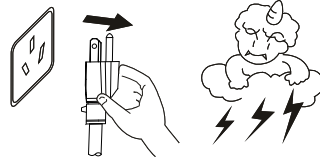

Pull off the power plug when lightning strikes.

- May result in product failure or damage.



When not in use for a long time, drain the stored water and pull the plug.

- Otherwise, water pollution and skin infections may be caused.

Component description

1. Cover plate

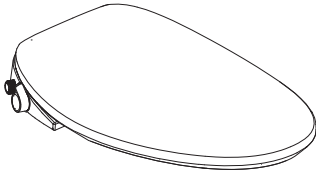

2. Installation template

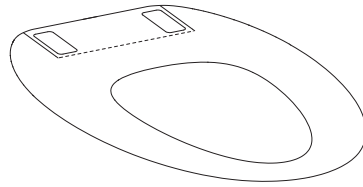

3. Fixation part



bolt (2)



sheet (2)



Plastic TAB(2)

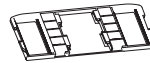

Fixing plate

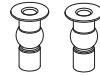

Rubber bushing(2)

4. T-junction

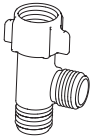

the picture is for indication

5. Water inlet hose



Filter screen

6. User manual

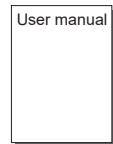

Installation steps

• Installation tools



Cross screwdriver

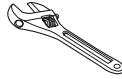

Monkey wrench



Barrel and rag

• Attention before installation

1. Water pressure range: 0.1-0.75MPa, please follow the instructions.
2. Corner valves shall be located close to the location where this product is installed and disassembled.
3. Please use the braided hose that comes with the product to prevent water leakage.
4. When installing braided hose, be careful to prevent the black gasket falling out.

• Installation Procedure

1. Loosen the nut connecting and remove the old cover.

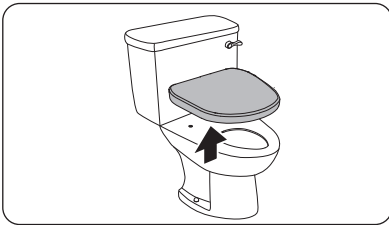

2. Place the mounting template on the ceramic as shown. Align it with the rim of toilet.

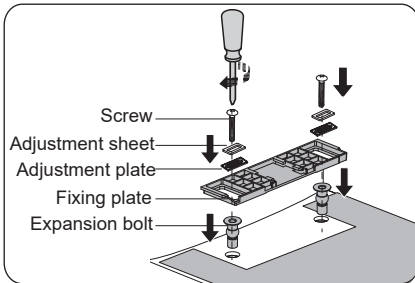
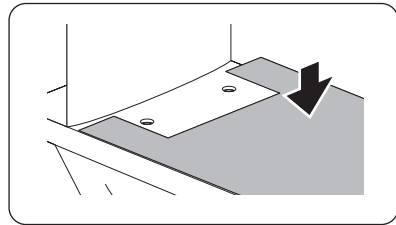

3. ① Insert the expansion bolt into ceramic hole;
② Place fixing plate in notch part of template;
③ Place adjusting sheet and plate in fixing plate;
④ Align expansion bolt hole, and tighten up;

4. To ensure the normal use of the product, please press reset key before installation;

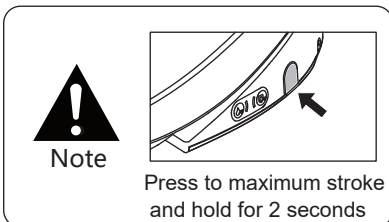

5. Slightly push the cover into fixing plate until you heard "click", indicating that the cover has been installed in place.

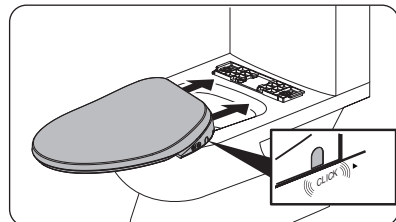

Installation steps

6. Close the water valve;

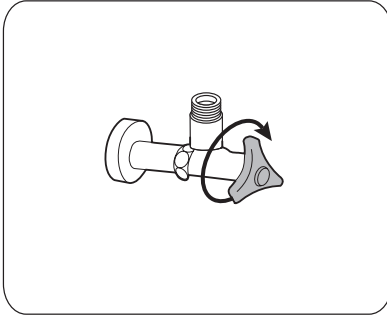

7. Install braided hose;

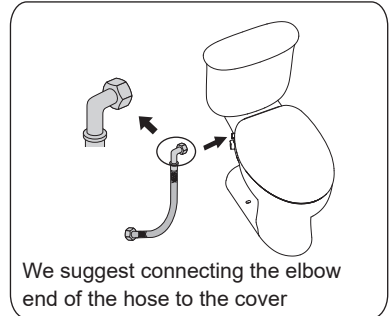

8. Installation tee;

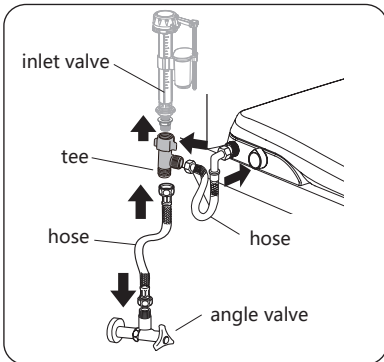

9. Open the angle valve to check water leakage;

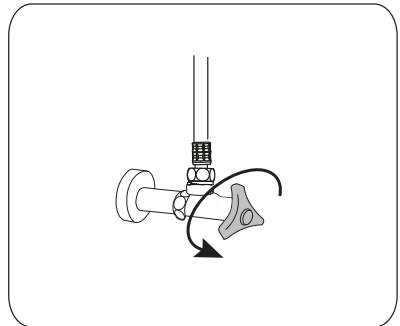

10. Turn on the knob to check whether the nozzle is protruding;

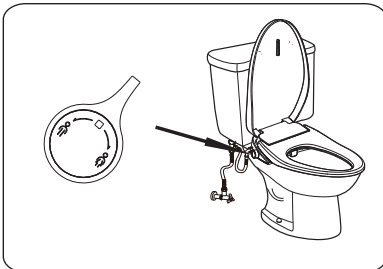

11. Plugged into a power supply;



Note

In order to protect the internal circuit, be sure to turn on the knob to make the nozzle out before plugged into power



Prohibition

1. It is strictly prohibited to move the product from the toilet cover, otherwise easy to cause mechanical failure.
2. It is strictly prohibited to connect hot water above 40 °C and cold water that may lead to icing.

Product description

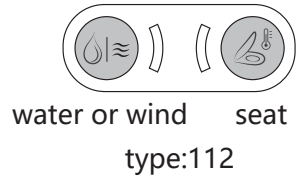
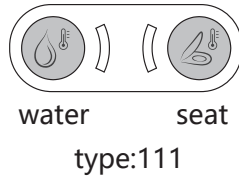
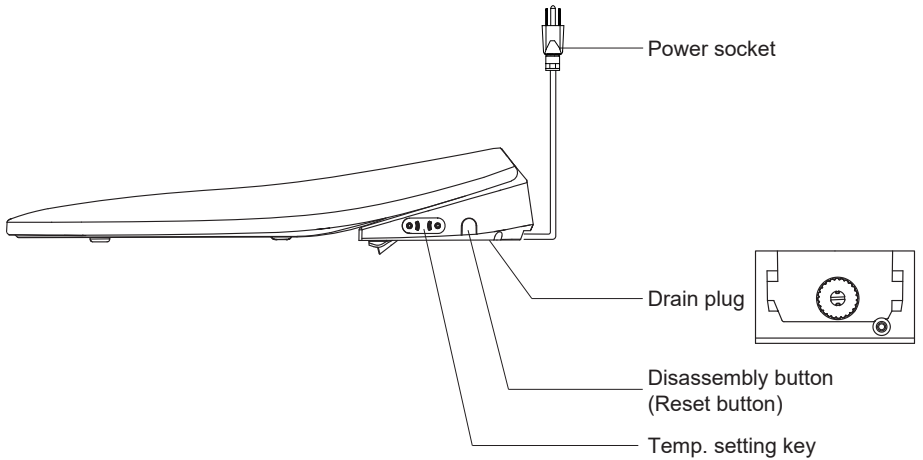
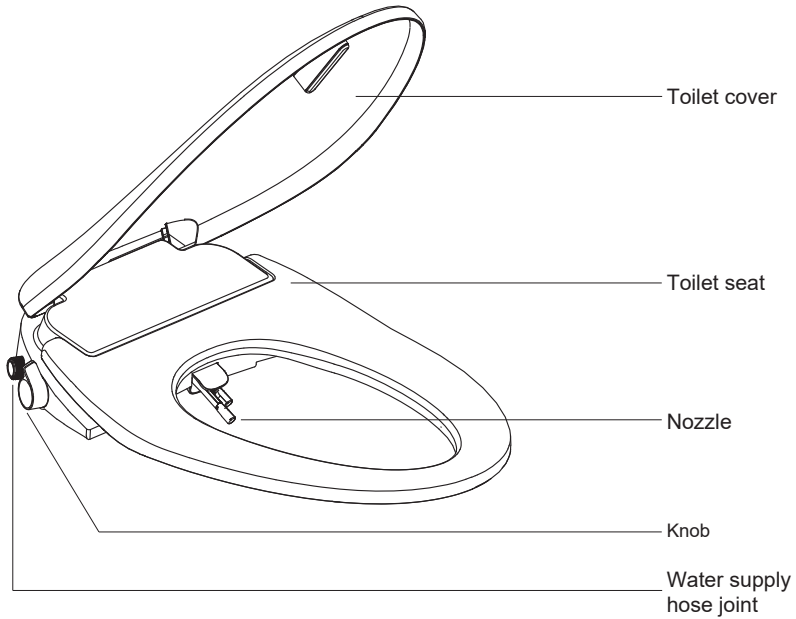

Function introduction-Type 111

• Standby mode

1. After the power supply is connected, the “bi” indicates that the cover can be used normally.
2. Water temperature by default at low gear: about 35°C.
3. Seat temperature by default at low gear: about 33°C.

• Rinsing function

1. Bidet/Hip Rinsing

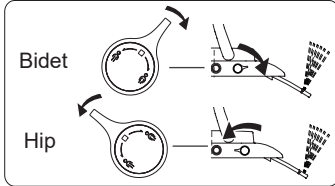

After sitting down, there is a beep prompt, rotating the knob to start rinsing

2. Self-cleaning

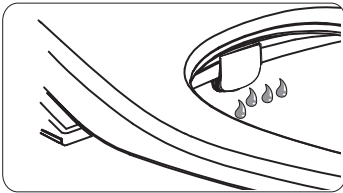

After sitting down, rotating the knob, spray rod self-cleaning, for cleaning nozzle

Attention: close the knob after cleaning!

• Key function

Breath lamp flashes when cleaning

Breathing lamp

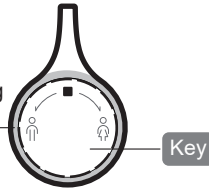

1. Lighting Settings

press  1.5s, you can set the light cycle, and there will be sound prompt when switching

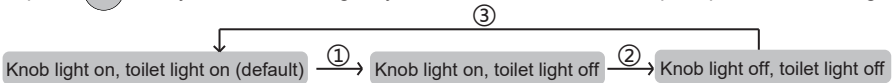

2. Cleaning setting

When cleaning, press  to set the cleaning mode in a cycle

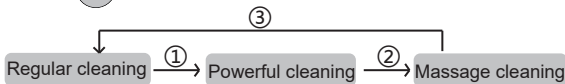

Note The specific functions shall be subject to the actual products

Function introduction-Type 111

• Description of function

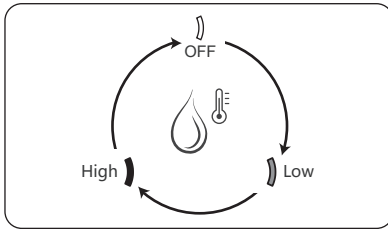
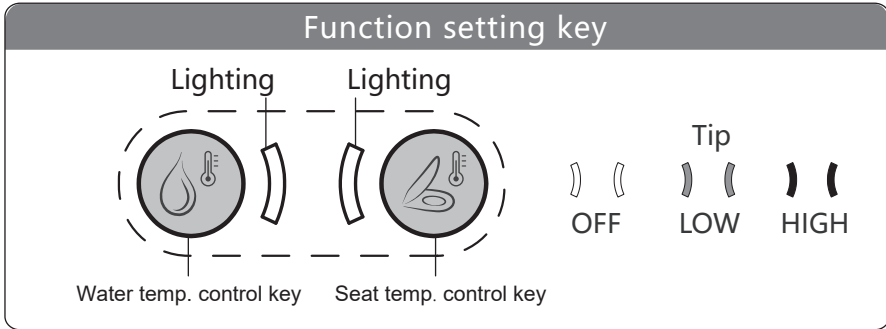

- Repeatedly press will switch over water temperature in the sequence indicated in the left figure.
- Change water temp.: a short sound.
Turn off water temp.: a long sound.
- low: about 35°C.
high: about 38°C.

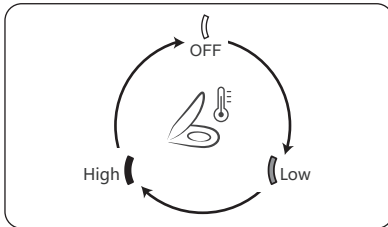

- Repeatedly press will switch over water temperature in the sequence indicated in the left figure.
- Change seat temp.: a short sound.
Turn off seat temp.: a long sound.
- low : about 33°C.
high : about 37°C.

• Protection functions:

1. Anti-splash function:

when the knob is not completely closed, it will alarm and automatically switch to self-cleaning.

2. Water temperature protection function

(1) When the water temperature exceeds 43°C, it will automatically switch to self-cleaning.

(2) At this time, it must be reconnected to the power supply to reset product.

3. Low temperature scalding protection function:

After seated by 5min, the seat temp. will automatically switch to Low temp. scalding protection

• Use during power failure

The water temperature and seat temperature cannot be adjusted when the power supply is cut off, but the rinsing with normal temperature can be used.

Function introduction-Type 112

• Standby mode

1. After the power supply is connected, the “bi” indicates that the cover can be used normally.
2. Water temperature by default at low gear: about 35°C.
3. Seat temperature by default at low gear: about 33°C.

• Rinsing function

1. Bidet/Hip Rinsing

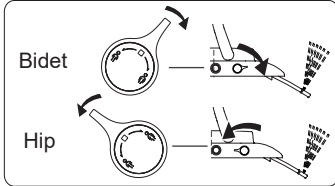

After sitting down, there is a beep prompt, rotating the knob to start rinsing

2. Self-cleaning

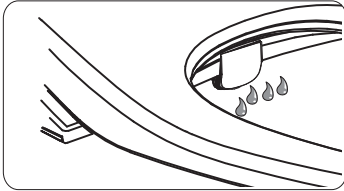

After sitting down, rotating the knob, spray rod self-cleaning, for cleaning nozzle

Attention: close the knob after cleaning!

• Key function

Breath lamp flashes when cleaning

Breathing lamp

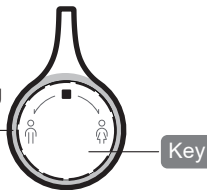

1、Lighting Settings

press  1.5s, you can set the light cycle, and there will be sound prompt when switching

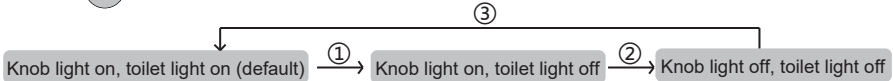

2、Cleaning setting

When cleaning, press  to set the cleaning mode in a cycle

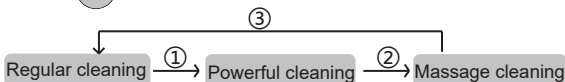

3、Warm air setting

① After rinsing, press  to open the function of warm air

② Turn off warm air: A. It will automatically close after 4 minutes.

B. It can be automatically closed when you get up.

C. Press  again to close;



The specific functions shall be subject to the actual products

Note

Function introduction-Type 112

• Description of function

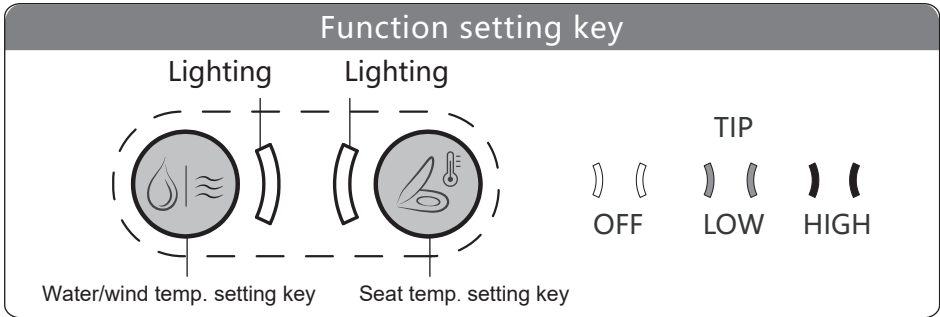

- Repeatedly press will switch over water temp. in the sequence indicated in the left figure.
- Change water temp. : a short sound.
Turn off water temp. : a long sound.
- low : about 35°C.
high : about 38°C.

- Repeatedly press will switch over wind temp. in the sequence indicated in the left figure.
- Change wind temp. : a short sound.
Turn off wind temp. : a long sound.
- low : about 33°C mid : about 38°C high: about 43°C.
(The specific temperature is slightly different depending on the ambient temperature)

- Repeatedly press will switch over seat temp. in the sequence indicated in the left figure.
- Change seat temp.: a short sound.
Turn off seat temp.: a long sound.
- low: about 33°C
high: about 37°C.

• Protection functions:

1. Anti-splash function:

when the knob is not completely closed, it will alarm and automatically switch to self-cleaning.

2. Water temperature protection function

(1) When the water temperature exceeds 43°C, it will automatically switch to self-cleaning.

(2) At this time, it must be reconnected to the power supply to reset product.

3. Low temperature scalding protection function:

After seated by 5min, the seat temp. will automatically switch to Low temp. scalding protection

• Use during power failure

The water temperature and seat temperature cannot be adjusted when the power supply is cut off, but the rinsing with normal temperature can be used.

Cleaning and maintenance

• Manual cleaning of spray tube

- Gently pull out the nozzle and dip the neutral detergent with a soft cloth, sponge or small brush.
- Gently support the nozzle, wipe the spray tube and nozzle.

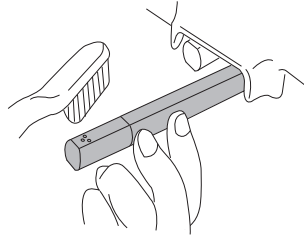

• Clean filter screen

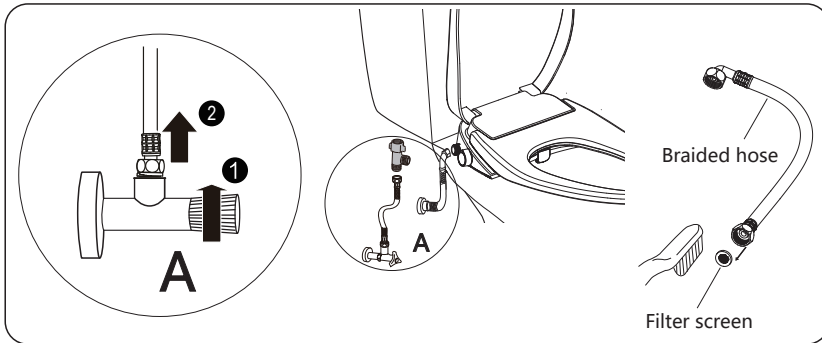

i Tips:

- Make sure that the corner valve close and the power off before you clean the filter screen ;
- Clean the filter screen when the water flow is less than normal hours.
- During cleaning process, the product must be thoroughly separated from the water inlet hose;
- Reinstall the filter screen in reverse order after cleaning.

• Product surface cleaning

⚠ Note: Please cut off power supply before cleaning.

- Wipe the product surface with a sponge or soft cloth dampened with room temperature water or a neutral detergent.
- Lift the upper cover and the seat ring when cleaning other parts with cleaning agents.
- Do not put cover on before the cleaning agent in the ceramic toilet is completely washed, otherwise the surface may be corroded by the evaporation of cleaning agent.

Cleaning and maintenance

• Product maintenance in winter

when the temperature of toilet below 0°C :

- Pull out the power plug .
- Remove water inlet hose from the angle valve to the toilet end, and empty the water in the water inlet hose;
- Remove the bottom nut, and drain internal water.

• Not use in a long time

When this product is not used for a long time, drain the water in the product and cut off the power supply:

- Pull out the power plug .
- Close angle valve and stop the water inlet.
- Remove water inlet hose from the angle valve to the toilet end, and empty the water in the water inlet hose.
- Close the upper cover, press and hold the removal button by hand, move the electronic seat cover from the front, and then complete the removal.
- Place the cover in a cool and dry place when not in use for a long time.

Faults and solutions

• Common fault diagnosis

When you think it is a fault, try some of the following processing methods. If the product is still not working properly, contact your local repair center or call the service hotline.

| | |
|--|---|
| Check power supply 1.If power supply is under normal state. 2.If leakage protector trips 3.Manual reset thermostat(Installation step4) | Check water supply 1.If water supply is under normal state. 2.If corner valve is closed. |
|--|---|

⚠ Note: When water leakage occurs, close the angle valve and cut off the power supply.

• Water leakage analysis

| Phenomenon | Possible cause | Solution |
|---|-------------------------|---|
| When person leaves the seat, the product alarm and water outlet continues to leak | Knob is not close | Close the knob |
| | Control valve is failed | Cut off the power supply, close the angle valve and contact the after-sales department for replacement. |

• Analysis of rising failure

| Phenomenon | Possible cause | Solution |
|--|---|---|
| There is no water when the knob is turned on | The inlet hose folds, causing blockage | Close the Angle valve and reinstall the inlet hose |
| After turning on the knob, the spray rod does not extend, but continues to flow | Self-cleaning nozzle before rising | Wait a few seconds |
| | Didn't seat on interaction area | It is necessary to sit on the interaction area of the seat (there is a drip sound prompt), and then turn on the knob again |
| | Abnormal water temperature, product over-temperature protection | Pull out the power plug to reset and reconnect the power after 5 seconds, |
| | Abnormal temperature sensor. Water vapor enters the product during use or cleaning in an environment without dry/wet separation, resulting in temporary short circuit | Please leave the product in a dry environment for 1-2 days, and reconnect the electricity to restore normal use. If the fault is still there, please contact the after-sales service for maintenance or replacement. |
| After turning on the knob, spray rod does not extend, a lot of water into the toilet | Abnormal pressure, product switch to pressure relief mode | Please close the Angle valve, remove the hose, check whether there is any foreign matter in the filter screen at the inlet of the product, reinstall the hose, open the Angle valve, and then open the knob to the maximum. |
| Normal water pressure, little cleaning water, cleaning force is weak | There are impurities in the water, use for a period of time, the filter screen blocked | Please clean the filter screen of the hose and the filter screen of the product inlet according to the maintenance instructions |
| Spray rod can be normally extended to rising but no warm water | The product is not connected to power supply | Plug the product into the power socket and check whether the indicator light of the leaky plug is on |
| | The water temperature function is turned off | Turn on the water temperature function by pressing the key |
| | The product over-temperature protector is disconnected, so reset operation is needed | Press the product disassembly button to the deepest place and hold it for two seconds (installation step 4) |

Product dimension drawing



• Failure analysis of seat

| Phenomenon | Possible cause | Solution |
|-----------------------------------|---|---|
| The seat is cold | The seat heating is turned off | Turn on the heating function in advance |
| Temperature drops When rinsing | The product started the low temperature scald prevention function | After cleaning, the setting temperature will rise again |

• Failure analysis of light

| Phenomenon | Possible cause | Solution |
|------------------------|--------------------------------------|---|
| Night light is not ON. | Night light is turned off or damaged | Reconnect to the power supply, if the fault still exists contact the after-sales department for replacement |
| Knob light is not ON | Knob light is turned off or damaged | |

• Failure analysis of warm wind(type:112)

| Phenomenon | Possible cause | Solution |
|--|-----------------------------------|---|
| Press  without response | Didn't seat on interaction area | Open the function of warm air after sitting |
| | Can't use warm air during rinsing | Press  after you stop cleaning |
| | Fan fault | Unplug the power and close the valve, please contact the after-sales service for maintenance or replacement. |
| no warm wind | Over temperature protection | Unplug the power plug, 5 minutes apart, reconnect to the power supply, if the failure is still the same, please unplug the power supply, close the Angle valve, contact the after-sales service |

Product dimension drawing

- Product dimension drawing

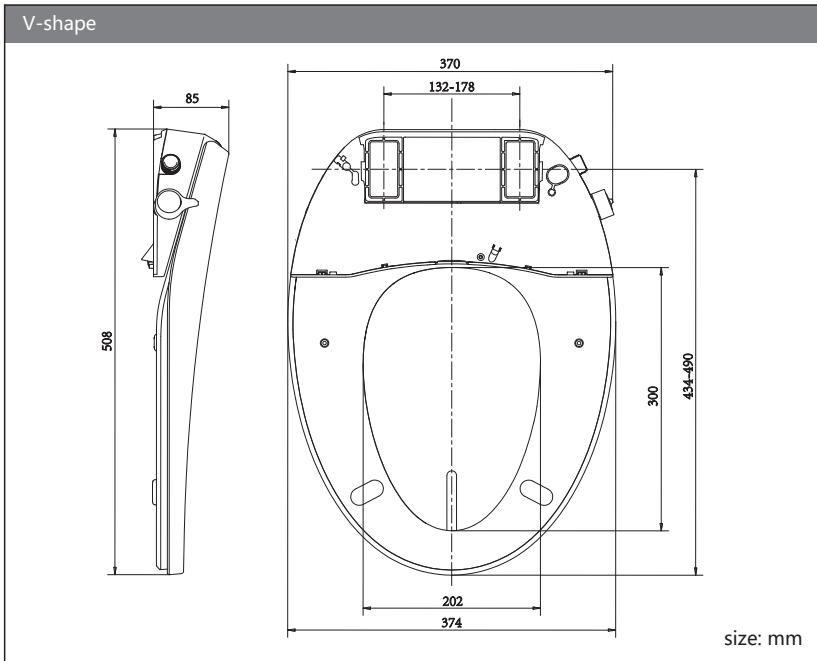

Product technical specification

| Items | | Description |
|--------------------------|-------------------------------------|--|
| Rated voltage | | 120V~, 60Hz |
| Rated power | | 1050W |
| Max. transient power | | 1450W |
| Length of power line | | About 1.1m |
| Water supply pressure | | 0.1 ~ 0.75MPa(Static pressure) |
| Water supply temperature | | 5 ~ 35°C |
| Ambient temperature | | 0 ~ 40°C |
| Net weight | | About 3.2kg |
| Water proof grade | | IPX4 |
| Cleaning device | Water amount regulation | Stepless regulation |
| | Water temperature regulation | Gear 3: about 35/38 C/OFF |
| | Heating method | Instant heating |
| | Protective device | Anti-siphon valve & anti-backflow valve |
| | Safety device | Double thermostat |
| Warm seat | Surface temperature | Gear 3: about 33/37 C/OFF |
| | Heater power | 50W |
| | Safety device | thermostat & fuse |
| Warm wind (Type 112) | wind temperature | Gear 3: about 33-43 C (The specific temp. is slightly different depending on the ambient temp.) |
| | Heating wire power | 180W |
| | Safety device | Thermostat + fuse |
| Others | Massage rinse | YES |
| | Antibacterial material | Nozzle and seat |
| | Low temperature scalding protection | YES |
| | Abnormality prompt | Alarm sound |
| | Control operation | Knob |
| | Auxiliary key | Water temp./Seat temp./Water temp. (Type 112) |
| | Seat sense | YES |
| | Light control | YES |

Rated power:

Under the ambient temp. of 20±5°C and the inlet water temp. of 15±1°C, the product starts to power up and start up, and the water temp. and setting temp. are adjusted to top grade. Turn on the hip wash function for testing (the reference flow rate is about 600ml/min). The measured product works continuously and stably. Average power of cleaning cycle (3 minutes)

Warranty Card

To dear customers:

Thank you for choosing our E-bidet! If any problem occurs during use, please simply remove and check the problems pursuant to the user's manual. When you cannot remove such problems, contact your local supplier or call the service hotline.

I. Information:

| | | | |
|----------------------|---------------|-----------------------|--|
| Customer information | Customer name | | |
| | Address | | |
| | TEL | | |
| Dealer information | Name | | |
| | TEL | | |
| Model | | Product series number | |
| Purchase date | Y | M | D |
| | | Warranty period | Two-year free warranty since the purchase date |

II. Notes to warranty card:

1. Please complete the warranty card.
2. Warranty cards and invoices are important for the warranty service.
If the product failure occurs during warranty period, please show the warranty card and the invoice when the dealer or after-sales service personnel of the Company provide on-site maintenance and repair.
3. The warranty card cannot be reissued, please keep it properly.

III. Rules on free maintenance

During the warranty period, the Company will provide repair free of charge according to the use instructions, precautions for normal use.

IV. Paid maintenance is required in the following circumstances that do not fall within the scope of free maintenance:

1. Out of warranty.
2. The valid invoice and warranty card cannot be provided during the warranty period.
3. Failure or damage caused by transportation, collision after purchase.
4. Product damage during abnormal use, failure and damage during the warranty period caused by human factors or natural disasters, such as fire, earthquake, flood, lightning or environmental pollution, etc.
5. Failure or damage caused by unauthorized disassembly, modification or maintenance due to user's cause or responsibility.
6. Failure or damage caused by violation of maintenance regulations in use, such as improper use of cleaning agent or wiping and maintenance methods not compliant with maintenance requirements.
7. The consumable items (such as sealing rings, etc.) or products have failed or damaged due to sand and impurities.
8. Conduct the secondary transfer according to the customer's requirements.



