

# TOTO

## Installation Guide

### SS234

To Contractors : After completing installation, be sure to hand this book to the customer.  
Explain about the warranty registration as well as the product use and care.

## Included parts

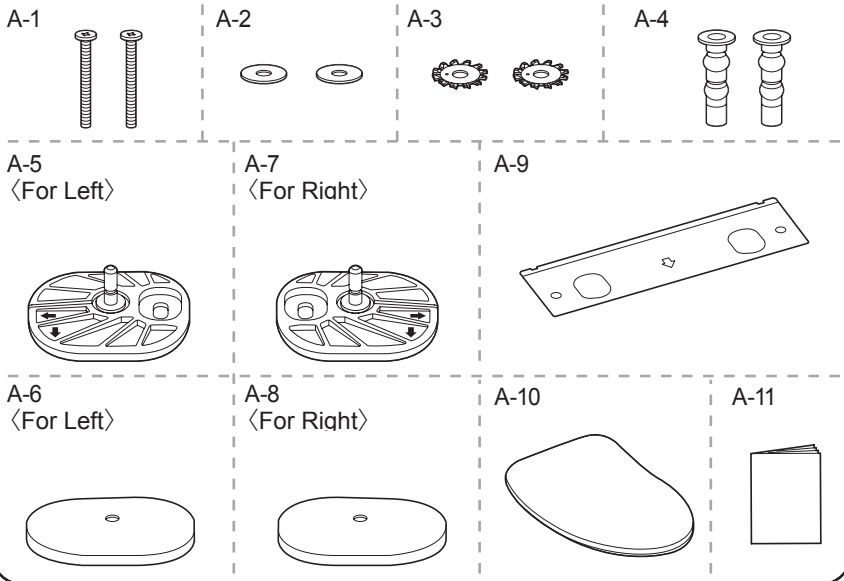

## Required items

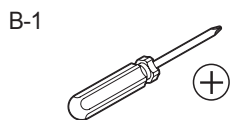

## Symbols and their meanings

Tasks that must be conducted by the installer.



Work flow direction.



Visual confirmation required.



## Installation procedure

1

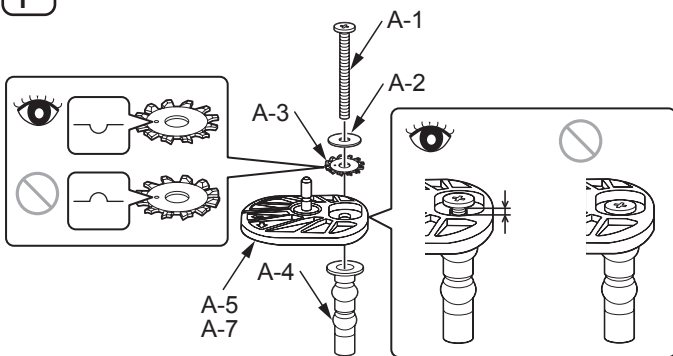

2

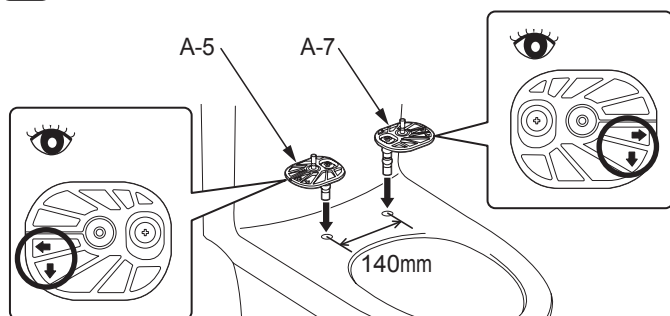

3

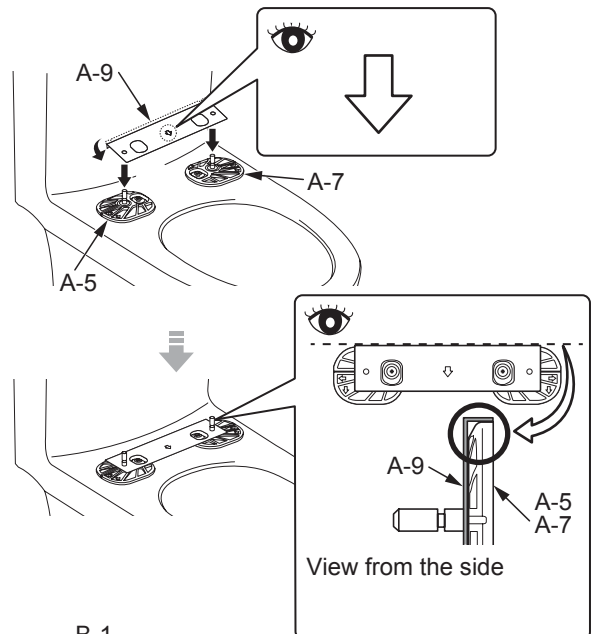

4

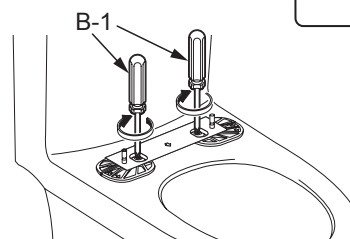

# Installation procedure

5

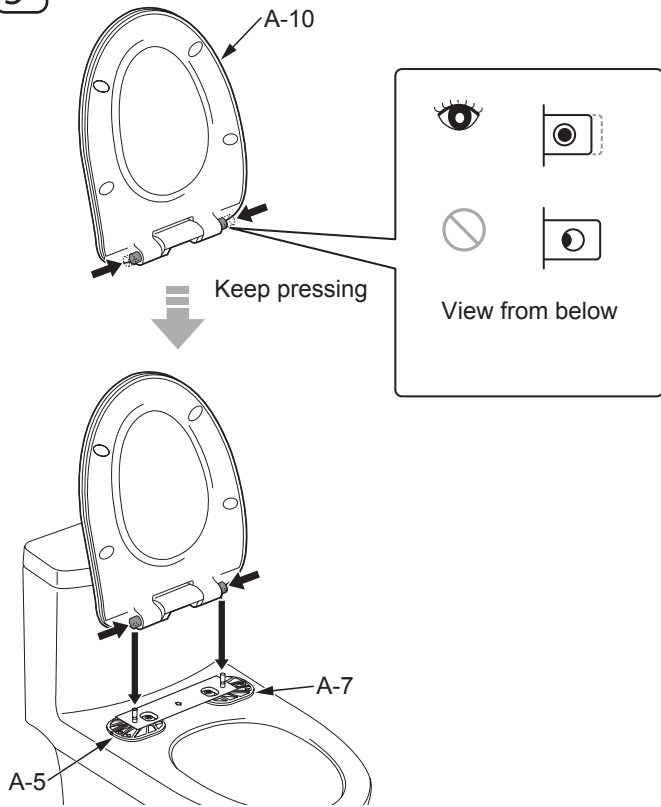

6

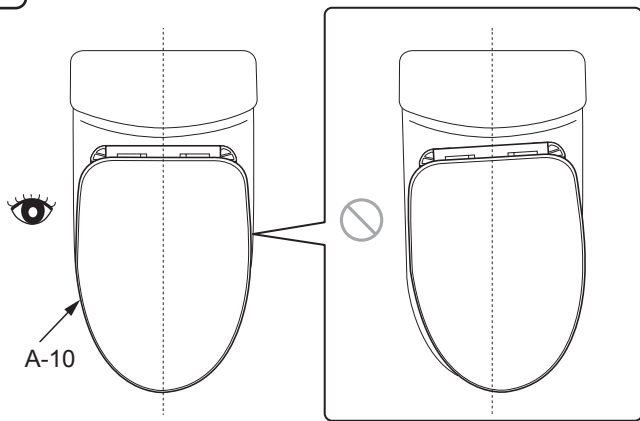

7

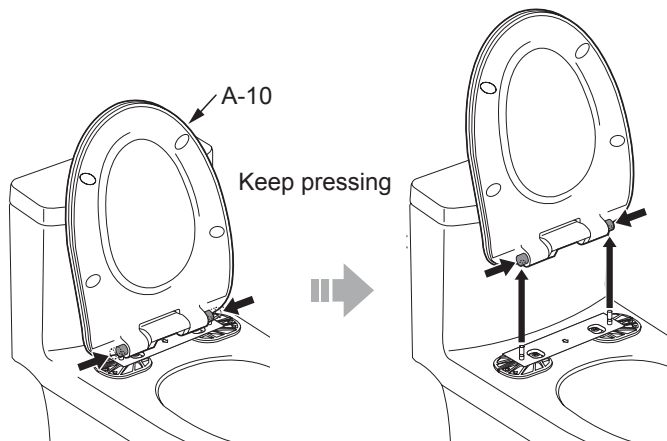

8

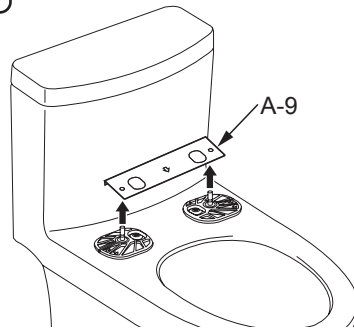

9

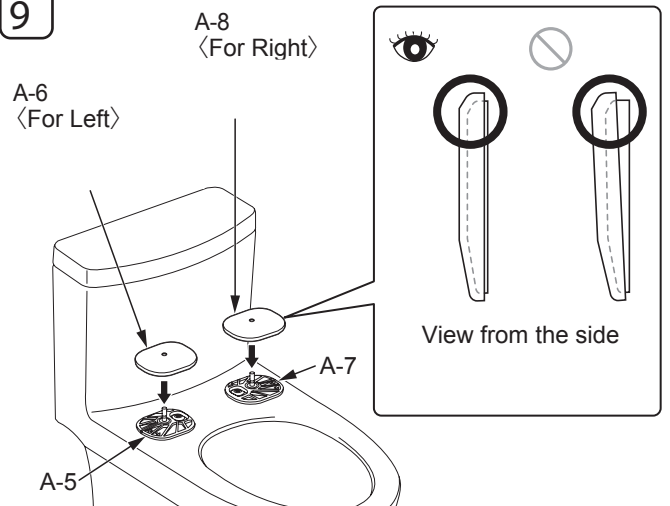

10

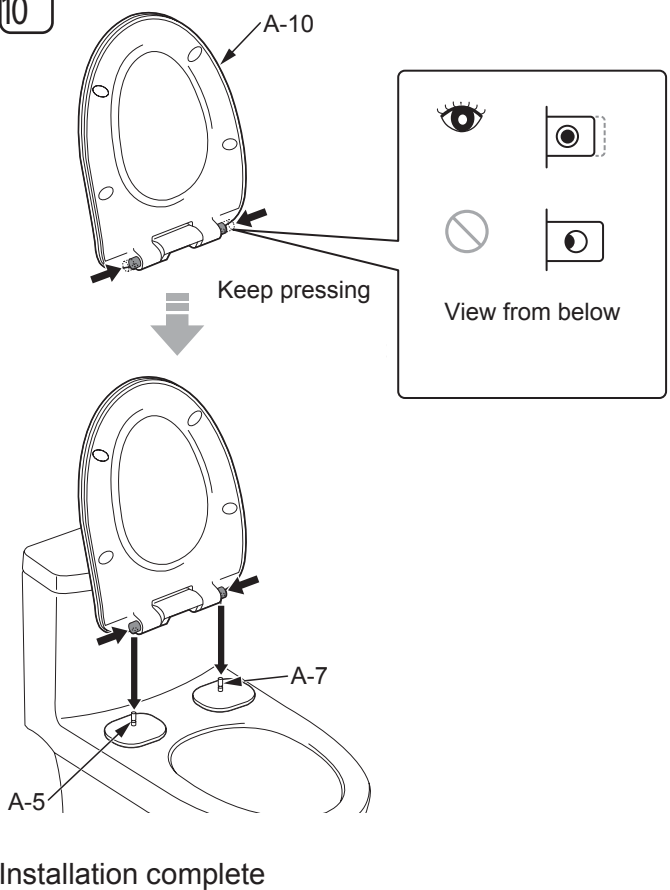









## For your safety, read these instructions

To ensure your TOTO seat installation is completed correctly, please carefully read the instructions in this manual.

Use the following safety precautions for your personal safety and to protect your seat or toilet from potential damage.

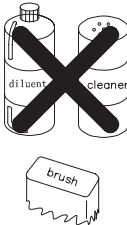
 **Caution** May result in injury or property damage.

The  symbol indicates prohibited actions that must be avoided.

 <b>Caution</b>	 <p>Do not stand on the toilet seat or put heavy items on it. This may scratch or break the seat.</p>	
	 <p>Do not use bleach, chemical thinners, cleaners with acids or alkaline detergents, metal scrub brushes, steel wool, polishing powders, or detergents with gritty or coarse particles to clean the seat. This will scratch, damage, or discolor the seat. For most cleaning, only use a soft wet cloth.</p>	
	 <p>Do not allow children to play with the seat. A falling seat could hurt their hands.</p>	
	 <p>Do not allow children to use the seat unattended.</p>	

## Repair Instructions

1. If the seat does not fit the toilet properly, check the screws for looseness. To correct, follow the instructions in the installation manual to tighten them. If this does not fix the problem, please contact customer service for assistance.
2. Please contact customer service if the seat or components are damaged or defective.

## Notice



Do not open or close the seat with excessive force, or the seat or toilet may break.

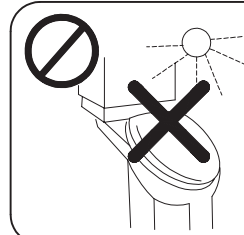

Do not expose the seat to direct sunlight, or it may become discolored.

- Open the seat and lid completely, otherwise when you let go, it could fall suddenly and hurt you.
- Please read the sheath instruction manual when putting the sheath on the seat. Note that sheaths purchased by other manufacturers may not fit the seat.
- If disposing of the product, do not throw away with your regular trash. Follow your local laws and regulations to responsibly recycle the product.

## How to remove/install the toilet seat and toilet lid

### Remove toilet seat and toilet lid

Open the toilet seat and toilet lid

(A-1) (A-2) : Hold down the buttons at both ends

B : Lift the toilet seat and toilet lid up

### Attach toilet seat and toilet lid

(A-1) (A-2) : Hold down the buttons at both ends

C : Attach the toilet seat and toilet lid to the pin of the mounting plate

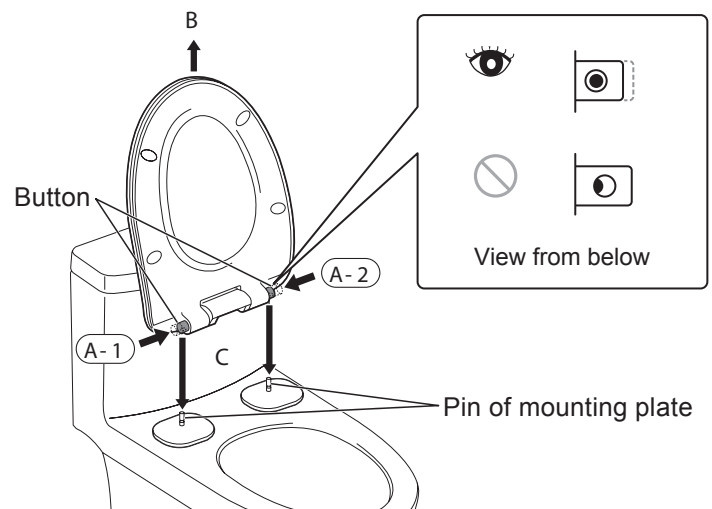

## Maintenance

### 1. Periodic Cleaning

Wipe gently with a soft wet cloth.

### 2. Deep Cleaning

- Use a neutral detergent (such as diluted dish soap) on a soft wet cloth to clean, then dry with a soft clean cloth.
- Do not use metal scrub brushes, steel wool, polishing powders, or detergents with gritty or coarse particles.
- Do not use bleach, chemical thinners, or products with acids or alkaline detergents.
- Please note that bathroom chemicals and cosmetics can damage the seat.

### Toilet seat specification

Length\*width\*height: 494mm\*363mm\*74mm(19.4in\*14.3in\*2.9in)

Weight: 3.4Kg(7.5Lb)