



These instructions and the images herein are proprietary. Any unauthorized reproduction is prohibited.

VANO-EVC-LP-EXT

Extend-A-Stay Kit for GoWesty Larger Capacity LP Tank

The fittings included in this kit are designed to work in conjunction with our increased-capacity Eurovan LP tank installed on a Vangon. It functions exactly like a standard RV Extend-A-Stay unit. It will allow you to use your on-board LP tank to run external appliances, such as lanterns and stoves, originally designed to work with disposable, 1-pound propane canisters. Additionally, it allows you to hook up an external tank to supplement your on-board tank during long stays and/or heavy usage.

NOTE: This kit will ONLY work in conjunction with our kit used to install an increased-capacity Eurovan LP tank on a Vangon (VANO-EVC-LP-KIT).

Installation

- Install the supplied fittings as shown in the diagram below. Be sure to use PTFE plumbers tape or an equivalent sealant on the brass pipe thread fittings. The lower fitting is a T with the second port capped off. Do not remove the pre-installed plug. Make sure, when tightening, to orient the inlet to allow easy access when hooking up the hose. An extra wrap of sealing tape can help adjust the final orientation.

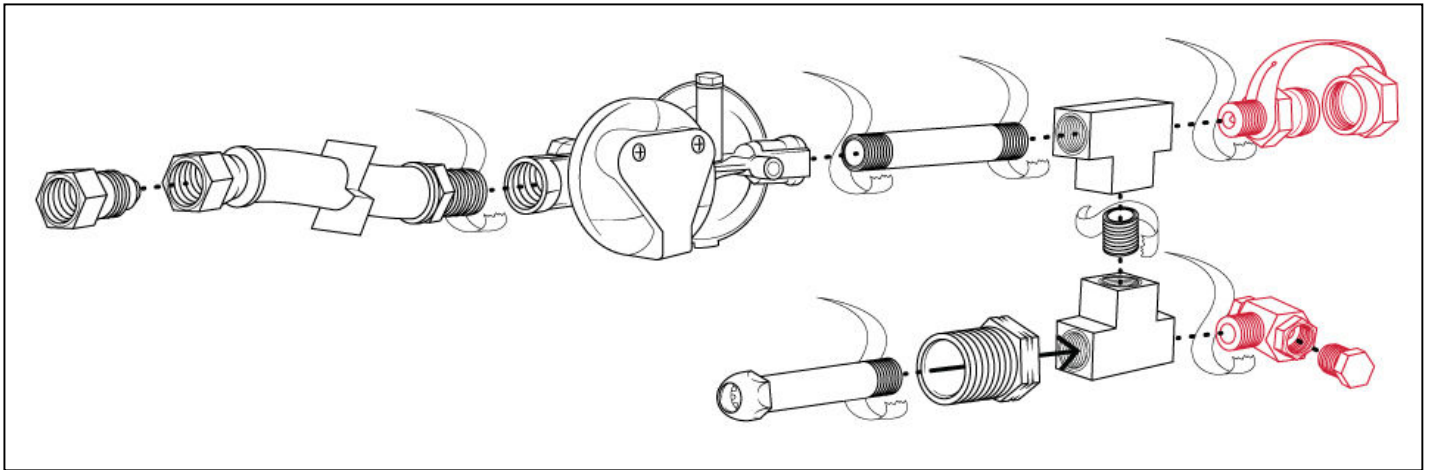

- These are standard propane and propane accessory fittings. They can be used with standard extend-a-stay hoses and hose kits sold online or at most RV supply stores.
- The upper fitting is a male, disposable cylinder adaptor, used to fuel external accessories (lantern, stove, etc.) with your on-board tank. This is an outlet only and has a built-in check valve to prevent leakage when accessories are not installed. You will need to open the main valve of your tank to fuel accessories with your on-board tank. Be sure to keep the protective cap installed to prevent contamination and inspect it for leaks and/or damage periodically.
- The lower fitting is a 1/4" female inverted flare, used to connect an external tank to your vehicle for extended stays. This is an inlet only and has a built-in check valve to prevent any flow *out* of the fitting. You should keep the main valve of your on-board tank **CLOSED** when using propane from an external tank. The plug should be used to seal the fitting and to protect the check valve from contamination or damage. Periodically check for leaks or damage to the check valve and threads.
- You can also use these fittings at the same time to fuel external accessories with an external tank.
- Please note: these fittings are PRE-REGULATOR; this is by design and standard RV Extend-A-Stay kits are also designed this way. If you are unsure of the proper use of these fittings in conjunction with your accessories, take your vehicle to an RV or propane and propane accessory dealer for assistance.