



These instructions and the images herein are proprietary. Any unauthorized reproduction is prohibited.

## EMBLEM-RESTORE

### Emblem & Inscription Restoration Decals

**STEP 1:** CUT INDIVIDUAL LETTER AS YOU INSTALL



**STEP 2:** FLIP DECAL FACEDOWN SO THE LETTERS ARE NOT VISIBLE



**STEP 3:** STARTING WITH A CORNER BEGIN TO PEEL THE BACKING AWAY FROM THE CLEAR TAPE. SLOWLY PEEL THE BACKING AT A 180 ANGLE AWAY FROM THE DECAL. ENSURE THE DECAL STAYS ON THE CLEAR TAPE AS YOU REMOVE THE BACKING

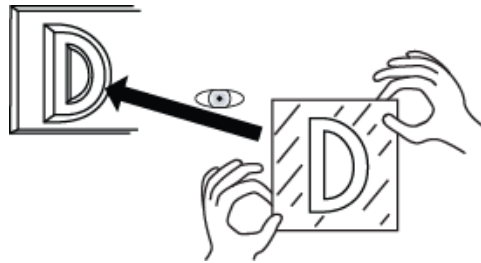

**STEP 4:** CLEAN AND WIPE DOWN THE SURFACE FOR DECAL TO BE APPLIED! HOLDING THE DECAL BY THE CORNERS OF THE CLEAR TAPE ALIGN THE DECAL OVER THE SURFACE TO BE APPLIED. SLOWLY LOWER THE DECAL ONTO THE SURFACE.

**NOTE:** ONCE THE DECAL STICKS TO THE SURFACE TRYING TO REALIGN WILL DAMAGE THE DECALS FINISH

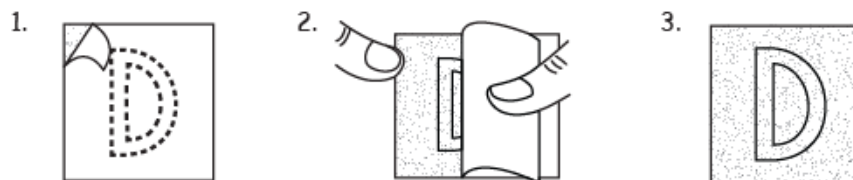

**STEP 5:** FIRMLY PRESS ON THE DECAL WITH YOUR FINGERS TO ENSURE PROPER ADHESION. PEEL THE CLEAR TAPE SLOWLY AT A 180 ANGLE, LEAVING THE DECAL ADHERED TO THE SURFACE

