

Rödler

MANUAL DE ARMADO

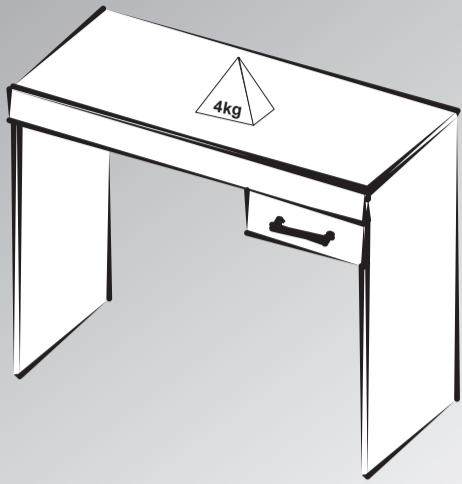

Mesa para Notebook Cooler

Mesa para Notebook Cooler / Cooler Notebook Table

Versão 1.2 / Versión 1.2 / Version 1.2

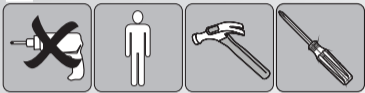

www.rodler.cl

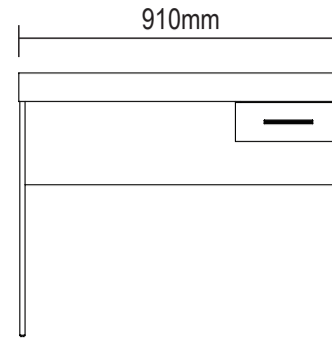

frente/frente/front

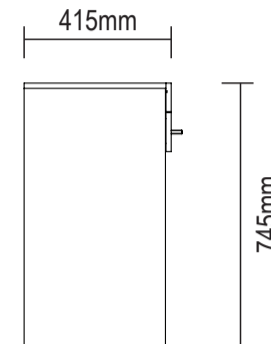

lateral/lado/side

Conservação e Limpeza

Conservación y Limpieza Conservation and Cleaning

Não expor o produto ao sol, altas temperaturas e umidade. Não arrastar objetos sobre a superfície do móvel (ex.: TV, DVD, aparelho de som, objetos decorativos...) e manter em local seco e arejado.

Para a limpeza, utilizar um pano seco e macio. Não é necessário o uso de materiais abrasivos ou álcool.

No exponga el producto a la luz solar, las altas temperaturas y la humedad. No arrastre los objetos a través de la superficie de la unidad (por ejemplo, TV, DVD, equipo de música, objetos de decoración ...) Mantener en un lugar fresco y seco.

Para la limpieza, utilizar un paño seco y suave. El uso de materiales abrasivos o del alcohol no es necesario.

Do not expose the product to sunlight, high temperatures and humidity. Do not drag objects across the surface of the unit (TV, DVD, stereo, decorative objects ...) keep it in a cool dry place. For cleaning, use a dry and soft cloth. Do not use abrasive materials or alcohol.

Lista de Materiais Lista de Materiales/ Hardware List

A		Cavilha / Tarugo / Dowel Ø6x30mm	18
B		Minifix / Minifix / Minifix Ø7x30mm	13
C		Tambor / Tambor / Minifix Cam Ø15x12mm	13
D		Tapa furo adesivo / Adhesivo / Hole Cover Ø18mm	04
E		Parafuso / Tornillo / Screw Ø3,5x40mm CP	03
F		Parafuso / Tornillo / Screw Ø3,5x12mm CC	08
G		Corrediça / Guia / Slider 300mm	02
H		Corrediça / Guia / Slider 300mm	02

J		Puxador Java / Tirador Java / Java Handle (128mm)	01
K		Sapata / Pata / Foot	04
L		Parafuso / Tornillo / Screw Ø4,0x14mm CP	10
M		Suporte Angular / Soporte Angular / Plastic Corner Brace 24x16x13mm	03
N		Cantoneira 1x1 / Cantonera 1x1 / 1x1 Corner Brace	02
O		Cola / Pegamento / Glue	01

Peça 01 - O numero na borda da peça corresponde ao manual.
-Para retirada do numero usar Lustra-Móveis.

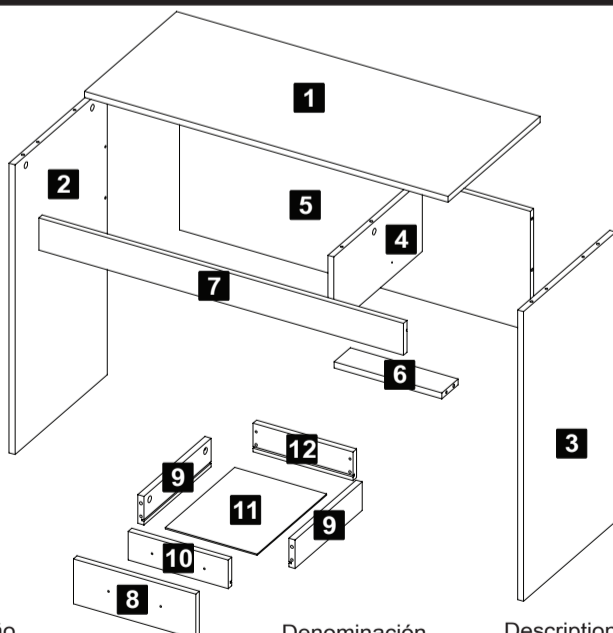

Denominação	Denominación	Description	Qty
1-Tampo (910x400x15mm)	1-Tapa	1-Top	1
2-Lateral esquerda (725x399x15mm)	2-Lateral izquierda	2-Left side	1
3-Lateral direita (725x399x15mm)	3-Lateral derecha	3-Right side	1
4-Divisão (178x384x15mm)	4-División	4-Partition	1
5-Travessa traseira (878x300x15mm)	5-Travesaño trasero	5-Back crosspiece	1
6-Travessa (270x70x15mm)	6-Travesaño	6-Crosspiece	1
7-Encabeçamento (913x80x15mm)	7-Encabezado	7-Header	1
8-Frente gaveta (300x110x15mm)	8-Frente cajón	8-Drawer front	1
9-Lateral gaveta (285x70x15mm)	9-Lateral cajón	9-Drawer side	2
10-Frente int gaveta (245x70x15mm)	10-Frent int cajón	10-Front int/Drawer	1
11-Fundo gaveta (295x225x3mm)	11-Fondo cajón	11-Drawer bottom	1
12-Traseira gaveta (245x70x15mm)	12-Trasera cajón	12-Drawer back	1

1 Passo Paso Step

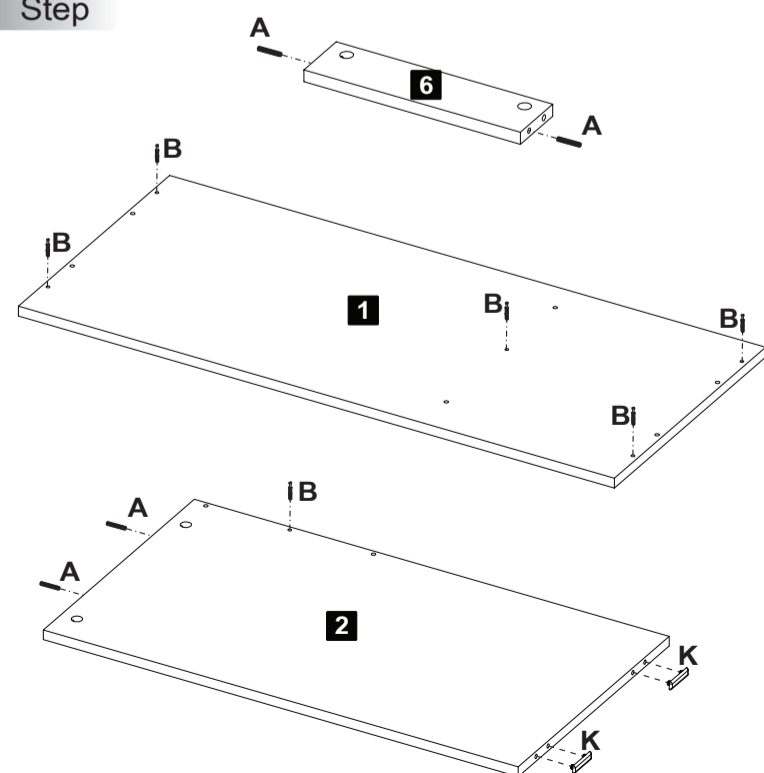

A Cavilha 04 **B** Minifix Ø7x30mm 06 **K** Sapata Reta 02

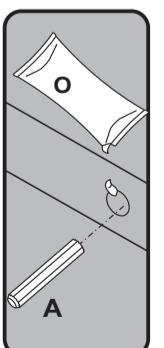
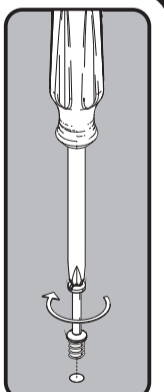

2 Passo
Paso
Step

Observe que o parafuso deve ser colocado no 1º furo da corredeira.
Observe que el tornillo deve ser colocado en el 1º hoyo de la corredeira.
Note that the screw must be located in the 1st slider holes.

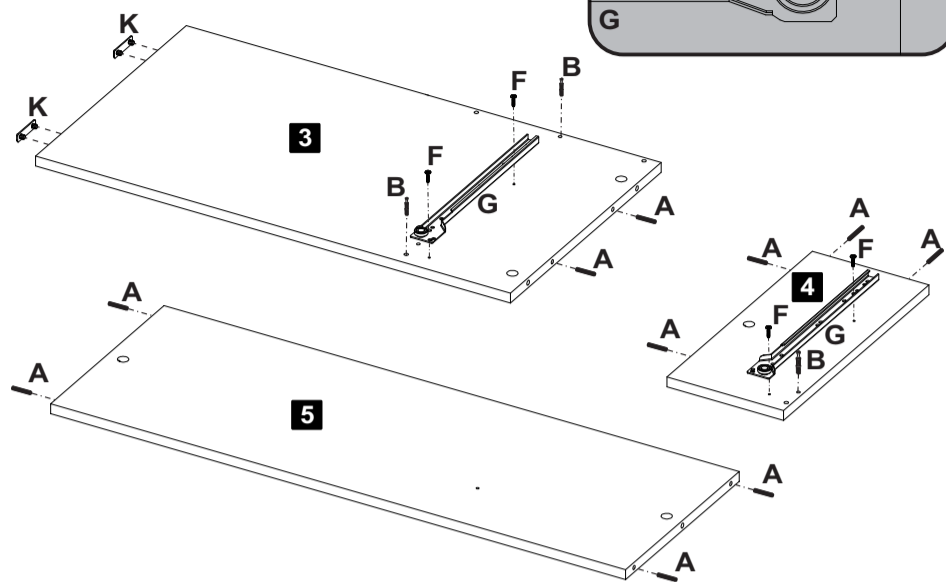

- A** Cavilha 04
- B** Minifix 07x30mm 06
- F** Parafuso Ø3,5x12mm CC 04
- G** Corredeira 300mm 02
- K** Sapata Reta 02

3 Passo
Paso
Step

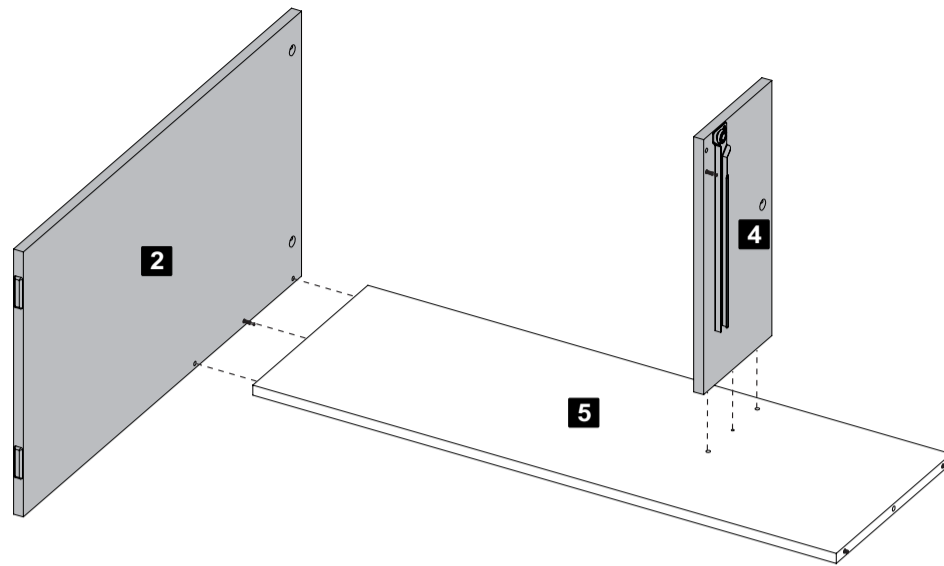

4 Passo
Paso
Step

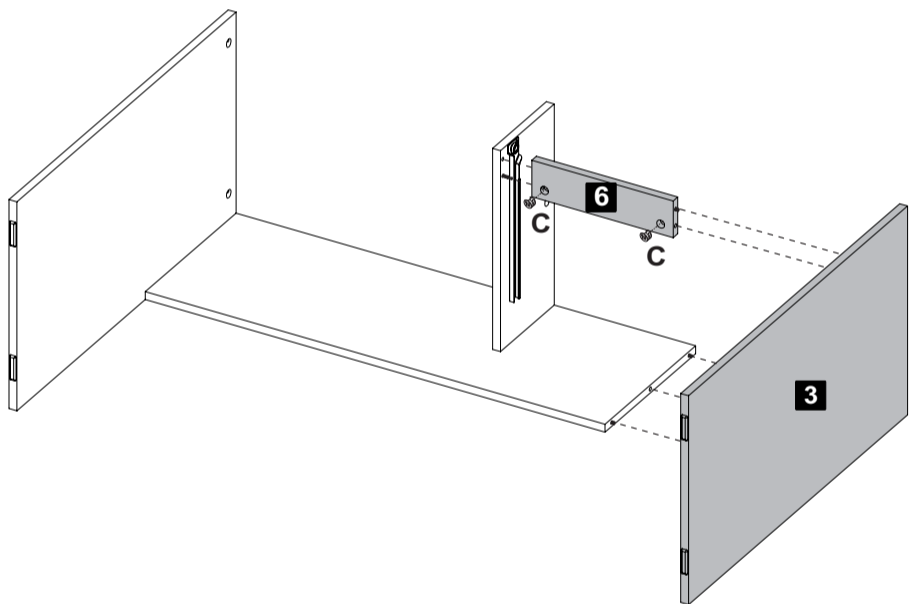
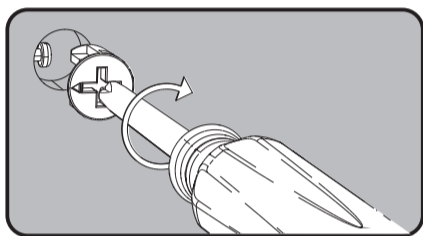

- C** Tambor 02

5 Passo
Paso
Step

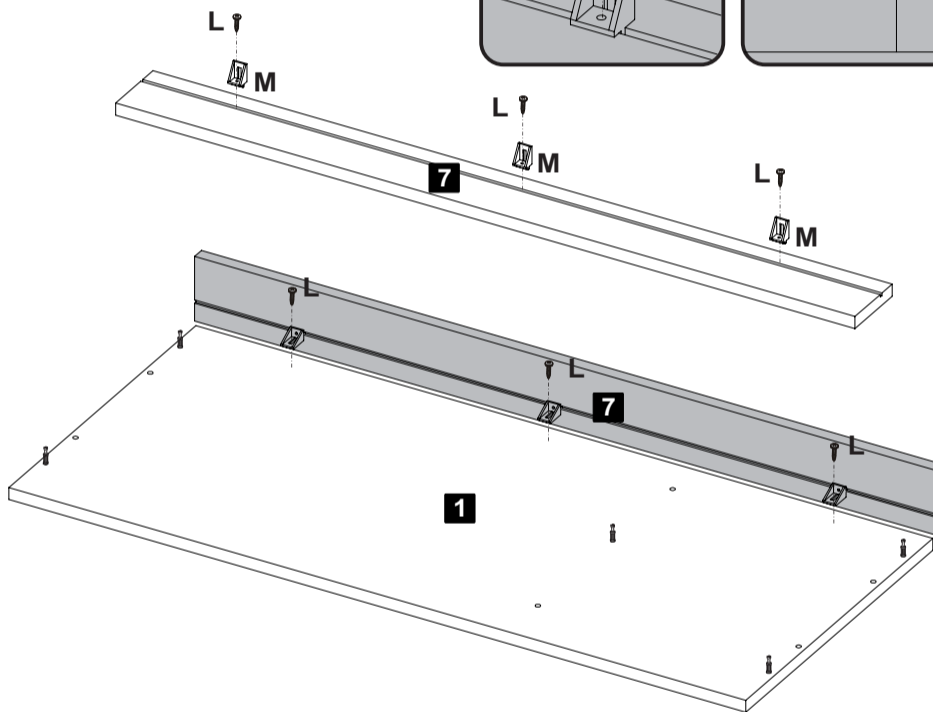
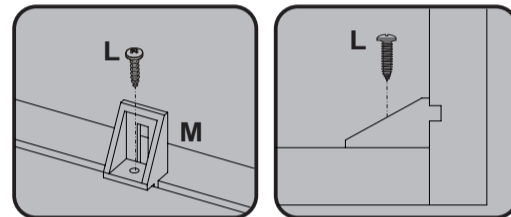

- L** Parafuso Ø4,0x14mm CP 06
- M** Suporte Angular 03

6 Passo
Paso
Step

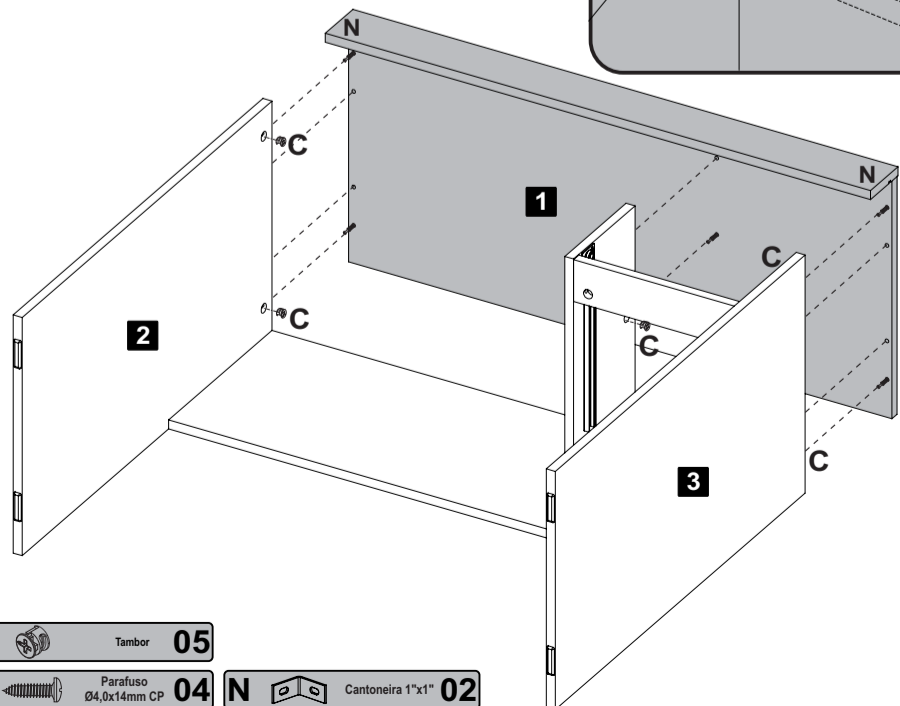
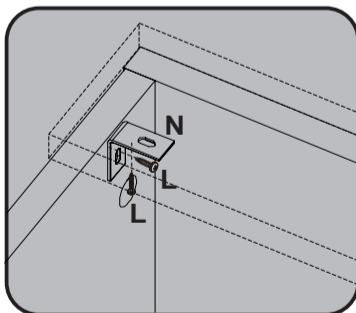

- C** Tambor 05
- L** Parafuso Ø4,0x14mm CP 04
- N** Cantoneira 1"x1" 02

7 Passo
Paso
Step

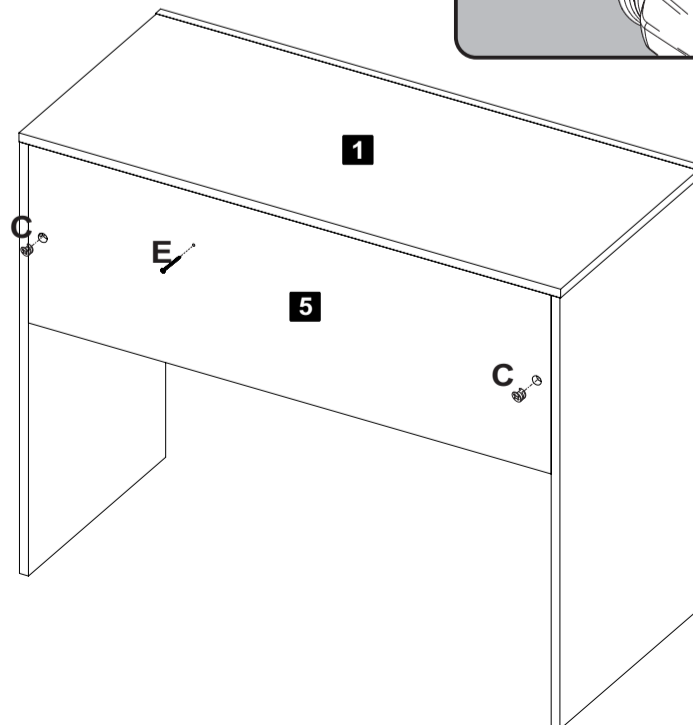
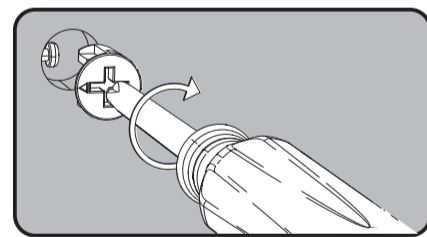

- C** Tambor 02
- E** Parafuso Ø3,5x40mm CP 01

8 Passo
Paso
Step

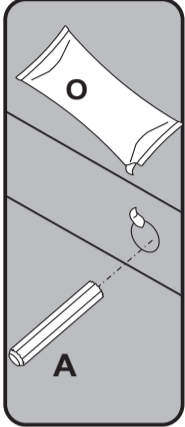
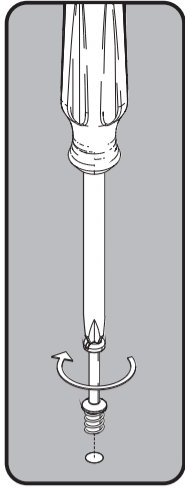
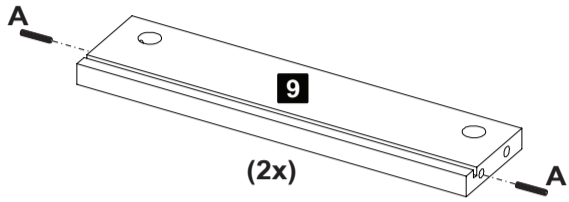
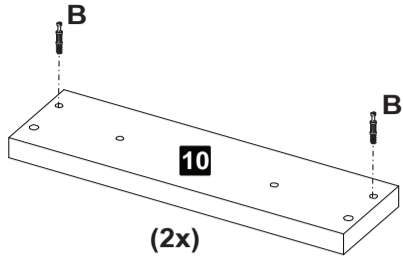

A Cavilha 04 B Minifix 07x30mm 06

9 Passo
Paso
Step

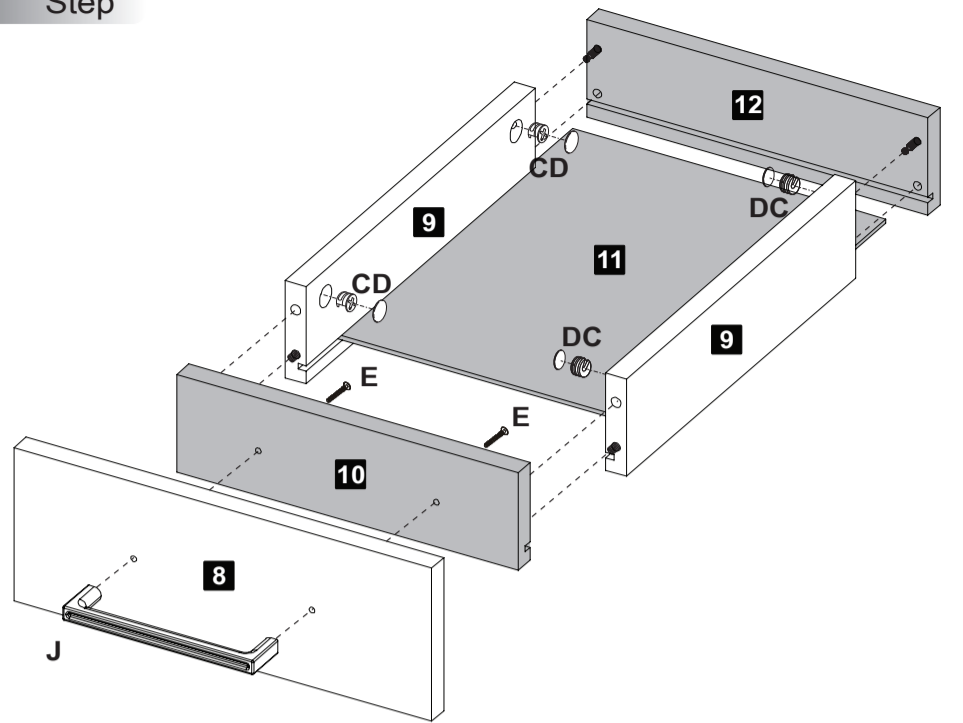

C Tambor 04 D Tapa Furo Adesivo 04 F Parafuso 03,5x40mm CP 02 J Puxador Java 01

10 Passo
Paso
Step

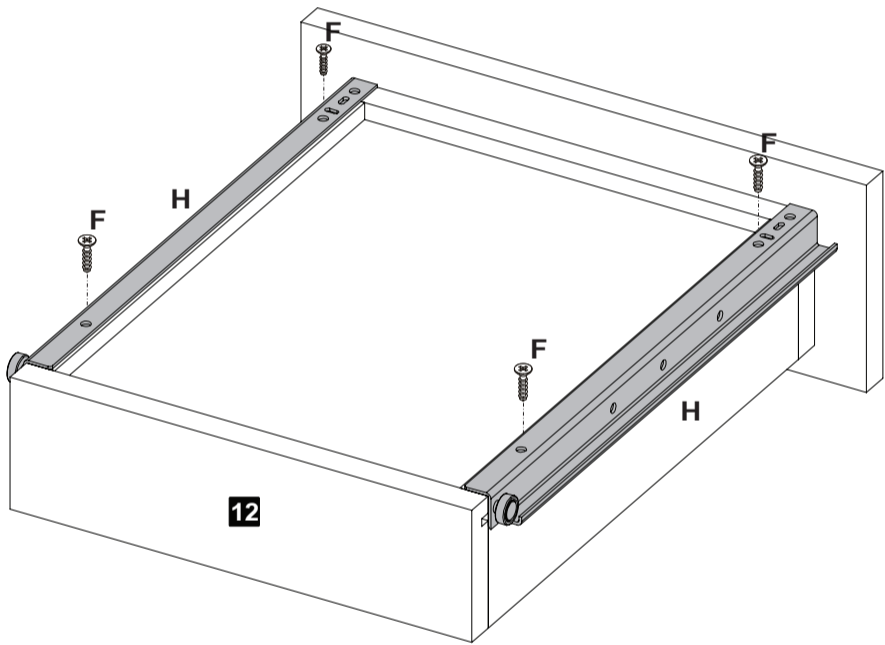

F Parafuso 03,5x12mm CC 04 H Corrediça 300mm 02

11 Passo
Paso
Step

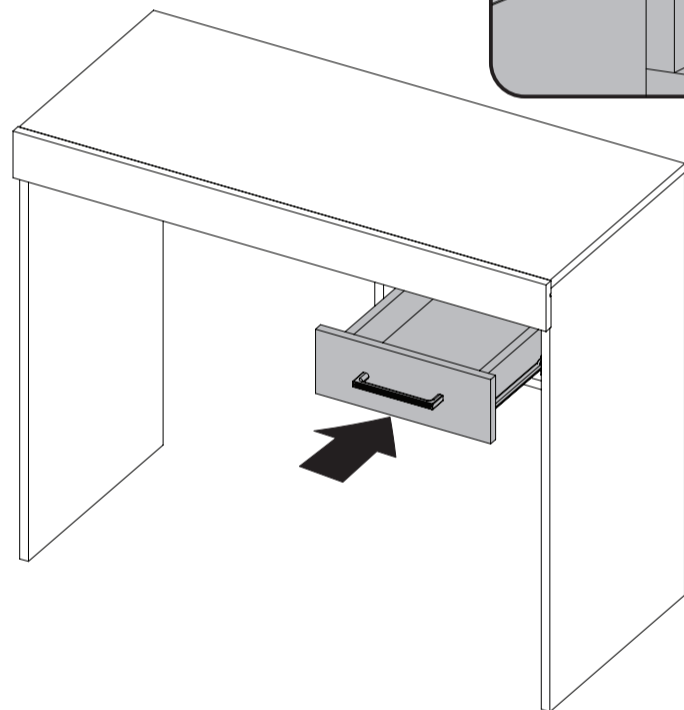

Röodler