

Escritorio Venecia

MANUAL DE ARMADO



Rödler®

- Siga atentamente todas as instruções de montagem;
- Monte seu produto no local ou próximo de onde será colocado. Movimentações do produto já montada, podem avariá-lo;
- Faça a montagem em uma superfície limpa e plana. Aconselhamos usar a própria embalagem de papelão para forrar o chão;
- Verifique se as quantidades de peças e acessórios estão de acordo com o manual de montagem;
- Compare atentamente os furos de cada peça com a ilustração do manual;
- Utilize as ferramentas indicadas. Só utilize parafusadeira se tiver conhecimento e habilidade. O uso inapropriado pode danificar peças e/ou acessórios;
- Se o produto necessitar fixação na parede, tenha cuidado para não atingir fios e canos ao furar a parede.

Obs: Caso necessite solicitar peças de reposição, por favor, utilize os códigos dos mesmos.

- *Siga con atención todas las instrucciones de armado.*
- *Arme su mueble en un lugar cerca donde será instalado. Mover el producto ya montado puede perjudicarlo.*
- *Haga el montaje en una superficie limpia y plana. Aconsejamos usar el propio embalaje de cartón para forrar el suelo.*
- *Asegúrese de que las cantidades de piezas y accesorios coincidan con el manual de montaje.*
- *Compare cuidadosamente los agujeros de cada pieza con la ilustración del manual.*
- *Utilice las herramientas indicadas. Sólo utilice atornillador automático si tiene conocimiento y habilidad. El uso inapropiado puede dañar piezas y/o accesorios.*
- *Si el producto necesita fijación en la pared, tenga cuidado de no alcanzar cables y cañones al perforar la pared.*

OBS: Si necesita solicitar piezas y / o accesorios de repuesto, por favor, utilice los códigos de los mismos.

- *Follow carefully the assembly instructions.*
- *Assemble your furniture in a place near where it will be installed. Moving the assembled product can harm it.*
- *Make the assembly on a clean and flat surface. We recommend using the cardboard box to cover the floor.*
- *Make sure the quantities of parts and accessories match the assembly manual.*
- *Carefully compare the holes in each piece with the illustration in the manual.*
- *Use the indicated tools. Only use an automatic screwdriver if you have knowledge and skill. Improper use can damage parts and/or accessories.*
- *If the product needs fixing on the wall, be careful and don't reach cables and cannons when drilling the wall.*

NOTE: If you need to request spare parts and/or accessories, please use the codes according of this instruction manual.

CONSERVAÇÃO E LIMPEZA

MANTENIMIENTO Y LIMPIEZA / MAINTENANCE AND CLEANING

Não expor o produto ao sol, altas temperaturas e umidade, mantendo-o em local seco e arejado. Para a limpeza, utilizar um pano seco e macio. Não é necessário o uso de materiais abrasivos ou álcool.

No exponga el producto al sol, altas temperaturas y la humedad. Mantener en local seco y ventilado. Para limpiar, utilice un paño suave y seco. No es necesario el uso de materiales abrasivos o alcohol.

Do not expose the product to sunlight, high temperatures and humidity. Keep it in a dry and ventilated place. To clean it, use a soft and dry cloth. It is not necessary to use abrasive materials or alcohol.

FERRAMENTAS **NÃO** FORNECIDAS, MAS NECESSÁRIAS
PARA A MONTAGEM DO PRODUTO

HERRAMIENTAS **NO** SUMINISTRADAS, MAS NECESARIAS PARA EL MONTAJE DEL PRODUCTO
TOOLS **NOT** SUPPLIED, BUT NECESSARY FOR THE ASSEMBLY

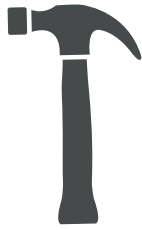

100097

18X



100070

14X



100069

14X

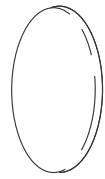

102958

16X

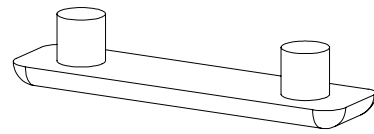

102971

4X



102371

8X

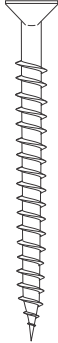

103122

16X



100461

2X



103330

8X



100503

6X



100201

12X

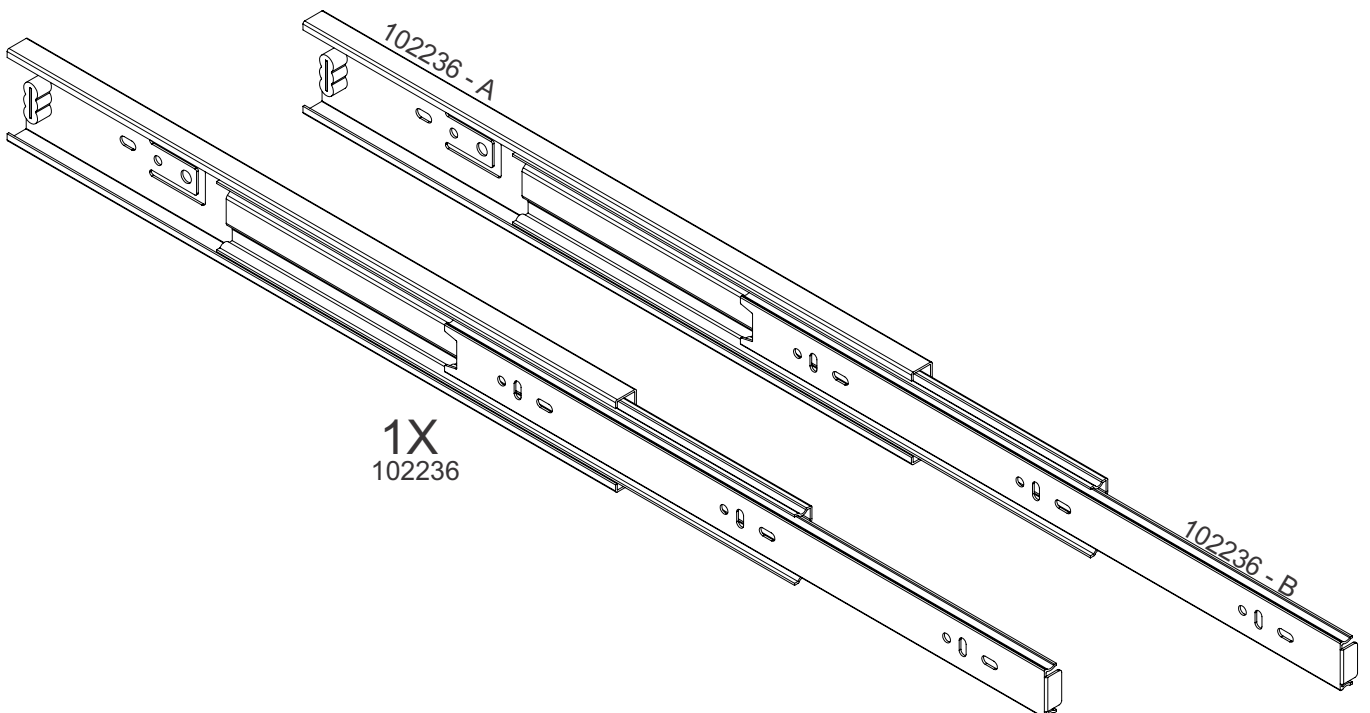

A **Instalação Trilho Telescópico - 350mm** 102236
Preparación del Guia Telescópico / Installation of the telescopic sliders

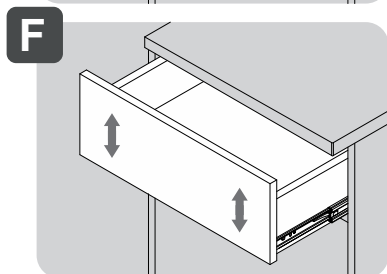
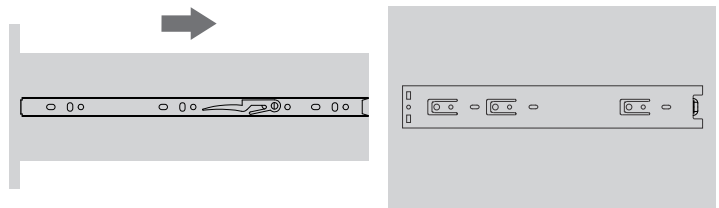
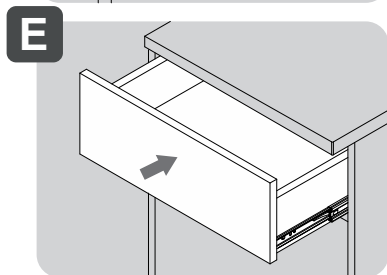
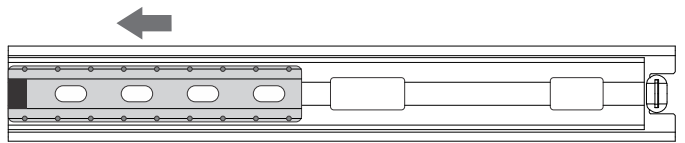
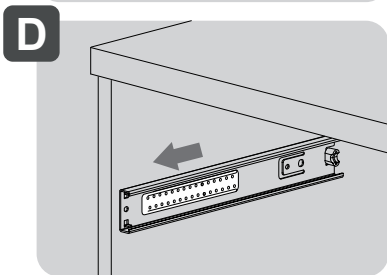
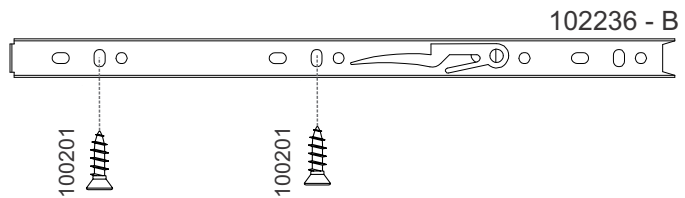
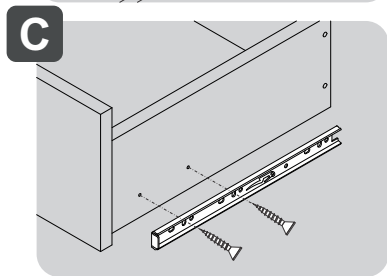
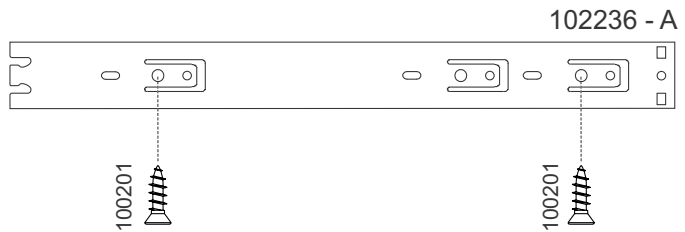
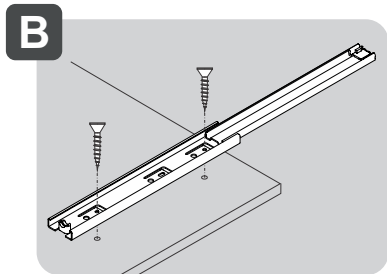
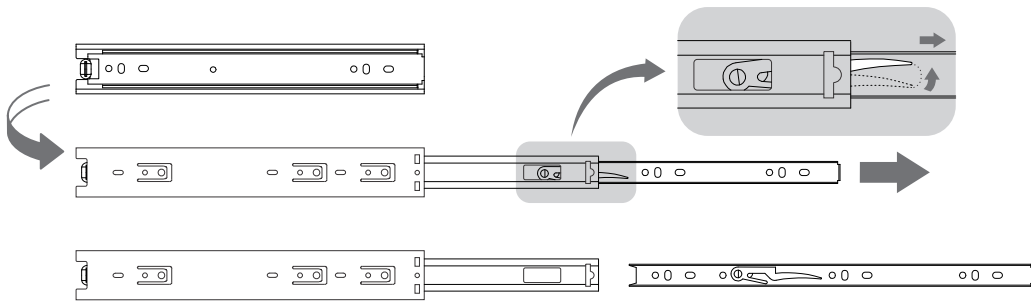

Ajustar a gaveta e colocar os parafusos
Ajustar el cajón y poner los tornillos
Adjust the drawer and put the screws

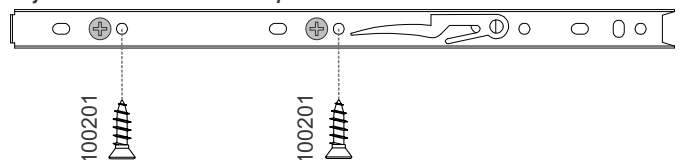

Como retirar a gaveta *Cómo sacar el cajón* / *How to take off the drawer*

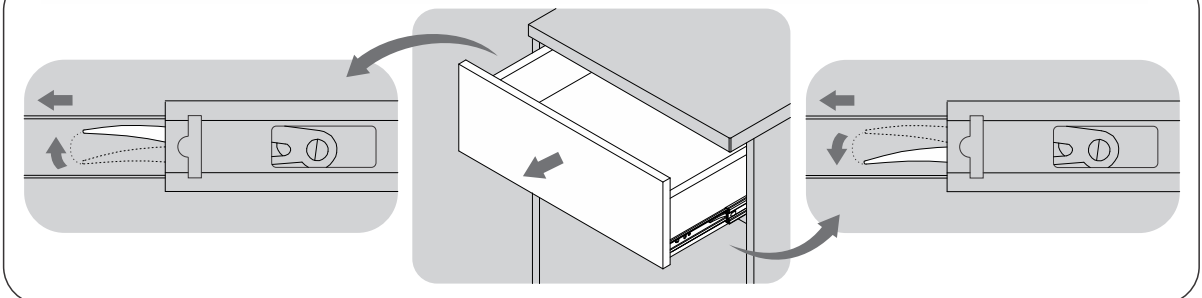

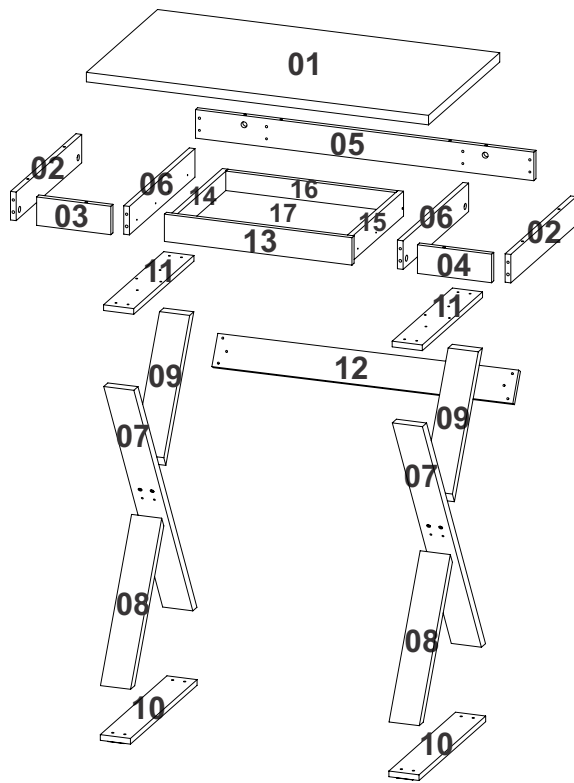

| Número Número Number | Medida Dimensión Size | Cantidad Cantidad Quantity |
|----------------------------|-----------------------------|----------------------------------|
| 01 | 908x500x25mm | 01 |
| 02 | 460x75x15mm | 02 |
| 03 | 197x75x15mm | 01 |
| 04 | 197x75x15mm | 01 |
| 05 | 989x75x15mm | 01 |
| 06 | 460x75x15mm | 02 |
| 07 | 843x80x25mm | 02 |
| 08 | 437x80x25mm | 02 |
| 09 | 392x80x25mm | 02 |
| 10 | 468x80x15mm | 02 |
| 11 | 423x80x15mm | 02 |
| 12 | 796x85x15mm | 01 |
| 13 | 498x72x15mm | 01 |
| 14 | 370x65x15mm | 01 |
| 15 | 370x65x15mm | 01 |
| 16 | 451x65x15mm | 01 |
| 17 | 462x363x6mm | 01 |

1

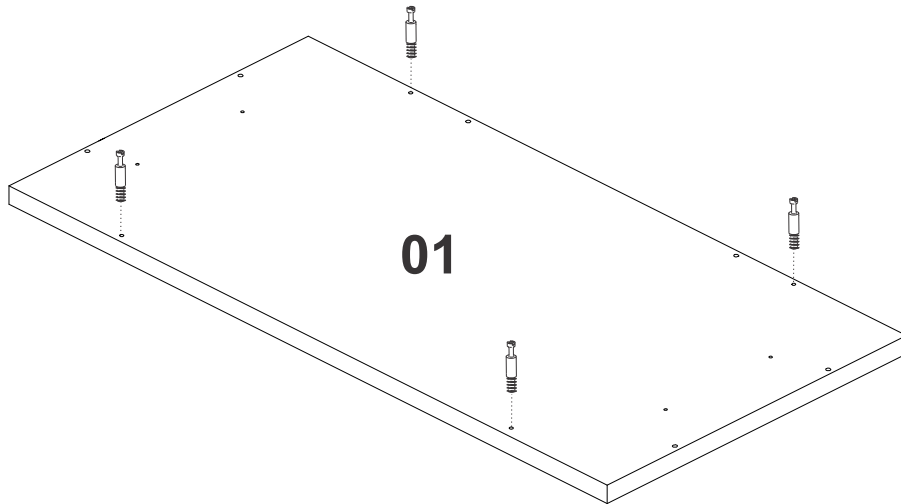

4X



2

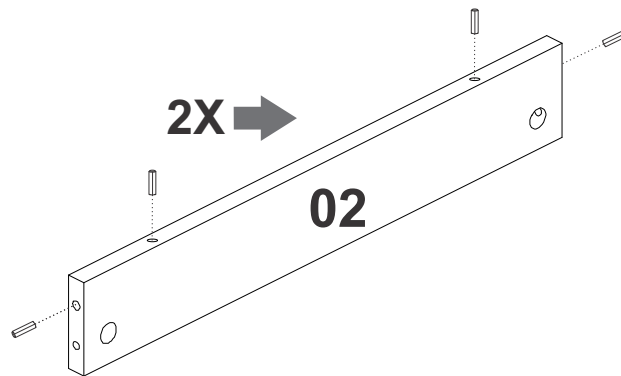

8X



3

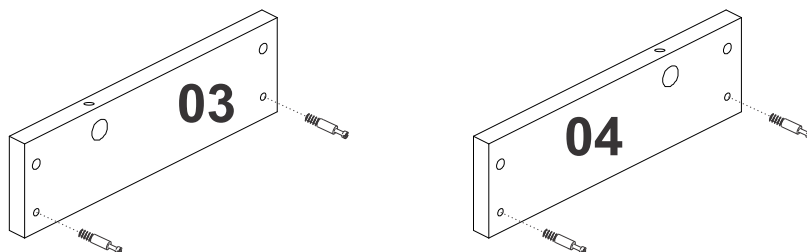

4X



4

2X

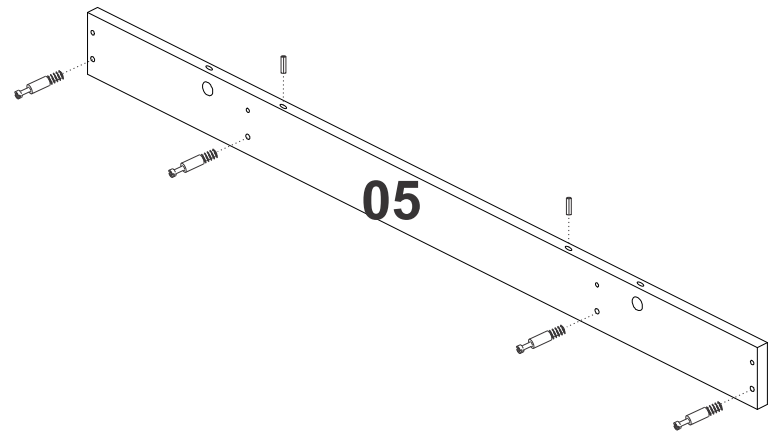
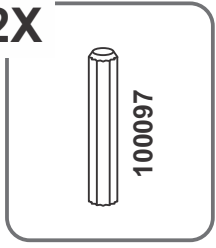

4X

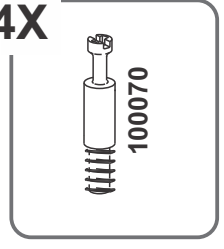

5

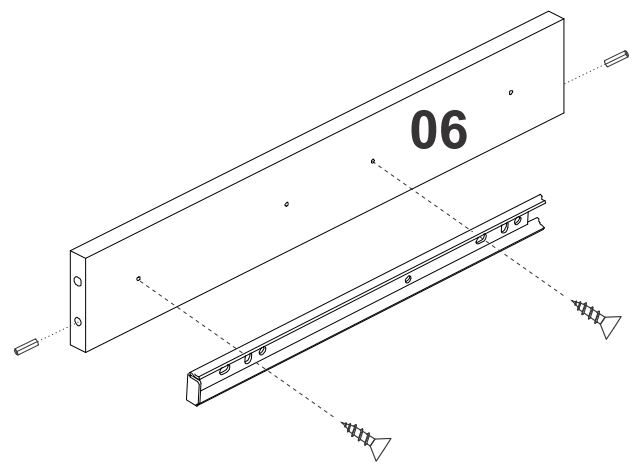
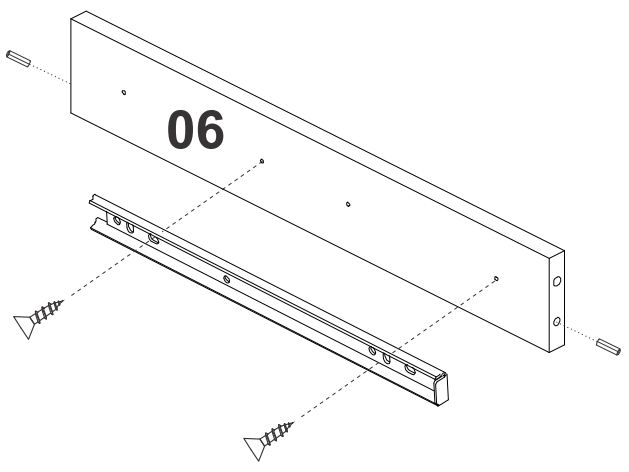

2X

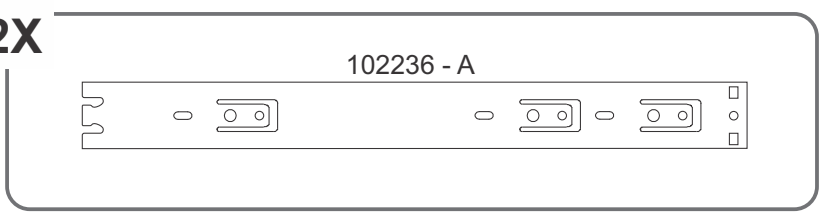

4X

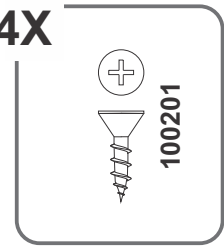

4X

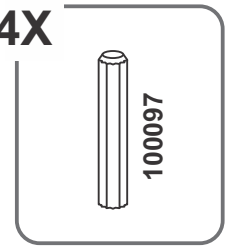

6

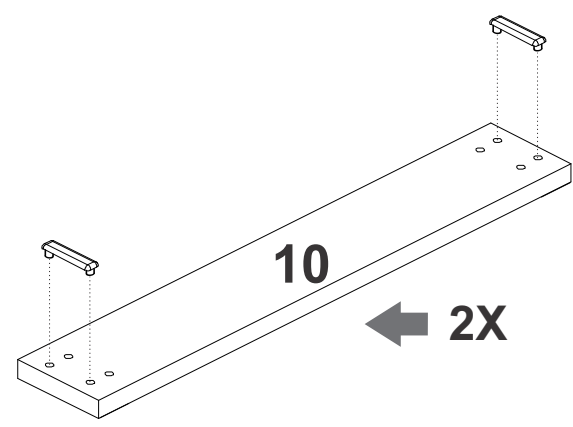

4X

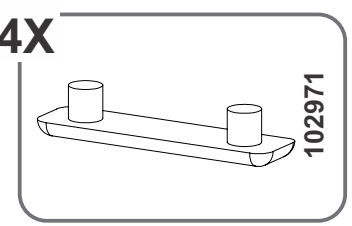

7

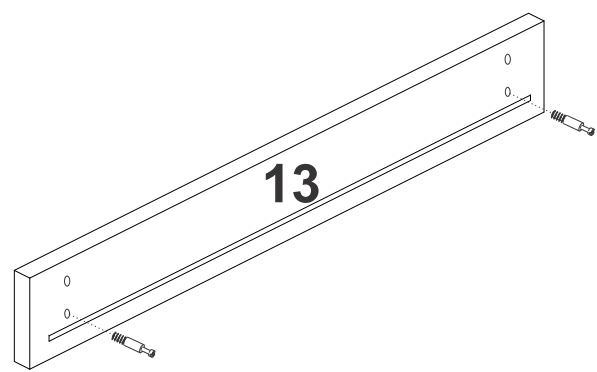

2X

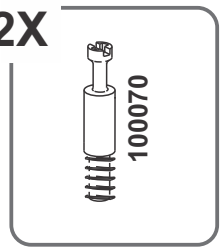

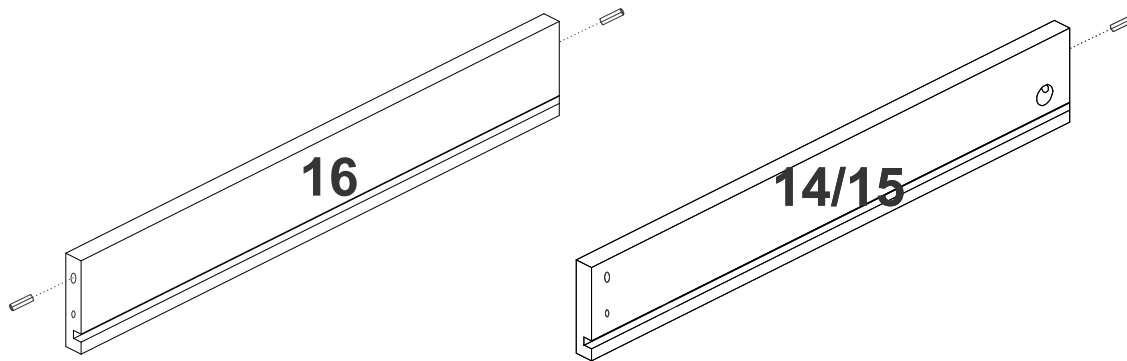
8**4X****9****ATENÇÃO**

ATENCIÓN / ATTENTION

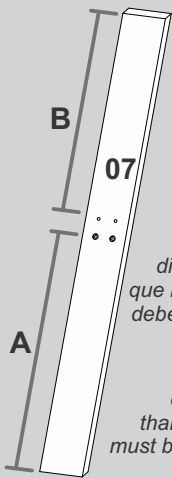

Na peça 07, a distância **A**, é maior que a **B**. A distância **A** deve ficar na base dos pés.

En la pieza 07, la distancia **A** es mayor que la **B**. La distancia **A** debe quedar en la base de los pies.

In the piece 07, the distance **A** is bigger than **B**. The distance **A** must be in the base of the feet.

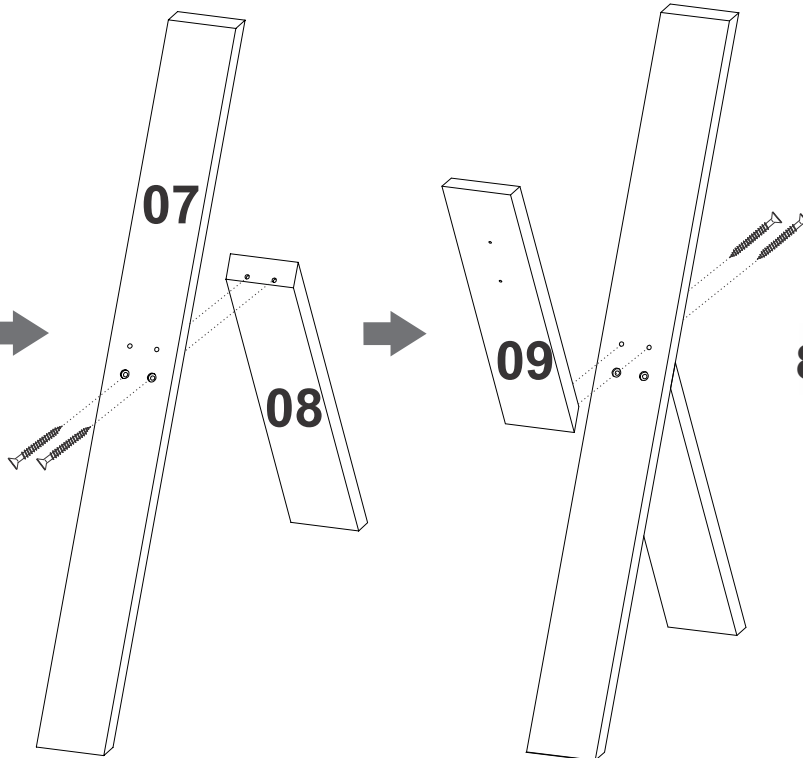
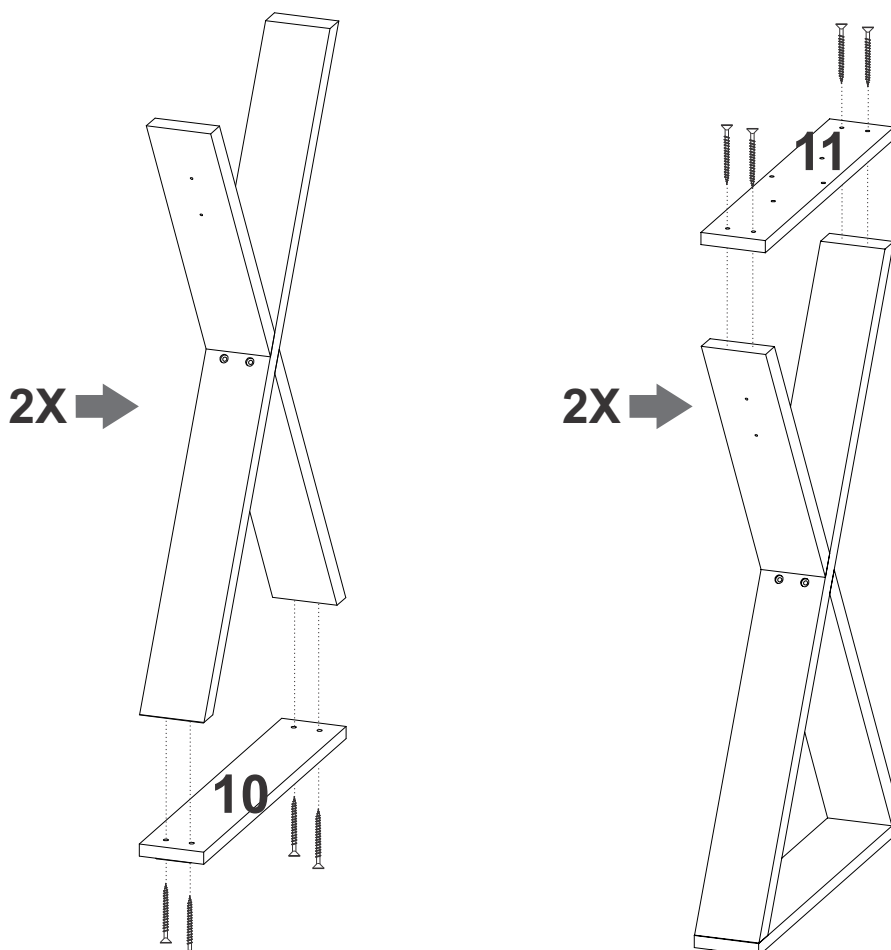
2X →**8X****10****2X** →**2X** →**16X**

11

2X

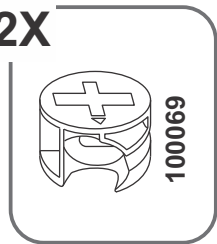

2X

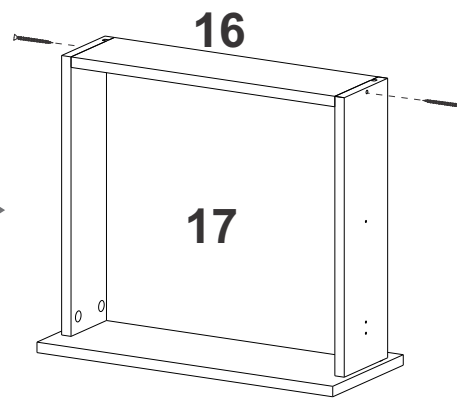
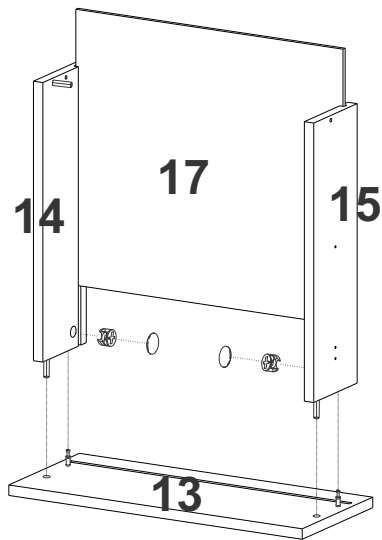
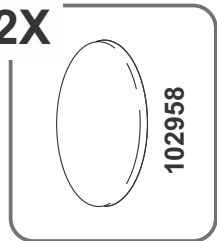

2X

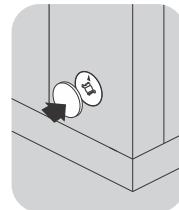
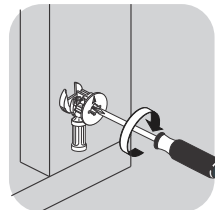
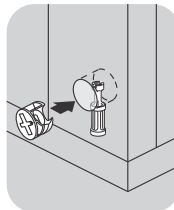
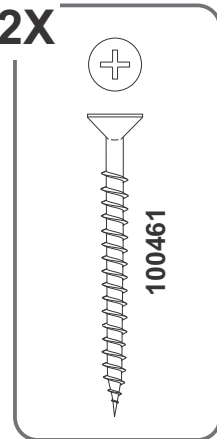

12

4X

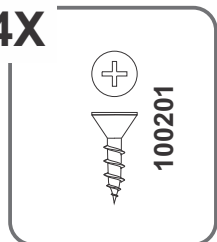

2X

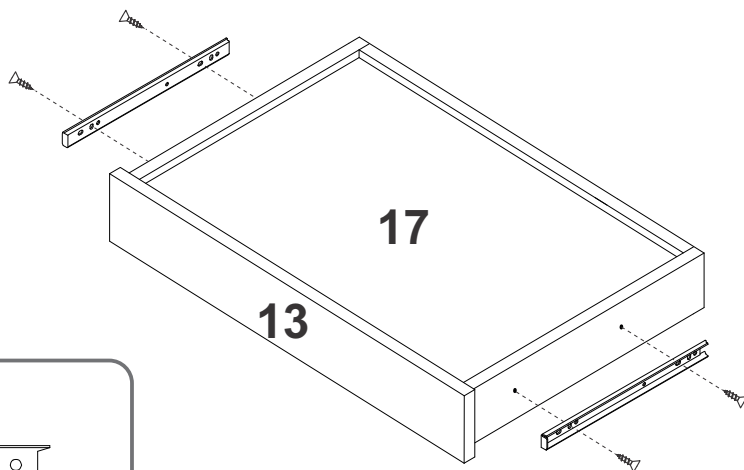
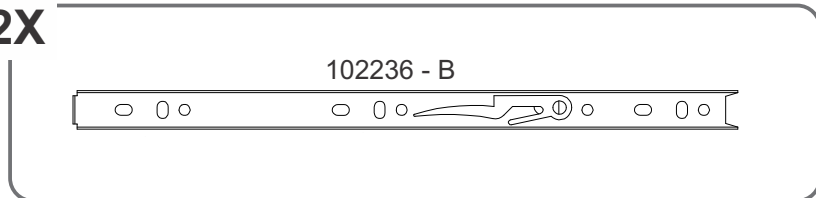

13

8X

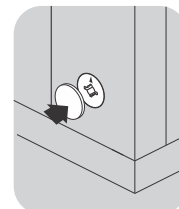
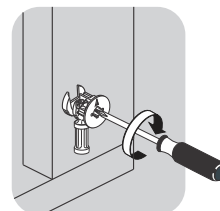
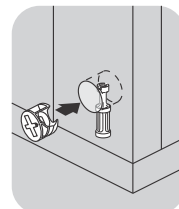
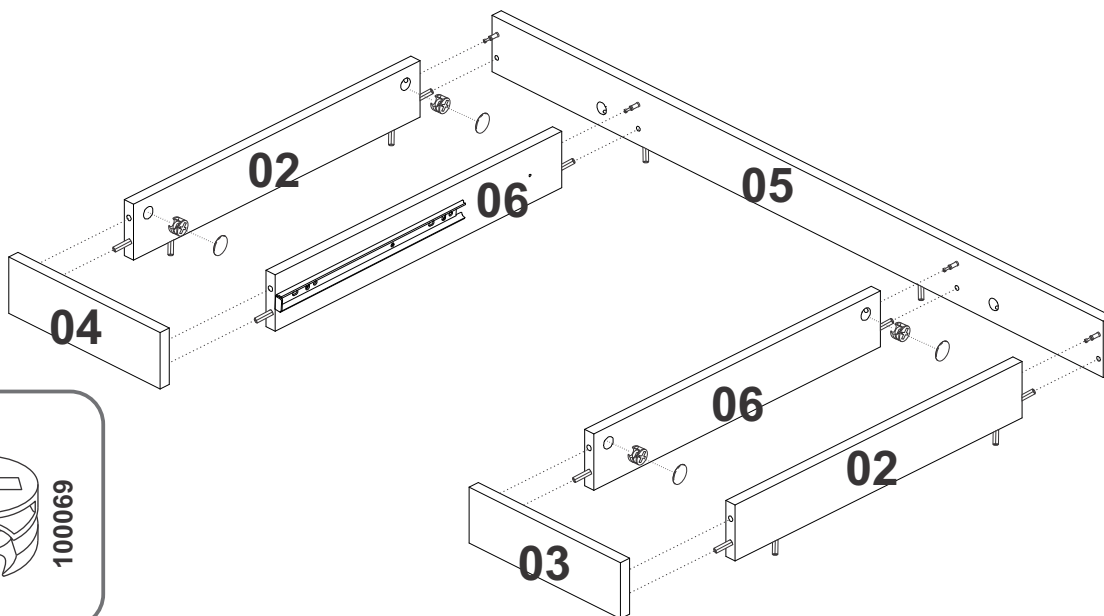
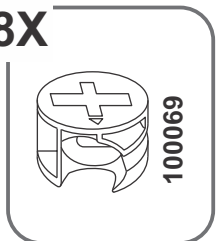

14

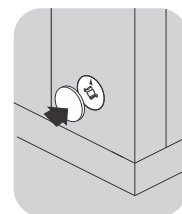
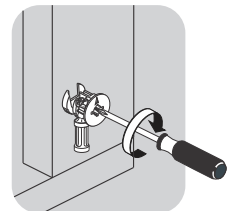
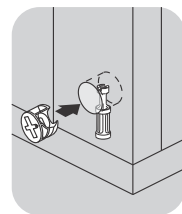
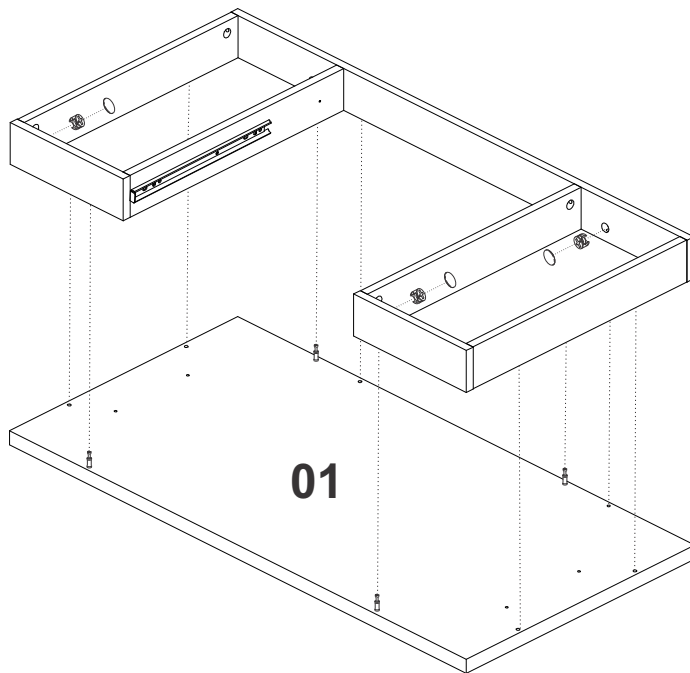

4X



01

15

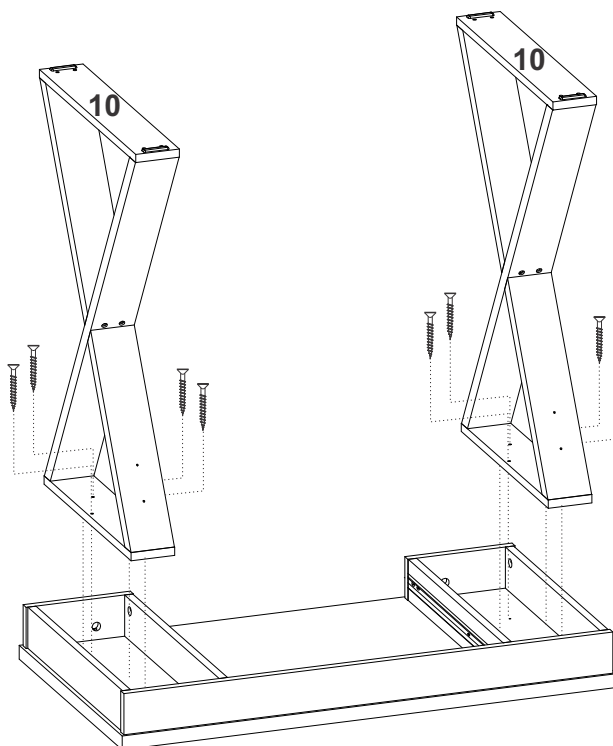

8X

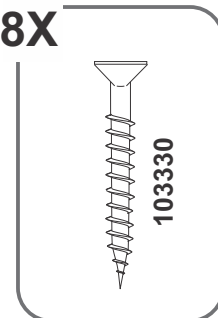

16

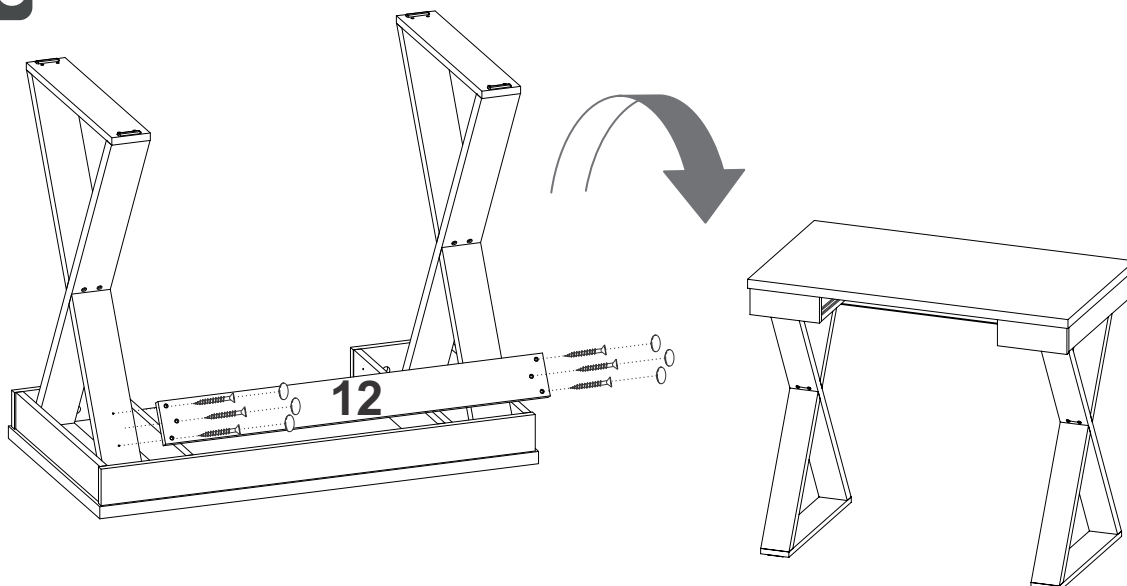

6X

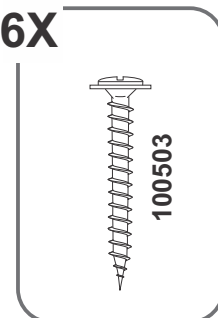

6X

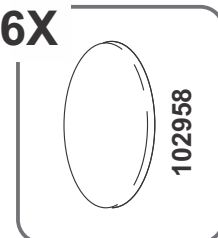

12

102958

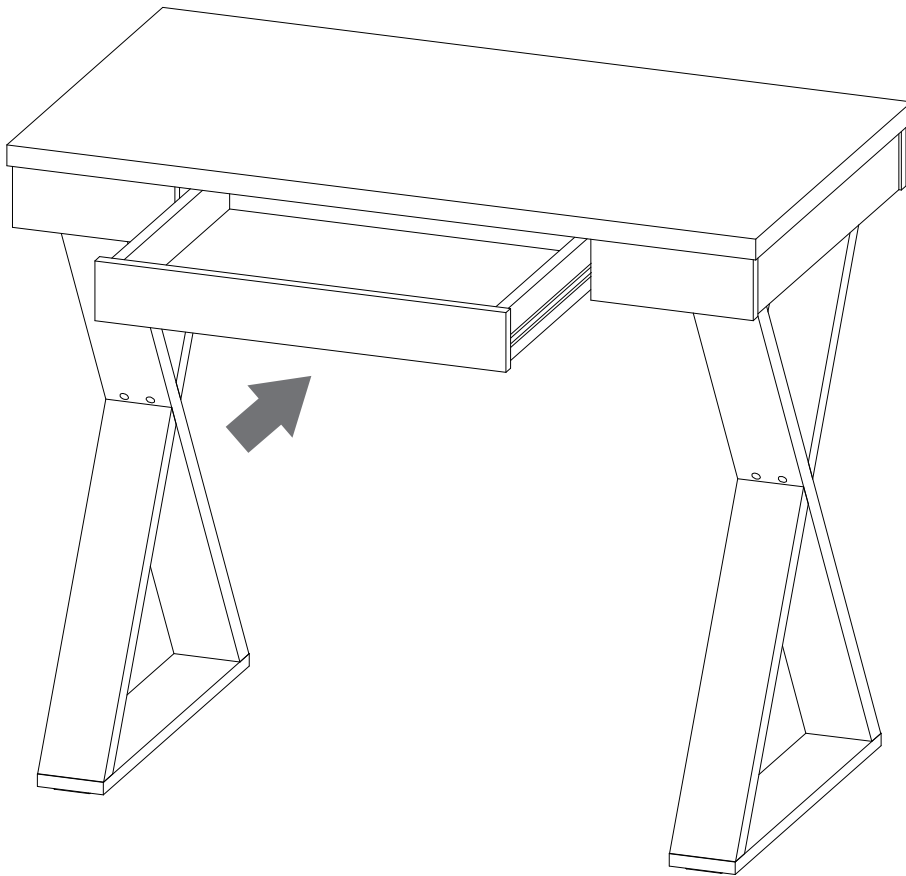
17**ATENÇÃO**

ATENCIÓN / ATTENTION

Depois de colocar a gaveta ajustar o trilho conforme o **Passo F** da Instalação do Trilho Telescópico.

Después de colocar el cajón, ajustar el guía de acuerdo a el **Paso F** de la Preparación del Guía Telescópico.

After attaching the drawer, adjust the rail according to **Step F** of the Telescopic Sliders Installation.

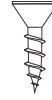
4X

100201

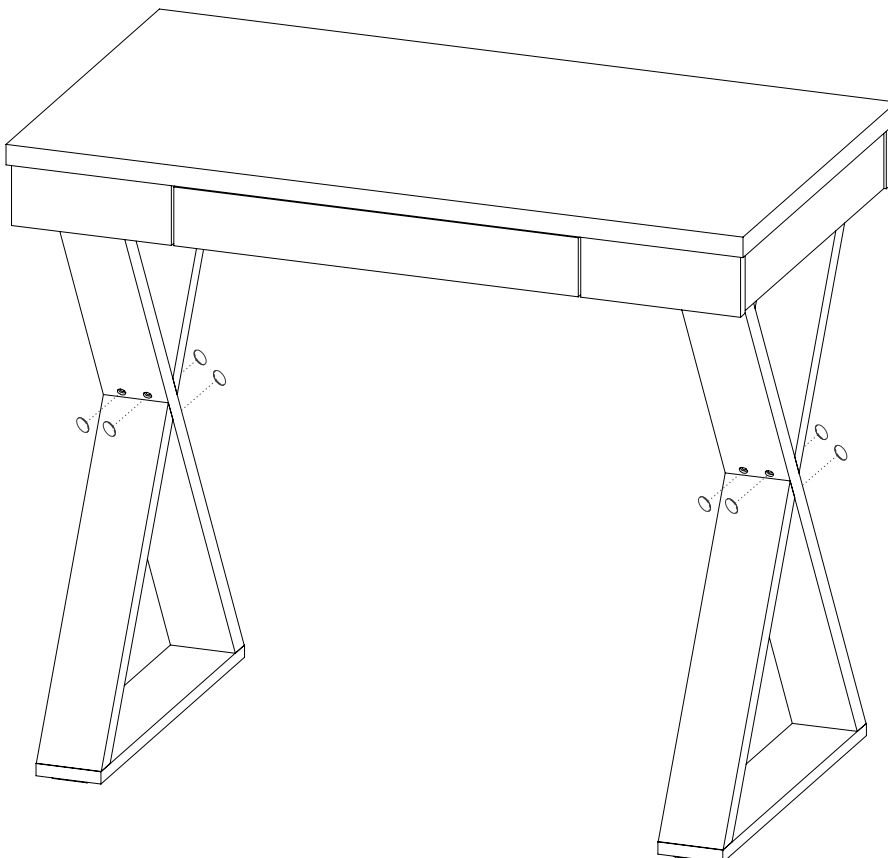
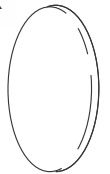
18**8X**

102958