



5-Stage RO System Filter Replacement Instructions

Model: RFK-5

Setup: Before starting, capture and reserve some RO water to use to rinse the filter housings. Shut off cold water supply to the RO unit and then close the valve on the tank. Lift the handle on the faucet to decompress the system. Leave the faucet open until the filter change is complete.

Filter Replacement Instructions:

Sediment Pre-Filter (Stage 1), Carbon Pre-Filters (Stage 2 & Stage 3), Post-filter (Stage 5)

- ◆ Step 1. Remove pre-filters from filter housings. Use a filter wrench if the housings are too tight.
- ◆ Step 2. Discard used filters, but save housing o-rings for re-use.
- ◆ Step 3. Clean inside of all housings with a mild soap solution, and then rinse with RO water.
- ◆ Step 4. Inspect o-rings to ensure they are free of damage (replace if necessary). Using a silicone-based lubricant, lubricate the o-ring and replace in filter housing. Make sure the o-ring is seated properly.
- ◆ Step 5. Insert the new filters into the appropriate housings and replace the housings onto the system.
- ◆ Step 6. Replace post-filter:
 - *If your existing post filter has **threaded** ends:* Disconnect the post-filter by removing the fittings on either end. Replace with new post-filter and re-use the existing fittings. The threaded adapters in the kit are not needed.
 - *If your existing post-filter has **quick connect** ends:* Thread the adapters tightly into either end of the new post filter. Disconnect the old post-filter by removing the tubing on either end. To release the tubing, push the collet square against the filter. With the collet held in this position, the tube can be removed. Inspect the ends of the tubing to make sure it is free from damage or kinks. Replace with the new post-filter by re-connecting the tubing. *(If the feed end tee is connected by a short length of tubing, keep this to use with the new filter.)*

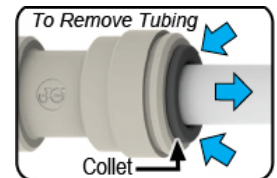

If also replacing the membrane (sold separately), follow steps 7-9. Otherwise, skip to step 10.

- ◆ Step 7. Unscrew the fitting to the cap of the membrane housing. Using pliers, pull out the old membrane from the housing.
- ◆ Step 8. Insert the membrane in the housing in the same direction as the old membrane. Push the membrane firmly into the housing until it seats on the far end.
- ◆ Step 9. Screw the housing cap back on, making sure the o-ring is positioned correctly. Screw the fitting (with tubing) back onto the housing.
- ◆ Step 10: Follow the normal start-up procedures to put the system back into service and test for leaks. *(Drain the first two tanks of water before drinking.)*



Important
Notice

The above instructions are written for AMI brand AAA RO Systems. Most standard-design systems are similar in setup and will have similar instructions. If using replacements for a different system, please refer to the owner's manual for instructions.

Ensure all seals and tubing connections are seated properly and free from damage. Misaligned or damaged, twisted, or warped seals may cause leaks. Manufacturer is not responsible for damages incurred through improper use of these products or instructions.

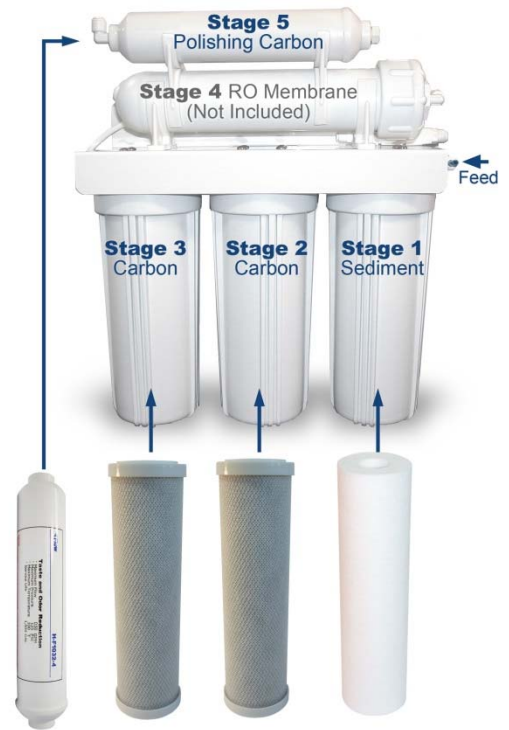

Recommended Replacement Schedule:

Our recommended replacement schedule is for relatively clean city feed water. For applications where the feed water is dirtier or has specific issues, more frequent change-outs may be required. Generally speaking, filters should be changed when there is a loss of performance. Contact sales@wateranywhere.com if you would like to receive a high-frequency replacement schedule to aid in planning your system maintenance for higher frequency change-outs.

Record Installation Date:

Half-Year Replacements

(6 months from installation or last 1-year service)

- ◆ Replace Sediment Pre-filter
- ◆ Replace Carbon Pre-filter (x 2)

1-Year Replacements

(12 months from installation or last 1-year service)

- ◆ Replace Sediment Pre-filter
- ◆ Replace Carbon Pre-filter (x2)
- ◆ Replace RO Membrane
- ◆ Replace Carbon Post-Filter
- ◆ If UV system is installed, lamp & sleeve should be replaced annually as well. (UV parts not included.)

Replacement Records

	Replaced on: (Record Date)	Next Due: (in 6 months)
Half-Year:		
1-Year:		
<i>Order New Replacement Packs on wateranywhere.com</i>		
Half-Year:		
1-Year:		
<i>Order New Replacement Packs on wateranywhere.com</i>		
Half-Year:		
1-Year:		
<i>Order New Replacement Packs on wateranywhere.com</i>		

(Continued)	Replaced on: (Record Date)	Next Due: (in 6 months)
Half-Year:		
1-Year:		
<i>Order New Replacement Packs on wateranywhere.com</i>		
Half-Year:		
1-Year:		
<i>Order New Replacement Packs on wateranywhere.com</i>		
Half-Year:		
1-Year:		
<i>Order New Replacement Packs on wateranywhere.com</i>		

Filter Packs Ordering Information (sold exclusively by wateranywhere.com)

RFK-5 – Replacement Filter-Pack

(Membrane Sold Separately) *Includes:*

- ◆ (1) H-F1005CF – 5 Micron Sediment Prefilter (Stage 1)
- ◆ (2) H-F2510AC – Carbon Block Pre-filters (Stages 2 & 3)
- ◆ (1) H-F1032-43A – Carbon Post-Filter (Stage 5) with QC adapters

New: Made-in-USA Filter Pack available – part # RFK-5-USA

RFK-5-PRE – Half-Year Pre-Filter-Pack

(Membrane Sold Separately) *Includes:*

- ◆ (1) H-F1005CF – 5 Micron Sediment Prefilter (Stage 1)
- ◆ (2) H-F2510AC – Carbon Block Pre-filters (Stages 2 & 3)

RFK-5-50 – Replacement Membrane & Filter Pack

With 50 GPD Membrane - *Includes:*

- ◆ (1) H-F1005CF – 5 Micron Sediment Prefilter (Stage 1)
- ◆ (2) H-F2510AC – Carbon Block Pre-filters (Stages 2 & 3)
- ◆ (1) M-T1812A50 – 50 GPD Reverse Osmosis Membrane (Stage 4)
- ◆ (1) H-F1032-43A – Carbon Post-Filter (Stage 5) with QC adapters

RFK-5-100 – Replacement Membrane & Filter Pack

With 100 GPD Membrane - *Includes:*

- ◆ (1) H-F1005CF – 5 Micron Sediment Prefilter (Stage 1)
- ◆ (2) H-F2510AC – Carbon Block Pre-filters (Stages 2 & 3)
- ◆ (1) M-T1812A100 – 100 GPD Reverse Osmosis Membrane (Stage 4)
- ◆ (1) H-F1032-43A – Carbon Post-Filter (Stage 5) with QC adapters

RFK-5-50 – Year Pack for 50 GPD System

Includes 1 Year Supply of Membranes and Filters:

- ◆ (2) H-F1005CF – 5 Micron Sediment Prefilter (Stage 1)
- ◆ (4) H-F2510AC – Carbon Block Pre-filters (Stages 2 & 3)
- ◆ (1) M-T1812A50 – 50 GPD Reverse Osmosis Membrane (Stage 4)
- ◆ (1) H-F1032-43A – Carbon Post-Filter (Stage 5) with QC adapters

RFK-5-100 – Year Pack for 100 GPD System

Includes 1 Year Supply of Membranes and Filters:

- ◆ (2) H-F1005CF – 5 Micron Sediment Prefilter (Stage 1)
- ◆ (4) H-F2510AC – Carbon Block Pre-filters (Stages 2 & 3)
- ◆ (1) M-T1812A100 – 100 GPD Reverse Osmosis Membrane (Stage 4)
- ◆ (1) H-F1032-43A – Carbon Post-Filter (Stage 5) with QC adapters

Additional Replacement Parts Ordering Information

- Storage tank	H-S4010ANW
- Clip for In-Line Filter to Membrane Housing	H-J2021KW
- Clip for Membrane Housing to Bracket	H-J2028PW
- Faucet (Non-Air Gap)	H-T5019
- Auto Shut-off valve	H-V1050W-QC
- Tank shut-off valve	PPSV500822W
- Check valve, in Elbow	H-V1003
- Filter bracket	H-B2030W

- Tubing	H-TU6025W
- Hex Nipple (connects filter housings)	F-0725-015
- Union Tee Fitting	F-4UT44QC
- 1/4" Male adapters (included in kit)	AMC 0404
- 1/4"x1/8" Elbow for Membrane Housing	F-4ME2QC
- 1/4" Elbow for Filter Housing	F-4ME4QC
- Feed Adapter and Ball Valve Kit	H-V1009
- Drain saddle	H-D3000M