

# 中文



## GAN356 i carry S 使用说明书



感谢选择 GAN 智能魔方

### 使用前必读

1. 本产品内置智能动态捕捉系统跟踪魔方动态，魔方各方面的位置不可随意调换。
2. 调整弹力时请勿左右晃动轴心，以免损坏内部电路。
3. 白色面红灯闪烁代表电量低，请及时更换电池。

\*使用产品前请仔细阅读并妥善保存

### 产品配置

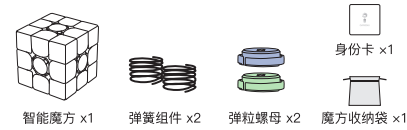

### 基本参数

产品型号	GAN356 i carry S	产品尺寸	56x56x56mm
产品重量	约 81g	电池类型	LR44 纽扣电池
续航时长	约 330h*	连接方式	蓝牙无线连接
设备要求	支持 IOS 9.0 及以上、Android 4.4 及以上版本的设备		

\*实验室测试数据，实际续航时长视使用而定。

### 上手步骤

1. 下载安装 APP “Cube Station”。



2. 转动魔方任意面唤醒魔方(即白色面白灯闪烁)。

\*唤醒后可连接 APP 查看电量。

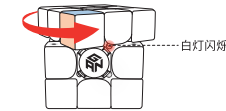

3. 打开手机蓝牙及 APP，根据 APP 提示连接魔方。

\*智能产品可能会因软件版本迭代而产生功能差异，具体以实际产品为准。

### 电池更换

白色面红灯闪烁代表电池电量低，为免数据丢失，请及时更换电池。更换步骤如下：

1. 黄色面朝上（且操作全程均保持朝上），拆开整个魔方，取出球轴，并用小螺丝刀拧下球轴的四颗螺丝。
2. 将球轴半圆外壳取下，同时更换两颗电池（负极朝上）。
3. 将球轴半圆外壳盖回，重新拧紧四颗螺丝，组装好魔方。

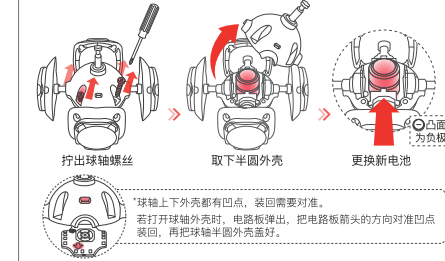

### 弹力调试

1. 掀开中心盖。
2. 取出弹粒：按压弹粒到底，旋转轴端卡针 90°，弹粒弹出，缓慢松手，防止弹簧弹飞。
3. 更换弹粒：放入新弹粒，重复步骤 2，松手完成更换。
4. 盖上中心盖，依次更换剩余 5 面。

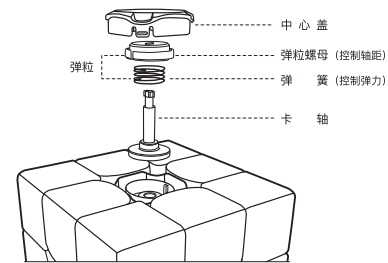

### 弹力参照表



螺母规格	弹珠规格	弹簧①	弹簧②	弹簧③
0.5 (透明)		2.1N	2.6N (出厂配置)	3.2N
0.6 (透绿)		2.0N	2.5N	3.1N
0.7 (透蓝)		1.9N	2.4N	3.0N

警告：请勿随意调换各面中心盖，以免影响 APP 识别魔方状态；调试弹力时请勿左右晃动轴心，以免损坏内部电路；调整弹力后需在 APP 上重置魔方。



### 注意事项

#### 连接 APP

- 每次连接前，请确保设备电量充足（即唤醒魔方后白色面无红灯闪烁）。
- 打开“Cube Station”APP，根据 APP 内提示连接魔方。连接后，APP 即可实时跟踪魔方状态。
- 魔方连接 APP 后，如 10 分钟内对两者无任何操作，魔方将自动断开蓝牙，进入休眠状态。
- 如魔方已被某台设备绑定，则需解除绑定后才能被另一台设备连接。魔方唤醒状态下，顺时针转动橙色面 5 圈（即转动 20 步），或在 APP 上点击“解除绑定”。

#### 使用限制

- 智能魔方为精密电子产品，请勿拆解内核球轴，否则可能导致产品损坏。
- 本产品不能遭受冲击、遇水或置于高于 60°C 的环境。
- 本产品内含小零件，请勿给 3 岁以下儿童使用。
- 请严格按照说明书提示使用产品，避免因操作不当导致设备损坏或人身伤害。

### 故障排除

#### 1. APP 无法检测到魔方？

- ① 请确认魔方电量充足。
- ② 请确认魔方处于唤醒状态。在未连接 APP 状态下，被唤醒的魔方 80 秒后将自动进入休眠状态。
- ③ 如魔方已被其他设备连接，则需断开后才能被另一台设备检测到。
- ④ 安卓设备请确认定位功能开启，并已授予 APP 定位权限。

#### 2. APP 显示的魔方状态不同步？

- ① 请确认魔方各方面的位置正确（参看“电池更换视频”）。
- ② 请通过 APP 的重置功能重置魔方状态。
- ③ 魔方电量低时，会自动休眠导致魔方状态无法同步，请尽快更换电池。

获取更多技术支持，请联系 support@gancube.com

# English



## GAN356 i carry S User Manual

Thank you for choosing the GAN356 i carry Smart Cube

### Read carefully before getting started

1. The product contains a built-in motion tracking system. Sides of the cube are NOT alterable.
2. DO NOT bend the core when adjusting tension, to prevent damage of the internal electrics.
3. Blinking red light in the white side indicates low battery. Please change battery in time.

\* Keep manual well for future reference.

### ACCESSORIES

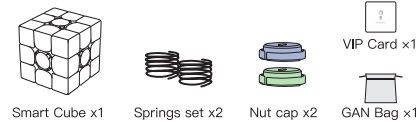

### SPECIFICATIONS

Model	GAN356 i carry S	Product size	56×56×56mm
Product weight	≈81g	Battery type	LR44 button cell
Battery life	About 330h*	Connection	Bluetooth
Device requirement	IOS 9.0 Android 4.4 or above		

\* Lab test data. Actual battery life subject to actual usage.

### GETTING STARTED

1. Download and install APP "Cube Station".



2. Turn any side of the GAN356 i carry S to awake it (The white light in the white side will blink in case of successful awakening.).

\* Battery level will show in APP once connected.

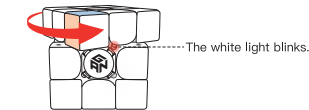

3. Enable your smart phone's Bluetooth function and open the APP; Connect the cube per instructions in the APP.

\*Smart products may have functional differences due to software version upgrade. Specific functions depend on the actual products.

### CHANGING BATTERY

The blinking red light in the white side indicates low battery. Please change the battery in time to avoid data loss.

#### Instruction of changing battery:

1. Keep the yellow side facing up during the whole procedure, take the cube apart and take out the core. Screw out 4 screws on the core.
2. Take out the semicircular shell. Replace 2 batteries with negative pole facing up.
3. Install the semicircular shell with 4 screws and reassemble the cube.

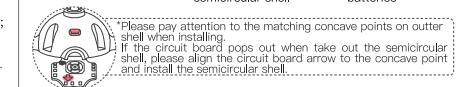
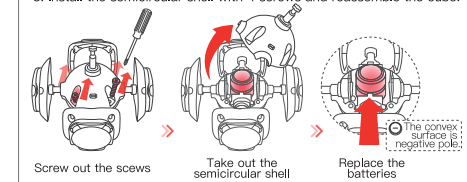

### TENSION ADJUSTMENT

1. Open the center cap.
2. Press the tension nut to the bottom and turn the core foot 90° to the release position, then take out the tension nut. Release slowly to prevent the spring from popping out.
3. Swap in the new tension nut and set it up properly (reverse step 2 operations).
4. Repeat on other sides.

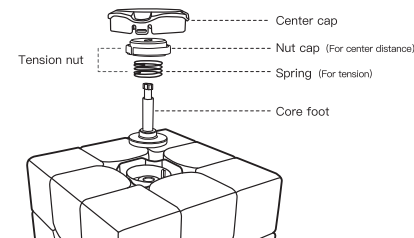

### Tension choices

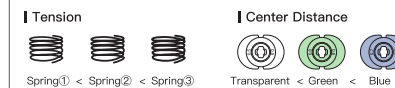

Nut cap	Spring		
	Spring①	Spring②	Spring③
0.5 (Transparent)	2.1N	2.6N (Default Value)	3.2N
0.6 (Green)	2.0N	2.5N	3.1N
0.7 (Blue)	1.9N	2.4N	3.0N

Warning: DO NOT alter the positions of center caps, this will lead to synchronization problems. DO NOT bend the core when adjusting tension, to prevent damage of the internal electrics. Resetting the cube is required after readjusting tension.



### MUST KNOWS

#### Connecting to APP

- Fully charge the cube before connecting (No blinking red light in the white side.).
- Install "Cube Station" APP and connect your cube per instructions in the APP. Once connected, the APP will be able to track GAN356 i carry's motion.
- The cube will automatically turn off its Bluetooth and enter sleep mode after being set aside for 10 minutes.
- Ensure the cube has not been bound already to another device. Rotating the orange side clockwise for 5 rounds (ie making turn for 20 times) or using "Unbind" option in the APP can unbind the cube.

#### Usage restrictions

- The smart cube contains electronic components. To prevent damage, DO NOT dismantle the core.
- DO NOT crash the product. Keep away from water or high temperature(≥60°C).
- Product contains small parts, NOT suitable for children under 36 months.
- Strictly follow manual to avoid product damage or bodily harm.

### TROUBLE-SHOOTING

#### 1. Failure of detecting the cube by APP?

- ① Ensure the cube has been fully charged.
- ② Ensure the cube has been awakened. Once disconnected from the APP, the cube will shut down automatically in 80 seconds.
- ③ Ensure the cube has not been connected already by another device.
- ④ Android users please ensure location access has been authorized to the APP.

#### 2. Cube position not synchronized in the APP?

- ① Ensure sides have not been altered from ex-factory positions. (Refer to the video instruction of "CHANGING BATTERY")
- ② Reset the cube via the "Reset Cube" functions in the APP.
- ③ The cube will shut down when battery is low. Change the battery timely.

More info & supports: support@gancube.com