



Skyhigh

Trampoline Ladder Instruction Manual

Trampoline Ladder

Before You Start

Read the Instruction Manual and Warnings in full

Please make sure you read the instruction manual and all warnings in full before you begin installing your trampoline ladder. Keep these instructions for future reference as they contain very important inspection and maintenance advice which will help you keep your trampoline ladder in a good and safe condition.



One pair of hands



Screwdriver (included)

Tools Required
Benötigtes Material / Accessoires / Herramientas
Strumenti da lavoro / Benodigdheden

Parts Included
Unterteile / Liste des pièces / Lista de partes
Elenco degli elementi / Onderdelen



part
1
Left & Right
Side Rails



part
2
U Shape
Bottom Rail



part
3
Steps
(x 2)



part
4
Screws & Nuts
(x4)

Warnings

Please read and understand the following warnings before installing and using your trampoline ladder

Warning! Maximum user weight is 100kg.

Warning! The trampoline ladder is intended for outdoor family/domestic use only.

Warning! The trampoline ladder should be assembled by an adult in accordance with the assembly instructions and thereafter checked before the first use to ensure it is correctly attached and the screws are tight.

Warning! This ladder is not suitable for children under 3 years.

Warning! Young children should not use unless supervised by an adult.

Warning! Improper use of this ladder can cause injury.

Warning! Remove ladder when trampoline is not in use to prevent young children from climbing onto the trampoline.

Warning! Do not exit the trampoline with a jump - do not jump on or off this ladder while exiting the trampoline or climbing onto the trampoline.

Inspection & Maintenance

It is important you make regular safety checks on your trampoline ladder ideally before each use.



Steps and Side Rails

Make sure the steps are securely in place and are not excessively worn. Make sure the steps are clean and dry before use. Check the side rails for rust and wear and tear. Make sure the screws are tight and the steps are in the correct positions.

Attachment to the Trampoline

Make sure the hooks on the ladder are firmly hooked onto the trampoline.

Place pressure on the steps to ensure it is sitting firmly on the ground and the steps are securely in place before use.

1

Assembling the Top Step

You will need:

Left and Right Side Rails (part 1)

Step (part 3)

Bolts and Nuts x 2 (part 4)

Take a seat! No really - you might find this part easiest sitting down on a chair or on the floor!

Take one of the side rails and turn it so the hook is at the top and facing away from you. Slide the first step onto the side rail. The wider/fatter part of the step should be on the same side as the hook (if the hook is facing away from you, the slope of the step should be coming towards you).

Making sure the holes in the side rail and step are lined up, turn the step and rail upside down - you need to drop the nut into the rectangular hole next to the pole - see Fig 1.

To ensure the nut is the correct way round, make sure the flat/threaded side is facing outwards towards the pole. The side containing the plastic stopper should face away from the pole.

You will need to put the bolt through the hole in the step then the side rail to secure the step in place. It may take a little bit of movement to get the bolt in position.

Use the screwdriver to tighten the bolt (this will screw into the nut that you placed into the hole) until it is secured - see Fig 2. Make sure the bolt has been screwed all the way in!

Repeat this process for the other side.

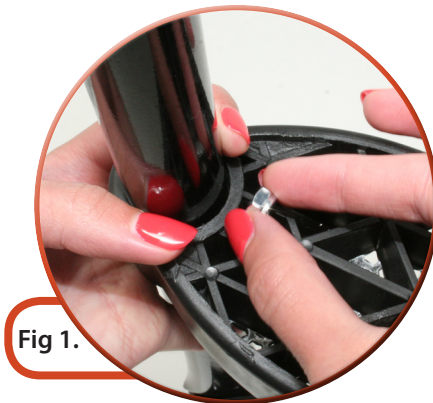

Fig 1.

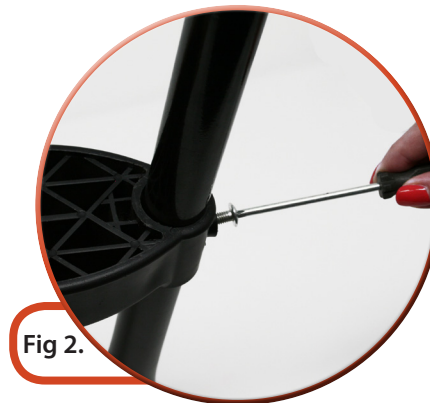

Fig 2.

2

Assembling the Bottom Step

You will need:

Left and Right Side Rails & Top Step (as assembled in step 1)

Step (part 3)

U Shaped Bottom Rail (part 2)

Bolts and Nuts x 2 (part 4)

With the top step in place slide the bottom step onto the side rails so the two are touching. Make sure it is the same way round as the top step (with the slant towards you and the hooks away from you).

Insert the side rails into the U Shaped Bottom Rail of the ladder (part 2).

The best way to do this is to line them up on both sides before you push them in.

Pull the second step down into place (in line with the holes on the side rails) and repeat step 2 to secure it in place.

Check the ladder to make sure all the screws are nice and tight and in position.

The ladder is ready to use! Lift the pads on your trampoline and use the hook at the top to securely attach the ladder to the frame of your trampoline.

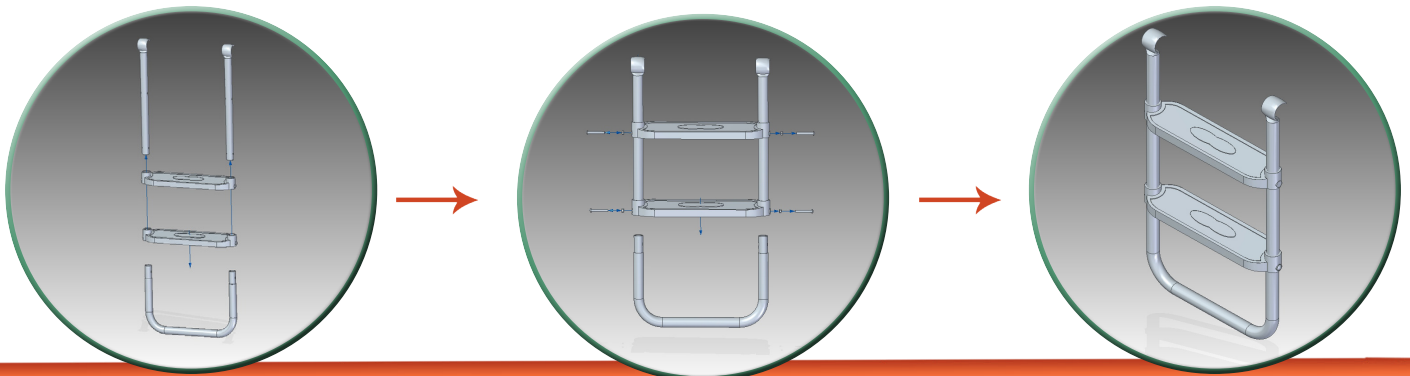



Warning!

 For family domestic use only. Not suitable for children under 3 years / 36 months because of small parts which could be a choking hazard. To be used under the supervision of an adult.

 Warnung! Nur für den häuslichen Gebrauch. Für Kinder unter 3 Jahren / 36 Monaten der Deckel ist nicht geeignet, wegen verschluckbare Kleinteile. Durch verschluckbare Kleinteile besteht Erstickungsgefahr. Nur unter der direkten Aufsicht eines Erwachsenen benutzen. Bei der Montage des

 Attention! Exclusivement à usage familial. Ne convient pas aux enfants de moins de 3 ans / 36 mois, présence de petits éléments susceptibles d'être ingérés ou inhalés - risque d'étouffement.. À utiliser sous la surveillance rapprochée d'un adulte.

 ¡Advertencia! Exclusivamente para uso doméstico. No conveniente para menores de 3 años / 36 meses - partes pequeñas con riesgo de ingestión o inhalación - riesgo de atragantamiento.. Se utilizará exclusivamente bajo la vigilancia directa de una persona adulta.

 Attenzione! Solo per uso domestico. Non adatto ai bambini di età inferiore a 3 anni / 36 mesi - presenza di piccoli elementi suscettibili di ingestione o inalazione - pericolo di soffocamento.. Utilizzare sotto la sorveglianza diretta di un adulto.

 Waarschuwing! Alleen voor privé gebruik. Niet geschikt voor kinderen jonger dan 3 jaar / 36 maanden wegens kleine elementen met het risico op inslikken of inademen - verstikkingsgevaar. Alleen voor privé gebruiken onder toezicht van een volwassene.

Not just Trampolines...

You may or may not be aware that Skyhigh not only have a huge range of high quality trampolines but also a range of replacement parts and accessories.

Having been in the trampoline game for decades, we know that sometimes you will need to replace pads, mats and netting to keep your trampoline safe & looking newer for longer. We also know that being charged a lot for some replacement parts can be frustrating which is why we keep our costs as low as possible - so we can keep your kids jumping for longer!

Skyhigh Replacement
Beds



Skyhigh Enclosures



Skyhigh Trampoline
Tent



for more information on these and other products visit our website
www.skyhightrampolines.co.uk

The logo to look out for...

Garden Games Ltd. spreads much wider than the Skyhigh Trampoline brand. There are many more products we have created - look out for our Garden Games logo or flower emblem to be sure you have an official Garden Games Limited product. The brand is not just a logo, it is the whole family of ideas, service and quality that are behind every product.

We are not a huge corporate and do not claim to be - we are proud of who we are and what we create

so look out for our brand knowing that each product carrying our logo has a special standard we aim to maintain for years and years to come...



+441865 391060
sales@gardengames.com
skyhightrampolines.co.uk
gardengames.com
@GardenGamesLtd

Please retain for future reference 

The Skyhigh brand is owned by: Garden Games Limited
Holly House • Pine Woods Road • Longworth
Oxfordshire • OX13 5HG • England