

VeroLina Step Light Installation Guide



ATTENTION: Installation and electrical wiring must be performed by a professional to prevent hazards, including the risk of electrocution.



Step 1: Detach the wall Mounting Plate

Hold the fixture and gently pull the label on the back of the light to release the wall mounting plate from the magnetic fixture.

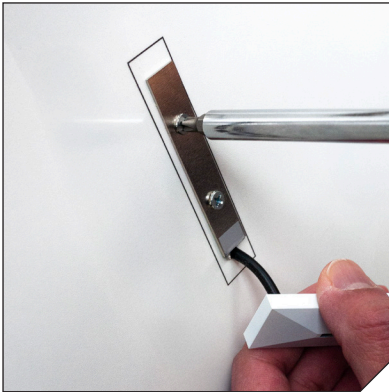

Step 2: Secure the Mounting Plate

Pass the power cable through the wall, then secure the mounting plate in your desired position and tighten it using the provided screws to fasten it securely in place.



Magnetic Fastening



Step 3: Connect the Wiring and Attach the Fixture

Connect the black (-) and red (+) 24V DC wires to the power supply. Next, align the fixture with the mounted plate, ensuring it is properly positioned and securely attached magnetically.