

Max. Amp: 12V - 5A / 24V - 4A

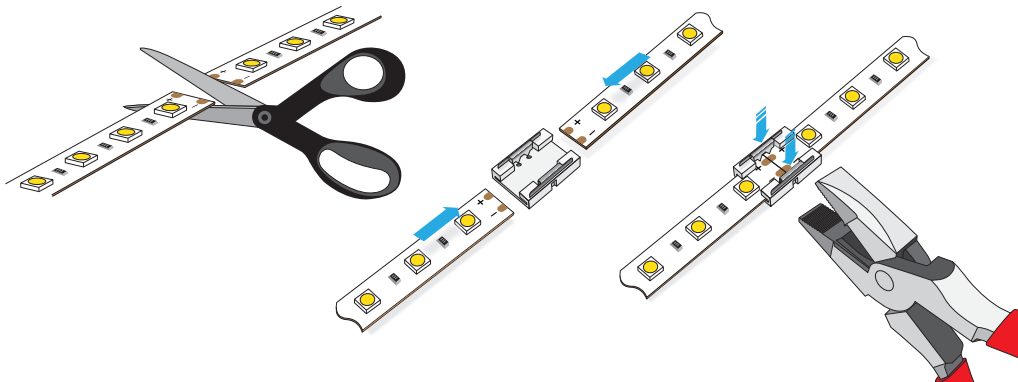

1 CUT STRIP LIGHT
AT CUTTING POINT

2 INSERT STRIP LIGHT
FROM BOTH ENDS INTO
THE CONNECTOR

3 PUSH DOWN METAL PLATES
ON BOTH SIDES TO SECURE
THE CONNECTION