

# VINdustry Wine Pegs & Panel Kits

*Rectangular panel LED light and stand-off plywood installation*

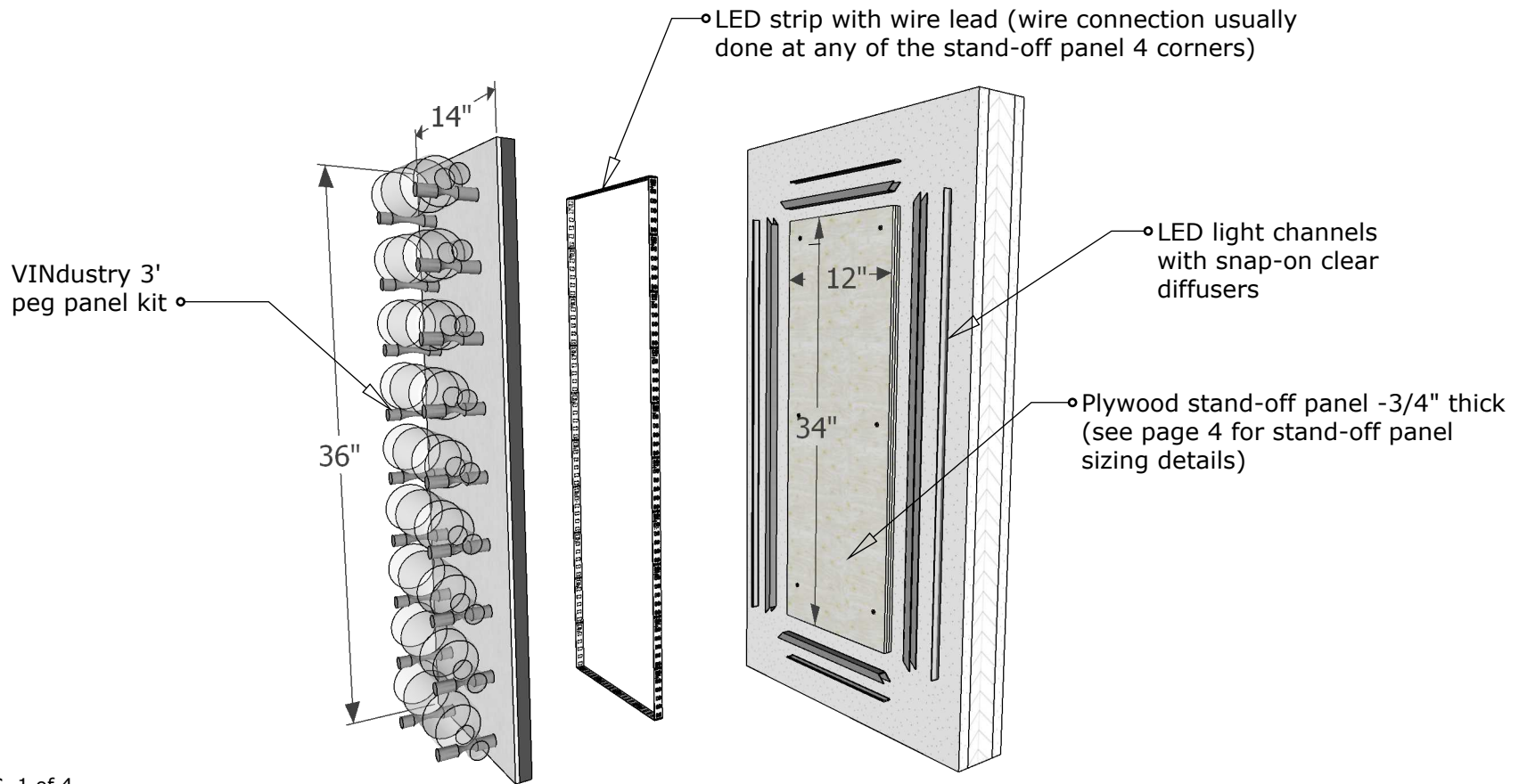

PG. 1 of 4  
(parts breakdown)

**Blue Grouse Wine Cellars**

604.929.3180  
1.888.400.CORK(2675)



# VINdustry Wine Pegs & Panel Kits

*Rectangular panel LED light and stand-off plywood installation*

## Step 1

Install pre-cut plywood panel,  
use a level to ensure level  
installation  
Plywood should be  
screwed to wall studs or using  
appropriate anchors/screws

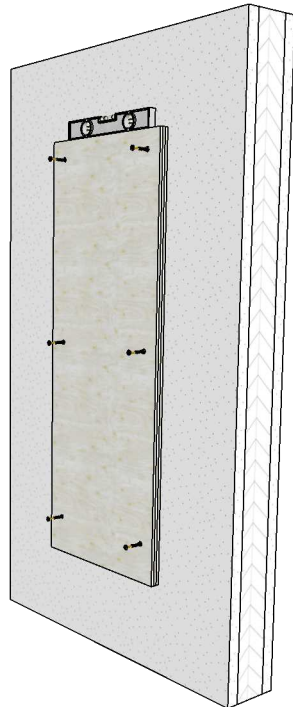

## Step 2

Cut LED channels to size and  
glue to 4 plywood edges using  
instant glue or double sided tape

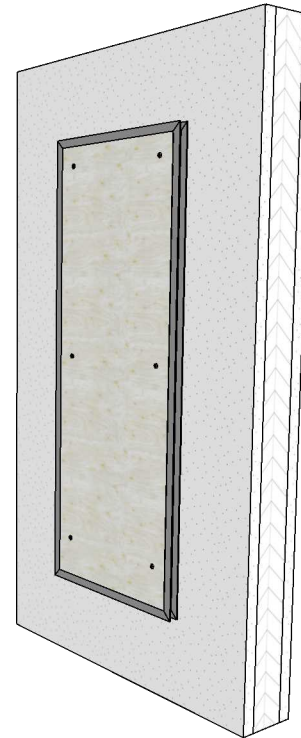

PG. 2 of 4  
(installation)

**Blue Grouse Wine Cellars**

604.929.3180

1.888.400.CORK(2675)



# VINdustry Wine Pegs & Panel Kits

*Rectangular panel LED light and stand-off plywood installation*

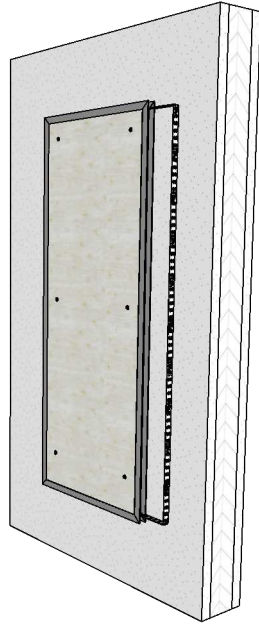

### Step 3

Connect wire lead to LED driver's wires, LED strips come with adhesive, glue carefully all around the bottom of channels in a continuous run

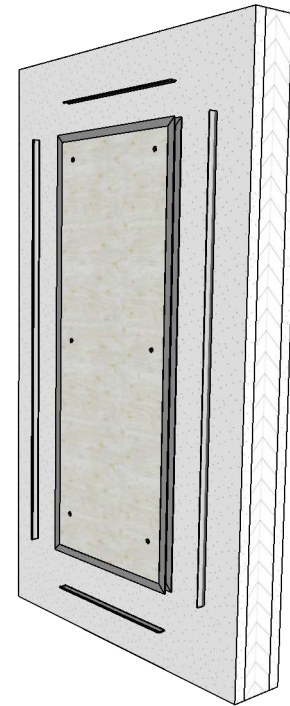

### Step 4

Cut clear diffusers to size and snap into installed channels

### Step 5

Install VINdustry rectangular peg panel  
(Follow peg panel's installation instructions)

PG. 3 of 4  
(installation)

**Blue Grouse Wine Cellars**

604.929.3180

1.888.400.CORK(2675)



# VINdustry Wine Pegs & Panel Kits

*Rectangular panel LED light and stand-off plywood installation*

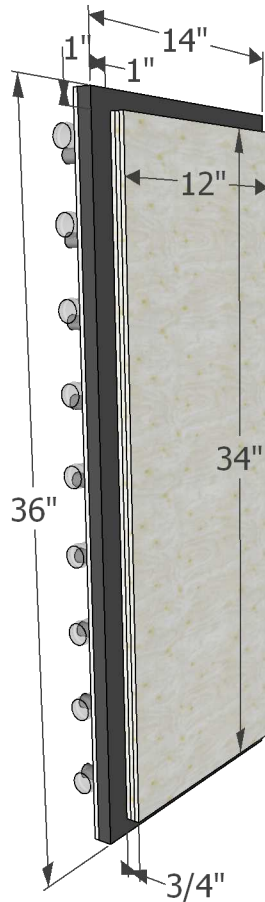

### 3' VINdustry panel

LED stand-off panel to be  
1" - 1 1/4" shorter on all  
sides than peg panel  
Length of LED strip required -8'

PG. 4 of 4  
(LED plywood stand-off panel sizing details)

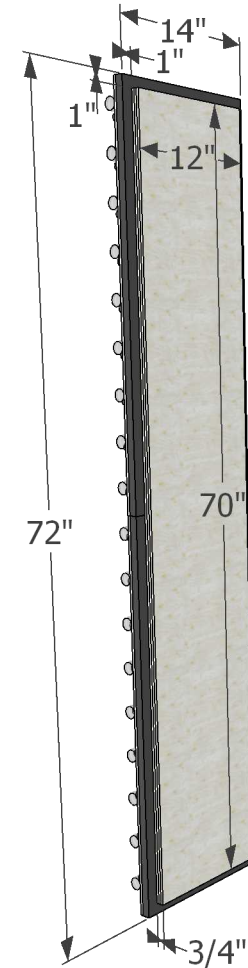

### 6' VINdustry panel (two 3' panels stacked)

LED stand-off panel to be  
1" - 1 1/4" shorter on all  
sides than peg panel  
Length of LED strip required -14'

**Blue Grouse Wine Cellars**

604.929.3180  
1.888.400.CORK(2675)

