

# NON-SLIP Square on Square 6" Trim Tool

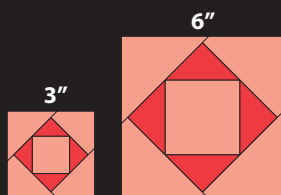

Create 3" or 6" square on square blocks. No calculations - the cutting measurements are printed right on the tool. Trimming each round as triangles are added creates perfect blocks!

**Designed by Jean Ann Wright**

#CGRJAW7  
Made in USA



SEE A DEMO  
SCAN WITH ANY  
QR READER



Creative Grids® USA, Inc.  
400 W. Dussel Dr. Ste B,  
Maumee, OH 43537  
www.creativegridsUSA.com

Creative Grids® UK, Ltd.  
Unit 23A Pate Road  
Leicester Road Industrial Estate  
Melton Mowbray  
Leicestershire, LE13 0RG England  
www.creativegrids.com

Creative Grids is covered by U.S. Trademark Registration No. 2,796,615

## NON-SLIP Square on Square 6" Trim Tool

Make a variety of 6" Square on Square blocks (or 3" bonus blocks) by following the cutting chart printed on the tool. Add the triangles sequentially to the square - then trim each round for perfect piecing!

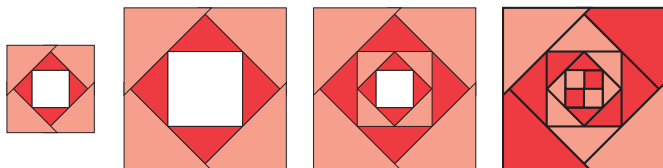

### For a 3" finished block

#### Step A-1

Center and sew the Block A-1 triangles to opposite sides of the center square. Press. Add the remaining two triangles to the other two sides. Press. Place the square marked A-1 on the ruler on top of the fabric center square. Trim two adjoining sides. Turn the partially trimmed unit a half turn (180°) then trim the remaining two sides.

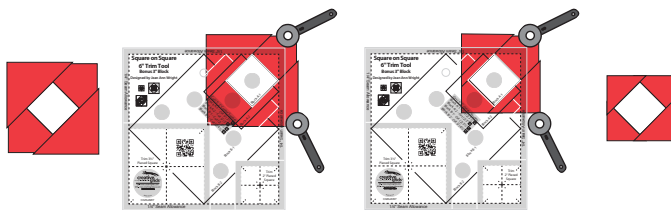

*Tip: If the sewn square does not fit exactly into the alignment square on the tool, be sure you match the two corners. This assures a 1/4" seam allowance.*

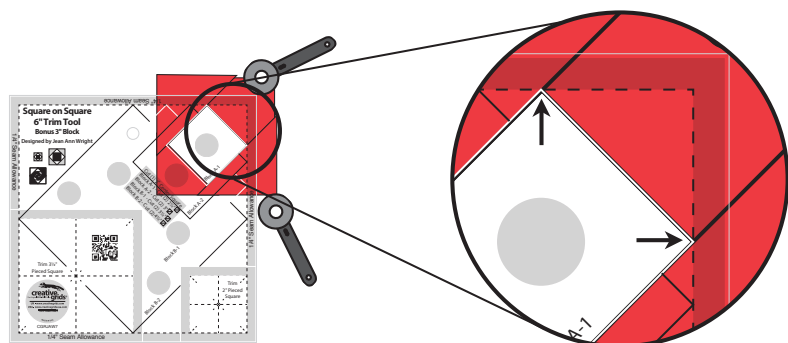

# NON-SLIP Square on Square 6" Trim Tool

## Step A-2

Center and sew the Block A-2 triangles to opposite sides of the pieced square. Press. Add the remaining two triangles to the other two sides. Press. Place the square marked A-2 on the ruler on top of the fabric center square. Trim two adjoining sides. Turn the partially trimmed unit a half turn (180°) then trim the remaining two sides.

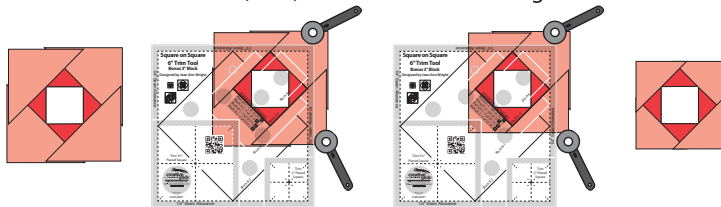

**Note:** The Square on Square block now measures 3 1/2" (3" finished). Continue with Steps B-1 and B-2 to create a 6" finished block. You may also choose to START with step B-1 - simply use a 3 1/2" fabric square (or pieced square) in the center.

## For a 6" finished block

### Step B-1

Center and sew the Block B-1 triangles to opposite sides of the center square. Press. Add the remaining two triangles to the other two sides. Press. Place the square marked B-1 on the ruler on the fabric center square. Trim two adjoining sides. Turn the partially trimmed unit a half turn (180°) then trim the remaining two sides.

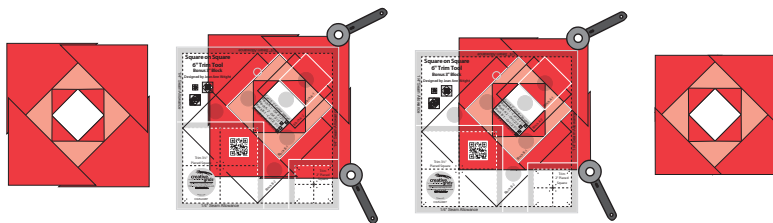

### Step B-2

Center and sew the Block B-2 triangles to opposite sides of the center square. Press. Add the remaining two triangles to the other two sides. Press. Place the square marked B-2 on the ruler on the fabric center square. Trim two adjoining sides. Turn the partially trimmed unit a half turn (180°) then trim the remaining two sides.

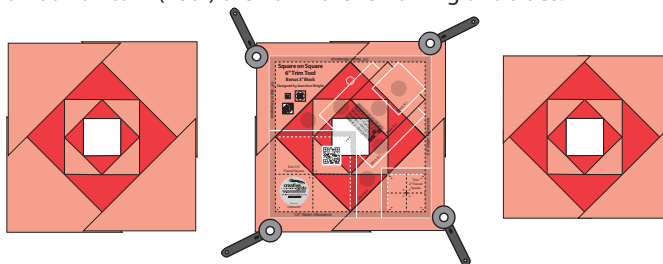

## Center Cutting / Trimming To Size

**2" Four-Patch** - cut (4) 1 1/2" squares **3 1/2" Four-Patch** - cut (4) 2 1/2" squares

**2" Hourglass Square** - cut (2) 3" squares, then cut in half on diagonal twice.

**3 1/2" Hourglass** - cut (2) 4 1/2" squares, then cut in half on diagonal twice.

**3 1/2" Pinwheel** - cut (2) 3" squares, then cut in half on diagonal once.

### Snail's Trail Block

A Snail's Trail block can be created by simply changing the colors of the triangles.



Trimming  
2" Center

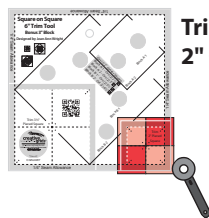

Trimming  
3 1/2" Center

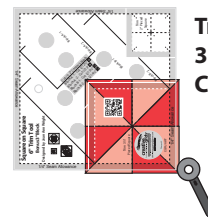

**creative grids**  
The Original NON-SLIP Ruler



Creative Grids is covered by U.S. Trademark Registration No. 2,796,615

08.25.15.1