

## Parts List

- A** Nesting Buckles
- B** Back pad
- C** Neck straps
- D** Chest pad
- E** Seatbelt restraint straps

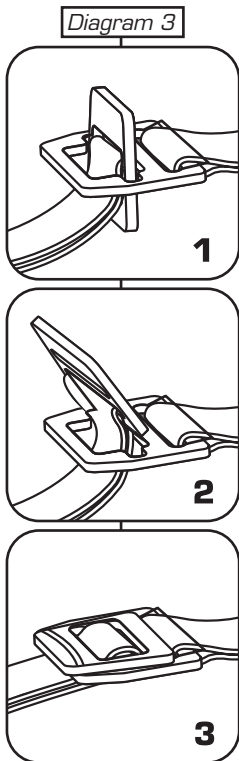
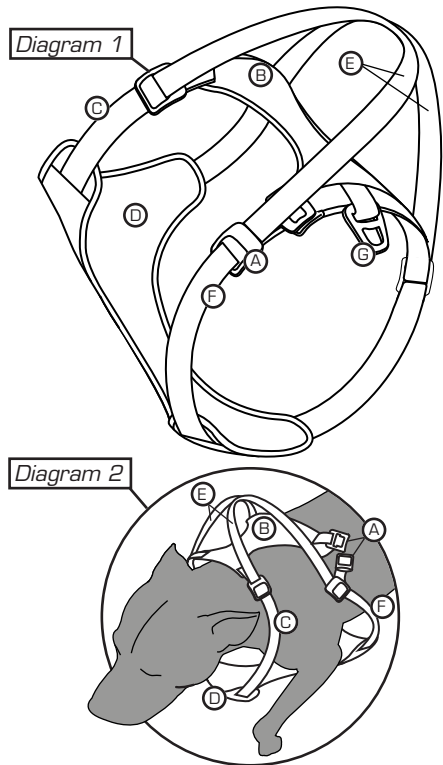

## Putting on the harness (Diagram 2)

1. Release the nesting buckles (A) and loosen the straps enough to easily fit over your dog.
2. Pull the harness over your dog, passing his head through the neck straps (C). The back pad (B) should be on his back and the chest pad (D) should be centered on the dog's chest.
3. One at a time pull your dog's front legs through the loops formed by the restraint and chest straps (E & F). Re-fasten the nesting buckles (A).
4. Adjust all straps for a snug fit.

## Using the seatbelt harness:

Load your pup into the backseat and have them sit. Pull the seatbelt down and pass it through both of the restraint straps. Connect seatbelt as normal to secure.

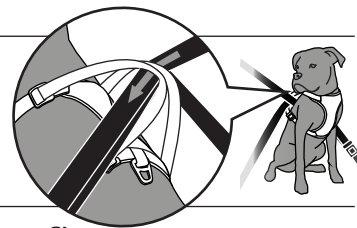

## Using the nesting buckles (Diagram 3)

1. With the larger piece of the nesting buckle system on top and the grip area of the smaller piece facing up, pass the smaller piece up through the larger piece.
2. Pull the smaller piece all the way through the larger piece as shown.
3. Pull flat and snug the straps for a secure fit.

## Cleaning Instructions:

Our product cleaning instructions will help ensure that your gear has a long, exciting life. Washing by hand and hang air-drying is the best way to care for your Kurgo products.

## Notice:

Please contact Kurgo directly with any product or warranty inquiries.

# FR - IMPACT HARNESS | INSTRUCTIONS ET ENTRETIEN

## Pièces clés

- A** Boucles imbriquées
- B** Dossieret
- C** Sangles de cou supérieures
- D** Plastron
- E** Courroies de retenue pour ceinture
- F** Sangles de poitrine inférieures
- G** Anneau en D arrière

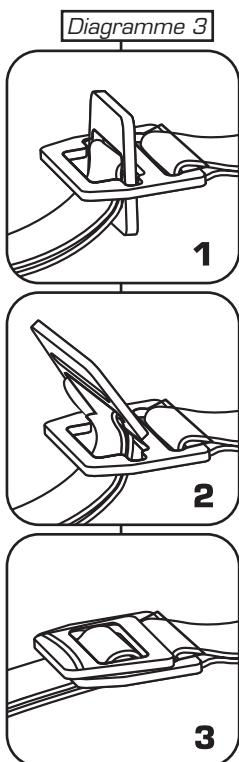
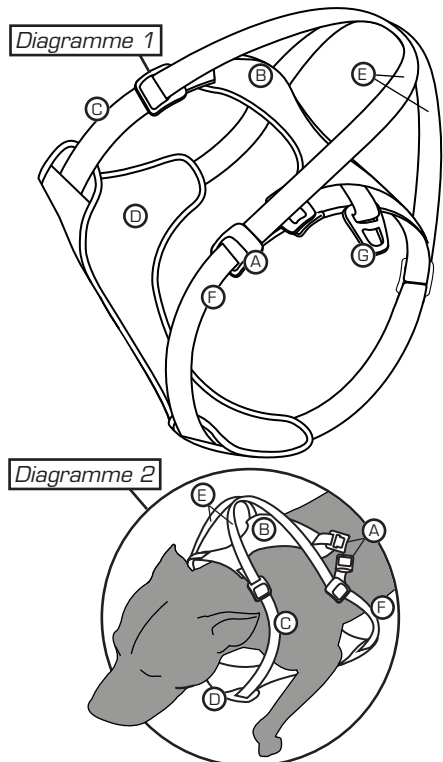

## Mettre le harnais: (Diagramme 2)

1. Détachez les boucles imbriquées (A) et desserrez suffisamment les sangles pour qu'elles passent facilement par-dessus votre chien.
2. Passez le harnais par-dessus votre chien en faisant passer sa tête par les sangles de cou (C). Le dossieret (B) devrait être sur son dos et le plastron (D) devrait être centré sur le poitrail de votre chien.
3. En procédant une patte à la fois, faites passer les pattes avant de votre chien dans les boucles formées par les courroies de retenue et les sangles de poitrine (E et F). Rattachez les boucles imbriquées (A).
4. Ajustez bien toutes les sangles.

## Pour utiliser le harnais pour ceinture de sécurité:

Faites monter votre chien sur le siège arrière et faites-le s'asseoir. Tirez la ceinture vers le bas et faites-la passer dans les deux courroies de retenue (reportez-vous à la clé des pièces). Bouclez la ceinture comme à l'habitude pour sécuriser le tout.

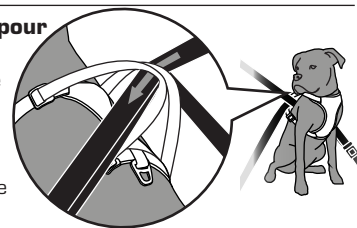

## Attacher à l'aide des boucles imbriquées: (Diagramme 3)

1. En positionnant la plus grande pièce du système de boucles imbriquées sur le dessus et la zone de prise de la pièce la plus petite vers le haut, insérez la petite pièce dans la grande pièce.
2. Insérez la petite pièce entièrement dans la grande pièce, tel qu'illustré.
3. Tirez sur les sangles pour qu'elles soient à plat et bien ajustées.

## Instructions de Lavage

Nos instructions de nettoyage des produits vous assurent que votre équipement aura une longue durée de vie. Laver à la main et suspendre pour sécher sont les meilleurs moyens de prendre soin de vos produits Kurgo.

## Avis:

Veuillez communiquer toute demande relative aux produits ou au garantie directement à Kurgo.

# DE - IMPACT HARNESS | ANLEITUNGEN UND PFLEGE

## Stückliste:

- A** Nesting Buckles
- B** Back pad
- C** Neck straps
- D** Chest pad
- E** Seatbelt restraint straps
- F** Chest Straps
- G** Rear D-ring

Diagram 1

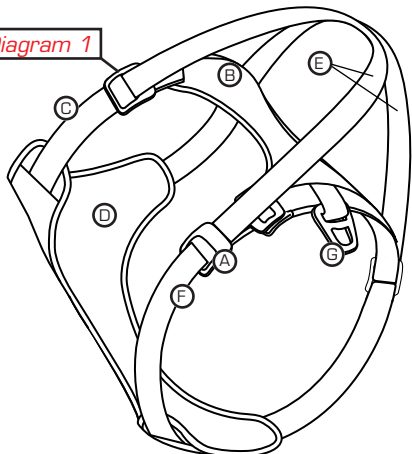

Diagram 2

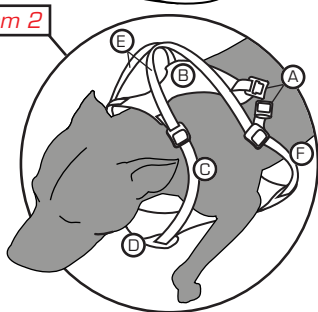
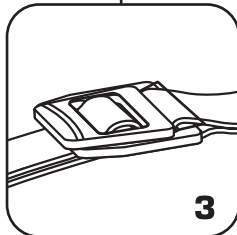
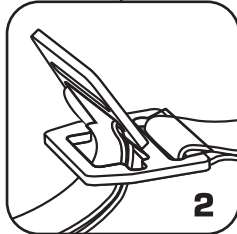
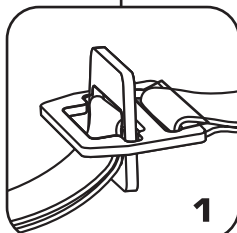

Diagram 3



## Putting on the harness (Diagram 2)

1. Release the nesting buckles (A) and loosen the straps enough to easily fit over your dog.
2. Pull the harness over your dog, passing his head through the neck straps (C). The back pad (B) should be on his back and the chest pad (D) should be centered on the dog's chest.
3. One at a time pull your dog's front legs through the loops formed by the restraint and chest straps (E & F). Re-fasten the nesting buckles (A).
4. Adjust all straps for a snug fit.

## Using the seatbelt harness:

Load your pup into the backseat and have them sit. Pull the seatbelt down and pass it through both of the restraint straps. Connect seatbelt as normal to secure.

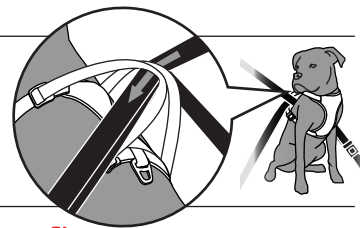

## Using the nesting buckles (Diagram 3)

1. With the larger piece of the nesting buckle system on top and the grip area of the smaller piece facing up, pass the smaller piece up through the larger piece.
2. Pull the smaller piece all the way through the larger piece as shown.
3. Pull flat and snug the straps for a secure fit.

## Reinigungsanleitungen:



Die Reinigungsanleitungen für unsere Produkte helfen dabei, dass sich Ihre Teile einer langen aufregenden Lebensdauer erfreuen. Waschen von Hand und Aufhängen zum Trocknen stellt die beste Art und Weise dar; Ihre Kurgo-Produkte zu pflegen.

## Hinweis:

Bitte wenden Sie sich bezüglich jedweder Produkt- oder Garantieforderungen direkt an Kurgo.

# ES - IMPACT HARNESS | INSTRUCCIONES Y CUIDADO

## Listado de piezas:

- A** Nesting Buckles
- B** Back pad
- C** Neck straps
- D** Chest pad
- E** Seatbelt restraint straps
- F** Chest Straps
- G** Rear D-ring

Diagram 1

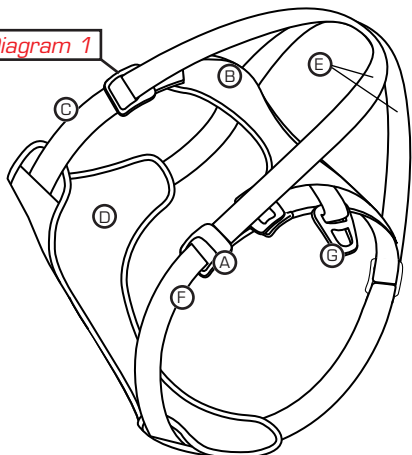

Diagram 2

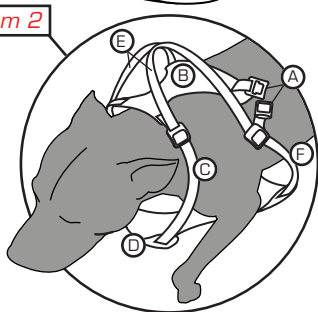
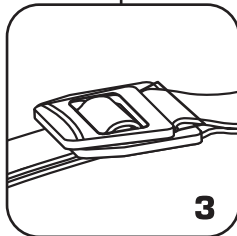
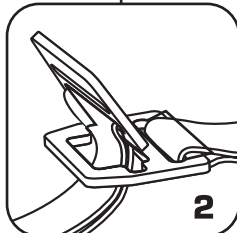
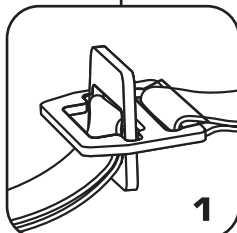

Diagram 3



## Putting on the harness (Diagram 2)

1. Release the nesting buckles (A) and loosen the straps enough to easily fit over your dog.
2. Pull the harness over your dog, passing his head through the neck straps (C). The back pad (B) should be on his back and the chest pad (D) should be centered on the dog's chest.
3. One at a time pull your dog's front legs through the loops formed by the restraint and chest straps (E & F). Re-fasten the nesting buckles (A).
4. Adjust all straps for a snug fit.

## Using the seatbelt harness:

Load your pup into the backseat and have them sit. Pull the seatbelt down and pass it through both of the restraint straps. Connect seatbelt as normal to secure.

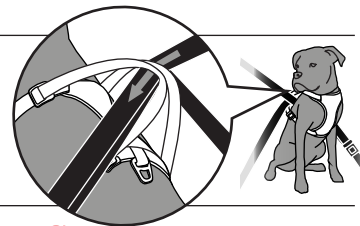

## Using the nesting buckles (Diagram 3)

1. With the larger piece of the nesting buckle system on top and the grip area of the smaller piece facing up, pass the smaller piece up through the larger piece.
2. Pull the smaller piece all the way through the larger piece as shown.
3. Pull flat and snug the straps for a secure fit.

## Instrucciones para la limpieza:



Nuestras instrucciones de limpieza del producto le ayudarán a garantizar una estimulante y larga vida del equipo. La mejor manera de cuidar los productos Kurgo es lavarlos a mano y secarlos al aire.

## Aviso:

Comuníquese con Kurgo directamente con cualquier producto o consulta de garantía.

