

# PS 1224HD POWER Start™

12V/24V Heavy Duty Booster Pack

**Ideally suited for mixed fleets of 12V and 24V vehicles, where the majority of use is on larger 24V vehicles.**

**1 CABLES & CLAMPS**  
50mm<sup>2</sup> welding grade cables with fully insulated cable clamps

**2 DOUBLE SKINNED CASE**  
For increased durability

**3 MAIN SWITCH**  
Key operated main switch

**POLARITY WARNING**  
Audible reverse polarity warning buzzer

**SPIKE PROTECTION**  
Prevents damage to onboard circuitry when jump-starting

**DESIGNED & MANUFACTURED IN THE UK**

**2 YEAR WARRANTY**  
With full in-house after sales service



**TECHNICAL SPECIFICATION**

Battery	2 x 28Ah
Voltage	12V+24V DC
Cranking Amps*	1100A/1100A
Peak Amps**	3500A
Safety fuse	500A
Weight (kg)	26

**FULL RANGE AVAILABLE**



\* The maximum current that can be drawn from a battery during cranking for a specified period of time, at a specified temperature & to a specified end of discharge voltage.  
\*\* The absolute peak instantaneous current measured during a discharge into the equivalent of a short circuit.

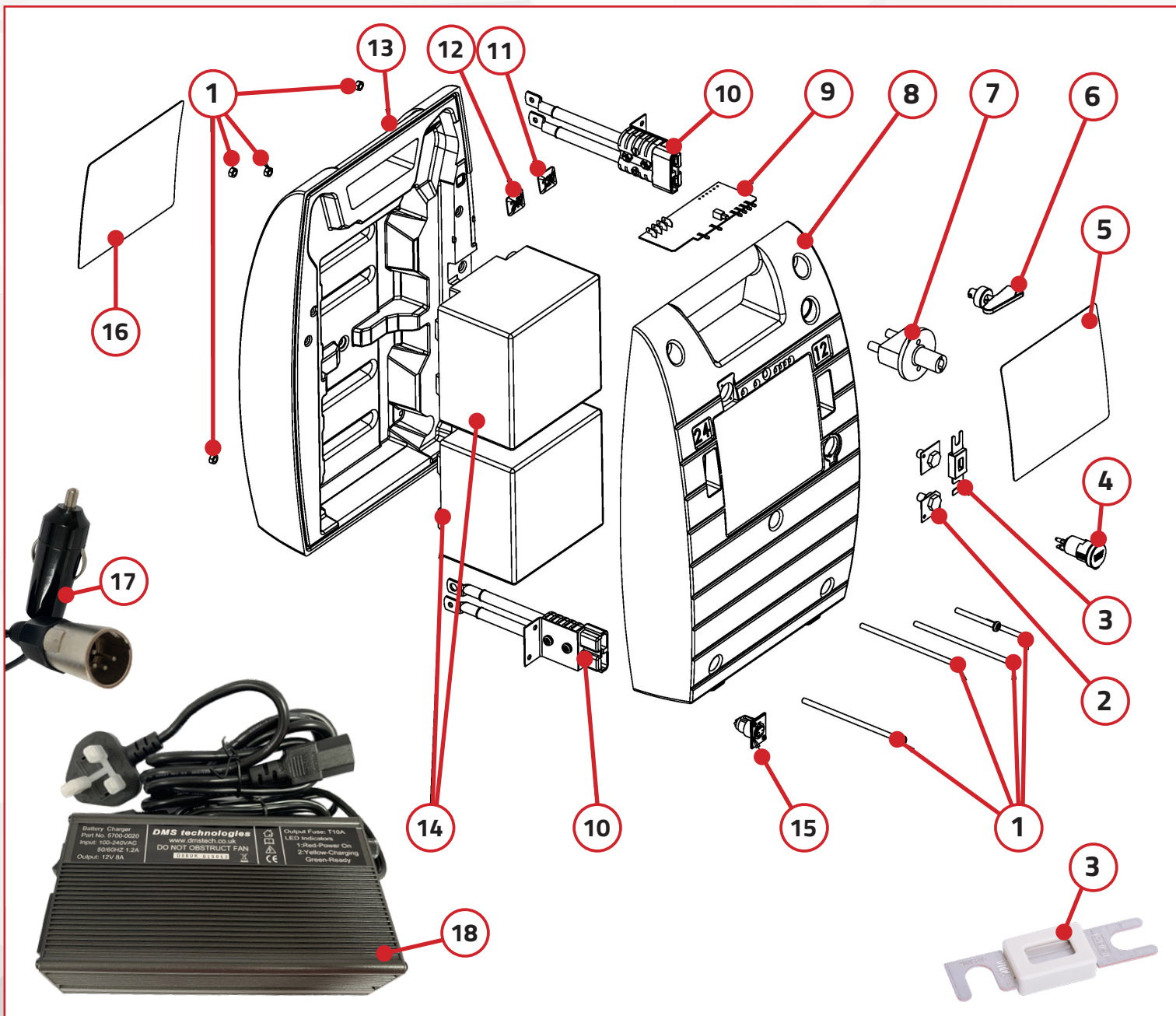

NO.	PART NO.	DESCRIPTION
1	N/A	Powerstart Case Bolts & Nuts
2	N/A	Powerstart Fuse Mounts
3	K212-F052	Powerstart 500A Ceramic Fuse
4	K205-C210	Powerstart 12V Cigar Socket
5	7500-0134	Powerstart Front Housing Label
6	K201-K002	Powerstart Switch Key
7	K212-S013	Powerstart Switch
8	*	Powerstart Front Housing
9	K212-P054	Powerstart Printed Circuit Board (PCB)
10	K205-C243	Powerstart 25mm Red Connector Socket (Internal)
11	PS-12LABEL	Powerstart 12V Output Socket Label
12	PS-24LABEL	Powerstart 24V Output Socket Label

NO.	PART NO.	DESCRIPTION
13	*	Powerstart Rear Housing
8 & 13	7254-0015	Powerstart Front & Rear Housing Set
14	7065-0018	Powerstart 12V 28Ah Red Flash Battery
15	K205-L034	Powerstart 4-Pole XLR Charge Socket
16	7500-0135	Powerstart Rear Housing Label
*	HD-Loom-BOM	Powerstart Internal Loom Set
*	K212-C103	Powerstart Positive (Red) Clamp
*	K212-C104	Powerstart Negative (Black) Clamp
*	K205-C221	Powerstart 50mm Red Connector Plug (External)
*	K703-K695-BOM	Powerstart 1.7m Lead & Clamp Assembly
17	K703-K701	Powerstart 12V Cigar to XLR Charge Lead
18	7700-0020(UK)	Powerstart 12V 8Ah 3 Stage Charger

PLEASE NOTE PARTS HIGHLIGHTED IN GREY SHOULD ONLY BE FITTED BY AN AUTHORISED OR QUALIFIED SERVICE AGENT, FITTING OF SUCH PARTS BY ANYONE OTHER THAN THE SERENCO SERVICE CENTRE MAY INVALIDATE YOUR WARRANTY. SERENCO (UK) LTD OFFER A FULL IN-HOUSE AFTER SALES SERVICE. PRICES QUOTED ARE CORRECT AT TIME OF GOING TO PRESS AND ARE SUBJECT TO VAT AND CARRIAGE.