

SIRUBA PARTS LIST	Series	Parts Group	Subclass / Remark	Page
	700Qe/988Qe	BKS-A2		2/2
				Date
				2015/08/11

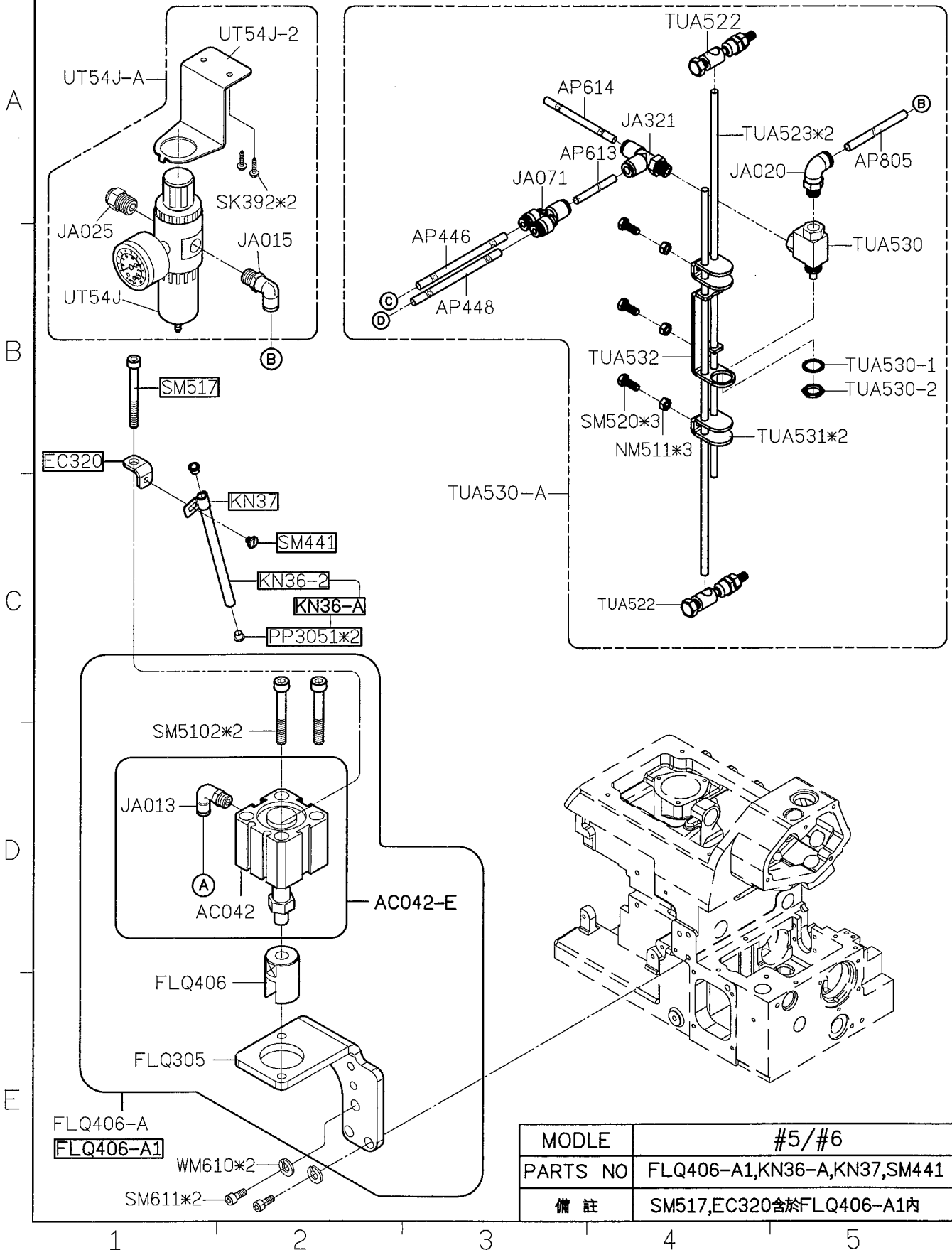

MODLE	#5/#6
PARTS NO	FLQ406-A1,KN36-A,KN37,SM441
備註	SM517,EC320含於FLQ406-A1内

SIRUBA PARTS LIST	Series	Parts Group	Subclass / Remark	Page
	拷克 Overlock	TUA-31	Note 註記: 1) ★ Before installation, please check one side is Air IN, another side is Air OUT. 2) 空氣有效使用壓力 Effective air pressure: 4~6 kg/cm 3) 請適度修剪管子長度, 以達到風力最佳效能。	1/1 Date 2016/11/02

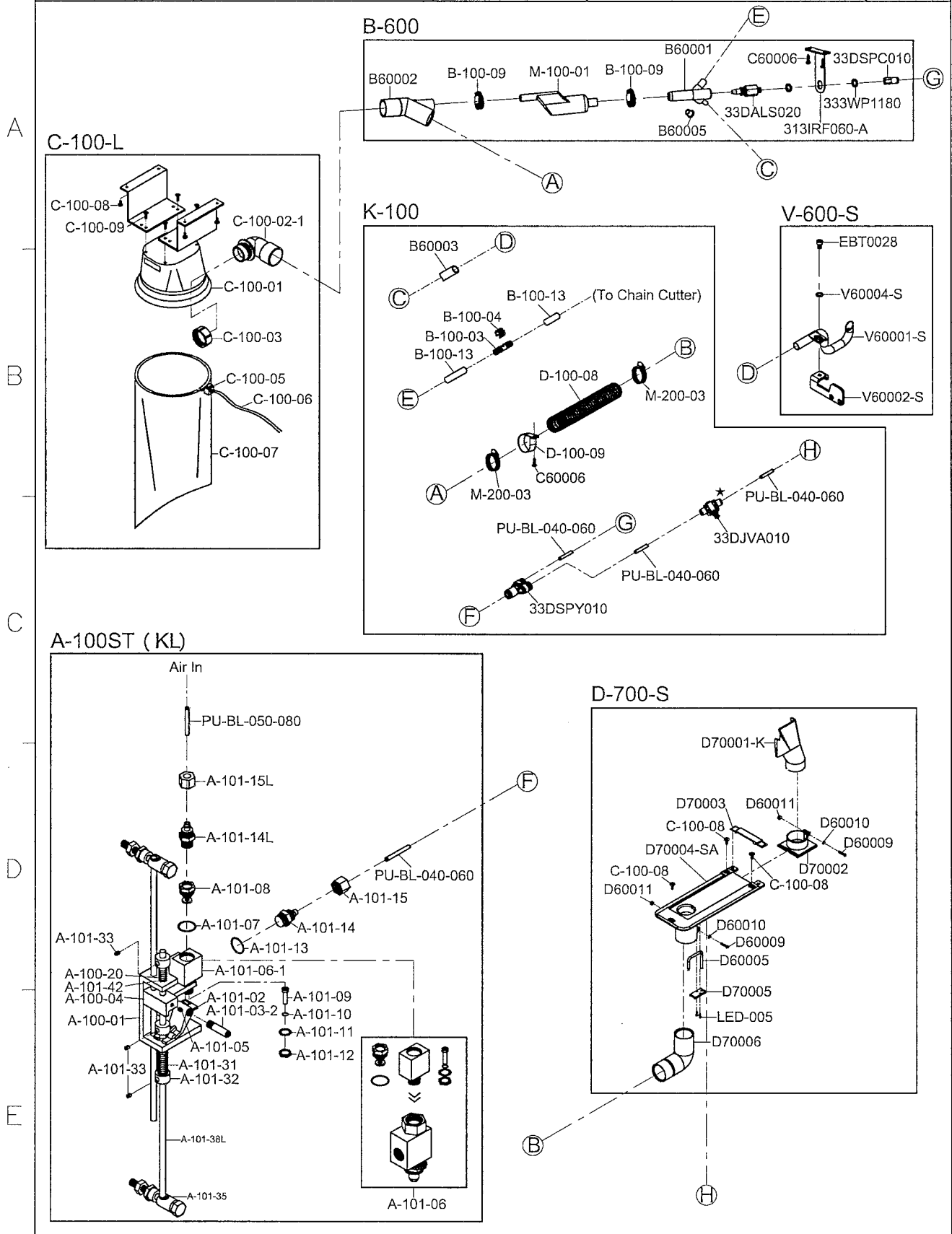

SIRUBA PARTS LIST	Series	Parts Group	Subclass / Remark	Page
	700Q 700QE	TUA-32Q	Note 註記: 1) ★ Before installation, please check one side is Air IN, another side is Air OUT. 2) 空氣有效使用壓力 Effective air pressure: 4~6 kg/cm 3) 請適度修剪管子長度, 以達到風力最佳效能。	1/1 Date 2016/11/02

