



MODEL
347R-1A-1WS

PARTS BOOK

MODEL : 347R-1A-1WS

索引

INDEX

PAGE

A、	本體關係(一)	----	FRAME & MISCELLANEOUS COVER COMPONENTS	----	2-3
B、	本體關係(二)	----	FRAME & MISCELLANEOUS COVER COMPONENTS	----	4-5
C、	上軸、下軸關係	----	MAIN SHAFT & UPRIGHT SHAFT COMPONENTS	----	6-7
D、	針棒、天秤關係	----	NEEDLE BAR & TREAD TAKE-UP LEVER COMPONENTS	----	8-9
E、	送料關係(一)	----	FEED MECHANISM COMPONENTS	----	10-11
F、	送料關係(二)	----	FEED MECHANISM COMPONENTS	----	12-13
G、	押腳關係(一)	----	PRESSER BAR & KNEE LIFTER COMPONENTS	----	14-15
H、	押腳關係(二)	----	PRESSER BAR & KNEE LIFTER COMPONENTS	----	16-17
I、	專用件	----	EXCLUSIVE PARTS	----	18-19
J、	附件	----	ACCESSORIES	----	20-21
K、	零件號碼與頁數對照	----	NUMERICAL PARTS-LIST	----	22-23

A 347R-1A-1WS 關係(一) FRAME & MISCELLANEOUS COVERS COMPONENTS

零件號碼 Part No	零件名稱 Name of Part	件數 Q, Ty	零件號碼 Part. No	零件名稱 Name of Part	件數 Q, Ty	備註 Remark
3400118800	橡膠栓	1	SB1029-0A	彈簧座	1	
A1021-0A	調整彈簧	2	SB1050-0A	單頭螺柱	1	
A1025-0A	壓線盤	1	SB1082-0A	天桿蓋	1	
A1034-0A	線調整壓盤	1	SB1279-0A	上部舉升軸臂	1	
A1051-0A	三孔線掛	2	SB1320-0A	上油槽組	1	
E1052-0A	線掛	1	SB1321-0A	油棉蓋	1	
LM1350-0A	上蓋	1	SB1322-0A	油槽蓋	1	
LM3000-0A	皮帶蓋	1	WA050001	墊圈	2	
LM3001-0A	皮帶蓋	1	KA309300	油線	1	
LM4083-0A	底座蓋板	1	XB132001	油棉	1	
LM4084-0A	底座蓋板	1	XB333001	油棉	1	
LM5030-0A	釜蓋	1	XB360001	油棉	1	
LM6050-0A	針板	1	YA000270	平行銷	2	
LM6052-0A	釜槽	1	YB030016	銷	1	
PA1052-0A	線掛	1	YD060050	平行銷	2	
SA055-0A	線掛	1	ZMB05026	螺絲	1	
SB1010-0A	面板蓋	1	ZMJ05098	螺絲	2	
SB1012-0A	側板(B)	1	ZSA11005	螺絲	1	
SB1013-0A	側板(A)	1	ZSA15006	螺絲	1	
SB1014-0A	檔塊	1	ZSB09002	螺絲	2	
SB1020-0A	壓線調整組	1	ZSB09005	螺絲	1	
SB1020-0A	調整螺絲棒	1	ZSB09041	螺絲	2	
SB1027-0A	吊線彈簧	1	ZSB09047	螺絲	4	
SB1028-0A	鬆線銷	1	ZSB09047	螺絲	4	

*LN4083-0C	底座蓋板	1				
*LM6030-0B	釜蓋	1				
*LM6050-0B	針板	1				
*LM6052-0B	釜槽	1				

車淺水衣專用零件

B、347R-1A-1WS 豐關係 (二) MAIN SHAFT COMPONENTS

零件號碼 Part No	零件名稱 Name of Part	件數 Q, TY	零件號碼 Part No	零件名稱 Name of Part	件數 Q, TY	備註 Remark
ZSB09079	螺絲 SCREW (SM9/64-40x7)	1	ZSC11001	螺絲 SCREW (SM11/64-40x6.5)	2	
ZSB09079	螺絲 SCREW (SM9/64-40x7)	1	ZSC11020	螺絲 SCREW (SM11/64-40x11.3)	2	
ZSB09080	螺絲 SCREW (SM9/64-40x12)	1	ZSD24095	螺絲 SCREW (SM3/8-16x39)	1	
ZSB09080	螺絲 SCREW (SM9/64-40x12)	1	ZSD32002	螺絲 SCREW (SM1/2-12x33)	1	
ZSB11017	螺絲 SCREW (SM11/64-40x12)	4	ZSD32003	螺絲 SCREW (SM1/2-12x39)	1	
ZSB12005	螺絲 SCREW (SM3/16-28x15)	2	ZSL09002	螺帽 NUT (SM9/64-40)	1	
ZSB12060	螺絲 SCREW (SM3/16-32x12)	1	ZSM16006	螺帽 NUT (SM1/4-40)	3	
ZSB12061	螺絲 SCREW (SM9/64-40x7)	3	ZSQ09008	螺絲 SCREW (SM9/64-40x6)	2	
ZSB12061	螺絲 SCREW (SM9/64-40x7)	3	ZSQ09008	螺絲 SCREW (SM9/64-40x6)	2	
ZSC11001	螺絲 SCREW (SM11/64-40x6.5)	2	ZSQ09008	螺絲 SCREW (SM9/64-40x6)	2	

C. 347R-1A-1WS-軸、下軸關係 MAIN SHAFT & UPRIGHT SHAFT COMPONENTS

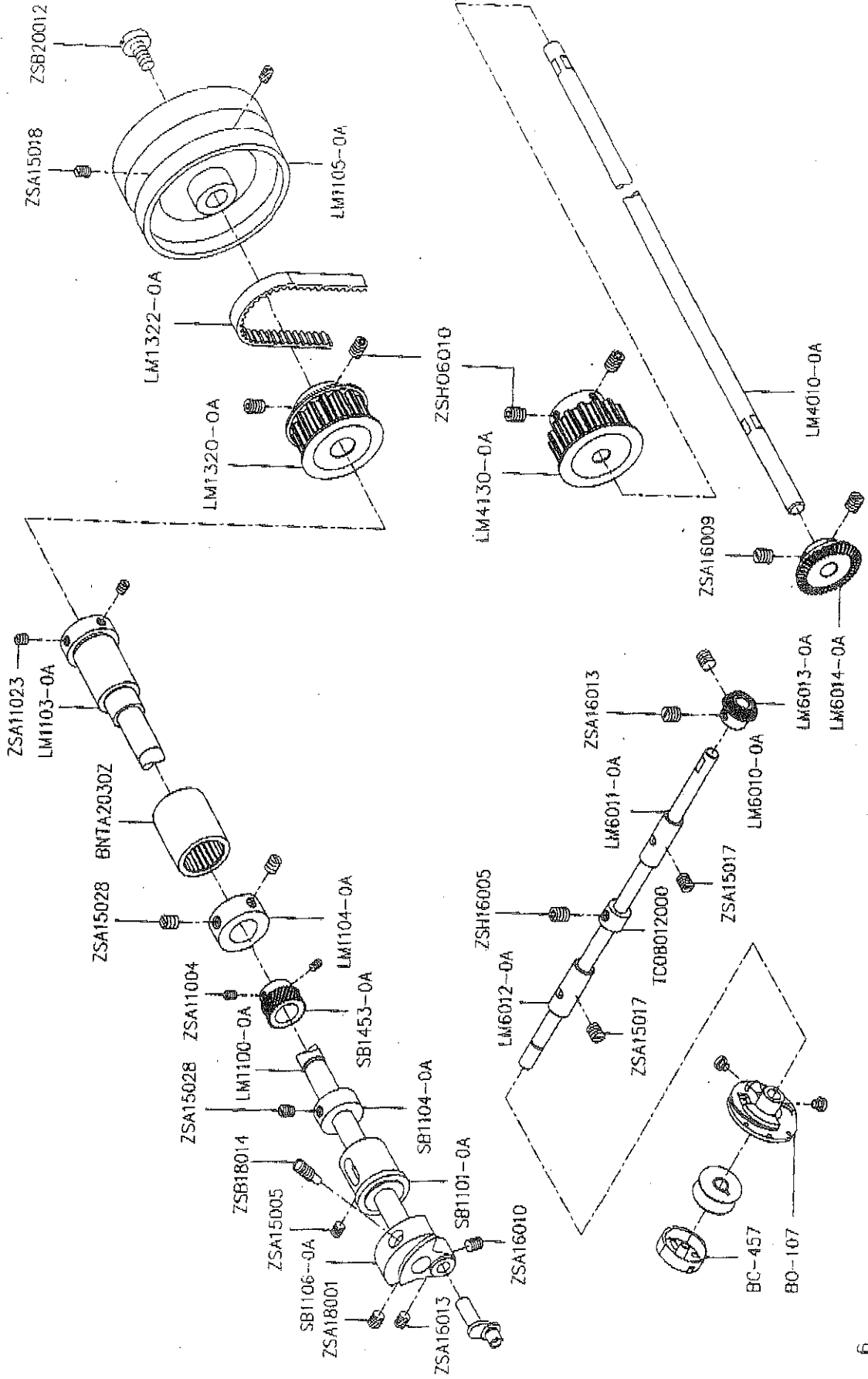

C-347R-1A-IWS 軸、下軸關係 MAIN SHAFT & UPRIGHT SHAFT COMPONENTS

零件號碼 Part No	零件名稱 Name of Part	零件號碼 Q, TY Part No	零件名稱 Name of Part	零件號碼 Q, TY Part No	備註 Remark
BC-457	梭殼	1	BOBBIN CASE	SBI453-0A	1
BNTA2030Z	培林	1	LOWER SHAFT BEARING	TC08012000	1
BO-107	大釜	1	HOOK	ZSA11004	2
LM1100-0A	上軸	1	ARM SHAFT	ZSA11023	1
LM1103-0A	軸套	1	ARM SHAFT BUSHING	ZSA15005	4
LM1104-0A	定環	1	ARM SHAFT COLLAR	ZSA15017	3
LM1105-0A	皮帶輪	1	HAND WHEEL	ZSA15017	3
LM1320-0A	齒輪	1	GEAR	ZSA15018	2
LM1322-0A	PU鋼絲齒形	1	TINING BELT	ZSA15028	2
LM4010-0A	下軸	1	HOOK DRIVE SHAFT	ZSA15028	2
LM4130-0A	齒輪	1	GEAR	ZSA16009	6
LM6010-0A	釜軸	1	HOOK SHAFT	ZSA16010	6
LM6011-0A	套管	1	HOOK SHAFT BUSHING	ZSA16013	2
LM6012-0A	套管	1	HOOK SHAFT BUSHING	ZSA16013	2
LM6013-0A	下軸傘齒輪	1	HELLCAL GEAR	ZSA18001	4
LM6014-0A	下軸傘齒輪	1	HELLCAL GEAR	ZSB18014	1
SBI101-0A	大心套	1	ARM BUSHING (FRONT)	ZSB20012	1
SBI104-0A	定環	1	ARM SHAFT COLLAR	ZSH06010	1
SBI106-0A	凸輪	1	COUNTER WEIGHT	ZSH16005	6
			針振齒輪(小)	NEEDLE VIBRATION PINION	
			定環	ARM SHAFT COLLAR	
			螺絲	SCREW (SM11/64-40x3.5)	
			螺絲	SCREW (SM11/64-40x6.5)	
			螺絲	SCREW (SM15/64-28x13)	
			螺絲	SCREW (SM15/64-28x8.5)	
			螺絲	SCREW (SM15/64-28x8.5)	
			螺絲	SCREW (SM15/64-28x19)	
			螺絲	SCREW (SM15/64-28x19)	
			螺絲	SCREW (SM15/64-28x19)	
			螺絲	SCREW (SM1/4-40x7)	
			螺絲	SCREW (SM1/4-40x4.5)	
			螺絲	SCREW (SM1/4-40x5.5)	
			螺絲	SCREW (SM1/4-40x5.5)	
			螺絲	SCREW (9/32-28x8)	
			螺絲	SCREW (SM9/32-28x17)	
			螺絲	SCREW (SM5/16-24x13)	
			螺絲	SCREW (M6x1.0-10)	
			螺絲	SCREW (SM1/4-40x4.5)	

D 347R-1A-1WS 棒、天秤關係 NEEDLE BAR & TREAD TAKE-UP LEVER COMPONENTS

零件號碼 Part No	零件名稱 Name of Part	件數 Q. TY	零件號碼 Part No	零件名稱 Name of Part	件數 Q. TY	備註 Remark
DPX1718	針	1	SB1458-0A	定環	1	ZIGZAG COLLAR
LM1066-0A	針棒連結軸	1	SB1458-0A	定環	1	ZIGZAG COLLAR
SB1061-0A	天秤固定銷	1	SB1459-0A	凸輪軸套管	1	ZIGZAG BUSHING REAR
SB1063-0A	天秤腳釘	1	WA030003	墊圈	1	WASHER
SB1064-0A	天秤架	1	WA050010	平盤圈	1	WASHER
SB1065-0A	天秤	1	WC119001	盤形墊圈	1	SPRING WASHER
SB1067-0A	針棒連結桿	1	ZSA11002	螺絲	1	SCREW (SM11/64-40x6.5)
SB1070-0A	針棒	1	ZSA11004	螺絲	1	SCREW (SM11/64-40x3.5)
SB1074-0A	針棒鉗	1	ZSA11004	螺絲	1	SCREW (SM11/64-40x3.5)
SB1076-0A	針棒鉗固定	1	ZSA15005	螺絲	1	SCREW (SM15/64-28x13)
SB1077-0A	墊圈	1	ZSA15005	螺絲	1	SCREW (SM15/64-28x13)
SB1078-0A	線掛	1	ZSA15005	螺絲	1	SCREW (SM15/64-28x13)
SB1081-0A	固定板	1	ZSA15005	螺絲	1	SCREW (SM15/64-28x13)
SB1090-0A	針柱座	1	ZSA15016	螺絲	1	SCREW (SM15/64-28x7)
SB1091-0A	針柱座固定	1	ZSA15021	螺絲	1	SCREW (SM15/64-28x4.5)
SB1092-0A	針柱座定位板	1	ZSA15025	螺絲	1	SCREW (SM15/64-28x6)
SB1095-0A	針落調整螺	1	ZSA15028	螺絲	1	SCREW (SM15/64-28x7)
SB1175-0A	針振目盛板	1	ZSA15022	螺絲	1	SCREW (SM1/4-40x7)
SB1176-0A	針振指針	1	ZSB09011	螺絲	1	SCREW (SM9/64-40x6.5)
SB1310-0A	針振調整	1	ZSB09021	螺絲	1	SCREW (SM9/64-40x7.7)
SB1311-0A	套管	1	ZSB09079	螺絲	1	SCREW (SM9/64-40x7)
SB1312-0A	針振調節器	1	ZSB11020	螺絲	1	SCREW (SM11/64-40x6.5)
SB1313-0A	旋鈕	1	ZSB12057	螺絲	1	SCREW (SM3/16-28x9.5)
SB1314-0A	筒塊	1	ZSB12058	螺絲	1	SCREW (SM3/16-32x6.5)
SB1450-0A	針振驅動組	1	ZSC09031	螺絲	1	SCREW (SM9/64-40x11)
SB1451-0A	凸輪軸套管	1	ZSC11019	螺絲	1	SCREW (SM11/64-40x5.5)
SB1452-0A	針振齒輪(大)	1	ZSC11019	螺絲	1	SCREW (SM11/64-40x5.5)
SB1454-0A	凸輪	1	ZSF12002	螺絲	1	SCREW (SM3/16-32x10)
SB1455-0A	針振三叉	1	ZSK09001	螺絲	1	SCREW (SM9/64-40x8.5)
SB1456-0A	彈簧掛勾	1	ZSK18032	螺絲	1	SCREW (SM9/32-28x12)
SB1457-0A	拉伸彈簧	1	ZSL12009	螺絲	1	NUT (SM3/16-32)
			ZSL18001	螺絲	1	NUT (SM9/32-28)

E. 347R-1A-1WS送料關係(一) FEED MECHANISM COMPONENTS

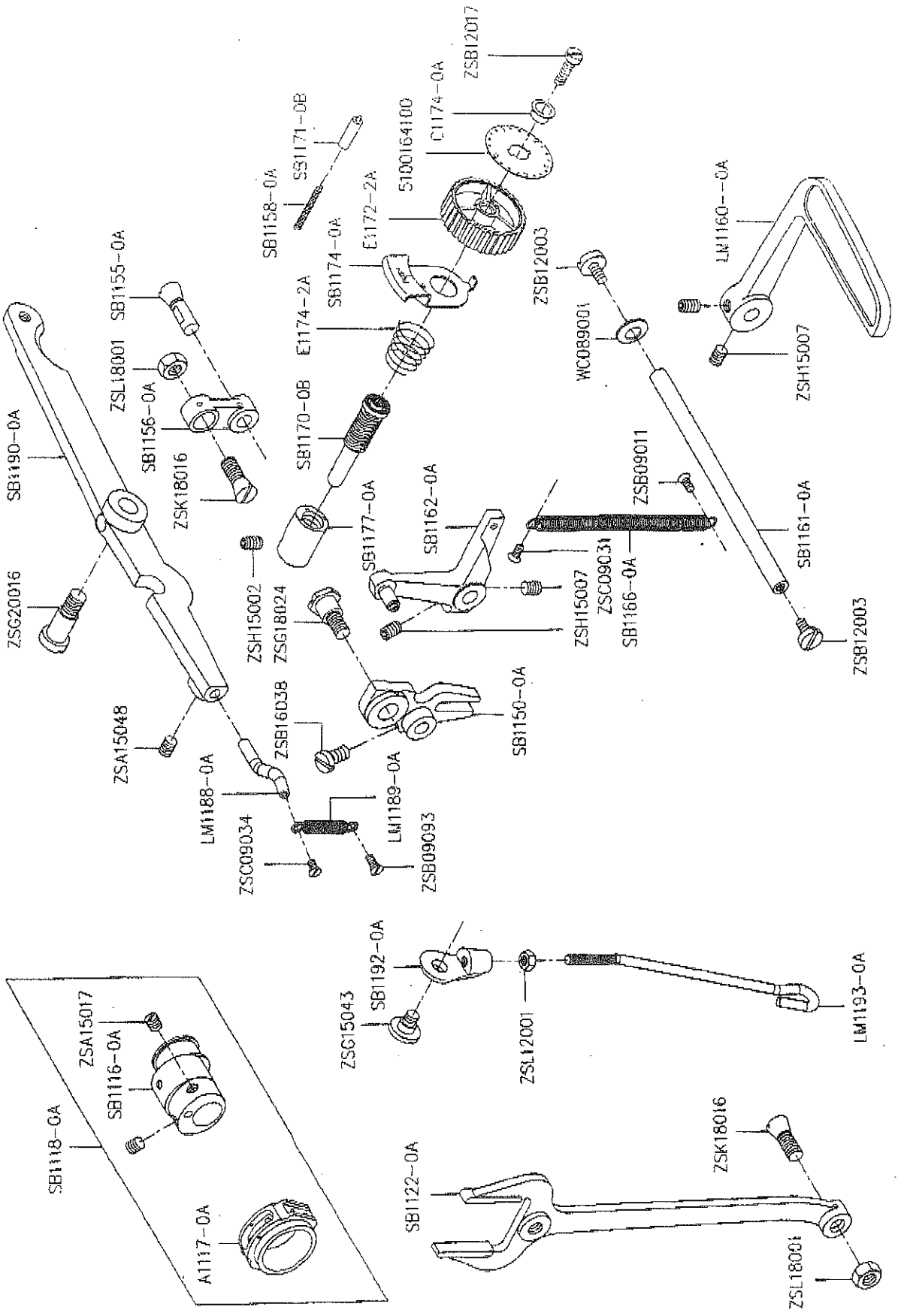

E 347R-1A-1WS料關係(一) FEED MECHANISM COMPONENTS

零件號碼	零件名稱	Name of Part	件數	零件號碼	零件名稱	Name of Part	件數	備註
Part No			Q, TY	Part No			Q, TY	Remark

5100164100	目盛板	INDICATOR PLATE	1	SB1192-0A	押棒提升桿	KNEE LIFTER LIFTING LEVER	1	
A1117-0A	偏心輪板	FEED CAM	1	WC089001	墊圈	WASHER	1	
C1174-0A	墊片	WASHER	1	ZSA15017	螺絲	SCREW (SM15/64-28x8.5)	1	
E1172-2A	刻度盤	FEED REGULATING STUD HEAD	1	ZSA15048	螺絲	SCREW (SM15/64-28x5)	1	
E1174-2A	壓縮彈簧	SPRING	1	ZSB09011	螺絲	SCREW (SM9/64-40x6.5)	16	
LM1160-0A	倒邊擋桿	REVERSE FEED CONTROL LEVER	1	ZSBC9093	螺絲	SCREW (SM9/64-40x10.5)	1	
LM1188-0A	連接板鉤	KNEE LIFTER LIFTING LEVER PIN	1	ZSBI2003	螺絲	SCREW (SM3/16-32x6.5)	2	
LM1189-0A	拉伸彈簧	FEED REVERSE SPRING	1	ZSB12003	螺絲	SCREW (SM3/16-32x6.5)	2	
LM1193-0A	連接棒	KNEE LIFTER ROD	1	ZSB12017	螺絲	SCREW (SM3/16-28x15)	1	
SB1116-0A	偏心輪	FEED CAM	1	ZSB16088	螺絲	SCREW (SM1/4-40x10)	1	
SB1118-0A	偏心輪組	FEED CAM	1	ZSC09031	螺絲	SCREW (SM9/64-40x11)	1	
SB1122-0A	連結叉桿	FEED FORKED CONNECTION	1	ZSC09034	螺絲	SCREW (SM9/64-40x11)	1	
SB1150-0A	送料調節器	FEED REGULATOR (FORKED)	1	ZSG15043	螺絲	SCREW (SM15/64-28x12.5)	1	
SB1155-0A	連結軸	FEED CONNECTION LINK HINGE STUD	1	ZSG18024	螺絲	SCREW (SM9/32-28x11.5)	1	
SB1156-0A	二又連桿	FEED CONNECTION LINK	1	ZSG20016	螺絲	SCREW (SM5/16-24x11)	1	
SB1158-0A	壓縮彈簧	SPRING	1	ZSH15002	螺絲	SCREW (SM15/64-28x8)	1	
SB1161-0A	連結軸	REVERSE FEED CONTROL LEVER SHAFT	1	ZSH15007	螺絲	SCREW (SM15/64-28x8)	1	
SB1162-0A	倒邊曲柄組	REVERSE FEED CONTROL LEVER CRANK	1	ZSH15007	螺絲	SCREW (SM15/64-28x8)	1	
SB1166-0A	拉伸彈簧	FEED REVERSE SPRING	1	ZSK18016	螺絲	SCREW (SM9/32-28x13)	1	
SB1170-0B	調節螺絲	FEED REGULATING STUD	1	ZSK18016	螺絲	SCREW (SM9/32-28x13)	1	
SB1171-0B	定位銷	FEED REGULATING STUD LOCK PIN	1	ZSL12001	螺帽	NUT (SM3/16-32)	1	
SB1174-0A	擋作板	FEED REGULATING STUD LEVER	1	ZSL18001	螺帽	NUT (SM9/32-28)	1	
SB1177-0A	調節螺絲	STOPPER PIN RELEASING LEVER	1	ZSL18001	螺帽	NUT (SM9/32-28)	1	
SB1192-0A	提聲升桿接頭	FEED REGULATING STUD BUSHING	1	ZSL18001	螺帽	NUT (SM9/32-28)	1	
		KNEE LIFTER LIFTING LEVER						
		CONNECTING ROD						

F. 347R-1A-1WS 料關係(二) FEED MECHANISM COMPONENTS

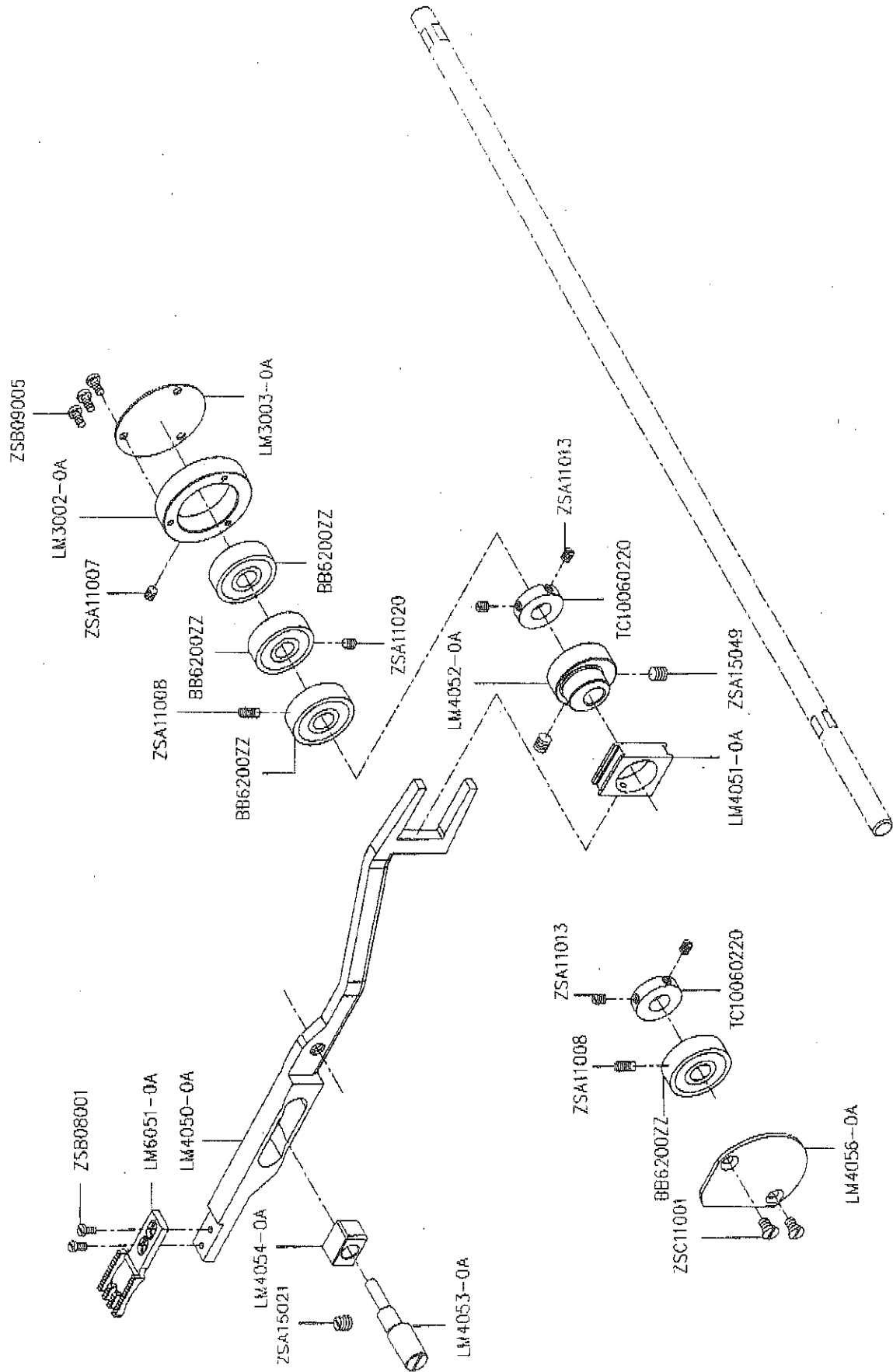

F 347R-1A-IWS料關係(二) FEED MECHANISM COMPONENTS

零件號碼 Part No	零件名稱 Name of Part	件數 Q. TY	零件號碼 Part No	零件名稱 Name of Part	件數 Q. TY	備註 Remark
BB6200ZZ	軸承	1	TC10060220	定環	1	
BB6200ZZ	軸承	1	TC10060220	定環	1	
BB6200ZZ	軸承	1	ZSAI1007	螺絲	1	
BB6200ZZ	軸承	1	ZSAI1008	螺絲	1	
LM3002-0A	軸承固定座	1	ZSAI1008	螺絲	1	
LM3003-0A	軸承固定座	1	ZSAI1008	螺絲	1	
LM4050-0A	送料台	1	ZSAI1013	螺絲	1	
LM4051-0A	偏心軸套	1	ZSAI1013	螺絲	1	
LM4052-0A	偏心輪	1	ZSAI1020	螺絲	1	
LM4053-0A	調整軸	1	ZSAI5021	螺絲	1	
LM4054-0A	滑塊	1	ZSAI5049	螺絲	1	
LM4056-0A	培林蓋	1	ZSB08001	螺絲	1	
LM6051-0A	送料齒	1	ZSB09005	螺絲	1	
		1	ZSC11001	螺絲	1	
		1		ZIGZAG COLLAR	1	
		1		ZIGZAG COLLAR	1	
		2		SCREW (SM11/64-40x8)	2	
		2		SCREW (SM11/64-40x5.5)	2	
		2		SCREW (SM11/64-40x5.5)	2	
		2		SCREW (SM11/64-40x6)	2	
		2		SCREW (SM11/64-40x6)	2	
		1		SCREW (SM11/64-40x11)	1	
		2		SCREW (SM15/64-28x4.5)	2	
		2		SCREW (SM15/64-28x12)	2	
		2		SCREW (SM1/8-44x6)	2	
		1		SCREW (SM9/64-40x5)	1	
		2		SCREW (SM11/64-40x9)	2	

G.347R-1A-IWS 脚關係(一) PRESSER BAR & KNEE LIFTER COMPONENTS

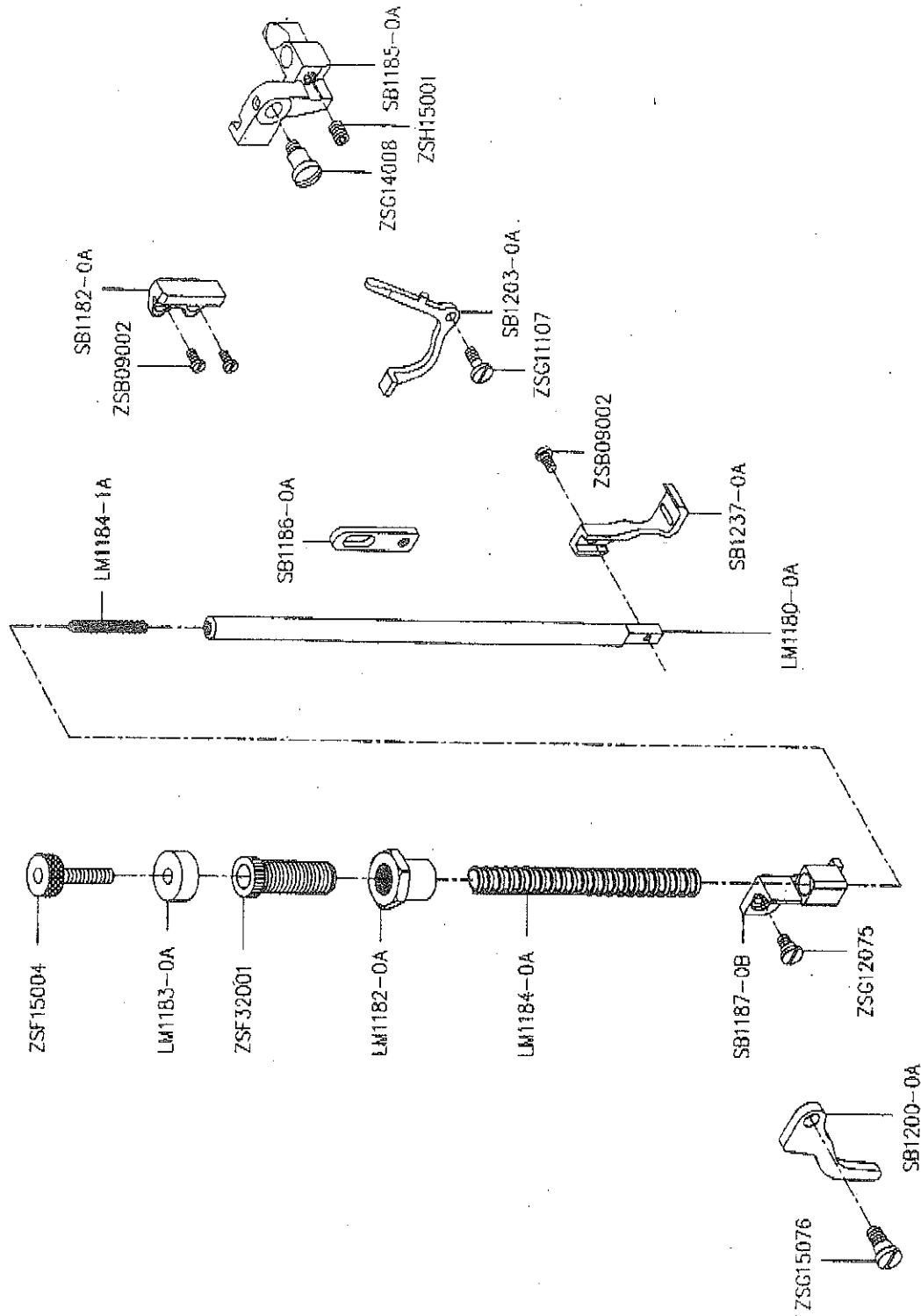

G 347R-1A-1WS 脚關係 (一) PRESSER BAR & KNEE LIFTER COMPONENTS

零件號碼	零件名稱	Name of Part	件數	零件號碼	零件名稱	Name of Part	件數
Part No			Q, TY	Part No			Q, TY
LM1180-0A	押棒	PRESSER BAR	1	SB1237-0A	內押脚	WORK CLAMP FOOT	1
LM1182-0A	調整螺絲套環	FEED REGULATING STUD BUSHING RING	1	ZSB09002	螺絲	SCREW (SM9/64-40x10)	2
LM1183-0A	緩衝墊	CUSHION RUBBER	1	ZSB09002	螺絲	SCREW (SM9/64-40x10)	2
LM1184-0A	壓縮彈簧	TENSION SPRING	1	ZSF15004	螺絲	SCREW (SM15/64-28x28)	1
LM1184-1A	擴張彈簧	TENSION SPRING	1	ZSF32001	螺絲	SCREW (SM11/2-28x48)	1
SB1182-0A	定位板	PRESSER BAR GUIDE BRACKET GUIDE	1	ZSG11107	螺絲	SCREW (SM11/64-40x7)	1
SB1185-0A	押棒固定座	PRESSER BAR FIXED BASE	1	ZSG12075	螺絲	SCREW (SM3/16-32x5)	1
SB1186-0A	連接板	LIFTING LEVER LINK	1	ZSG14008	螺絲	SCREW (SM7/32-32x5)	1
SB1187-0B	押棒固定座	PRESSER BAR LIFTING AND RELEASING LEVER BRACKET	1	ZSG15076	螺絲	SCREW (SM15/64-28x8)	1
SB1200-0A	押棒提桿	KNEE LIFTER LIFTING LEVER	1	ZSH15001	螺絲	SCREW (SM15/64-28x6)	1
SB1203-0A	鬆線架	TENSION RELEASING LEVER	1				

H-347R-1A-1WS脚關係(二) PRESSER BAR & KNEE LIFTER COMPONENTS

零件號碼	零件名稱	Name of Part	零件號碼	零件名稱	Name of Part	件數	備註
Part No			Q, TY Part No			Q, TY	Remark
EK4037-1A	角驅軸	BEARING STUD	WH208007	墊圈	WASHER	2	
EK4038-1A	送料角軀	FEED FORKED CONNECTION SLIDE BLOCK	WH208007	墊圈	WASHER	2	
RE000040	E和環	E RING	YB030018	銷	TAPER PIN	1	
SB1122-0A	連結叉桿	FEED FORKED CONNECTION RING	ZSA15049	螺絲	SCREW (SM15/64-28x12)	2	
SB1235-0A	外押腳	OUTSIDE PRESSER FOOT	ZSA15049	螺絲	SCREW (SM15/64-28x12)	2	
SB1281-0A	押腳擋板	OUTSIDE PRESSER BAR STOP BRACKET	ZSB09017	螺絲	SCREW (SM9/64-40x8)	2	
SB1282-0A	押腳引導板	OUTSIDE PRESSER BAR	ZSB11125	螺絲	SCREW (SM11/64-40x6)	1	
SB1283-0A	前後叉臂	FEED FORKED CONNECTION	ZSB11127	螺絲	SCREW (SM11/64-40x10.5)	1	
SB1284-0A	擋塊	FRONT AND REAR PRESSER BAR GUIDE BRACKET	ZSG14008	螺絲	SCREW (SM7/32-32x5)	1	
SB1285-0A	連桿	FRONT AND REAR LIFTING LEVER LINK	ZSG14008	螺絲	SCREW (SM7/32-32x5)	1	
SB1286-0A	連桿	FRONT AND REAR LIFTING LEVER LINK	ZSG14009	螺絲	SCREW (SM7/32-32x5)	1	
SB1287-0A	連桿	FRONT AND REAR LIFTING LEVER LINK	ZSG15080	螺絲	SCREW (SM7/32-32x5)	1	
SB1288-0A	鎖	FEED FORKED CONNECTION PIN	ZSH15002	螺絲	SCREW (SM15/64-28x12)	1	
SB1289-0A	搖動曲柄(小)	FEED LIFTING ROCK SHAFT CRANK	ZSH15003	螺絲	SCREW (SM15/64-28x8)	1	
SB1290-0A	上部舉升搖組	ROCK ARM ASM.	ZSH15007	螺絲	SCREW (SM15/64-28x5)	1	
SB1290-1A	上送料軸	FEED ROCK SHAFT	ZSK18016	螺絲	SCREW (SM15/64-28x8)	1	
SB1290-2A	上部舉升搖	FEED LIFTING ROCK SHAFT CRANK COMPLETE	ZSK18016	螺絲	SCREW (SM15/64-28x8)	1	
SB1291-0A	上部舉升搖	ROCK ARM ASM.	ZSK18016	螺絲	SCREW (SM9/32-28x13)	1	
SB1292-0A	送料連桿	FEED ROCK SHAFT CRANK	ZSK18016	螺絲	SCREW (SM9/32-28x13)	1	
SB1293-0A	中軸後套管	REAR FEED ROCK SHAFT	ZSK18016	螺絲	SCREW (SM9/32-28x13)	1	
SB1294-0A	螺絲帽	FEED LIFTING ROCK SHAFT CONNECTING ROD	ZSK18034	螺絲	SCREW (SM9/32-28x13)	1	
SB1294-0A	螺絲帽	FEED LIFTING ROCK SHAFT CONNECTING ROD	ZSL15001	螺絲帽	SCREW (SM9/32-28x33.5)	1	
SB1295-0A	偏心輪	FEED CAM	ZSL18001	螺絲帽	NUT (SM15/64-28)	2	
SB1296-0A	搖動曲柄(大)	FEED LIFTING ROCK SHAFT CRANK	ZSL18001	螺絲帽	NUT (SM9/32-28)	1	
SB1297-0A	送料連接桿	FEED CONNECTING LINK	ZSL18001	螺絲帽	NUT (SM9/32-28)	1	
SB1298-0A	前後連桿	FEED LIFTING ROCK SHAFT CONNECTING ROD	ZSL18001	螺絲帽	NUT (SM9/32-28)	1	
WH206011	墊圈	WASHER	ZSL18001	螺絲帽	NUT (SM9/32-28)	1	

I. 347R-1A-1WS 零件 EXCLUSIVE PARTS

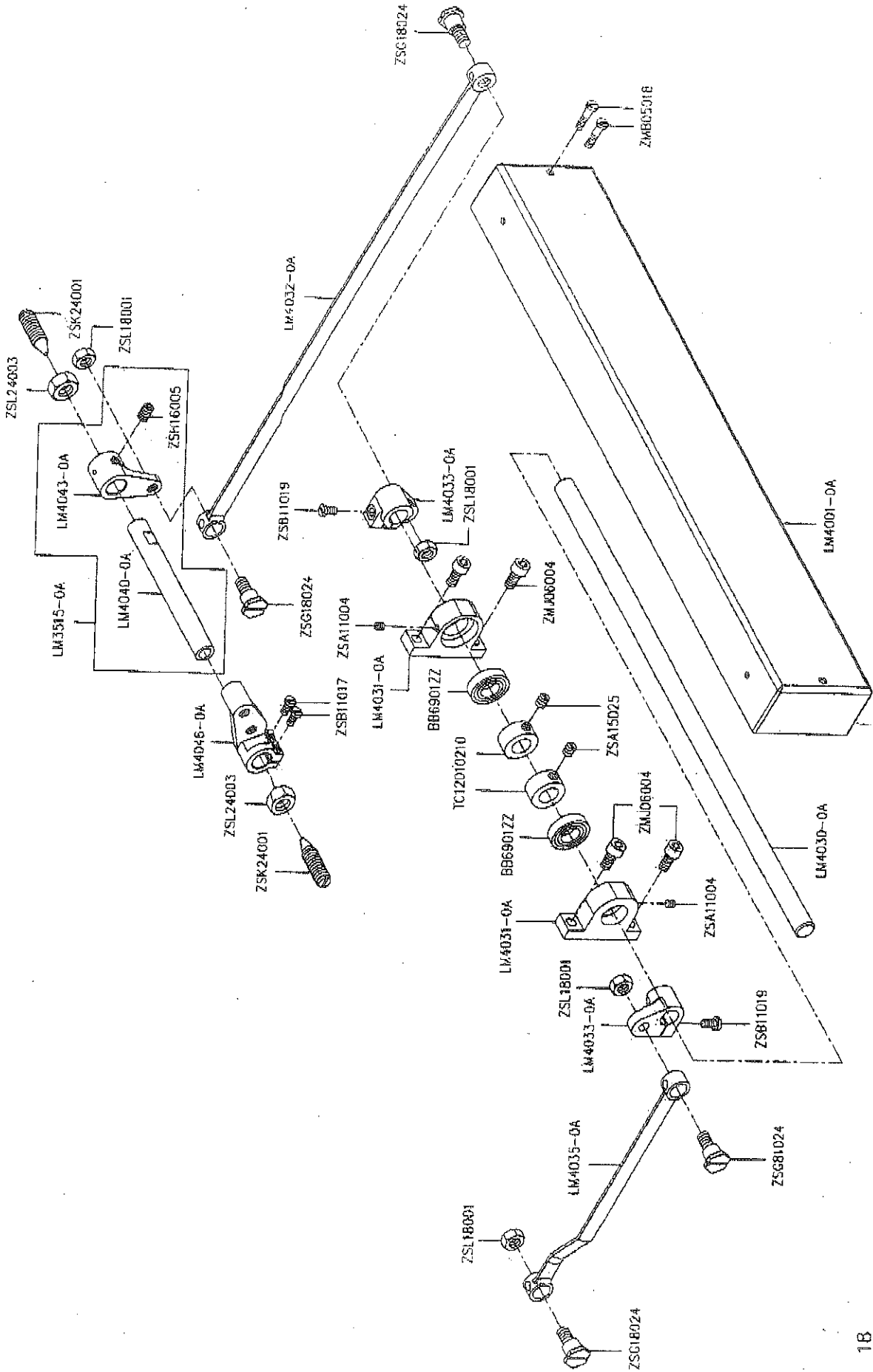

I 347R-1A-IWS 用件 EXCLUSIVE PARTS

零件號碼	零件名稱	Name of Part	件數	零件號碼	零件名稱	Name of Part	件數	備註
Part No			Q, TY	Part No			Q, TY	Remark
B66901ZZ	軸承	BEARING	1	ZSA11004	螺絲	SCREW (SM11/64-40x3.5)	1	
B66901ZZ	軸承	BEARING	1	ZSA15025	螺絲	SCREW (SM15/64-28x4.5)	2	
LM3515-0A	送料軸組	FEED SHAFT	1	ZSBI1017	螺絲	SCREW (SM11/64-40x15)	4	
LM4001-0A	送料蓋板	FEED LIFTING ROCK COVER	1	ZSBI1019	螺絲	SCREW (SM11/64-40x13)	3	
LM4030-0A	搖動軸	DRIVING SHAFT	1	ZSBI1019	螺絲	SCREW (SM11/64-40x13)	3	
LM4031-0A	搖動軸座	DRIVING SHAFT BASE	1	ZSG18024	螺絲	SCREW (SM9/32-28x11.5)	1	
LM4031-0A	搖動軸座	DRIVING SHAFT BASE	1	ZSG18024	螺絲	SCREW (SM9/32-28x11.5)	1	
LM4032-0A	送料建桿	FEED LIFTING ROCK SHAFT	1	ZSG18024	螺絲	SCREW (SM9/32-28x11.5)	1	
LM4033-0A	送料腕	FEED LIFTING ROCK LINK	1	ZSG81024	螺絲	SCREW (SM9/32-28x11.5)	1	
LM4033-0A	送料腕	FEED LIFTING ROCK LINK	1	ZSH16005	螺絲	SCREW (SM1/4-40x4.5)	1	
LM4035-0A	送料建桿	FEED LIFTING ROCK SHAFT	1	ZSK24001	螺絲	SCREW (SM3/8-28x35)	2	
LM4040-0A	送料軸	FEED SHAFT	1	ZSK24001	螺絲	SCREW (SM3/8-28x35)	2	
LM4043-0A	送料軸座	FEED BAR SHAFT	1	ZSL18001	螺帽	NUT (SM9/32-28)	1	
LM4046-0A	送料曲柄	FEED ROCK SHAFT CRANK	1	ZSL18001	螺帽	NUT (SM9/32-28)	1	
TC12010210	定環	ZIGZAG COLLAR	2	ZSL18001	螺帽	NUT (SM9/32-28)	1	
ZM05018	螺絲	SCREW (M5x0.8-50)	1	ZSL18001	螺帽	NUT (SM9/32-28)	1	
ZM06004	螺絲	SCREW (M6x1.0-20)	1	ZSL24003	螺帽	NUT (SM3/8-28)	2	
ZM06004	螺絲	SCREW (M6x1.0-20)	1	ZSL24003	螺帽	NUT (SM3/8-28)	2	
ZSA11004	螺絲	SCREW (SM11/64-40x3.5)	1					

J. 347R-1A-1WS附件 ACCESSORIES

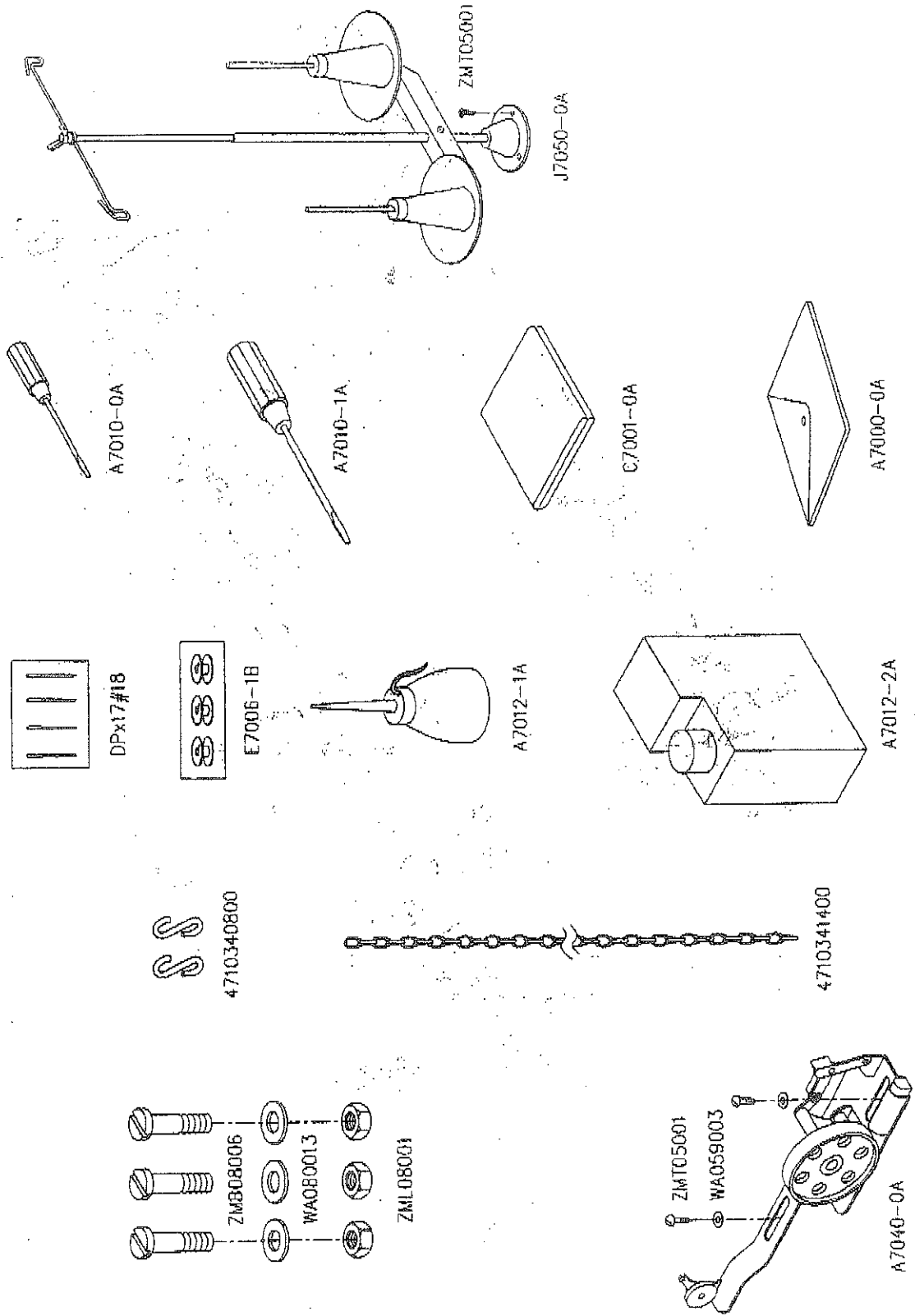

J 347R-1A-1WS 件 ACCESSORIES

零件號碼 Part No	零件名稱 Name of Part	件數 Q. TY	零件號碼 Part No	零件名稱 Name of Part	件數 Q. TY	備註 Remark
4710340800	S 字金具	1	DPX17#18	針	1	
4710341400	鎖	1	ET006-1B	梭仔	1	
A7000-0A	工具袋	1	J7050-0A	線架組	3	
A7010-0A	螺絲起子 (小)	1	WA059003	平墊圈	1	
A7010-1A	螺絲起子 (中)	1	WA080013	平墊圈	2	
A7012-1A	油壺 (中)	1	ZMB08006	螺絲	4	
A7012-2A	油壺 (大)	1	ZML08001	螺帽	3	
A7040-0A	捲線器組	1	ZMT05001	木螺釘	1	
C7001-0A	脚踏板	1	ZMT05001	木螺釘	4	
	S-PLUG			NEEDLE		
	CHAIN			BOBBIN		
	ACCESSORY BAG			THREAD STAND		
	SCREW DRIVER (SMALL)			WASHER		
	SCREW DRIVER (MIDDLE)			WASHER		
	OILER (MIDDLE)			SCREW (M8x1.25-27)		
	OILER (MIDDLE)			NUT (M8x1.25)		
	BOBBIN WINDER ASSY.			SCREW (M4.5x4.5-16)		
	PEDAL ASSEMBLY			SCREW (M4.5x4.5-16)		

K、347R-1A-1WS 零件號碼與頁數對照 NUMERICAL PARTS-LIST

零件號碼 PARTS NO.	頁數 PAGE	零件號碼 PARTS NO.	頁數 PAGE	零件號碼 PARTS NO.	頁數 PAGE	零件號碼 PARTS NO.	頁數 PAGE	零件號碼 PARTS NO.	頁數 PAGE
3400118800	3	EK4038-1A	17	LM4031-0A	19	SB1010-0A	3	SB1106-0A	7
4710340800	21	J7050-0A	21	LM4032-0A	19	SB1012-0A	3	SB1116-0A	11
4710341400	21	LM1066-0A	9	LM4033-0A	19	SB1013-0A	3	SB1118-0A	11
5100164100	11	LM1100-0A	7	LM4035-0A	19	SB1014-0A	3	SB1122-0A	11, 17
A1021-0A	3	LM1103-0A	7	LM4040-0A	19	SB1020-0A	3	SB1150-0A	11
A1025-0A	3	LM1104-0A	7	LM4043-0A	19	SB1026-0A	3	SB1155-0A	11
A1034-0A	3	LM1105-0A	7	LM4046-0A	19	SB1027-0A	3	SB1156-0A	11
A1051-0A	3	LM1160-0A	11	LM4050-0A	13	SB1028-0A	3	SB1158-0A	11
A1117-0A	11	LM1180-0A	15	LM4051-0A	13	SB1029-0A	3	SB1161-0A	11
A7000-0A	21	LM1182-0A	15	LM4052-0A	13	SB1050-0A	3	SB1162-0A	11
A7010-0A	21	LM1183-0A	15	LM4053-0A	13	SB1061-0A	9	SB1166-0A	11
A7010-1A	21	LM1184-0A	15	LM4054-0A	13	SB1062-0A	3	SB1170-0B	11
A7012-1A	21	LM1184-1A	15	LM4056-0A	13	SB1063-0A	9	SB1171-0B	11
A7012-2A	21	LM1188-0A	11	LM4083-0A	3	SB1064-0A	9	SB1174-0A	11
A7040-0A	21	LM1189-0A	11	LM4084-0A	3	SB1065-0A	9	SB1175-0A	9
BB6200ZZ	13	LM1193-0A	11	LM4130-0A	7	SB1067-0A	9	SB1176-0A	9
BB6901ZZ	19	LM1320-0A	7	LM6010-0A	7	SB1070-0A	9	SB1177-0A	11
BC-457	7	LM1322-0A	7	LM6011-0A	7	SB1074-0A	9	SB1182-0A	15
BNTA2030Z	7	LM1360-0A	3	LM6012-0A	7	SB1076-0A	9	SB1185-0A	15
BO-107	7	LM3000-0A	3	LM6013-0A	7	SB1077-0A	9	SB1186-0A	15
C1174-0A	11	LM3001-0A	3	LM6014-0A	7	SB1078-0A	9	SB1187-0B	15
C7001-0A	21	LM3002-0A	13	LM6030-0A	3	SB1081-0A	9	SB1190-0A	11
DPx17#18	9, 21	LM3003-0A	13	LM6050-0A	3	SB1090-0A	9	SB1192-0A	11
E1052-0A	3	LM3515-0A	19	LM6051-0A	13	SB1091-0A	9	SB1200-0A	15
E1172-2A	11	LM4001-0A	19	LM6052-0A	3	SB1092-0A	9	SB1203-0A	15
E1174-2A	11	LM4010-0A	7	PA1052-0A	3	SB1095-0A	9	SB1235-0A	17
E7006-1B	21	LM4030-0A	19	RE000040	17	SB1101-0A	7	SB1237-0A	15
EK4037-1A	17	LM4031-0A	19	S1055-0A	3	SB1104-0A	7	SB1279-0A	3

K-347R-1A-IWS 零件號碼與頁數對照 NUMERICAL PARTS-LIST

零件號碼 PARTS NO.	頁數 PAGE	零件號碼 PARTS NO.	頁數 PAGE	零件號碼 PARTS NO.	頁數 PAGE	零件號碼 PARTS NO.	頁數 PAGE	零件號碼 PARTS NO.	頁數 PAGE
SB1281-0A	17	SB1450-0A	9	YB030018	17	ZSA16010	7	ZSB16038	11
SB1282-0A	17	SB1451-0A	9	YD060050	3	ZSA16013	7	ZSB18014	7
SB1283-0A	17	SB1452-0A	9	ZMB05018	19	ZSA16022	9	ZSB20012	7
SB1284-0A	17	SB1453-0A	7	ZMB05026	3	ZSA18001	7	ZSC09031	9, 11
SB1285-0A	17	SB1454-0A	9	ZMB08006	21	ZSB08001	13	ZSC09034	11
SB1286-0A	17	SB1455-0A	9	ZMJ06004	19	ZSB08027	9	ZSC11001	5, 13
SB1287-0A	17	SB1456-0A	9	ZMJ06008	3	ZSB09002	3, 15	ZSC11019	9
SB1288-0A	17	SB1457-0A	9	ZML08001	21	ZSB09005	3, 13	ZSC11020	5
SB1289-0A	17	SB1458-0A	9	ZMT05001	21	ZSB09011	9, 11	ZSD24005	5
SB1290-0A	17	SB1459-0A	9	ZSA11002	9	ZSB09017	17	ZSD32002	5
SB1290-1A	17	TC08012000	7	ZSA11004	7, 9, 19	ZSB09021	9	ZSD32003	5
SB1290-2A	17	TC10060220	13	ZSA11005	3	ZSB09041	3	ZSF12002	9
SB1291-0A	17	TC12010210	19	ZSA11007	13	ZSB09047	3	ZSF15004	15
SB1292-0A	17	WA030003	9	ZSA11008	13	ZSB09079	5, 9	ZSF32001	15
SB1293-0A	17	WA050001	3	ZSA11013	13	ZSB09080	5	ZSG11107	15
SB1294-0A	17	WA050010	9	ZSA11020	13	ZSB09093	11	ZSG12075	15
SB1295-0A	17	WA059003	21	ZSA11023	7	ZSB11017	5, 19	ZSG14008	15, 17
SB1296-0A	17	WA080013	21	ZSA15005	7, 9	ZSB11019	19	ZSG14009	17
SB1297-0A	17	WC089001	11	ZSA15006	3	ZSB11020	9	ZSG15043	11
SB1298-0A	17	WC119001	9	ZSA15016	9	ZSB11125	17	ZSG15076	15
SB1310-0A	9	WH206011	17	ZSA15017	7, 11	ZSB11127	17	ZSG15080	17
SB1311-0A	9	WH208007	17	ZSA15018	7	ZSB12003	11	ZSG18024	11, 19
SB1312-0A	9	XA300300	3	ZSA15021	9, 13	ZSB12005	5	ZSG20016	11
SB1313-0A	9	XB132001	3	ZSA15025	9, 19	ZSB12017	11	ZSG81024	19
SB1314-0A	9	XB333001	3	ZSA15028	7, 9	ZSB12057	9	ZSH06010	7
SB1320-0A	3	XB360001	3	ZSA15048	11	ZSB12058	9	ZSH15001	15
SB1321-0A	3	YA060270	3	ZSA15049	13, 17	ZSB12060	5	ZSH15002	11, 17
SB1322-0A	3	YB030016	3	ZSA16009	7	ZSB12061	5	ZSH15003	17

K、347R-1A-1WS 零件號碼與頁數對照 NUMERICAL PARTS-LIST

零件號碼 PARTS NO.	頁數 PAGE	零件號碼 PARTS NO.	頁數 PAGE	零件號碼 PARTS NO.	頁數 PAGE	零件號碼 PARTS NO.	頁數 PAGE	零件號碼 PARTS NO.	頁數 PAGE
ZSH15007	11, 17								
ZSH16005	7, 19								
ZSK09001	9								
ZSK18016	11, 17								
ZSK18032	9								
ZSK18034	17								
ZSK24001	19								
ZSL09002	5								
ZSL12001	11								
ZSL12009	9								
ZSL15001	17								
ZSL18001	9, 11, 17, 19								
ZSL24003	19								
ZSN16006	5								
ZSQ09008	5								

Consolidated Sewing Machine Corp.
Website: www.consew.com

MAIN office

131 W. 25th Street
New York, NY 10001
Tel: 212-741-7788
Fax: 212-741-7787
e-mail: consew@att.net

Miami, FL

4013 N.W. 79th Avenue
Miami, FL 33166
Tel: 305-471-0200
Fax: 305-471-0243
e-mail: miamisales@consew.com

Los Angeles, CA

2320 South Hill Street
Los Angeles, CA 90007
Tel: 213-745-8844
Fax: 213-745-8855
e-mail: lasales@consew.com