

Model 202R 202RB

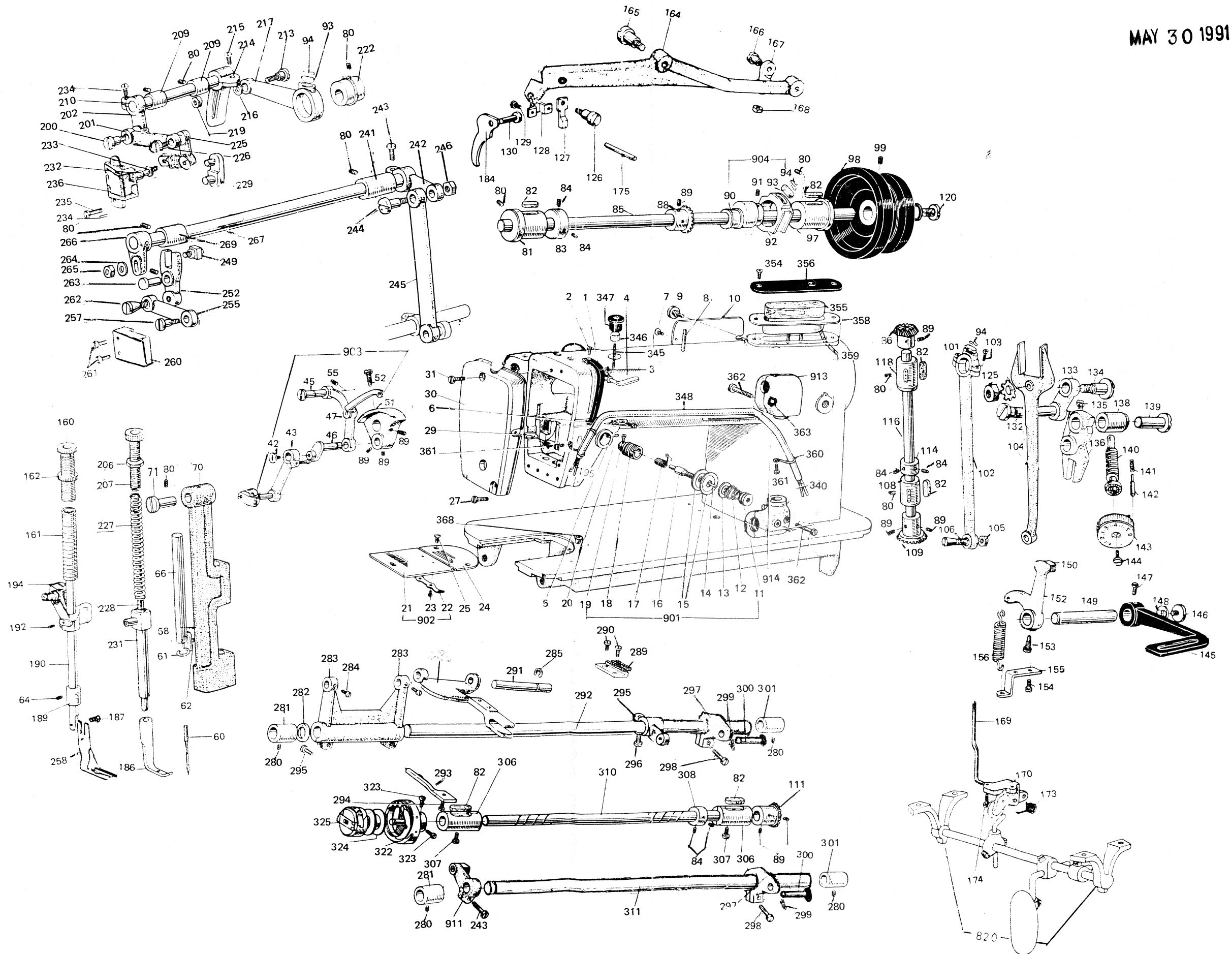

Industrial Sewing Machine Parts Catalog

Fig No.	Description	Fig No.	Description	Fig No.	Description	Fig No.	Description	Fig No.	Description
1	Thread take-up cover	93	Felt for feed cam	155	Hinged screw 5/16(24)X30	245	Feed drive connecting link	340	Wool yarn
2	Screw 11/64(40)X5.5	94	Spring for feed cam	166	Hinged screw 15/64(28)X10	246	Nut 9/32(28)	345	Oil wick ϕ 2.5X35
3	Set screw 11/64(40)X5.5	97	Arm shaft bushing (right)	167	Knee lifter rock shaft arm	249	Feed connecting slick block complete	346	Felt for oiler
4	Three hole thread guide	98	Balance wheel	168	Nut 3/16(32)	252	Feed connecting rod lever	347	Cap for oiler
5	Thread guide for arm	99	Screw 15/64(28)X12	169	Lifting lever connecting rod	255	Walking foot connecting link	348	Oil pipe ϕ 3X ϕ 4.2X580
6	Screw 9/64(40)X6	101	Felt for crank rod	170	Knee lifter bell crank complete	257	Hinged screw 1/4(40)X12	913	Arm shaft bevel gear box complete
7	Screw 11/64(40)X7	102	Crank rod	173	Knee lifter bell crank spring	258	Walking foot	914	Hook shaft bevel gear box complete
8	Spool pin	104	Feed forked connecting rod	174	Screw 11/64(40)X12	259	Screw 9/64(40)X8	354	Screw 11/64(40)X7
10	Arm side cover	105	Nut 9/32(28)	175	Upper thread releasing pin	260	Guide bracket	355	Felt for oil reservoir
11	Thread tension regulating thumb nut	106	Taper screw 9/32(28)X23	184	Presser lifter	261	Screw 11/64(40)X12	356	Oil reservoir cover (right)
12	Thread tension spring	108	Vertical shaft bushing (under)	185	Set screw 11/64(40)X8.5	262	Taper screw 1/4(40)X26	358	Oil reservoir (right)
13	Thread tension releasing disc	109	Bevel gear for vertical shaft (under)	186	Presser foot (inside)	263	Hing pin	359	Oil wick ϕ 2.5X100
14	Thread tension releasing pin ϕ 2X28.4	111	Bevel gear for hook shaft	187	Screw 1/4(40)X9	264	Washer	360	Oil pipe holder
15	Thread tension disc	116	Vertical shaft	188	Set screw 11/64(40)X27	265	Nut 1/4(24)	361	Screw 9/64(40)X6.5
16	Thread tension stud	118	Vertical shaft bushing (upper)	189	Presser bar bushing (under)	266	Feed driving rock shaft crank (left)	362	Screw M5X12
17	Thread take-up spring	120	Screw 11/32(28)X10	190	Presser bar	267	Feed driving shaft (upper)		
18	Thread tension regulator bushing	126	Hinged screw 3/16(28)X6.2	192	Set screw 15/64(28)X8	269	Feed driving shaft bushing (left)		
19	Screw 9/64(40)X4	127	Upper thread releasing cam	194	Presser bar holder	280	Set screw 15/64(28)X10		
901	Thread tension regulator complete	128	Guide plate	200	Hinged screw 1/4(40)X12	281	Feed rock shaft bushing		
	Set screw 15/64(28)X8	129	Screw 11/64(40)X7	201	Feed lifting rock shaft link	282	Feed rock shaft bushing washer		
902	Slide plate complete	130	Presser foot lifting pin	202	Upper feed lifting rock shaft crank	283	Feed rock shaft crank (left)		
24	Needle plate B2.6(7mm)	132	Eccentric pin	206	Nut 9/32(28)	284	Screw 11/64(40)X8		
27	Screw 11/64(40)X20	133	Fixed connecting link	207	Feed regulating screw 9/32(28)X35	285	E-type spring		
29	Thread guide for face Plate	134	Set pin	209	Feed lifting rock shaft bushing	286	Feed bar		
30	Face plate	135	Screw 15/64(28)X10	210	Feed lifting rock shaft	289	Feed dog		
31	Screw 5/32(40)X30	136	Feed regulator	213	Hinged screw M5 PO 75X24	290	Screw 1/8(44)X6		
903	Thread take-up lever & needle bar complete	138	Feed connecting bushing	214	Feed lifting rock shaft crank (right)	291	Feed bar holder stud		
51	Crank	139	Feed connecting hinge pin	215	Screw 1/4(24)X16	292	Feed rock shaft		
52	Screw 4 x 16	140	Stitch length regulator screw	216	Washer 6	293	Rotating hook positioner		
60	Needle DPX17 #22	141	Presser spring for stitch length	217	Feed connecting crank rod	294	Screw 11/64(40)X10		
61	Needle bar thread guide set screw	142	Stopper pin for stitch length 4X18	219	U-nut 6X0.75	295	Screw 3/16(28)X5		
62	Thread guide for needle bar	143	Stitch length regulator dial	222	Feed lifting eccentric	297	Feed lifting & rock shaft crank		
66	Needle bar	144	Screw 3/16(28)X8	225	Bell crank	298	Screw 1/4(24)X16		
68	Needle bar thread guide set screw	145	Reverse sewing lever	226	Screw 3/16(28)X10	299	Screw 15/64(28)X8.5		
70	Needle bar guide bracket	146	Screw 3/16(28)X6.5	227	Spring	300	Pin for feed lifting rock shaft crank		
71	Needle bar guide bracket rot	147	Screw 15/64(28)X8.5	228	Spring guide bar complete	303	Feed lifting rock shaft screw 3/8(28)X35		
80	Set screw 15/64(28)X7	148	Spring washer	229	Vibrating presserbar link	304	Nut 3/8(28)		
81	Arm shaft bushing (left)	149	Reverse stitch lever shaft	231	Vibrating presser bar	311	Feed lifting rock shaft		
82	Felt for arm shaft bushing	152	Stitch length regulating bracket complete	232	Bell crank guide bracket block	911	Feed lifting rock shaft crank complete (left)		
83	Collar for arm shaft	153	Screw 15/64(28)X14.5	233	Bell crank guide pin	306	Rotating hook shaft bushing (right)		
84	Set screw 1/4(40)X4	154	Screw 11/64(40)X8	234	Spring Pin	307	Screw 11/64(40)X13		
85	Arm shaft	155	Feed regulating spring holder	235	Screw 11/64(40)X8	308	Collar for rotating hook shaft		
86	Bevel gear for vertical shaft (upper)	156	Spring	236	Bell crank guide bracket	310	Rotating hook shaft		
88	Bevel gear for arm shaft	160	Presser regulating thumb screw 1/2(28)X43	241	Feed driving shaft bushing (right)	322	Rotating hook complete HSM-A		
89	Set screw 1/4(40)X7	161	Presser bar spring	242	Feed driving rock shaft crank	323	Screw 11/64(40)X5		
90	C-type stop ring	162	Special nut 1/2(28)	243	Screw 1/4(24)X16	324	Bobbin		
904	Feed cam complete	164	Lifting lever (upper)	244	Hinged screw for connecting rod	325	Bobbin case complete		